

RESOLUTION OF THE CITY COUNCIL

No. 504

Approved August 11, 2000

WHEREAS, Johnson & Wales University (hereinafter "Petitioner"), has sought:

(a) to alter the existing grade of the sidewalk located adjacent to 8-11 Abbott Park Place; and

(b) to construct a handicapped access ramp adjacent to said real estate; and

WHEREAS, said access ramp will encroach upon the public walkway; and

WHEREAS, after study of Petitioner's request, the City, acting through its appropriate authorities, has determined that the proposed encroachments are not adverse to the public interest,

NOW, THEREFORE, BE IT RESOLVED That the Petitioner is granted permission to encroach upon the public way for the purpose of constructing and maintaining a handicapped-access ramp at or near the entrance to the building located at 8-11 Abbott Park Place, provided said grant is specifically conditioned upon the following:

1. All construction with relation to the said ramps is to be completed in accordance with plans and specifications submitted by the Petitioner to the city Department of Inspection & Standards as those plans may have been modified and/or approved by said department, the Department of Public Works, and the Council Committee on Public Works. (Copies of the subject plans are attached hereto).

2. The Petitioner shall supply and retain in effect a certificate of insurance in an amount of not less than one hundred thousand dollars (\$100,000.00) protecting the City of Providence and its successors and assigns, its agents, servants, officers and employees as additional-named insureds against claims for the construction, maintenance and/or existence of said ramp encroachment. Said insurance shall be from a company and in a form acceptable to the Department of Law.

IN CITY COUNCIL
FEB 3 2000
FIRST READING
REFERRED TO COMMITTEE ON
PUBLIC WORKS

Michael B. Clemente
CB

THE COMMITTEE ON
PUBLIC WORKS
Approves Passage of
The Within Resolution

Claire A. Bestwick
July 12, 2000 Clerk

From the Clerks Desk

3. The Petitioner shall execute an indemnification and hold harmless agreement satisfactory to the City Solicitor.

4. The Petitioner shall grant to the appropriate public utility(ies) and/or governmental agency(ies), by pertinent document, any easements, licenses, or the like, so as to maintain public services.

5. A certified copy of the within Resolution shall be recorded in the Office of Land Evidence of the City of Providence.

6. Any rights or obligations granted hereunder shall be deemed to run with the land and shall operate against any and all successors in interest and/or title .

7. Any rights or obligations granted hereunder shall remain in full force and effect for so long as the encroachment permitted hereby does not cease to be utilized for the purposes for which it was granted provided, however, Petitioner shall at its own expense remove said encroachment in the event the City notifies said Petitioner or any successor in interest thirty (30) days in advance of the intent of the City to utilize said realty for any purposes. By commencing any alteration pursuant to this grant, Petitioner specifically waives any claim for damages it may have for such use.

8. Such other reasonable conditions as the Mayor and/or the Department of Law may impose hereunder.

9. Petitioner shall comply with all conditions contained herein not later than sixty (60) days from its approval. Upon failure to so comply for any reason, the within resolution shall automatically become a nullity.

CITY COUNCIL
AUG 3 2000
READ AND PASSED

PRES.

CLERK

APPROVED

AUG 11 2000

Vincenta Lamy
Mayor

RICHMOND ST.

Lot 485

Lot 502

Lot 644

CHESTNUT ST.

PINE STREET

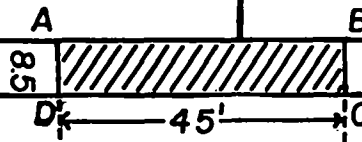

NOTES: Cross-hatched area (A-B-C-D-A) indicates proposed
handicap ramp.
Total square footage = 382.50'

PROVIDENCE, R. I.
DEPT. - ENGINEERING OFFICE
STREET LINE SECTION
Plan No. 064649
Date Feb. 23, 2000

CITY OF PROVIDENCE, R. I.
Public Works Dept. - Engineering Office
Showing proposed handicap ramp on
Pine Street
Drawn by A. Zisides Checked by [Signature]
Scale 1" = 30' Date 2-24-2000
Correct [Signature] Chief Engineer
Approved [Signature]

Lot numbers taken from A.P. 24.

FERDINAND C. IHENACHO, P.E., PTOE.

Director



VINCENT A. CIANCI, JR.

Mayor

Department of Public Works

"Building Pride In Providence"

February 23, 2000

Hon. Robert M. Clarkin
Chairman of the Public Works Committee
Providence City Council -- City Hall
Providence, R.I. 02903

Re: Elevated Sidewalk on Pine Street
8 Abbott Park Place

Dear Councilman Clarkin:

This department has no objection to the elevated sidewalk and grass strip on Pine St., as shown on the accompanying plan entitled, "Providence, R.I., P.W. Dept. Engineering Office, Street Line Section, Plan No. 064649, Date: 2/23/00".

The proposed sidewalk area is depicted as cross-hatched area on the accompanying plan, Noted as A-B-C-D-A. The total square footage related to this proposed work is 382.50 Sq.Ft. Lot numbers taken from A.P. 24.

Be advised that the proposed work encroaches on the sidewalk and lot, in front of Lot 485, which is not owned by the Petitioner (who owns the adjacent Lot 502.) Subsequently, agreement of the owner of Lot 485 is needed to proceed with the proposed improvements. Attached is a list of the property owners.

If we can further assist in this regard, please advise.

Very truly yours,

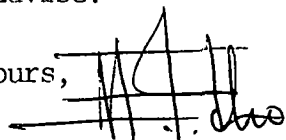
Ferdinand C. Ihenacho, P.E., PTOE
Director of Public Works

M. Clement - City Clerk
J. D'Amico, Esq.
G. Florio, Oper Dir./DPW
JLC
SZ

RESOLUTION OF THE CITY COUNCIL

No. 504

Approved August 11, 2000

WHEREAS, Johnson & Wales University (hereinafter "Petitioner"), has sought:

(a) to alter the existing grade of the sidewalk located adjacent to 8-11 Abbott Park Place; and

(b) to construct a handicapped access ramp adjacent to said real estate; and

WHEREAS, said access ramp will encroach upon the public walkway; and

WHEREAS, after study of Petitioner's request, the City, acting through its appropriate authorities, has determined that the proposed encroachments are not adverse to the public interest,

NOW, THEREFORE, BE IT RESOLVED That the Petitioner is granted permission to encroach upon the public way for the purpose of constructing and maintaining a handicapped-access ramp at or near the entrance to the building located at 8-11 Abbott Park Place, provided said grant is specifically conditioned upon the following:

1. All construction with relation to the said ramps is to be completed in accordance with plans and specifications submitted by the Petitioner to the city Department of Inspection & Standards as those plans may have been modified and/or approved by said department, the Department of Public Works, and the Council Committee on Public Works. (Copies of the subject plans are attached hereto).

2. The Petitioner shall supply and retain in effect a certificate of insurance in an amount of not less than one hundred thousand dollars (\$100,000.00) protecting the City of Providence and its successors and assigns, its agents, servants, officers and employees as additional-named insureds against claims for the construction, maintenance and/or existence of said ramp encroachment. Said insurance shall be from a company and in a form acceptable to the Department of Law.

3. The Petitioner shall execute an indemnification and hold harmless agreement satisfactory to the City Solicitor.

4. The Petitioner shall grant to the appropriate public utility(ies) and/or governmental agency(ies), by pertinent document, any easements, licenses, or the like, so as to maintain public services.

5. A certified copy of the within Resolution shall be recorded in the Office of Land Evidence of the City of Providence.

6. Any rights or obligations granted hereunder shall be deemed to run with the land and shall operate against any and all successors in interest and/or title .

7. Any rights or obligations granted hereunder shall remain in full force and effect for so long as the encroachment permitted hereby does not cease to be utilized for the purposes for which it was granted provided, however, Petitioner shall at its own expense remove said encroachment in the event the City notifies said Petitioner or any successor in interest thirty (30) days in advance of the intent of the City to utilize said realty for any purposes. By commencing any alteration pursuant to this grant, Petitioner specifically waives any claim for damages it may have for such use.

8. Such other reasonable conditions as the Mayor and/or the Department of Law may impose hereunder.

9. Petitioner shall comply with all conditions contained herein not later than sixty (60) days from its approval. Upon failure to so comply for any reason, the within resolution shall automatically become a nullity.



A true copy,
Attest:

Michael R. Clement

Michael R. Clement
City Clerk

RICHMOND ST.

PROVIDENCE, R. I.
DEPT. - ENGINEERING OFFICE
STREET LINE SECTION
Map No. **064649**
Date **Feb. 23, 2000**

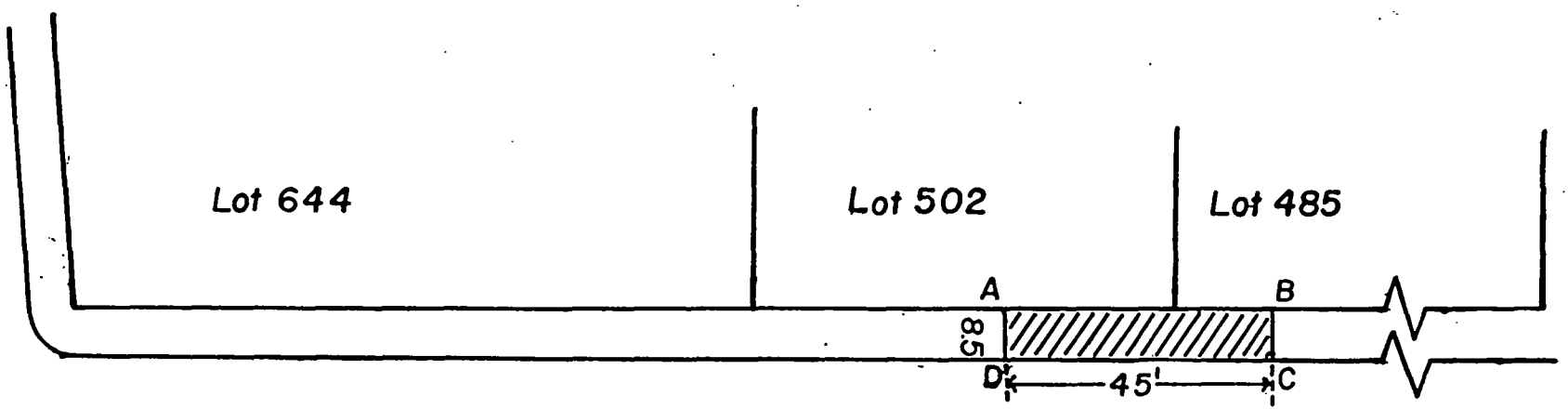

PINE STREET

NOTES: Cross-hatched area (A-B-C-D-A) indicates proposed
handicap ramp.
Total square footage = 382.50'

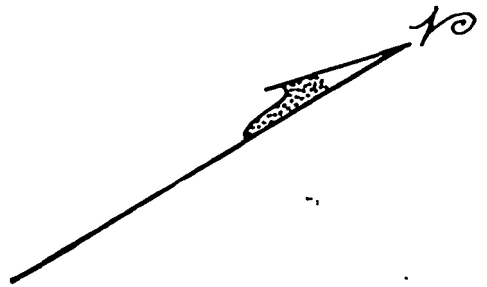

PROVIDENCE, R. I.
RECEIVED FOR RECORD
2000 AUG 30 10 21 AM
BARBARA A. TRONCY
ACTING RECORDER OF DEEDS
Barbara A. Troncy

CITY OF PROVIDENCE, R. I.
Public Works Dept. - Engineering Office
Showing proposed handicap ramp on
Pine Street
Drawn by **A. Zislaides** Checked by **He**
Scale **1" = 30'** Date **2-23-2000**
Correct **Barbara A. Troncy** Chief Engr.
Approved **He** Chief Engineer

Lot numbers taken from A.P. 24.

CHESTNUT ST.

4451 140-142



PROVIDENCE, RI
RECEIVED FOR RECORD

2000 AUG 10 10 27

BARBARA A. TRONCY
ACTING RECORDER OF DEEDS

36022