

# The City of Providence

STATE OF RHODE ISLAND AND PROVIDENCE PLANTATIONS

## CHAPTER 111

No. 309 **AN ORDINANCE** IN AMENDMENT OF SEC. 54-A-3 OF  
CHAPTER 544 OF THE ORDINANCES OF THE CITY OF PROVIDENCE  
ENTITLED "AN ORDINANCE ZONING THE CITY OF PROVIDENCE AND  
ESTABLISHING USE, HEIGHT AND AREA REGULATIONS", AS AMENDED,  
PROVIDING FOR INCREASED STORAGE CAPACITY OF PETROLEUM  
PRODUCTS IN C-A ZONE.

Approved April 19, 1957

*Be it ordained by the City of Providence:*

Section 1. Sec. 54-A-3 of Chapter 544 of the Ordinances  
of the City of Providence, entitled "An Ordinance Zoning the  
City of Providence and Establishing Use, Height and Area  
Regulations", as amended, is further amended to read as  
follows:

"Sec. 54-A-3. AUTOMOBILE SERVICE STATION.--With total  
storage capacity of petroleum products not to exceed  
13,000 gallons and provided that any tire or tube repairing,  
battery charging, and storage of merchandise or supplies  
are conducted wholly within a building; provided further  
that any lubrication or washing not conducted within a  
building shall be permitted only if a solid wall,  
compact evergreen screen or uniformly painted board  
fence not less than 4 feet high is erected and maintained  
between such uses and any adjoining R Zone and provided  
that the use area shall be developed as required in  
Section 24."

Sec. 2. This ordinance shall take effect upon its  
passage.

IN CITY  
COUNCIL

APR 4 - 1957

FIRST READING  
READ AND PASSED

*Deverett Whelan*  
CLERK

APPROVED

APR 19 1957

*Harry H. Regan*  
MAYOR

IN CITY  
COUNCIL

APR 18 1957

FINAL READING  
READ AND PASSED

*Angelo DiStefano*  
PRESIDENT  
*Deverett Whelan*  
CLERK

No.

**CHAPTER**

AN ORDINANCE IN AMENDMENT OF  
SEC. 54-A-3 OF CHAPTER 544  
OF THE ORDINANCES OF THE  
CITY OF PROVIDENCE ENTITLED  
"AN ORDINANCE ZONING THE CITY  
OF PROVIDENCE AND ESTABLISH-  
ING USE, HEIGHT AND AREA RE-  
ULATIONS", AS AMENDED, PRO-  
VIDING FOR INCREASED STORAGE  
CAPACITY OF PETROLEUM PRODUCTS  
IN C-4 ZONE.

**The City of Providence — Legislative Department**  
**CITY CLERK'S OFFICE—OFFICIAL MEMORANDUM**

Providence, R. I., February 8, 1957

TO: City Solicitor

SUBJECT: Additional Storage Capacity at Auto Filling Station

CONSIDERED BY: Committee on Ordinances and Committee on Licenses

ACTION TAKEN: VOTED: to request the City Solicitor to draw such ordinance as he may deem necessary to amend Chapter 544 of the Ordinance approved Sept. 21, 1951 as follows:  
"That Section 54-A-3 be amended to provide a maximum capacity of 13,000 gallons in order to avoid unnecessary petitions before the Board of Zoning Adjustments."

*Everett Whelan*  
City Clerk



## City Plan Commission

EDWARD WINSOR, *Chairman*  
JERRY LORENZO      RALPH MATERA

WALTER H. REYNOLDS, *Mayor*  
LUCIO E. CARLONE, *Secretary*

PAUL A. SAN SOUZI, *Vice Chairman*  
RAYMOND J. NOTTAGE      HARRY PINKERSON

FRANK H. MALLEY, *Director*  
DIETER HAMMERSCHLAG, *Senior Planner*  
ANTHONY A. VERRECCHIA, *Senior Planner*

*Suite 103, City Hall,  
Providence 3, Rhode Island*

August 27, 1956

Committee on Ordinances  
City Hall  
Providence, R. I.

SUBJECT: REFERRAL NO. 847 - ADDITIONAL STORAGE CAPACITY AT AUTO FILL-  
ING STATION

Gentlemen:

The subject referral received consideration by the City Plan Commission at a meeting held on Tuesday, August 21, 1956.

As a result of a substantial number of petitions to the Zoning Board of Review for additional storage capacity at Auto Filling Stations, brought about by the development of a new and third type of gasoline to be handled at most stations, the staff of the City Plan Commission had a conference with Mr. Charles R. Wood, Mr. Vincent Di Mase, Inspector of Buildings, and Battalion Chief Leo Gorman and Captain Thomas Fitzgerald of the Fire Prevention Bureau. The purpose of the conference was to determine whether the 10,000 gallon storage capacity provided for in the Ordinance should be strictly adhered to or whether it could be reasonably increased. Chief Gorman and Captain Fitzgerald felt that the capacity could safely be increased to not over 13,000 gallons and that the Committee on Ordinances could properly be requested to so amend the Ordinance in Section 54-A-3. As there appears to be no serious planning aspects in the proposed change,

The Commission

VOTED: To recommend to the Committee on Ordinances that Section 54-A-3 be amended to provide a maximum capacity of 13,000 gallons in order to avoid unnecessary petitions before the Board of Zoning Adjustments.

Very truly yours,

  
FRANK H. MALLEY  
DIRECTOR  
CITY PLAN COMMISSION

FHM:MMH

# The City of Providence

STATE OF RHODE ISLAND AND PROVIDENCE PLANTATIONS

## CHAPTER 112

*going change  
P#100*

No. 350 **AN ORDINANCE** IN AMENDMENT OF CHAPTER 544 OF THE ORDINANCES OF THE CITY OF PROVIDENCE, APPROVED SEPTEMBER 21, 1951, AS HERETOFORE AMENDED, IS HEREBY FURTHER AMENDED BY CHANGING FROM AN R-3 GENERAL RESIDENTIAL ZONE TO AN M-1 GENERAL INDUSTRIAL ZONE, LOTS 222 and 223 AS SET OUT AND DELINEATED ON CITY ASSESSOR'S PLAT 46; SAID LOTS BEING DESIGNATED AS 36-38 and 40-42 BISHOP STREET.

Approved April 19, 1957

*Be it ordained by the City of Providence:*

SECTION 1: The Zoning Map accompanying and made a part of Chapter 544 of the Ordinances of the City of Providence, approved September 21, 1951, as heretofore amended, and entitled "An Ordinance Zoning the City of Providence and Establishing Use, Height, and Area Regulations" is hereby further amended by changing from an R-3 General Residential Zone to an M-1 General Industrial Zone, Lots 222 and 223 as set out and delineated on City Assessor's Plat 46; said lots being designated as 36-38 and 40-42 Bishop Street, bounded and described as follows:

Beginning at a point in the southerly line of Bishop Street at the northeasterly corner of Lot 222 on Assessor's Plat 46; thence southerly, bounding easterly on Lot 221 to the southeasterly corner of Lot 222; thence westerly, bounding southerly in part on Lot 311 and in part on the northerly line of Janes Street to the southwesterly corner of Lot 223; thence northerly, bounding westerly on Lot 224 to the northwesterly corner of Lot 223; thence easterly along the southerly line of Bishop Street to the northeasterly corner of Lot 222 and the point and place of beginning.

SECTION 2: This Ordinance shall take effect upon its passage.

IN CITY  
COUNCIL

APR 4 - 1957

FIRST READING

READ AND PASSED

*Everett Whelan*  
CLERK

IN CITY  
COUNCIL

APR 18 1957

FINAL READING  
READ AND PASSED

*Angelo Stillo*  
PRESIDENT  
*Everett Whelan*  
CLERK

APPROVED

APR 19 1957

*Nathan H. Reynolds*  
MAYOR

**CITY OF PROVIDENCE**  
STATE OF RHODE ISLAND AND PROVIDENCE PLANTATIONS

**PETITION TO THE CITY COUNCIL**

TO THE HONORABLE CITY COUNCIL OF THE CITY OF PROVIDENCE:

The undersigned respectfully petitions your honorable body ~~for~~  
to change from an R-3 General Residence Zone to an ~~M-1~~ General Industrial  
Zone Lots 222 and 223 as set out and delineated on City Assessor's Plat 46;  
said Lots being designated as 36-38 and 40-42 Bishop Street.

Giuseppe Maiorano *Maiorano*

Filomena Maiorano

Gemma Clemente

Madeline Clemente

**IN CITY  
COUNCIL**

**FEB 21 1957**

**PROJ. RESOLVING  
REFERRED TO COMMITTEE ON  
ORDINANCES**  
.....  
*Thompson*  
GREEN

**FEB 13 3 33 PM '57  
CITY CLERK'S OFFICE  
PROVIDENCE, R.I.**

CITY COUNCIL

DATE Feb. 13, 1957

RECEIVED OF Giuseppe Maisiane

TEN AND 00/100

DOLLARS

Fee for Petition to the City Council for a change in the Zoning of

Lot

Flat

\$10.00

PAID—City of Providence — James M. Gordon, City Collector

10.00

YAC

FEB-13-57 0.00

**The City of Providence — Legislative Department**  
**CITY CLERK'S OFFICE—OFFICIAL MEMORANDUM**

Providence, R. I., ~~February 22, 1957~~

TO: City Plan Commission

SUBJECT: zoning petition - Giuseppe Maiorani, et al, -40-42 Bishop Street

CONSIDERED BY: Committee on Ordinances

ACTION TAKEN: Voted: to refer attached petition for study, report, and  
recommendation.

*City Clerk*

Giuseppe Maiorano, Et al  
36-28 & 40-42 Bishop Street

16

Plat 46 Lots 222 & 223

Plat 46

311 Hilda G. Bonar & William F. Whalen  
695 Eddy St.

216 " "

486 Jean Carbone & wf. Rosella I.  
896 Warwick Avenue, Lakewood

223 Gennaro & Maddalena D. Clemente  
7 Belcourt Avenue, No. Prov.

225 William Connolly & wf. Elizabeth I.  
52 Bishop Street

506 Charles W. Cooney & wf. Nellie - *owned by - owner of B. ...*  
12 Janes Street *now Sarah J. + Helen C. Lynch, ...*  
*41 Janes St.*

260 Joseph Cultrera  
21 Messer St.

262 John F. & Anna Flynn & Theresa Clark  
2 Winter Avenue, Conimicut

108 Mary Grzinkowski  
294 Waldo St.

224 Sabina Kruk, wd. Ilko  
46 Bishop St.

222 Giuseppe & Filomena Maiorano  
57 ~~Vernon~~ Vernon St.

221 John J. McGann & wf. Margaret G.  
160 Wyndham Ave.

263 Millard Wire Co.  
47 Culver Rd.

220 Emil Rekrut & wf. Ksenia  
40 Edgewood Blvd.

257 Rose Rocchio  
2769 Hartford Ave., Johnston

261 Frank Wallace & wf. Bertha  
78 Willard Ave.

Ward 11

Councilman Edward P. Quigley  
Councilman Edmund Wexler

**Zoning Change No.**  
**Shaded area to be changed from an**  
**R-3 General Residence Zone to an M-1**  
**General Industrial Zone.**

February 28, 1957

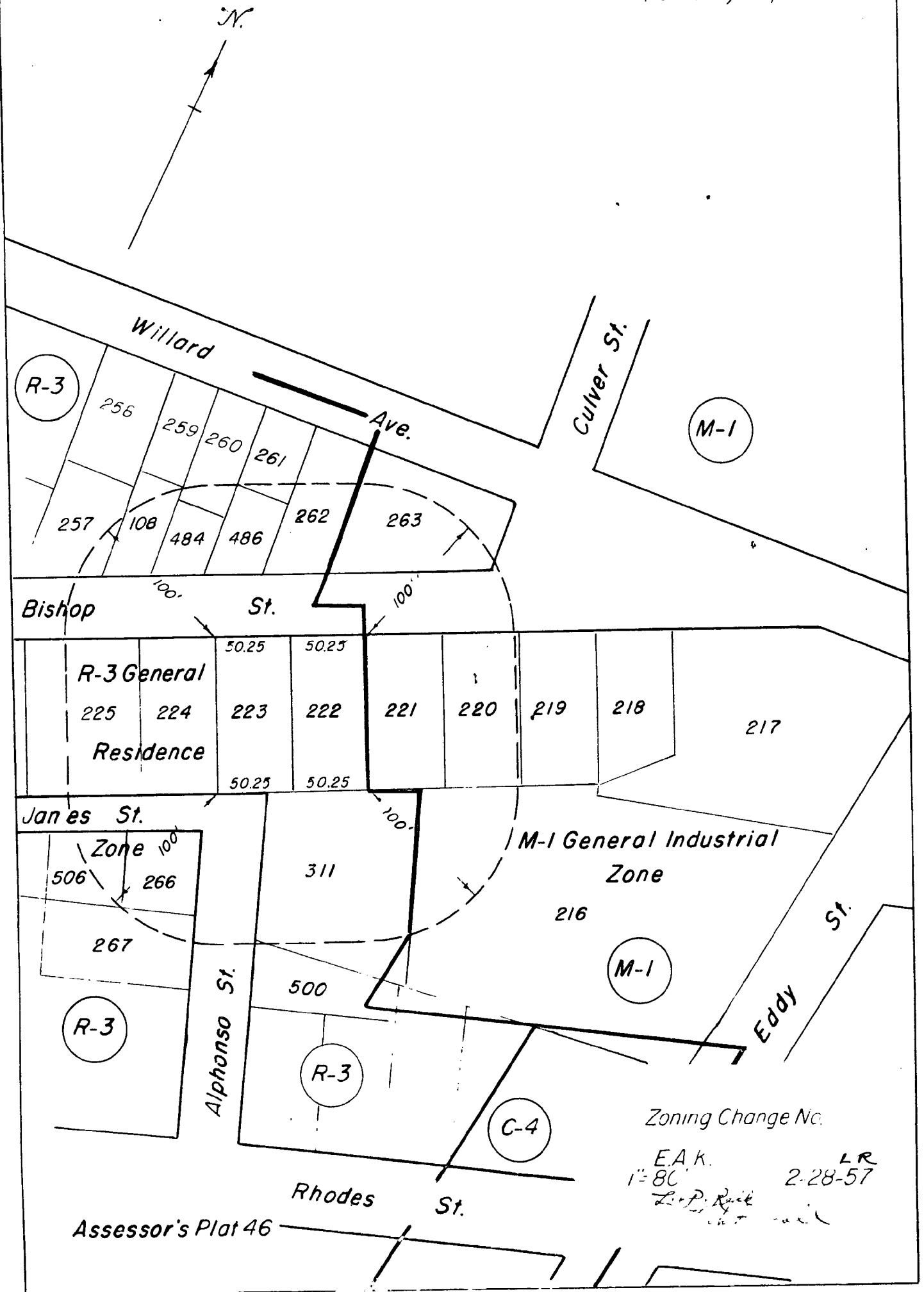

Zoning Change No.

E.A.K.  
 1-80  
 L.P. Ruck  
 2-28-57



# City Plan Commission

EDWARD WINSOR, *Chairman*  
JERRY LORENZO      RALPH MATERA

WALTER H. REYNOLDS, *Mayor*  
LUCIO E. CARLONE, *Secretary*

PAUL A. SAN SOUZI, *Vice Chairman*  
RAYMOND J. NOTTAGE      HARRY PINKERSON

FRANK H. MALLEY, *Director*  
DILTER HAMMERSCHLAG, *Senior Planner*  
ANTHONY A. VERRECCHIA, *Senior Planner*

*Suite 103, City Hall,  
Providence 3, Rhode Island*

**April 2, 1957**

**Committee on Ordinances  
City Hall  
Providence, R. I.**

**SUBJECT: Referral No. 880 - ZONING CHANGE AT 36-38 AND 40-42 BISHOP STREET**

**Gentlemen:**

This referral, from the Committee on Ordinances, is a request for a change of zoning from an R-3 Zone to an M-1 Zone of Lots 222 and 223 on Assessor's Plat 46 located at 36-38 and 40-42 Bishop Street. The area in question contains 10,150 square feet of land area.

On the field trip it was found that the area in question is at present occupied by two vacant three-family dwellings, and the adjacent properties are in a heavy commercial and industrial use.

The extension of the M-1 use to include this area would not affect the adjacent property. Therefore, the staff offers no objection to the granting of this petition.

Very truly yours,

  
FRANK H. MALLEY  
DIRECTOR  
CITY PLAN COMMISSION

FHM:MMH



## City Plan Commission

EDWARD WINSOR, *Chairman*  
JERRY LORENZO      RALPH MATERA

WALTER H. REYNOLDS, *Mayor*  
LUCIO E. CARLONE, *Secretary*

PAUL A. SAN SOUZI, *Vice Chairman*  
RAYMOND J. NOTTAGE      HARRY PINKERSON

FRANK H. MALLEY, *Director*  
DIETER HAMMERSCHLAG, *Senior Planner*  
ANTHONY A. VERRECCHIA, *Senior Planner*

*Suite 103, City Hall,  
Providence 3, Rhode Island  
April 10, 1957*

**Committee on Ordinances  
City Hall  
Providence, R. I.**

**SUBJECT: REFERRAL NO. 880 - ZONING CHANGE AT 36-38 AND 40-42 BISHOP STREET**

**Gentlemen:**

The subject referral received further consideration by the City Plan Commission at a meeting held on Tuesday, April 9, 1957.

This referral is a request for a change of zoning from an R-3 Zone to an M-1 Zone of Lots 222 and 223 on Assessor's Plat 46 located at 36-38 and 40-42 Bishop Street. The area in question contains 10,150 square feet of land area.

On the field trip it was found that the area in question is at present occupied by two vacant three-family dwellings, and the adjacent properties are in a heavy commercial and industrial use.

The extension of the M-1 use to include this area would not affect the adjacent property. Therefore,

**The Commission**

**VOTED: To offer no objection to the granting of this petition.**

Very truly yours,

  
FRANK H. MALLEY  
DIRECTOR  
CITY PLAN COMMISSION

FHM:MMH

c.c. Councilman Edward P. Quigley  
Councilman Edmund Wexler

**The City of Providence**  
STATE OF RHODE ISLAND AND PROVIDENCE PLANTATIONS

~~1013~~  
**CHAPTER 113**

**No. 311 AN ORDINANCE** AMENDING CHAPTER 1052 of the ORDINANCES OF THE  
CITY OF PROVIDENCE, AS APPROVED SEPTEMBER 20, 1956, AS AMENDED,  
BY DELETING SEVERAL SECTIONS AND ADDING SEVERAL SECTIONS THERETO.

*Approved* April 19, 1957

*Be it ordained by the City of Providence:*

SECTION 1: Chapter 1052 of the Ordinances of the City of Providence as  
approved September 20, 1956, as amended, is hereby further amended as follows:

Delete:

SECTION 22: DEPARTMENT OF INSPECTOR OF BUILDINGS

SECTION 23: DEPARTMENT OF SANITARY ENGINEER OF PLUMBING AND DRAINAGE

SECTION 46: The number of employees in the DEPARTMENT OF PUBLIC WORKS-  
PUBLIC SERVICE DIVISION-ADMINISTRATION SECTION shall not  
exceed four (4); shall hereafter read: The number of employees  
in the DEPARTMENT OF PUBLIC WORKS-PUBLIC SERVICE DIVISION-  
ADMINISTRATION SECTION shall not exceed one (1).

Delete:

- 1 Steam Engineering Examiner
- 1 Clerk Stenographer II
- 1 Clerk Typist I (Temporary)

SECTION 47: DEPARTMENT OF PUBLIC WORKS-PUBLIC SERVICE DIVISION-ELECTRICAL  
INSPECTION SECTION

SECTION 49: DEPARTMENT OF PUBLIC WORKS-PUBLIC SERVICE DIVISION-AIR POLLUTION  
AND SMOKE ABATEMENT SECTION

Add:

SECTION 22: The number of employees in the DEPARTMENT OF BUILDING INSPECTION  
ADMINISTRATION shall not exceed thirteen (13). There shall be no  
more than:

- 1 Director of Building Inspection
- 1 Plan Estimator
- 1 Clerk IV
- 1 Clerk III
- 1 Clerk Stenographer III
- 2 Clerk Stenographer II
- 1 Clerk Stenographer I
- 3 Clerk Typist II
- 1 Clerk Typist I
- 1 Automobile Driver

No.

1

**CHAPTER**  
**AN ORDINANCE**

# The City of Providence

STATE OF RHODE ISLAND AND PROVIDENCE PLANTATIONS

PAGE -2-

SECTION 23: The number of employees in the DEPARTMENT of BUILDING INSPECTION-STRUCTURES and ZONING DIVISION shall not exceed twelve (12). There shall be no more than:

- 1 Chief Inspector of Structures and Zoning
- 1 Building Inspector III
- 2 Building Inspector II
- 8 Building Inspector I

SECTION 23-A: The number of employees in the DEPARTMENT of BUILDING INSPECTION-PLUMBING, DRAINAGE and GAS PIPING DIVISION shall not exceed six (6). There shall be no more than:

- 1 Chief Inspector of Plumbing, Drainage and Gas Piping
- 1 Plumbing Inspector III
- 4 Plumbing Inspector I

SECTION 23-B: The number of employees in the DEPARTMENT of BUILDING INSPECTION-ELECTRICAL INSTALLATIONS DIVISION shall not exceed six (6). There shall be no more than:

- 1 Chief Inspector of Electrical Installations
- 1 Electrical Inspector III
- 4 Electrical Inspector I

SECTION 23-C: The number of employees in the DEPARTMENT of BUILDING INSPECTION-AIR POLLUTION, MECHANICAL EQUIPMENT and INSTALLATIONS DIVISION shall not exceed nine (9). There shall be no more than:

- 1 Chief Inspector of Air Pollution, Mechanical Equipment and Installations
- 1 Air Pollution & Mechanical Equipment Inspector III
- 3 Air Pollution & Mechanical Equipment Inspector II
- 3 Air Pollution & Mechanical Equipment Inspector I
- 1 Steam Engineering Examiner

SECTION 2: This Ordinance shall become effective April 22, 1957.

IN CITY COUNCIL  
APR 4 1957  
First Reading Read and Passed  
Referred to Committee on  
FINANCE  
*Deverett Whelan*  
Clerk

IN CITY  
COUNCIL

APR 18 1957  
FINAL READING  
READ AND PASSED

*Angelo Diella*  
PRESIDENT  
*Deverett Whelan*  
CLERK

APPROVED

APR 19 1957

*Walter S. Reynolds*  
MAYOR

# The City of Providence

STATE OF RHODE ISLAND AND PROVIDENCE PLANTATIONS

## CHAPTER 114

No. 312 AN ORDINANCE AMENDING CHAPTER 760, SECTION 1 "ESTABLISHING  
A CLASSIFICATION PLAN FOR THE CITY OF PROVIDENCE", AS APPROVED  
AUGUST 7, 1953.

Approved April 19, 1957

*Be it ordained by the City of Providence:*

SECTION 1: The Classification Plan as incorporated and adopted in Section 1  
of Ordinance. Chapter 760 entitled: "An Ordinance: Establishing a Classification Plan  
for the City of Providence", as amended, is hereby further amended in the following respects:

Delete:

Building Inspector IV	(424)
Zoning Assistant II	(432)
Electrical Inspector	(426)
Air Pollution Regulation Engineer	(435)
Air Pollution Inspector I	(436)
Air Pollution Inspector II	(437)
Plumbing Inspector III	(431)

Add:

Director of Building Inspection	(736)
Plan Estimator	(738)
Chief Inspector of Structures and Zoning	(740)
Chief Inspector of Plumbing, Drainage and Gas Piping	(742)
Plumbing Inspector III	(743)
Chief Inspector of Electrical Installations	(744)
Electrical Inspector III	(746)
Electrical Inspector I	(748)
Chief Inspector of Air Pollution and Mechanical Equipment Installations	(751)
Air Pollution and Mechanical Equipment Inspector III	(753)
Air Pollution and Mechanical Equipment Inspector II	(754)
Air Pollution and Mechanical Equipment Inspector I	(755)

SECTION 2: This Ordinance shall become effective April 22, 1957.

IN CITY COUNCIL  
APR 4 1957

First Reading Read and Passed  
Referred to Committee on

FINANCE  
*D. Everett Whelan*  
Clerk

IN CITY  
COUNCIL

APR 18 1957

FINAL READING  
READ AND PASSED

*D. Everett Whelan*  
PRESIDENT  
CLERK

## DIRECTOR OF BUILDING INSPECTION

CLASS TITLE: Director of Building Inspection

CLASS DEFINITION: Highly responsible engineering and administrative work in the enforcement of the Building Ordinance, Zoning Ordinance and related work.

DISTINGUISHING FEATURES OF WORK: Work involves responsibility for the administration and enforcement of the Building Code, establishing general policies, promulgating rules to implement the requirements of the Building Code, in order to secure the intent and beneficial effects thereof. He shall act in an advisory capacity to the Zoning Board of Review, the Building Board of Review, and the licensing committee of the City Council, and shall participate in the activities of the Building Code Revision Board and the Board of Survey as a member.

ILLUSTRATIVE EXAMPLES OF WORK: Executes the provisions of the Building Ordinance, the Zoning Ordinance and related laws and ordinances. Explains and interprets these ordinances to building contractors, owners, and other interested persons. Supervises the manner and method of issuing building permits to insure compliance with established public safety standards, and supervises construction plans. Inspects fire damaged buildings and orders partial or complete demolition or specified repairs. Condemns buildings unsafe because of structural weakness or potential fire hazard. Consults with, and advises the Zoning Board of Review relative to cases before it. Executes provisions of Window Cleaners Ordinance establishing safety standards, and other public safety ordinances and laws. Reports ordinance violations to City Solicitor for prosecution and signs warrants. Establishes work procedure and instructs and supervises subordinates in their work.

DESIRABLE KNOWLEDGES, SKILLS AND ABILITIES: He shall have the ability to design new buildings and other structures, to examine plans and check designs of new buildings, other structures, mechanical equipment and installations including a general knowledge of electrical and plumbing equipment and installations in order to determine whether such plans and designs are in conformity with the provisions of the Building Code, other ordinances and good engineering practice. Prepares rules and regulations governing the above work for submission to the Building Code Revision Board and to prepare specifications, estimates and reports, to supervise construction and alterations, repair, demolition, maintenance and inspection and to perform related work as required.

QUALIFICATIONS REQUIRED FOR APPOINTMENT: The Director shall be a Registered Professional Engineer, or a Registered Architect, preferably a graduate of a recognized college or University, a General Building Contractor or general superintendent of building construction with at least twelve (12) years experience in his profession, including five (5) years in responsible charge of important building work.

SPECIAL QUALIFICATIONS REQUIRED BY CHARTER: Minimum of five (5) years experience as an architect or structural engineer.

## PLAN ESTIMATOR

CLASS TITLE: Plan Estimator

CLASS DEFINITION: Checks plans for buildings and structures, for purpose of verifying fees.

DISTINGUISHING FEATURES OF WORK: Work involves responsible charge of checking plans and determining the cost of buildings, structures and equipment as shown on plans filed. General policies are established by the superior, but incumbent is individually responsible for technical aspects of the work. Supervises the construction of buildings and other structures. Prepares reports, examines plans and checks designs.

ILLUSTRATIVE EXAMPLES OF WORK: Examines plans for structural design. Determines whether or not the proposed structure complies with the building code and related ordinances and with good structural engineering practice. He must keep a permanent record of the checking calculations on all important structures.

NECESSARY KNOWLEDGES, SKILLS and ABILITIES: Knowledge of structural design of buildings and structures. Ability to establish and maintain satisfactory relations with the public.

QUALIFICATIONS REQUIRED FOR APPOINTMENT: The Plan Estimator shall be a registered professional engineer (structural-civil) who shall have had at least 12 years of experience in designing, checking plans and specifications of buildings and other structures.

## CHIEF INSPECTOR OF STRUCTURES AND ZONING

**CLASS TITLE:** Chief Inspector of Structures and Zoning

**CLASS DEFINITION:** Highly responsible civil and structural engineering duties in the enforcement of the Building Code, the Zoning Ordinance and related work as required.

**DISTINGUISHING FEATURES OF WORK:** Work involves responsibility for planning and directing engineering and inspection duties, establishing general policies and individually responsible for technical aspects of the work. Work is reviewed for accomplishment. Supervision is exercised over assistants and clerks.

**ILLUSTRATIVE EXAMPLES OF WORK:** Examines plans and checks designs of new buildings and other structures in order to determine whether such plans and designs are in conformity with the provisions of the Building Code, other ordinances and good engineering practice. Prepares specifications, estimates and reports, supervises construction, alterations, repairs, demolitions, inspections of buildings and other structures and performs related work as required. Consults with and advises the Zoning Board of Review relative to cases before it.

**DESIRABLE KNOWLEDGES, SKILLS AND ABILITIES:** He shall have the ability to design new buildings and other structures, to examine plans and check designs of new buildings and other structures in order to determine whether such plans and designs are in conformity with the provisions of the Building Code, other ordinances and good engineering practice. Prepares rules and regulations governing the above work for submission to the Building Code Revision Board.

**QUALIFICATIONS REQUIRED FOR APPOINTMENT:** Experience as a civil engineer engaged in the supervision of structural design and construction methods pertaining to buildings and other structures. He shall be a registered professional engineer in the State of Rhode Island, preferably a graduate of a recognized college or university.

CHIEF INSPECTOR OF PLUMBING  
DRAINAGE AND GAS PIPING

CLASS TITLE: Chief Inspector of Plumbing, Drainage and Gas Piping

CLASS DEFINITION: Highly responsible plumbing, drainage and gas piping work.

DISTINGUISHING FEATURES OF WORK: Work involves responsibility for planning and directing plumbing and drainage work and inspection, establishing general policies and individually responsible for technical aspects of the work. Work is reviewed for accomplishment. Supervision is exercised over assistants and clerks.

ILLUSTRATIVE EXAMPLES OF WORK: Reviews and approves plans for installation, repair or extension of plumbing systems to insure conformity with municipal regulations. Supervises the work of a small staff of plumbing inspectors guiding their decisions in the more difficult cases and reviewing their work through reports. Investigates complaints concerning violations of the plumbing code. Prosecutes illegal plumbing when necessary. Explains and interprets plumbing regulations to contractors, the public, and other interested parties. Supervises the preparation of, and approves all plans and specifications pertaining to the plumbing and drainage of all buildings and structures belonging to the City of Providence. Examines candidates for master plumbers' and master drain layers' licenses.

NECESSARY KNOWLEDGES, SKILLS AND ABILITIES: Examine plans, check design of any plumbing and drain laying projects, in order to determine whether such plans and designs are in conformity with the provisions of this Code, other ordinances and good practice as applied to plumbing and drainage work, to prepare reports, to supervise the installations, inspection, operation and maintenance of plumbing and drainage systems in buildings and other structures and to perform related work as required. Thorough knowledge of the laws and ordinances. Prepares rules and regulations governing the installation of plumbing and drainage work for submission to the Building Code Revision Board and the ability to supervise the enforcement of these laws, ordinances, rules and regulations.

QUALIFICATIONS REQUIRED FOR APPOINTMENT: He shall be a Registered Professional(Sanitary)Engineer with at least Five (5) years of practical experience or a certified licensed Master Plumber with at least Five (5) years practical experience in plumbing and drainage work, or sanitary engineering.

SPECIAL QUALIFICATIONS REQUIRED BY CHARTER: He must be a practical plumber and qualified by training and experience in the theory and practice of sanitation as applied to plumbing and drainage.

USUAL LINE OF PROMOTION: FROM: PLUMBING INSPECTOR III

## PLUMBING INSPECTOR III

CLASS TITLE: Plumbing Inspector III

CLASS DEFINITION: Highly responsible sanitary engineering work in plumbing and drainage; and practical experience in gas piping.

DISTINGUISHING FEATURES OF WORK: Work involves responsible supervision and directing of inspection. General policies are established by superior but incumbent is responsible for technical aspects of the work. Work is subject to review by superior.

ILLUSTRATIVE EXAMPLES OF WORK: Assists the Division Chief in all phases of his work and assumes responsible charge as Division Chief whenever the Division Chief is out of the City or is incapacitated, and also assists in preparing rules and regulations governing the installation of Plumbing Drainage and Gas Piping, and supervises the enforcement of these ordinances, rules and regulations. Explains and interprets plumbing, drainage and gas piping regulations to contractors, the public and other interested parties. Investigates complaints of violations of the Building Code as it pertains to Plumbing, Drainage and Gas Piping. Checks Field reports of subordinates for compliance with Building Code of all work in progress. Supervises the notification to the property owner or his agent of all violations of the Building Code.

DESIRABLE KNOWLEDGES, SKILLS AND ABILITIES: Thorough knowledge of the practices of sanitary engineering particularly as applied to the installation of plumbing systems. Ability to lay out work for and supervise the work of Plumbing Inspectors I. Ability to establish and maintain satisfactory relations with the public.

QUALIFICATIONS REQUIRED FOR APPOINTMENT: Graduation from a standard high school and completion of a recognized apprenticeship under a journeyman plumber. Experience as a journeyman plumber and some experience as a plumbing inspector.

CHIEF INSPECTOR OF ELECTRICAL  
INSTALLATIONS

CLASS TITLE: Chief Inspector of Electrical Installations

CLASS DEFINITION: Highly responsible administrative engineering work, of an electrical engineering nature; and related work as required.

DISTINGUISHING FEATURES OF WORK: Work involves responsibility for planning, assigning and directing the activities of subordinates, for compliance with the requirements of the Building Code.

ILLUSTRATIVE EXAMPLES OF WORK: Examines plans, and checks designs of electrical engineering projects, in order to determine whether such plans and designs conform to the provisions of the Building Code, other ordinances or statutes and good engineering practices; prepares specifications estimates and reports; supervises the construction, installation, inspection, operation and maintenance of electrical equipment and appliances in buildings and other structures. Prepares revisions for submission to the Building Code Revision Board.

DESIRABLE KNOWLEDGES, SKILLS AND ABILITIES: Comprehensive knowledge of the principles and practices of electrical engineering, particularly as applied to the proper installation of electric wiring systems and apparatus. Ability to maintain cooperative relationships with employees, other division heads and the public.

QUALIFICATIONS REQUIRED FOR APPOINTMENT: Shall be a Registered Professional (Electrical) Engineer and shall have Five (5) Years practical experience in the electrical field.

### ELECTRICAL INSPECTOR III

**CLASS TITLE:** Electrical Inspector III

**CLASS DEFINITION:** Highly responsible electrical engineering and related work as required.

**DISTINGUISHING FEATURES OF WORK:** Under the supervision of the Chief of the Division, supervises and directs the work of subordinates. Carries out general policies established by superiors, and is responsible for the technical aspects of work. Work is subject to review by superior.

**ILLUSTRATIVE EXAMPLES OF WORK:** Assists the Division Chief in all phases of his work; acts as Division Chief in the absence of the Division Chief from the City, or whenever the Division Chief is incapacitated; assists in preparing revisions for submission to the Building Code Revision Board.

**DESIRABLE KNOWLEDGES, SKILLS and ABILITIES:** Thorough knowledge of the practices of electrical engineering, particularly as applied to the installation of electrical wiring systems. Ability to lay out work for an supervise. the work of Electrical Inspectors I. Ability to establish and maintain satisfactory relations with the public.

**QUALIFICATIONS REQUIRED FOR APPOINTMENT:** Graduation from a standard high or technical school, with courses in Electrical Engineering; preferably graduation from a recognized college or university, with major courses in electrical engineering. Shall have at least Five (5) years of practical electrical experience.

## ELECTRICAL INSPECTOR I

**CLASS TITLE:** ELECTRICAL INSPECTOR I

**CLASS DEFINITION:** Inspects new and existing electrical installations to insure conformity with rules and regulations.

**DISTINGUISHING FEATURES OF WORK:** Work involves responsibility for inspection of new and existing electrical installations to insure conformity with established standards. When deemed necessary advice and assistance is available from superior in difficult cases. Work is assigned by a superior and all inspectional reports shall be submitted in written form.

**ILLUSTRATIVE EXAMPLES OF WORK:** (Note: The following examples of work are only illustrative of the kind of work to be performed by persons of this class and are not intended to be all inclusive or exclusive.) Inspects new and existing installations of electrical wires, apparatus and equipment in all types of buildings and other structures to insure conformity with the building code regulating such installations. Checks plans and specifications of proposed electrical installations. Submits reports of violations and issues written or verbal orders for correction of same.

**NECESSARY KNOWLEDGES, SKILLS AND ABILITIES:** Thorough knowledge of building code regulations pertaining to electrical installations. Thorough knowledge of the methods, materials, and techniques of the electrical trade at the journeyman level. Ability in locating defects and hazards in new and existing installations. Ability to successfully meet contractors, property owners, and the general public and to establish effective working relationships.

**QUALIFICATIONS REQUIRED FOR APPOINTMENT:** Graduation from a standard high or technical school and completion of a recognized apprenticeship under a journeyman electrician; five (5) years experience as a journeyman electrician.

**CHIEF INSPECTOR OF AIR POLLUTION AND MECHANICAL  
EQUIPMENT INSTALLATIONS**

**CLASS TITLE:** Chief Inspector of Air Pollution and Mechanical Equipment Installations

**CLASS DEFINITION:** Performs responsible supervisory work pertaining to the installation of fuel burning, heating, ventilating, air conditioning, refrigeration, and other equipment which might contribute to air pollution.

**DISTINGUISHING FEATURES OF WORK:** Administers and directs the work of air pollution and mechanical inspectors in a program of smoke abatement, and inspection of heating, ventilating, air conditioning and refrigeration installations for compliance with the requirements of the Building Code.

**ILLUSTRATIVE EXAMPLES OF WORK:** Plans, assigns, and supervises the work of subordinates. Examines for approval the application and plans for the construction, installation or alteration of any fuel burning, heating ventilating, air conditioning, refrigeration and other equipment which might contribute to air pollution, for compliance with the provision of the Building Code.

**DESIRABLE KNOWLEDGES, ABILITIES AND SKILLS:** Thorough knowledge of the Building Code as it pertains to Air Pollution Regulation and Mechanical Equipment. Thorough knowledge of the materials and methods used in the installation of all air pollution regulation and mechanical equipment, governed by the Building Code. Ability to successfully meet and establish satisfactory relations with the public.

**QUALIFICATIONS REQUIRED FOR APPOINTMENT:** He shall have at least Five (5) years service in the Division of Air Pollution.

**USUAL LINE OF PROMOTION:** FROM: AIR POLLUTION AND MECHANICAL INSPECTOR III

AIR POLLUTION AND MECHANICAL  
EQUIPMENT INSPECTOR III

CLASS TITLE: Air Pollution and Mechanical Equipment Inspector III

CLASS DEFINITION: Highly responsible technical work in supervising the enforcement of the Building Code as it pertains to the Air Pollution and Mechanical Equipment Division.

DISTINGUISHING FEATURES OF WORK: Under the supervision of the Chief of the Division; supervises and directs the work of subordinates. Carries out general policies established by superiors, and is responsible for the technical aspects of work. Work is subject to review by superior.

ILLUSTRATIVE EXAMPLES OF WORK: Assists the Division Chief in all phases of his work: acts as Division Chief in the absence of the Division Chief from the City, or whenever the Division Chief is incapacitated; assists in preparing revisions for submission to the Building Code Revision Board.

DESIRABLE KNOWLEDGES, SKILLS AND ABILITIES: Thorough knowledge of the practices of combustion and mechanical engineering particularly as applied to the installation of fuel burning and mechanical equipment. Ability to lay out work for and supervise the work of subordinates. Ability to establish and maintain satisfactory relations with the public.

QUALIFICATIONS REQUIRED FOR APPOINTMENT: Graduation from a standard High or Technical School, with courses in Combustion or Mechanical Engineering; preferably graduation from a recognized college or university with major courses in mechanical engineering. Shall have at least five (5) years experience in the related fields.

USUAL LINE OF PROMOTION: FROM: AIR POLLUTION AND MECHANICAL EQUIPMENT  
INSPECTOR II

## AIR POLLUTION AND MECHANICAL EQUIPMENT INSPECTOR II

**CLASS TITLE:** AIR POLLUTION AND MECHANICAL EQUIPMENT INSPECTOR II

**CLASS DEFINITION:** Performance of highly responsible inspectional work in the enforcement of the Building Code as it pertains to the Air Pollution and Mechanical Equipment Division.

**DISTINGUISHING FEATURES OF WORK:** Work involves primary responsibility for the acceptance or rejection of plans and specifications for new and existing air pollution mechanical devices and mechanical equipment apparatus relating to air conditioning, refrigeration and ventilation to insure conformity with the Building Code and established standards. When deemed necessary advice and assistance is available from a superior in difficult cases. Work is assigned by a superior and all inspectional reports shall be submitted in written form. Work is performed under the general direction of a superior and supervision is exercised over inspectional assistants.

**ILLUSTRATIVE EXAMPLES OF WORK:** Plans, assigns and supervises work programs of inspectional assistants and clerks in the division. Reviews applications and related plans for permits to install air pollution devices and mechanical equipment for ventilating, air conditioning and refrigeration apparatus or equipment to insure conformity with the Building Code. Investigates complaints from the public and suggests methods for correction. Confers with superior on difficult cases.

**NECESSARY KNOWLEDGES, SKILLS AND ABILITIES:** Thorough knowledge of Building Code regulations pertaining to air pollution, air conditioning, refrigeration and ventilation installations. Thorough knowledge of the methods, materials and techniques of the air conditioning, refrigeration and ventilation trades at the journeyman level. Ability in locating defects and hazards in new and existing installations. Skill in conducting various tests and in reading and interpreting plans and specifications for heating systems, high pressure boilers, fuel consuming and allied installations for conformity with air pollution requirements of the Building Code. Ability to successfully meet contractors, property owners and the general public and to establish effective working relationships.

**QUALIFICATIONS REQUIRED FOR APPOINTMENT:** Graduation from a standard high school or a technical school preferably supplemented with completion of courses in one of the following fields: mechanical installations relating to air pollution, ventilating, air conditioning and refrigeration.

**USUAL LINE OF PROMOTION: FROM: AIR POLLUTION AND MECHANICAL EQUIPMENT INSPECTOR I**

**TO: AIR POLLUTION AND MECHANICAL EQUIPMENT INSPECTOR III**

## AIR POLLUTION AND MECHANICAL EQUIPMENT INSPECTOR I

CLASS TITLE: AIR POLLUTION AND MECHANICAL EQUIPMENT INSPECTOR I

CLASS DEFINITION: Performance of responsible inspectional work as required by the specifications of the Building Code pertaining to the Air Pollution and Mechanical Equipment Division.

DISTINGUISHING FEATURES OF WORK: Under the supervision of superiors carries out general inspection work in the field covering new and existing air pollution mechanical devices and mechanical equipment apparatus relating to air conditioning refrigeration and ventilation to insure conformity with the Building Code and established standards. When deemed necessary, advice and assistance is available from a superior in difficult cases. Work is assigned by a superior and all inspectional reports shall be submitted in written form.

EXAMPLES OF WORK: (Note: The following examples of work are only illustrative of the kind of work to be performed by persons of this class and are not intended to be all inclusive or exclusive.) Inspects new and existing installations of air conditioning refrigeration and ventilation, apparatus and equipment in all types of buildings and other structures to insure conformity with the Building Code regulating such installations. Check plans and specifications of proposed installations of air conditioning, refrigeration and ventilation. Submits reports of violations and issues written or verbal orders for correction of same.

NECESSARY KNOWLEDGES, SKILLS AND ABILITIES: Thorough knowledge of Building Code regulations pertaining to air conditioning, refrigeration and ventilation installations. Thorough knowledge of the methods, materials and techniques of the air conditioning, refrigeration and ventilation trades at the journeyman level. Ability in locating defects and hazards in new and existing installations. Ability to successfully meet contractors, property owners and the general public and to establish effective working relationships.

QUALIFICATIONS REQUIRED FOR APPOINTMENT: Graduation from a standard high school or trade school. Considerable experience in one of the following fields: mechanical installations relating to air pollution, ventilating, air conditioning and refrigeration.

USUAL LINE OF PROMOTION: TO: AIR POLLUTION AND MECHANICAL EQUIPMENT INSPECTOR II