

NOT PASSED  
O'Connor?  
P.R.A.?  
P. Saffey?

## PETITION TO THE CITY COUNCIL

TO THE HONORABLE CITY COUNCIL OF THE CITY OF PROVIDENCE:

*The undersigned respectfully petitions your honorable body*

PETITION FOR ABANDONMENT OF CRARY STREET (PORTION)

Rhode Island Hospital, a corporation organized by the General Assembly of the State of Rhode Island, and having its principal place of business in the City of Providence, in said state, respectfully represents:

FIRST: That your petitioner is the owner in fee of all of the land bordering southwesterly on the portion of Crary Street that is sought to be abandoned, the same being approximately one (1) city block in length running from the westerly line of Eddy Street to the southerly line of Borden Street as extended by a suitable arc. Said portion of Crary Street sought to be abandoned is shown with its four corners marked A, B, C, and D, respectively, on the attached drawing.

SECOND: Your petitioner is informed and believes that the lands lying northeasterly of that portion of Crary Street sought to be abandoned are owned by the State of Rhode Island being a portion of Interstate Route 95, so called.

THIRD: That the portion of Crary Street sought to be abandoned has been closed to all vehicular traffic for more than one (1) year and has ceased to be useful to the public.

FOURTH: That in the event this Honorable City Council shall see fit to abandon said Crary Street, your petitioner hereby agrees to waive any and all rights to receive compensation from the City of Providence for damages sustained by it by reason of such abandonment and will exonerate and hold harmless said City of Providence from all legal damages, if any, caused to any other person or persons whatsoever and for which said City is or may become legally liable by or on account of such abandonment.

FIFTH: That your petitioner will devote and develop said

PROVIDENCE R. I.  
 P. W. DEPT. ENGINEERING OFFICE  
 CITY PROPERTY SECTION  
 Plan No. 064256  
 Date November 1, 1983

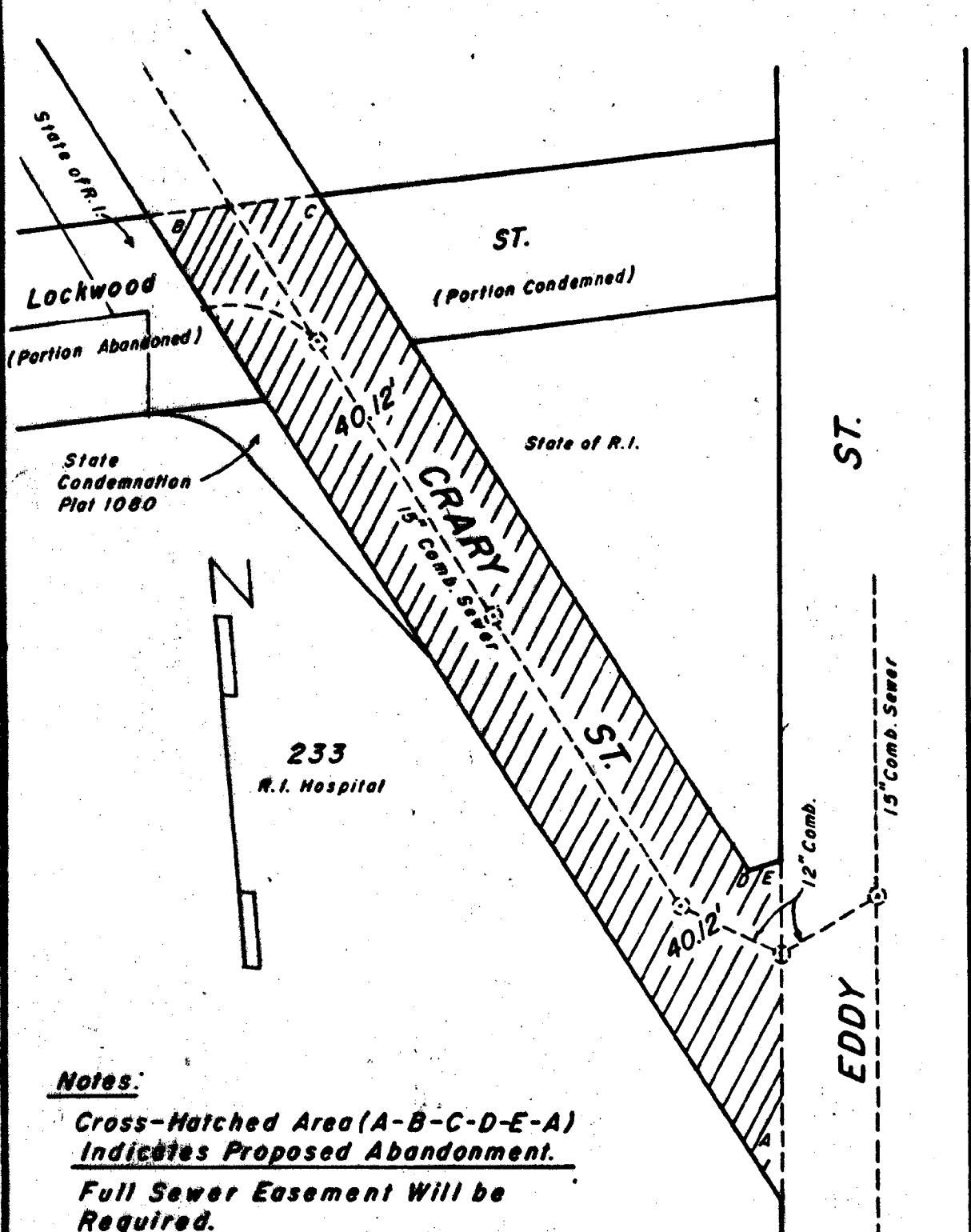

**Notes:**

Cross-Hatched Area (A-B-C-D-E-A)  
Indicates Proposed Abandonment.  
Full Sewer Easement Will be  
Required.

CITY OF PROVIDENCE, R. I.  
 Public Works Dept. Engineering Office  
 Showing Proposed Abandonment of  
Cray St. (Portion)  
 Drawn by J.A.M. Checked by L.D.A.  
 Scale 1"=40' Date 11-1-83  
 Corrected by [Signature] Associate Engr.  
 Approver D.H. MacLennan Chief Engineer

Lot Numbers From Assessor's Plat 22

**CITY OF PROVIDENCE**  
STATE OF RHODE ISLAND AND PROVIDENCE PLANTATIONS

**PETITION TO THE CITY COUNCIL**

TO THE HONORABLE CITY COUNCIL OF THE CITY OF PROVIDENCE

*The undersigned respectfully petitions your honorable body*

portion of Crary Street only for parking and will grant easements  
for all present utilities in and over said street.

RHODE ISLAND HOSPITAL

October , 1983

By

*Lloyd L. Hughes*  
President

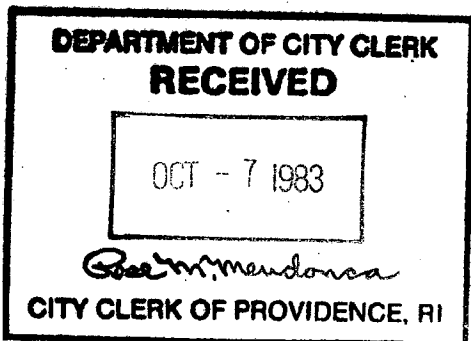

*Pol by Ch # 18433  
amt \$ 75.00  
Edwards + Angell*

IN CITY COUNCIL  
JAN 5 1984  
READ AND DENIED

*Rose M. Mendonca* CLERK

CITY CLERK OF PROVIDENCE, R.I.  
*Goodman*  
**RECEIVED**  
DEPARTMENT OF CITY CLERK

IN CITY COUNCIL  
OCT 20 1983  
FIRST READING  
REFERRED TO COMMITTEE ON PUBLIC WORKS

*Rose M. Mendonça* CLERK

THE COMMITTEE ON  
PUBLIC WORKS

Recommends

*Rose M. Mendonça*  
Clerk

SEND AND DELIVER

DEPT. OF CITY CLERK  
PROVIDENCE, R.I.

OCT 17 3 42 PM '83

FILED

*From the Clerk's Desk*

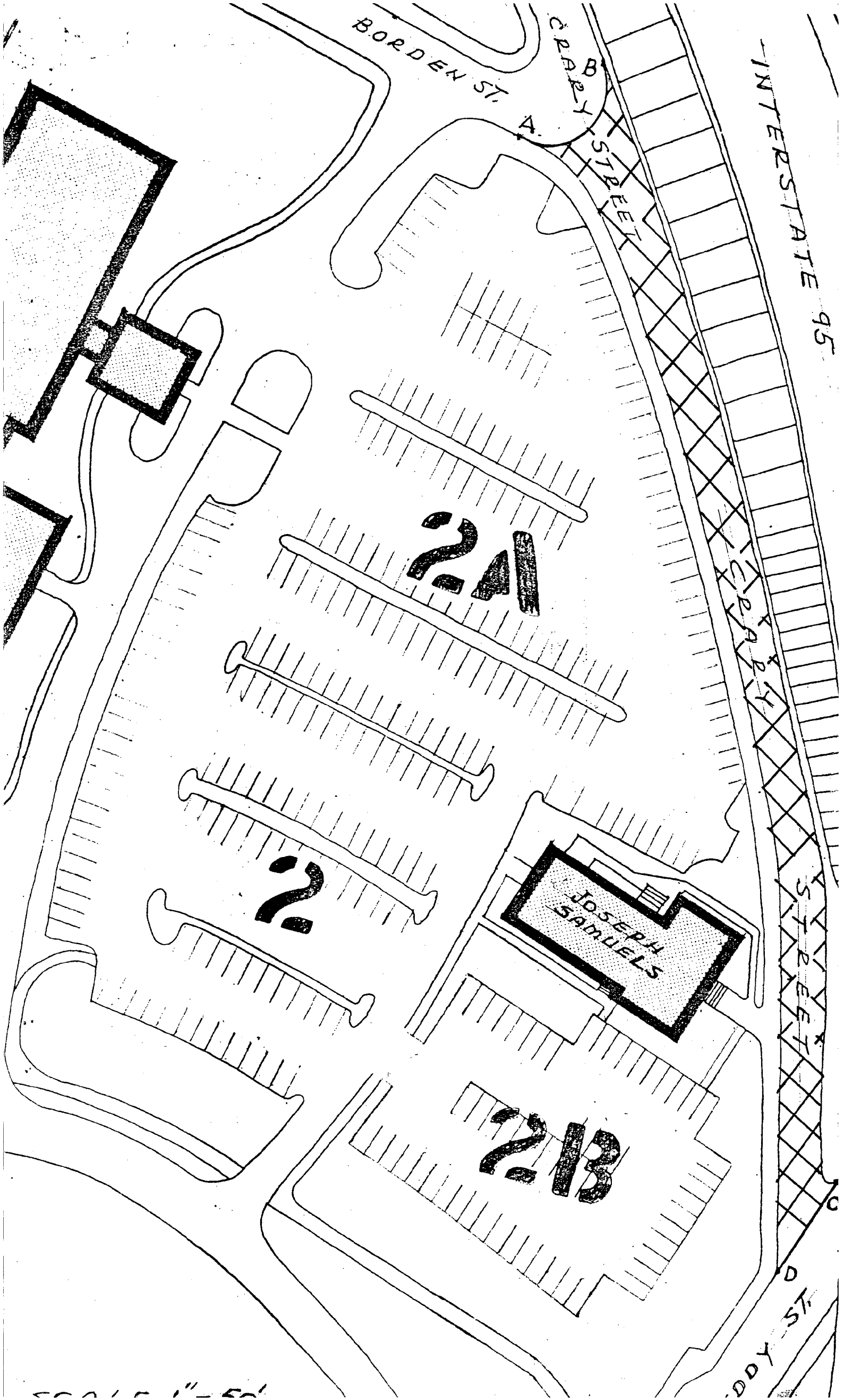

BORDEN ST. A.

CRAB STREET

INTERSTATE 95

STREET

ST.

JOSEPH  
SAMUELS

241

2

213

50' 1" = 50'

Proposed Abandonment of  
Cary St.

Plat 22

Lot 233

Rhode Island Hospital

593 Eddy Street

Providence, R. I. 02902

THE CITY OF PROVIDENCE

CITY SERGEANT'S OFFICE

**THIS IS TO CERTIFY**, That I have caused the notice, of which a true copy is hereto annexed, to be served upon the following named persons, by handing to each of said persons, or by leaving at their last and usual place of abode in this State a true copy of said notice, to wit: Petition of Rhode Island Hospital to abandon a portion of Crary Street, from approximately one city block in length running from the westerly line of Eddy Street to the southerly line of Borden Street.

<u>PLAT</u>	<u>LOT</u>	<u>NAME</u>	<u>ADDRESS</u>
22	233	Rhode Island Hospital	573 Eddy Street Providence, RI 02902

Councilman Thomas F. O'Connor, Jr.

  
Giacomo Martone  
City Sergeant

11/18/83

ENT ASSOCIATES, INC.  
100 DUDLEY STREET  
PROVIDENCE, RHODE ISLAND 02905

FRANCIS L. McNELIS, M. D.  
JOSEPH P. BELLINO, M. D.  
PETER T. NIGRI, M. D.  
ROBERT G. McRAE, M. D.

October 6, 1983

Mr. James A. Petrosinelli, Chairman  
Committee on Public Works  
c/o City Clerk's Office  
City Hall,  
Providence, Rhode Island 02901

Dear. Mr. Petrosinelli:

My name is Joseph P. Bellino. I am Ear, Nose and Throat surgeon located at 100 Dudley Street, a medical building on the corner of Dudley and Plain Streets in Providence. It is my understanding that that portion of Plain Street between Dudley and Borden is to be condemned at the request of Rhode Island Hospital for the relocation of the new Women & Infants Hospital. I would like to include in Rhode Island Hospital's condemnation request that segment of Plain Street between Dudley and Blackstone Street.

Dudley Street Associates, of which I am a partner, owns the property on both sides of this portion of Plain Street most of which is used for patient parking. As a result of this proposed condemnation, and the necessary rerouting of traffic, there will be increased congestion at this corner, and our patients will have to cross a very busy intersection from the parking lot in order to reach our medical building. We are presently in the process of expanding our facility, and are adding two more floors. This will increase the number of patients coming to our building.

I believe our proposal is more in keeping with your overall plan for this area if this segment between Dudley and Blackstone Street is included.

Sincerely yours,

  
Joseph P. Bellino, M.D.

JPB/cah

cc: Mr. Guido Salvatore



City of Providence



Rhode Island

Department of City Clerk

**MEMORANDUM**

DATE: October 25, 1983

TO: Joseph DiSanto, Director of Public Works

SUBJECT: Crary Street, Abandonment

CONSIDERED BY: Committee On Public Works

DISPOSITION:

Attached are copies of the above subject matter for your study and report back in writing, along with a list of abutting property owners, and tracing of the said area.

*oh*

First Deputy City Clerk

City of Providence



Rhode Island

Department of City Clerk

**MEMORANDUM**

DATE: October 25, 1983

TO: Wiley Archer, Chief of Water Supply Board

SUBJECT: Crary Street, Abandonment

CONSIDERED BY: Committee On Public Works

DISPOSITION:

Attached are copies of the subject matter for your study  
and report back in writing to the said committee.

*ok*

First Deputy City Clerk

City of Providence



Rhode Island

Department of City Clerk

**MEMORANDUM**

DATE: October 25, 1983

TO: Stanley Bernstein, Director of Planning and Urban Development

SUBJECT: Crary Street Abandonment-Portion

CONSIDERED BY: Committee On Public Works

DISPOSITION: Attached are copies of the subject matter for your study and report, back in writing to the said committee.

?

*Michael R. Clement*  
First Deputy City Clerk

City of Providence



Rhode Island

Department of City Clerk

**MEMORANDUM**

DATE: October 25, 1983

TO: Frank Tibaldi, Traffic Engineer

SUBJECT: Crary Street, Abandonment

CONSIDERED BY: Committee On Public Works

DISPOSITION:

Attached are copies of the subject matter for your study  
and report back in writing to the said committee.

*oh*

First Deputy City Clerk

City of Providence



Rhode Island

Department of City Clerk

**MEMORANDUM**

DATE: October 25, 1983

TO: Sanford H. Gorodetsky, Commissioner of Public Safety

SUBJECT: Crary Street, Abandonment

CONSIDERED BY: Committee On Public Works

DISPOSITION:

Attached are copies of the subject matter for your study and report back in writing to the said committee.

First Deputy City Clerk

RICHARD A. CARROLL  
Chairman  
JOSEPH G. FORMICOLA  
Vice Chairman  
MARY A. NOCERA  
Member  
ARMANDO PARILLO  
Member  
EVELYN V. FARGNOLI  
Councilwoman  
ANDREW J. ANNALDO  
Councilman  
JEROME I. BARON  
Ex-Officio

## WATER SUPPLY BOARD



CITY OF PROVIDENCE

WILEY J. ARCHER, P.E.  
Chief Engineer/General Manager  
WILLIAM J. MCGAIR  
Legal Advisor  
JAMES A. LOMBARDI  
Secretary

October 31, 1983

Councilman James Petrosinelli, Chairman  
Committee on Public Works  
City Clerk's Office, City Hall  
Providence, Rhode Island

Dear Councilman Petrosinelli:

This department received a memorandum and a copy of a petition for the abandonment of a portion of Crary Street (Service Road No. 1) from Borden Street to Eddy Street.

The Water Supply Board has a 20-inch feeder water main in Crary Street, running from Borden Street to Eddy Street. This 20-inch feeder main cannot be eliminated as it serves a significant portion of the Rhode Island Hospital general and fire supplies.

The Water Supply Board will accept a permanent easement equivalent to the present street width and length. This area must be accessible to us at all times for any repair work necessary and also include no installations of any permanent type buildings or facilities that could obstruct access.

If you desire additional information, please advise.

Very truly yours,

Wiley J. Archer, P.E.  
Chief Engineer/General Manager

ms

cc: Mr. Edward Bondarevskis, WSB  
Mr. James Lombardi, Controller

FILED

Nov 2 10 19 AM '83

DEPT. OF CLERK  
PROVIDENCE, R.I.

These documents are to be  
of the Department of  
MS

RECEIVED  
NOV 2 1983

NOV 2 1983

These documents are to be

of the Department of  
These documents are to be  
of the Department of

These documents are to be

of the Department of  
These documents are to be  
of the Department of

These documents are to be

of the Department of  
These documents are to be  
of the Department of

These documents are to be

These documents are to be

of the Department of

These documents are to be

of the Department of

NOV 2 1983

FRANK A. TIBALDI  
TRAFFIC ENGINEER



VINCENT A. CIANCI, JR.  
MAYOR

## DEPARTMENT OF TRAFFIC ENGINEERING

November 1, 1983

Committee on Public Works  
City Hall  
Providence, Rhode Island

Gentlemen:

The Traffic Engineering Department has received the following petition from your Committee and has taken the subsequent action:

Request: To abandon a portion of Crary Street.

Disposition: No objection.

Very truly yours,

A handwritten signature in cursive script, reading "Frank A. Tibaldi".

Frank A. Tibaldi  
Traffic Engineer

FAT/it



FILED

Nov 2 10 19 AM '83

DEPT. OF CLERK  
PROVIDENCE, R. I.



# The City Plan Commission

40 FOUNTAIN STREET

PROVIDENCE, RHODE ISLAND 02903

November 18, 1983

Committee on Public Works  
c/o City Clerk  
City Hall  
Providence, Rhode Island 02903

Attention: Rose M. Mendonca, City Clerk

Subject: Referral No. 2110 - Abandonment of Southern Portion  
of Crary St.

Gentlemen:

The subject referral was presented to the City Plan Commission at its November 2, 1983 meeting.

The City Plan Commission did not vote on this referral due to lack of a quorum, however this Department has reviewed the subject referral.

A communication was received from the Committee on Public Works dated October 25, 1983, proposing the abandonment of the southern portion of Crary Street between Borden and Eddy Sts. The petition was submitted by Mr. Lloyd L. Hughes, President of Rhode Island Hospital.

A field inspection revealed that the subject portion of Crary Street is a paved public right-of-way with sidewalks. The subject portion of Crary Street has a width of 30 feet and a length of approximately 450 feet. The State of Rhode Island recently widened the Interstate Route 95 by constructing a new retaining concrete wall following the easterly curb line of aforesaid portion of Crary Street for approximately 200 feet. The remaining portion of Crary Street is separated from the State owned land by a wire fence.

The entire subject portion of Crary Street was recently refurbished with a new sidewalk on the western side and a new street base. The street is presently closed to all vehicular traffic pending a final resurfacing.

Crary Street provides an important link between Plain Street and Eddy Street and serves besides R. I. Hospital, several industrial properties located along Borden and Crary Streets.

Considering a potential increase of the traffic volume around Rhode Island Hospital and additional traffic obstacles caused by the abandonment of a portion of Plain Street for the planned

page 2 - Referral No. 2110

construction of Women & Infants Hospital, it is important from the planning point of view to maintain vehicular traffic movement around the R.I. Hospital area.

Therefore, this Department recommends that this petition be denied.

Sincerely yours,

  
Stanley Bernstein  
Director

SB/cd

FILED

Nov 28 2 22 PM '83

DEPT. OF CITY CLERK  
PROVIDENCE, R.I.

SANFORD H. GORODETSKY  
COMMISSIONER



VINCENT A. CIANCI, JR.  
MAYOR

## DEPARTMENT OF PUBLIC SAFETY

November 22, 1983

The Honorable City Council  
City Hall  
Providence, Rhode Island

Att: Committee on  
Public Works

Gentlemen:

The Department of Public Safety has no objection to the proposed abandonment of a portion of Crary Street. It is advised, however, that if the proposal becomes effective, Clay Street, the loop that joins Crary Street with Borden Street, be made wider to accomodate fire apparatus.

Respectfully submitted,

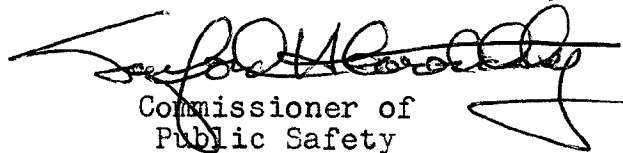
  
Commissioner of  
Public Safety

lr

Enc:

FILED

NOV 23 2 15 PM '83

DEPT. OF JUSTICE  
PROVIDENCE, R.I.

## PETITION TO THE CITY COUNCIL

TO THE HONORABLE CITY COUNCIL OF THE CITY OF PROVIDENCE:

*The undersigned respectfully petitions your honorable body*

PETITION FOR ABANDONMENT OF CRARY STREET (PORTION)

Rhode Island Hospital, a corporation organized by the General Assembly of the State of Rhode Island, and having its principal place of business in the City of Providence, in said state, respectfully represents:

FIRST: That your petitioner is the owner in fee of all of the land bordering southwesterly on the portion of Crary Street that is sought to be abandoned, the same being approximately one (1) city block in length running from the westerly line of Eddy Street to the southerly line of Borden Street as extended by a suitable arc. Said portion of Crary Street sought to be abandoned is shown with its four corners marked A, B, C, and D, respectively, on the attached drawing.

SECOND: Your petitioner is informed and believes that the lands lying northeasterly of that portion of Crary Street sought to be abandoned are owned by the State of Rhode Island being a portion of Interstate Route 95, so called.

THIRD: That the portion of Crary Street sought to be abandoned has been closed to all vehicular traffic for more than one (1) year and has ceased to be useful to the public.

FOURTH: That in the event this Honorable City Council shall see fit to abandon said Crary Street, your petitioner hereby agrees to waive any and all rights to receive compensation from the City of Providence for damages sustained by it by reason of such abandonment and will exonerate and hold harmless said City of Providence from all legal damages, if any, caused to any other person or persons whatsoever and for which said City is or may become legally liable by or on account of such abandonment.

FIFTH: That your petitioner will devote and develop said

**CITY OF PROVIDENCE**  
STATE OF RHODE ISLAND AND PROVIDENCE PLANTATIONS

**PETITION TO THE CITY COUNCIL**

TO THE HONORABLE CITY COUNCIL OF THE CITY OF PROVIDENCE:

*The undersigned respectfully petitions your honorable body*

portion of Crary Street only for parking and will grant easements  
for all present utilities in and over said street.

RHODE ISLAND HOSPITAL

October , 1983

By

*Lloyd L. Hughes*  
President

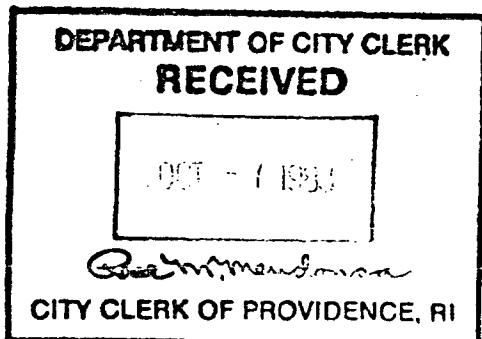

*Pol by Ch # 18433*

*Am't \$ 75.00*

*Edwards + Angell*



INTERSTATE 95

STREET

0.5 ST

CRAZY STREET

BORDEN ST.

JOSEPH SAMUELS

2A

2

2B

Councilman  
THOMAS F. O'CONNOR, JR.  
166 Dudley Street 02905



## City of Providence, Rhode Island

November 30, 1983

### COMMITTEES

Urban Redevelopment,  
Renewal and Planning  
Chairman

Public Works

Port Commission

James A. Petrosinelli, Chairman  
Public Works Committee  
City Hall  
Providence, Rhode Island 02903

RE: ABANDONMENT OF PORTION OF CRARY STREET AND ADDITIONAL  
REQUEST TO ABANDON PORTION OF PLAIN STREET, BETWEEN  
DUDLEY AND BLACKSTONE STREETS.

Dear Jim,

I have reviewed the request of Rhode Island Hospital to abandon a portion of Crary Street and find the petition to be lacking pertinent specifics, i.e., The reason for the difference in maps submitted delineating that portion to be abandoned.

In addition, the City Plan Commission review and recommendation is to retain as a public highway. I find their argument has merit.

Contained within the petition is also a request by a Joseph Bellino on behalf of ENT Associates asking that a portion of Plain Street between Dudley Street and Blackstone Street be abandoned.

I am adamantly opposed to such abandonment of any additional portions of Plain Street and suggest this not be given any consideration, as it would be against the wishes of the Community.

A portion of Plain Street has been approved for abandonment in conjunction with the move of Women & Infants Hospital to the area. This was a reluctant move, but one which was deemed necessary to accommodate the Hospitals plan and has since received criticism which I think is justified. This argues against any further intrusion into the residential neighborhood and precludes any further abandonments for expansion of the hospital or hospital related services.

I am requesting that the petition of Rhode Island Hospital be denied on the basis of what has been presented.

Thanking you for your cooperation in this matter, I am

Sincerely,

Councilman Thomas F. O'Connor, Jr.  
Ward 11



**COUNCILMAN**  
**THOMAS F. O'CONNOR, JR.**  
166 Dudley Street  
Providence, Rhode Island 02905

Councilman James A. Petrosinelli  
Chairman - Committee on Public Works

---

FILED  
DEC 2 2 12 PM '63  
U.S. DEPT. OF JUSTICE  
RECORDS SECTION

November 30, 1983

James A. Petrosinelli, Chairman  
Public Works Committee  
City Hall  
Providence, Rhode Island 02903

RE: ABANDONMENT OF PORTION OF CRARY STREET AND ADDITIONAL  
REQUEST TO ABANDON PORTION OF PLAIN STREET, BETWEEN  
DUDLEY AND BLACKSTONE STREETS.

Dear Jim,

I have reviewed the request of Rhode Island Hospital to abandon a portion of Crary Street and find the petition to be lacking pertinent specifics, i.e. The reason for the difference in maps submitted delineating that portion to be abandoned.

In addition the City Plan Commission review and recommendation is to retain as a public highway. I find their argument has merit.

Contained within the petition is also a request by a Joseph Bellino on behalf of ENT Associates asking that a portion of Plain Street between Dudley Street and Blackstone Street be abandoned.

I am adamantly opposed to such abandonment of any additional portions of Plain Street and suggest this not be given any consideration, as it would be against the wishes of the Community.

A portion of Plain Street has been approved for abandonment in conjunction with the move of Women & Infants Hospital to the area. This was a reluctant move, but one which was deemed necessary to accommodate the Hospital's plan and has since received criticism which I think is justified. This argues against any further intrusion into the residential neighborhood and precludes any further abandonments for expansion of the hospital or hospital related services.

I am requesting that the petition of Rhode Island Hospital be denied on the basis of what has been presented.

Thanking you for your cooperation in this matter, I am

Sincerely,

EDWARDS & ANGELL

Counsellors at Law

One Hospital Trust Plaza  
Providence, Rhode Island 02903  
401 274-9200  
Telex 952001 "E A PVD"  
Telecopier 401 276-6611

BY COURIER

December 6, 1983

Mrs. Rose M. Mendonca  
City Clerk  
City of Providence  
Providence City Hall  
Providence, Rhode Island

Dear Mrs. Mendonca:

Re: Petition for Abandonment  
of Crary Street (portion)

On behalf of our client, Rhode Island Hospital, we filed on October 7, 1983 a street abandonment petition as noted above. We are advised that the matter is to be the subject of a public hearing in the near future.

We have been instructed by our client to withdraw the petition. Accordingly, we request that the same be either marked withdrawn or denied without prejudice whichever is most appropriate as we wish to preserve our client's options.

Thank you for your assistance.

Very truly yours,

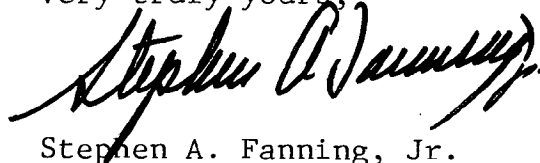

Stephen A. Fanning, Jr.

375 Park Avenue  
Suite 3409  
New York, NY 10152  
212 308-4411  
Telecopier 212 308-4844

250 Royal Palm Way  
P.O. Box 2621  
Palm Beach, Florida 33480  
305 833-7700  
Telecopier 305 655-8719

One Boston Place  
Suite 3920  
Boston, Massachusetts 02108  
617 720-3440  
Telecopier 617 720-0645

SAF

EDWARDS & ANGELL

FILED

DEC 6 12

DEPT. OF CITY CLERK  
PROVIDENCE, R.I.

Mrs. Rose M. Mendonca  
City Clerk  
City of Providence  
Providence City Hall  
Providence, Rhode Island

BY COURIER

One Hospital Trust Plaza  
Providence, Rhode Island 02903

*request  
mine receives this*

ENT ASSOCIATES, INC.  
100 DUDLEY STREET  
PROVIDENCE, RHODE ISLAND 02905

FRANCIS L. McNELIS, M. D.  
JOSEPH P. BELLINO, M. D.  
PETER T. NIGHI, M. D.  
ROBERT G. McRAE, M. D.

October 6, 1983

Mr. James A. Petrosinelli, Chairman  
Committee on Public Works  
c/o City Clerk's Office  
City Hall,  
Providence, Rhode Island 02901

Dear. Mr. Petrosinelli:

My name is Joseph P. Bellino. I am Ear, Nose and Throat surgeon located at 100 Dudley Street, a medical building on the corner of Dudley and Plain Streets in Providence. It is my understanding that that portion of Plain Street between Dudley and Borden is to be condemned at the request of Rhode Island Hospital for the relocation of the new Women & Infants Hospital. I would like to include in Rhode Island Hospital's condemnation request that segment of Plain Street between Dudley and Blackstone Street.

Dudley Street Associates, of which I am a partner, owns the property on both sides of this portion of Plain Street most of which is used for patient parking. As a result of this proposed condemnation, and the necessary rerouting of traffic, there will be increased congestion at this corner, and our patients will have to cross a very busy intersection from the parking lot in order to reach our medical building. We are presently in the process of expanding our facility, and are adding two more floors. This will increase the number of patients coming to our building.

I believe our proposal is more in keeping with your overall plan for this area if this segment between Dudley and Blackstone Street is included.

Sincerely, yours,

  
Joseph P. Bellino, M.D.

JPB/cah

cc: Mr. Guido Salvatore



