

THE CITY OF PROVIDENCE
STATE OF RHODE ISLAND AND PROVIDENCE PLANTATIONS

RESOLUTION OF THE CITY COUNCIL

No. 653

Approved August 15, 1975

Alfred Resequino
City Clerk
Approved
August 15, 1975
COMMITTEE ON
STREETS

RESOLVED, DECREED, AND ORDERED:

That the following portion named highway shown as crosshatched area on the accompanying Plan entitled "Providence, R. I., P. W. Dept. - Engineering Office, Street Line Section Plan No. 063930, Date: June 24, 1975,

Viz:

Washington Avenue, a portion of Washington Avenue, on City Assessor's Plat 56 from the Easterly Line of Michigan Avenue to the Termination Point of Washington Avenue, having ceased to be useful to the public and the same is abandoned as a public highway and the damage to the abutters is appraised at nothing and so awarded, and it is further

ORDERED, that the Director of Public Works, be and he is hereby directed to cause a sign to be placed on the above-named highway abandoned as aforesaid, having thereon the words "Not a Public Highway", and it is further

ORDERED, that after the entry of this order or decree, the City Clerk shall cause a notice, thereof, to be published in a newspaper published in the County of Providence at least once a week for three successive weeks, and a further and personal notice shall be served by the City Sergeant upon every owner of land abutting the above-named highway which has been abandoned, who is known to reside within this State.

IN CITY COUNCIL
AUG 17 1975

READ AND PASSED

Ralph Fernald, PRES.
ACTING
Clerk
Clerk

Approved
Maurice Cianci

RECEIVED (in order)

July 29, 1975

**THE COMMITTEE ON
PUBLIC WORKS**

**Approves Passage of
The Within Resolution**

Vincent Crespo
July 29, 1975 *Chair*

CITY OF PROVIDENCE
STATE OF RHODE ISLAND AND PROVIDENCE PLANTATIONS

PETITION TO THE CITY COUNCIL

TO THE HONORABLE CITY COUNCIL OF THE CITY OF PROVIDENCE:

The undersigned respectfully petitions your honorable body

for abandonment of that portion of Washington Avenue on Tax Assessor's Plat 56 from the easterly line of Michigan Avenue to the termination point of Washington Avenue approximately three hundred ninety (390) feet center line distance all as shown on accompanying plan. Said portion of Washington Avenue is abutted on each side by land of the petitioner and is rendered useless as a public right of way.

David Friedman

By his Attorney

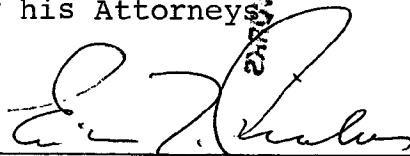

Tillinghast, Collins & Graham
2000 Hospital Trust Tower
Providence, Rhode Island

June 13, 1975

Ch. no. 8157
pd. 6/13/75
\$35.00

FILED
JUN 13 2 29 PM '75
DEPT. OF CITY CLERK
PROVIDENCE, R.I.

274-3800

IN CITY COUNCIL

JUN 19 1975
FIRST READING

REFERRED TO COMMITTEE ON

PUBLIC WORKS

Vincent Vespe
CLERK

Councilman Johnson

and
Councilman McKeenan

by Request

City of Providence



Rhode Island

Department of City Clerk

MEMORANDUM

DATE: June 20, 1973

TO: *

SUBJECT: WASHINGTON AVENUE - ADJACENTMENT OF A PORTION

CONSIDERED BY: Committee on Public Works

DISPOSITION: Attached is copy of petition of above subject
for study and report.

*
Acting Commissioner Cionci

✓ Director of Public Works Hesly

✓ Deputy Director of Planning & Urban Development Cornotain

Chief Engineer Rogers

✓ Traffic Engineer Tabaldi

Ernest Leape

City Clerk

NAME AND
ADDRESS
OF SENDER

Indicate type of mail

☐ INSURED ☐ C. O. D.

☐ CERTIFIED

Affix stamp here if issued as
certificate of mailing or for
additional copies of this bill.

POSTMARK AND DATE OF RECEIPT

NUMBER OF ARTICLE	NAME OF ADDRESSEE, STREET, AND POST-OFFICE ADDRESS	POSTAGE	FEE	DUE SENDER IF C. O. D.	ENDORSE- MENT ¹	R. R. FEE	S. D. FEE	S. H. FEE ²	RESTRICTED DELIVERY FEE REMARKS
1	33181	Penn Central Transportation Co							
2		6 Penn Central Plaza Phil, PA.							
3	33182	Claude Di Jesus & Wf. Amelia							
4		1156 Las Pulgas Place							
5		Pacific Palisades, Calif.							
6									
7									
8									
9									
10									
11									
12									
13									
14									
15									
16									
17									
18									
19									
20									
TOTAL NUMBER OF PIECES LISTED BY SENDER		TOTAL NUMBER OF PIECES RECEIVED AT POST OFFICE	POSTMASTER, PER (Name of receiving employee)		¹ Mark "F" if "Fragile," "P" if "Perishable," "E" if "Eggs," "EH" if "Eggs for Hatching," "B" if "Butter," "FL" if "Fragile-Liquid," and "FLU" if "Fragile-Liquid-This Side Up." ² Special-handling charges apply only to fourth-class parcels. Special-delivery service also includes special-handling service.				

POD Form 3877-A—July 1958



CITY OF PROVIDENCE, RHODE ISLAND
MAYOR VINCENT A. CIANCI, JR.

DEPARTMENT OF PUBLIC WORKS . 700 ALLENS AVENUE . 02905

Daniel E. Healy, Director

Joseph J. Campo, Deputy Director

June 30, 1975

Chairman of the Public Works Committee
Providence City Council
City Hall - Prov., R.I. 02903

RE: Abandonment of Portion of Washington Avenue

Dear Sir:

The Department of Public Works has no objections to the abandonment of Washington Avenue from the easterly line of Michigan Avenue to its easterly termination point on Washington Avenue, approximately three hundred ninety (390') feet center line distance.

Sincerely,

A handwritten signature in cursive script that reads "Daniel E. Healy".

- Daniel E. Healy -
Director of Public Works

DEH:JJC:jlc

City of Providence



Rhode Island

Department of City Clerk

MEMORANDUM

DATE: June 20, 1975

TO: *

SUBJECT: WASHINGTON AVENUE - ADBANDONMENT OF A PORTION

CONSIDERED BY: Committee on Public Works

DISPOSITION: Attached is copy of petition of above subject
for study and report.

*
Acting Commissioner Cianci

✓ Director of Public Works Healy

Deputy Director of Planning & Urban Development Bernstein

Chief Engineer Rogers

Traffic Engineer Tabaldi

No objection

Lincoln

City Clerk

JUN 25 1975
2:00 PM

POD Form 3877-A—July 1958

NAME AND ADDRESS OF SENDER		Indicate type of mail <input type="checkbox"/> INSURED <input type="checkbox"/> C. O. D. <input type="checkbox"/> CERTIFIED		Affix stamp here if issued as certificate of mailing or for additional copies of this bill. POSTMARK AND DATE OF RECEIPT							
NUMBER OF ARTICLE		NAME OF ADDRESSEE, STREET, AND POST-OFFICE ADDRESS		POSTAGE	FEE	DUE SENDER IF C. O. D.	ENDORSE- MENT ¹	R. R. FEE	S. D. FEE	S. H. FEE ²	RESTRICTED DELIVERY FEE REMARKS
1	33181	Penn Cental Transportation Co									
2		6 Penn Cental Plaza Phil. PA.									
3	33182	Claude Digesu & Wf. Amelia									
4		1156 Las Pulgas Place									
5		Pacific Palisades, Calif.									
6											
7											
8											
9											
10											
11											
12											
13											
14											
15											
16											
17											
18											
19											
20											
TOTAL NUMBER OF PIECES LISTED BY SENDER		TOTAL NUMBER OF PIECES RECEIVED AT POST OFFICE		POSTMASTER, PER (Name of receiving employee)		¹ Mark "F" if "Fragile," "P" if "Perishable," "E" if "Eggs," "EH" if "Eggs for Hatching," "B" if "Butter," "FL" if "Fragile-Liquid," and "FLU" if "Fragile-Liquid—This Side Up." ² Special-handling charges apply only to fourth-class parcels. Special-delivery service also includes special-handling service.					



CITY OF PROVIDENCE, RHODE ISLAND
MAYOR VINCENT A. CIANCI, JR.

DEPARTMENT OF PUBLIC WORKS . 700 ALLENS AVENUE . 02905

Daniel E. Healy, Director

Joseph J. Campo, Deputy Director

June 30, 1975

Chairman of the Public Works Committee
Providence City Council
City Hall - Prov., R.I. 02903

RE: Abandonment of Portion of Washington Avenue

Dear Sir:

The Department of Public Works has no objections to the abandonment of Washington Avenue from the easterly line of Michigan Avenue to its easterly termination point on Washington Avenue, approximately three hundred ninety (390') feet center line distance.

Sincerely,

A handwritten signature in cursive script that reads "Daniel E. Healy".

- Daniel E. Healy -
Director of Public Works

DEH:JJC:jlc

City of Providence



Rhode Island

Department of City Clerk

MEMORANDUM

DATE: June 20, 1975

TO: *

SUBJECT: WASHINGTON AVENUE - ADBANDONMENT OF A PORTION

CONSIDERED BY: Committee on Public Works

DISPOSITION: Attached is copy of petition of above subject
for study and report.

*
Acting Commissioner Cianci

✓ Director of Public Works Healy

Deputy Director of Planning & Urban Development Bernstein

Chief Engineer Rogers

Traffic Engineer Tabaldi

No Disposition

L. Vincent Caspica

City Clerk

JUN 25 1975
L. Vincent Caspica

CITY OF PROVIDENCE
STATE OF RHODE ISLAND AND PROVIDENCE PLANTATIONS

PETITION TO THE CITY COUNCIL

TO THE HONORABLE CITY COUNCIL OF THE CITY OF PROVIDENCE:

The undersigned respectfully petitions your honorable body
for abandonment of that portion of Washington Avenue on Tax
Assessor's Plat 56 from the easterly line of Michigan Avenue
to the termination point of Washington Avenue approximately
three hundred ninety (390) feet center line distance all as
shown on accompanying plan. Said portion of Washington Avenue
is abutted on each side by land of the petitioner and is
rendered useless as a public right of way.

David Friedman

By his Attorneys,

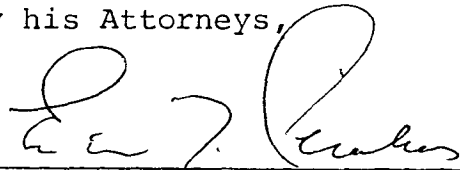
A handwritten signature in dark ink, appearing to be "L. E. Collins", written over a horizontal line.

Tillinghast, Collins & Graham
2000 Hospital Trust Tower
Providence, Rhode Island

June 13, 1975

FRANK A. TIBALDI
TRAFFIC ENGINEER
JAMES J. D'AGOSTINO
ASSISTANT TRAFFIC ENGINEER



VINCENT A. CIANCI, JR.
MAYOR

TRAFFIC ENGINEERING DEPARTMENT

60 ERNEST ST.

PROVIDENCE, R. I. 02905

781 - 4044

June 25, 1975

The Honorable City Council
Committee on Public Works
City Hall
Providence, Rhode Island

RE: Memorandum - dated 6/20/75
Washington Avenue - abandonment

Gentlemen:

The Traffic Engineering Department has received the following petition from your Committee and has taken the subsequent action:

Request: Abandonment of that portion of Washington Avenue on Tax Assessor's Plat 56 from the easterly line of Michigan Avenue to the termination point of Washington Avenue approximately 390 feet center line distance all as shown on accompanying plan. Said portion of Washington Avenue is abutted on each side by land of the petitioner is rendered unless as a public right of way.

Disposition: No objection.

Very truly yours,

A handwritten signature in cursive script, reading "Frank A. Tibaldi".
Frank A. Tibaldi
Traffic Engineer

FAT/it



VINCENT A. CIANCI, JR.
MAYOR

DEPARTMENT OF PLANNING AND URBAN DEVELOPMENT
40 FOUNTAIN ST. • PROVIDENCE, R. I. 02903 • TEL. 401-831-6550

July 21, 1975

Committee on Public Works
City Hall
Providence, R. I. 02903

SUBJECT: REFERRAL NO. 1932 - ABANDONMENT PORTION WASHINGTON AVE.

Gentlemen:

This petition from the Providence City Council Committee on Public Works proposes the abandonment of that portion of Washington Ave. on Assessor's Plat 56 from the easterly line of Michigan Ave. running easterly to the termination point of Washington Ave. This section has a centerline length of approximately 390 ft. Said portion of Washington Ave. is abutted on each side by land owned by the petitioner (lots 286, 298, 301 and 302) who maintains that it is useless as a public right-of-way.

Inspection revealed that the portion of highway in question comes to a dead end on railroad property which has access via Shipyard St. and is fenced off at its point of abutment with Washington Ave. The section proposed for abandonment is not open to the public as a highway.

This department has no objection from a planning standpoint to the proposed abandonment.

Upon motion of Mr. Casey seconded by Mr. Souza

The Commission

VOTED: To offer no objection to the proposed abandonment.

Very truly yours,

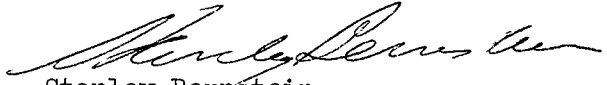
Stanley Bernstein
Deputy Director

SB:ee

cc: Councilman Donald E. McKiernan
Councilman Harry A. Johnson

PROVIDENCE, R. I.
 P. W. DEPT. - ENGINEERING OFFICE
 STREET LINE SECTION
 Plan No. 063930
 Date June 24, 1975

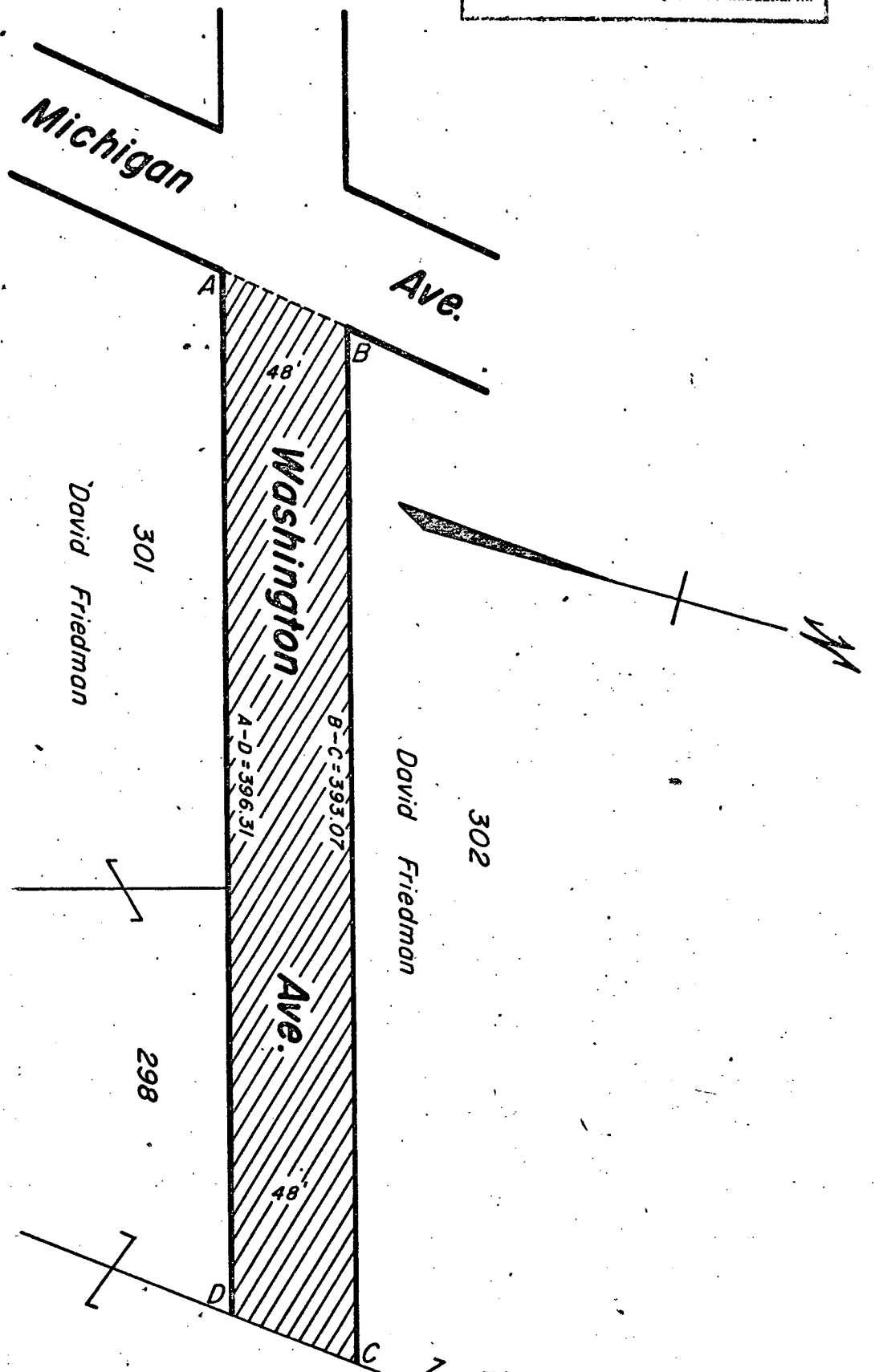

Note:

Cross-Hatched Area (A-B-C-D-A) Indicates
 Proposed Abandonment. 286

Lot Numbers From Assessor's Plat 56

CITY OF PROVIDENCE, R. I.
 Public Works Dept. - Engineering Office
 Showing Proposed Abandonment
 Drawn by Petrushko Checked by J.A.M.
 Scale 1"=60' Date June 24, 1975
 Corrected by J. J. Murphy Associate Engr.
 Approved Joseph J. Camp CHIEF ENGINEER

THE CITY OF PROVIDENCE

CITY SERGEANT'S OFFICE

THIS IS TO CERTIFY, That I have caused the notice, of which a true copy is hereto annexed, to be served upon the following named persons, by handing to each of said persons, or by leaving at their last and usual place of abode in this State a true copy of said notice, to wit: ABANDONMENT-WASHINGTON AVENUE (PORTION) ON CITY ASSESSORS' PLAT 56 FROM THE EASTERLY LINE OF MICHIGAN AVENUE TO THE TERMINATION POINT OF WASHINGTON AVENUE.

<u>PLAT</u>	<u>LOT</u>	<u>NAME AND ADDRESS</u>
56	298	David Friedman c/o 711 Associates, Inc. 711 Branch Avenue
56	301	"
56	302	"
56	286	"

Date

July 16, 1975

Councilman Donald E. McKiernan

Councilman Harry A. Johnson

This is to certify that I have caused a true copy of the attached Resolution to be served upon the above named persons, firms, and/or corporations, as the case may be, by handing to each said person, firm and/or corporation, as the case may be, or by leaving at their last usual place of abode in this state, a true copy,

Date

July 16, 1975

Richard Marton

City Sergeant

Mayor Vincent A. Cianci, Jr.
Acting Commissioner of Public
Safety

~~XXXXXXXXXXXX~~

~~XXXXXXXXXXXX~~



V. Vespa

LEONARD W. REILLY
ADMINISTRATIVE
ASSISTANT

COMMISSIONER OF PUBLIC SAFETY
209 FOUNTAIN ST., PROVIDENCE, RHODE ISLAND 02903

August 5, 1975

RECEIVED

AUG 6 1975

EXECUTIVE OFFICE

The Honorable City Council
City Hall
Providence, Rhode Island

Att: Committee on
Public Works

Gentlemen:

This office has no objection to the abandon-
ment of a portion of Washington Avenue as requested
in the attached petition to the City Council.

Respectfully submitted,

Vincent A. Cianci, Jr.
Mayor
Acting Commissioner of
Public Safety

lr

Enc:

CITY OF PROVIDENCE
STATE OF RHODE ISLAND AND PROVIDENCE PLANTATIONS

PETITION TO THE CITY COUNCIL

• TO THE HONORABLE CITY COUNCIL OF THE CITY OF PROVIDENCE:

The undersigned respectfully petitions your honorable body
for abandonment of that portion of Washington Avenue on Tax Assessor's Plat 56 from the easterly line of Michigan Avenue to the termination point of Washington Avenue approximately three hundred ninety (390) feet center line distance all as shown on accompanying plan. Said portion of Washington Avenue is abutted on each side by land of the petitioner and is rendered useless as a public right of way.

David Friedman

By his Attorneys,

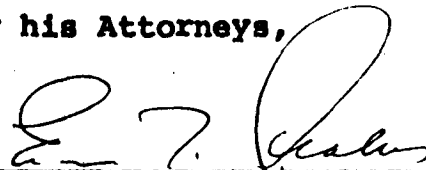

Tillinghast, Collins & Graham
2000 Hospital Trust Tower
Providence, Rhode Island

June 13, 1975

From : Batt. Chief Joseph R. Hull BC 2D

I can foresee no problems with the above listed abandonment for the Providence Fire Dept.

Respectfully

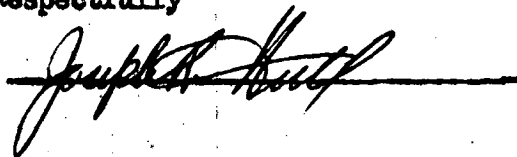

AFFIDAVIT OF PUBLICATION

THE PROVIDENCE DAILY JOURNAL THE EVENING BULLETIN
THE PROVIDENCE SUNDAY JOURNAL

Published by THE PROVIDENCE JOURNAL COMPANY
Providence, Rhode Island

State of Rhode Island
City and County of Providence

THE CITY OF PROVIDENCE
STATE OF RHODE ISLAND
AND PROVIDENCE PLANTATIONS
RESOLUTION OF THE
CITY COUNCIL
No. 653

Approved August 15, 1975
RESOLVED, DECREED, AND OR-
DERED:

That the following portion named
highway shown as crosshatched area
on the accompanying Plan entitled
"Providence, R.I., P.W. Dept. —
Engineering Office, Street Line
Section Plan No. 063930, Date: June
24, 1975,

Viz:

Washington Avenue, a portion of
Washington Avenue, on City Asses-
sor's Plat 56 from the Easterly Line
of Michigan Avenue to the Termina-
tion Point of Washington Avenue,
having ceased to be useful to the
public and the same is abandoned as
a public highway and the damage to
the abutters is appraised at nothing
and so awarded, and it is further

ORDERED, that the Director of
Public Works, be and he is hereby
directed to cause a sign to be placed
on the above-named highway aban-
doned as aforesaid, having thereon
the words "Not a Public Highway",
and it is further

ORDERED, that after the entry of
this order or decree, the City Clerk
shall cause a notice, thereof, to be
published in a newspaper published
in the County of Providence at least
once a week for three successive
weeks, and a further and personal
notice shall be served by the City
Sergeant upon every owner of land
abutting the above-named highway
which has been abandoned, who is
known to reside within this State.

A true copy,
Attest
VINCENT VESPIA,
City Clerk

On this 2nd day of October 19 75,
before me, a Notary Public, duly qualified for said
County and State, personally appeared

Director of Classified Advertising

Stanley E. Amersbach

Manager in the office of The Providence

Journal Company, publishers of The Providence
Journal and Evening Bulletin

a newspaper published in the City of Providence by
The Providence Journal Company, who, on being
duly sworn, states on oath that the advertisement of
Resolution of City Council-No 653

a true copy of which is hereunto annexed, was duly
inserted in The Providence Journal
in its issues of

September 9, 16, 23, and 30th 19 75

Subscribed and sworn to before me this

2nd day of October

19 75

James M. Harvey
Notary Public.

LOT 286
DAVID FRIEDMAN

LOT 298 - DAVID FRIEDMAN

LOT 301 - DAVID FRIEDMAN

PROPOSED ABANDONMENT-
SECTION OF WASHINGTON AVE.

SCALE 1 IN. = 40 FT.

AVENUE

MICHIGAN

WASHINGTON AVE.

VERMONT AVE.

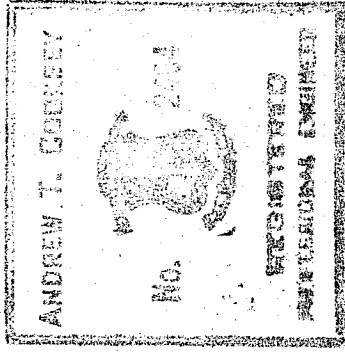

JUNE 9, 1975

REVISED JUNE 10 1975