

THE CITY OF PROVIDENCE

CITY SERGEANT'S OFFICE

**THIS IS TO CERTIFY**, That I have caused the notice, of which a true copy is hereto annexed, to be served upon the following named persons, by handing to each of said persons, or by leaving at their last and usual place of abode in this State a true copy of said notice, to wit: ABANDONMENT-PEARL STREET (PORTION) BEING AN AREA OF TWO HUNDRED TWENTY SQUARE FEET OR LESS ± SITUATED AT THE INTERSECTION OF WELLINGTON STREET.

<u>PLAT</u>	<u>LOT</u>	<u>NAME AND ADDRESS</u>
23	740	Rhode Island Hospital 593 Eddy Street
"	459	"
"	461	"

Date \_\_\_\_\_

Councilmen Ronald G. Henries and

Charles R. Mansolillo

This is to certify that I have caused a true copy of the attached Resolution to be served upon the above named persons, firms, and/or corporations, as the case may be, by handing to each said person, firm and/or corporation as the case may be, or by leaving at their last usual place of abode in this state, a true copy,

Date

4-17-35

Raymond R. Rouse

City Sergeant

PROVIDENCE, R. I.  
 P. W. DEPT. - ENGINEERING OFFICE  
 STREET LINE SECTION  
 Plan No. 063834  
 Date July 8, 1974

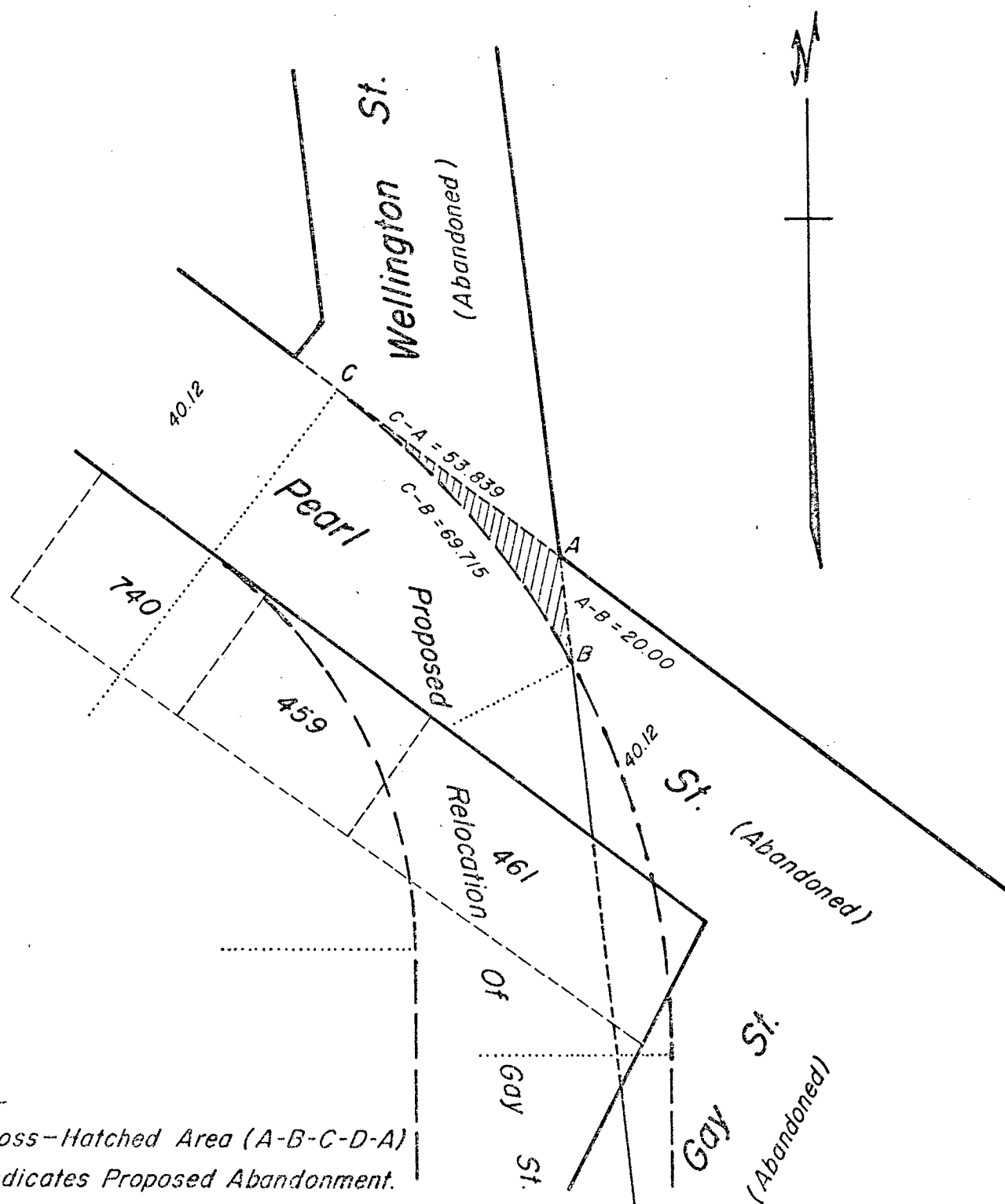

Note:

Cross-Hatched Area (A-B-C-D-A)  
 Indicates Proposed Abandonment.  
 Said Area Contains 220± Sq. Ft.

Lot Numbers From Assessor's Plat 23

766  
 H-47

CITY OF PROVIDENCE, R. I.  
 Public Works Dept. - Engineering Office  
 Showing Proposed Abandonment  
(Portion of Pearl St.)  
 Drawn by Petruska Checked by R.J.Q.  
 Scale 1" = 30' Date July 8, 1974  
 Corrected by J. J. Fung Associate Engr.  
 Approved [Signature] Chief Engineer

City of Providence



Rhode Island

Department of City Clerk

MEMORANDUM

DATE: August 7, 1974  
TO: Acting Commissioner Doorley, Director Pallozzi  
Chief Engineer Rogers and Traffic Engineer Tibaldi  
SUBJECT: Pearl Street, (portion)  
CONSIDERED BY: Committee on Public Works  
DISPOSITION: Attached is copy of Petition for study and written report.

*Ummert Casper*

City Clerk

JOHN A. DOHERTY, CHAIRMAN  
EARL H. ASHLEY  
UGO RICCIO  
JOHN J. TIERNEY  
RAYMOND COLA  
THOMAS L. PAYNE  
VINCENT T. IZZO, EX-OFFICIO

**WATER SUPPLY BOARD**  
CITY OF PROVIDENCE, R. I. 02908  
552 ACADEMY AVENUE

JOHN E. ROGERS  
CHIEF ENGINEER  
JAMES P. RYAN  
DEPUTY CHIEF ENGINEER  
JOHN T. WALSH  
LEGAL ADVISOR  
AUSTIN B. McMANUS  
SECRETARY

August 6, 1974

Councilman Thomas Payne, Chairman  
Committee on Public Works  
City Clerk's Office, City Hall  
Providence, Rhode Island

Dear Councilman Payne:

We received a memorandum from the City Clerk's office with regard to a petition requesting the proposed abandonment of a portion of Pearl Street, Providence, Rhode Island.

We have reviewed our distribution plans and find that we do not have facilities in this area of the proposed abandonment. We, therefore, offer no objection to the petition.

Very truly yours,

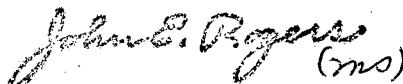
 (ms)

John E. Rogers, P.E.  
Chief Engineer

JER/ms

FRANK A. TIBALDI  
TRAFFIC ENGINEER



JOSEPH A. DOORLEY, JR  
MAYOR

## TRAFFIC ENGINEERING DEPARTMENT

60 ERNEST ST.

PROVIDENCE, R. I. 02905

781 - 4044

September 5, 1974

The Honorable City Council  
Committee on Public Works  
City Hall  
Providence, Rhode Island

Gentlemen:

The Traffic Engineering Department has received the following petition from your Committee and has taken the subsequent action:

Request: To abandon a portion of Pearl Street at the intersection of Wellington Street.

Disposition: No objection.

Very truly yours,

A handwritten signature in cursive script, reading "Frank A. Tibaldi".

Frank A. Tibaldi  
Traffic Engineer

FAT/it

Mayor Joseph A. Doorley, Jr.  
Acting Commissioner of Public  
Safety

~~FRANCIS EXETER~~  
~~COMMISSIONER~~



LEONARD W. REILLY  
ADMINISTRATIVE  
ASSISTANT

COMMISSIONER OF PUBLIC SAFETY  
209 FOUNTAIN ST., PROVIDENCE, RHODE ISLAND 02903

September 16, 1974

The Honorable City Council  
City Hall  
Providence, Rhode Island

Att: Committee on  
Public Works

Gentlemen:

This office has no objection to the abandon-  
ment of that portion of Pearl Street at Wellington  
Street as requested in a petition to the City  
Council.

Respectfully submitted,

*Joseph A. Doorley Jr.*  
Mayor  
Acting Commissioner of  
Public Safety

lr

THE CITY OF PROVIDENCE  
STATE OF RHODE ISLAND AND PROVIDENCE PLANTATIONS

# RESOLUTION OF THE CITY COUNCIL

No. 435

Approved May 21, 1975

THE CITY OF PROVIDENCE  
APPROVED  
The Mayor's Resolution  
Approved by the City Council

RESOLVED, DECREED AND ORDERED:

That the following named highway shown as shaded areas on the accompanying plan entitled "Providence, Rhode Island, Department of Public Works - Engineering Office, Street Line Section Map no. 063834, dated July 8, 1974",

viz:

Pearl Street (portion) at the intersection of Wellington Street as shown in Area (A-B-C-D-A), having ceased to be useful to the public and the same are abandoned as public highway and the damage to the abutters is appraised at nothing and so awarded, and it is further

ORDERED, That the Director of Public Works, be and he is hereby directed to cause a sign to be placed on the above-named highway abandoned as aforesaid, having thereon the words "Not a Public Highway," and it is further

ORDERED, That after the entry of this order or decree the City Clerk shall cause a notice thereof to be published in a newspaper published in the County of Providence at least once each week for three successive weeks and a further and personal notice shall be served by the City Sergeant upon every owner of land abutting the above-named highway which have been abandoned, who is known to reside within this State.

IN CITY COUNCIL  
MAY 15 1975

READ AND PASSED

*Robert J. Hayton*  
PRES.  
*Vincent C. Culpia*  
CLERK

APPROVED  
MAYOR

MAY 21 1975

*Vincent C. Culpia*

THE COMMITTEE ON  
*Public Works*  
Approves Passage of  
The Within Resolution

*Wm. W. Rogers*  
April 29, 1978 *Clerk*



**CITY OF PROVIDENCE**  
STATE OF RHODE ISLAND AND PROVIDENCE PLANTATIONS

**PETITION TO THE CITY COUNCIL**

**TO THE HONORABLE CITY COUNCIL OF THE CITY OF PROVIDENCE:**

*The undersigned respectfully petitions your honorable body*  
Abandon as a Public Highway Pearl Street (portion) at the intersection of Wellington Street.

Proposed Abandonment  
(Portion of Pearl Street)

That certain tract or parcel of land situated on Pearl Street at the intersection of Wellington Street in the City of Providence, R.I., shown as cross hatched area and designated by the letters A-B-C-A on the accompanying plan entitled, "Providence, R.I., P.W. Dept. Engineering Office, Street line Section, Plan no. 063834, Date July 8, 1974", bounded and described as follows:

Beginning at a point marked "A" on the accompanying plan said point being the former southeast intersection of Pearl Street and Wellington Street; thence southerly along the range of the former easterly street line of Wellington Street twenty (20.0') feet to a point on the arc of a curve in the proposed relocated Gay Street and point marked "B" on the accompanying plan thence in a generally westerly direction on a arc of a curve to the left sixty nine and 715/100 (69.715') feet to point marked "C" on the accompanying plan; thence southeasterly along the northerly line of Pearl Street fifty-three and 839/1000 (53.839') feet to point marked "A" on the accompanying plan; said point being point and place of beginning.

Said parcel herein described contains 220 ± square feet.

*Evelyn Lawrence*

IN CITY COUNCIL

AUG 1 1974  
FIRST READING

REFERRED TO COMMITTEE ON PUBLIC WORKS

Wm. H. Resnick  
CLERK

Councilman Lynch  
and Councilman Dargatzis,  
by request