

THE CITY OF PROVIDENCE
STATE OF RHODE ISLAND AND PROVIDENCE PLANTATIONS

RESOLUTION OF THE CITY COUNCIL

No. 350

Approved July 3, 1958

Resolved, DECREEED AND ORDERED,

That the portion of Joslin Street, from a point approximately 88 feet northeasterly from Manton Avenue, to Kossuth Street, shown as shaded area and designated by the letters A-B-C-D-E-F-G on the accompanying plan entitled, "Providence, R. I., P. W. Dept., Engineering Office, City Property Section, Plan No. 061717, Date May 14, 1958," has ceased to be useful to the public and the same is abandoned as a public highway and the damage to the abutters is appraised at nothing and so awarded, and it is further

ORDERED, That the Superintendent of Street Signs and Numbers be and he is hereby directed to cause a sign to be placed on part of Joslin Street, from a point approximately 88 feet northeasterly from Manton Avenue, to Kossuth Street, abandoned as aforesaid, having thereon the words, "Not a Public Highway", and it is further

ORDERED, That after the entry of this order or decree the City Clerk shall cause a notice thereof to be published in a newspaper published in the County of Providence, at least once each week for three successive weeks and a further and personal notice shall be served by the City Sergeant upon every owner of land abutting upon part of Joslin Street, from a point approximately 88 feet northeasterly from Manton Avenue, to Kossuth Street, which has been abandoned, who is known to reside within this State.

IN CITY COUNCIL

JUL 3 - 1958

READ and PASSED

W. A. Williams, Jr.
ACTING President
Devereux Whelan
Clerk

APPROVED

JUL 3 1958

Walter H. Reynolds
MAYOR

RESOLUTION
OF THE
CITY COUNCIL

CITY OF PROVIDENCE
STATE OF RHODE ISLAND AND PROVIDENCE PLANTATIONS

PETITION TO THE CITY COUNCIL

TO THE HONORABLE CITY COUNCIL OF THE CITY OF PROVIDENCE:

The undersigned respectfully petition your honorable body

To abandon as a public highway that portion of
Joslin Street from the southwesterly line of property of
the City of Providence, approximately 88 feet northeasterly
from Manton Avenue to Kossuth Street.

John P. Grain, Director of Recreation
James J. Foley, Asst. Supt. Schools

**IN CITY
COUNCIL**

MAY 1 - 1958

**FIRST READING
REFERRED TO COMMITTEE ON
PUBLIC WORKS
.....
DEWEATER, CLERK**

Recess Board adj. at 2:00 (by request)

The City of Providence — Legislative Department
CITY CLERK'S OFFICE—OFFICIAL MEMORANDUM

Providence, R. I., May 2, 1958

TO: Deputy Director of Public Works

SUBJECT: Joslin Street - abandonment of portion of

CONSIDERED BY: Committee on Public Works

ACTION TAKEN: VOTED: To refer attached petition for study, report
and recommendation.

Deverick Whelan
City Clerk

The City of Providence — Legislative Department

CITY CLERK'S OFFICE—OFFICIAL MEMORANDUM

Providence, R. I., May 2, 1958

TO: City Plan Commission

SUBJECT: Joslin Street - abandonment of portion of

CONSIDERED BY: Committee on Public Works.

ACTION TAKEN: VOTED: To refer attached petition for study, report
and recommendation.

Devereux Whelan
City Clerk



CITY OF PROVIDENCE • RHODE ISLAND • Walter H. Reynolds • Mayor

DEPARTMENT OF PUBLIC WORKS

Charles F. McElroy

Director

John E. Meade

Deputy Director

MAY 15, 1958.

CITY HALL

SUBJECT: PROPOSED ABANDONMENT OF THAT PORTION OF JOSLIN
STREET FROM THE SOUTHWESTERLY LINE OF PROPERTY
OF THE CITY OF PROVIDENCE TO KOSSUTH STREET.

MR. RALPH MATERA,
CHAIRMAN, PUBLIC WORKS COMMITTEE,
CITY HALL, PROVIDENCE, R. I.

DEAR SIR:

THE ABANDONMENT OF THIS SECTION OF JOSLIN STREET
IS NECESSARY TO THE USE OF JOSLIN STREET SCHOOL AND PLAYGROUND
AS PLANNED.

VERY TRULY YOURS,

JOHN E. MEADE

DEP. DIRECTOR OF PUBLIC WORKS.

JEM:MC.

FILED

MAY 15 4 46 PM '58

**CITY CLERK'S OFFICE
PROVIDENCE, R.I.**



City Plan Commission

EDWARD WINSOR, *Chairman*
JERRY LORENZO RALPH MATERA

WALTER H. REYNOLDS, *Mayor*
LUCIO E. CARLONE, *Secretary*

PAUL A. SAN SOUZI, *Vice Chairman*
RAYMOND J. NOTTAGE HARRY PINKERSON

FRANK H. MALLEY, *Director*
DIETER HAMMERSCHLAG, *Chief Planner*

*Suite 103, City Hall,
Providence 3, Rhode Island*

May 15, 1958

Committee on Public Works
City Hall
Providence, Rhode Island

SUBJECT: Referral No. 990 - ABANDONMENT OF PORTION OF JOSLIN STREET

Gentlemen:

The subject referral received consideration by the City Plan Commission at a meeting held on Tuesday, May 13, 1958.

This referral is a request to abandon a portion of Joslin Street from Manton Avenue to Kossuth Street.

The abandonment of this street will result in the elimination of the traffic between the swimming pool area and the playground, and the combination of these areas with the abandoned street area will form one unified recreation area which is in accordance with the recommendations in the MASTER PLAN FOR PLAYGROUNDS AND PLAYFIELDS.

The Commission

VOTED: To offer no objection to the granting of this petition.

Very truly yours,

FRANK H. MALLEY
DIRECTOR
CITY PLAN COMMISSION

FHM:MMH

c.c. Councilman John F. Brock
Councilman William D'Abate

THE CITY OF PROVIDENCE
CITY SERGEANT'S OFFICE

This is to Certify that I have caused the notice, of which a true copy is hereto annexed, to be served upon the following named persons, by handing to each of said persons, or by leaving at their last and usual place of abode in this State a true copy of said notice, to wit:- JOSLIN STREET, from the southwesterly line of property of the City of Providence, approximately eighty-eight (88) feet north-easterly from Manton Avenue to Kossuth St.

Abandonment as a public highway.

Plat 63

<u>Lot</u>	<u>Name</u>
226	City of Providence
255	"
337	"
354	"
371	"

Harry Corman
Dep City Sergeant

This is to certify that I have caused a true copy of the attached Resoltuion to be served upon the above named persons, firms and/or corporations, as the case may be, by handing to each said person, firm and/or corporation, as the case may be, or by leaving at their last and usual place of abode in this state, a true copy of said notice, to wit:

FROM PLAT 63
 CITY PROPERTY
 Plan No. **061717**
 Date **May 14, 1958**

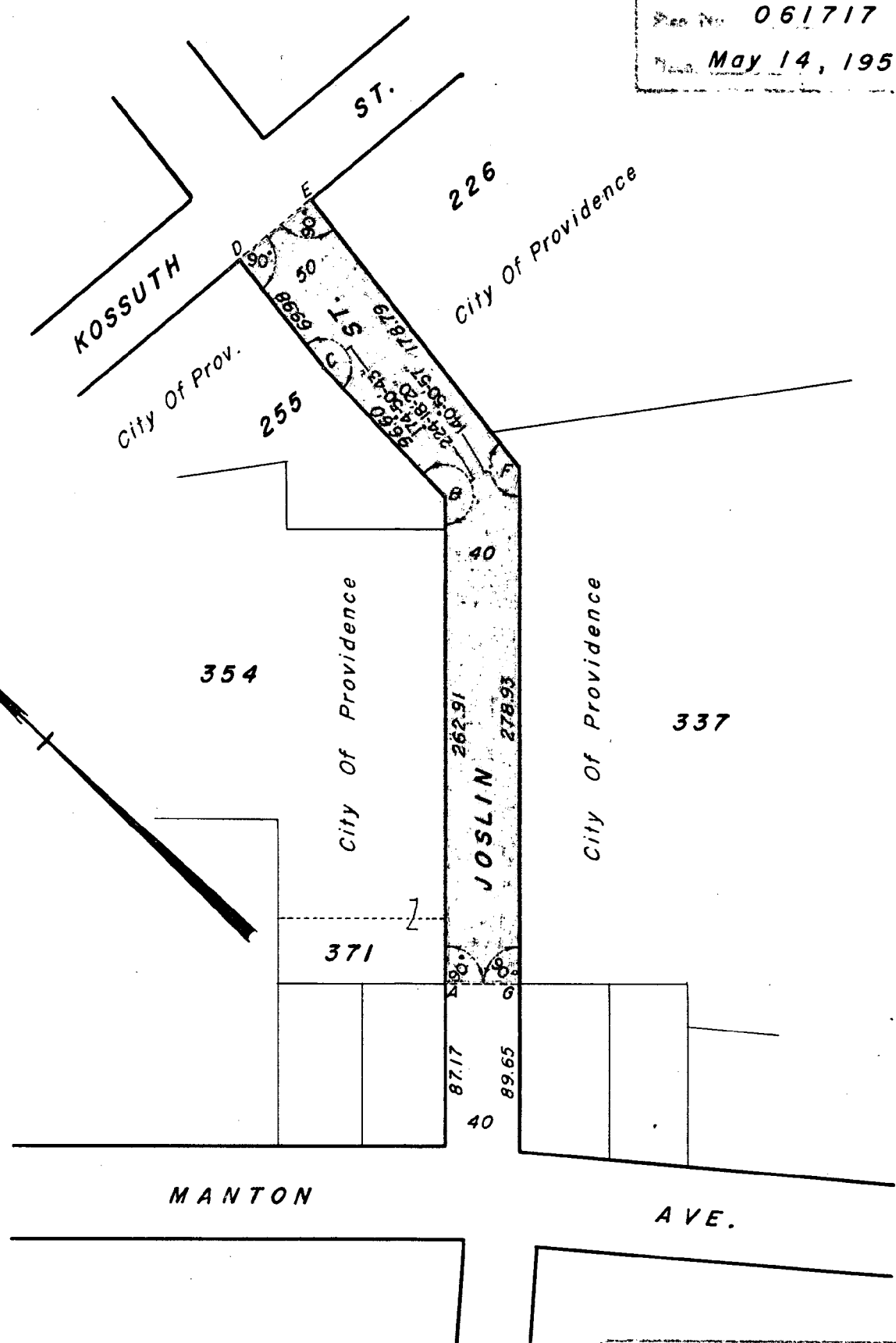

CITY OF PROVIDENCE, R. I.
 Public Works Dept. - Engineering Office
 Showing *Proposed Abandonment Of*
Portion Of Joslin St. Shaded Area- ABCDEF
 Drawn by L. R. Checked by E. A. K.
 Scale 1" = 80' Date May 14, '58
 Corrected by *Robert Small* Associate Engr.
 Approved by *Robert Small* Chief Engineer

Lot Numbers From Assessors Plat 63.

THE CITY OF PROVIDENCE
STATE OF RHODE ISLAND AND PROVIDENCE PLANTATIONS

RESOLUTION OF THE CITY COUNCIL

No. 361

Approved July 3, 1958

Resolved, DECREEED AND ORDERED,

That Asheville Avenue from Manton Avenue to its northeasterly termination as defined by the shaded area on the accompanying plan entitled, "Providence, R. I., P. W. Dept., Engineering Office, City Property Section, Plan No. 061573, Date March 25, 1957," has ceased to be useful to the public and the same is abandoned as a public highway and the damage to the abutters is appraised at nothing and so awarded, and it is further

ORDERED, That the Superintendent of Street Signs and Numbers be and he is hereby directed to cause a sign to be placed on part of Asheville Avenue, from Manton Avenue, to its northeasterly termination, abandoned as aforesaid, having thereon the words, "Not a Public Highway", and it is further

ORDERED, That after the entry of this order or decree the City Clerk shall cause a notice thereof to be published in a newspaper published in the County of Providence, at least once each week for three successive weeks and a further and personal notice shall be served by the City Sergeant upon every owner of land abutting upon part of Asheville Avenue from Manton Avenue, to its northeasterly termination, which has been abandoned, who is known to reside within this State.

IN CITY COUNCIL

JUL 3 - 1958

READ and PASSED

William A. Gray
ACTING President
David H. Whelan
Clerk

APPROVED

JUL 3 1958

Walter H. Reynolds
MAYOR

RESOLUTION
OF THE
CITY COUNCIL

PETITION TO THE CITY COUNCIL

TO THE HONORABLE CITY COUNCIL OF THE CITY OF PROVIDENCE:

~~undersigned~~

~~The undersigned respectfully petitions the Mayor and City Council for compensation for injuries or damages~~

~~estimated on~~

~~street on~~

~~19~~

The undersigned respectfully petitions your honorable body that they are the owners of an entire tract of land in the City of Providence, State of Rhode Island, composed of three separate parcels of land, designated and described as follows:

PARCEL I: That certain tract or parcel of land with all the buildings and improvements thereon situate on the northeasterly side of Manton Avenue in the City of Providence, State of Rhode Island, laid out and designated as Lot No. 42 on that plat entitled, "Dyerville Plat No. 2 Providence, R.I. April 1901 R. H. Tingley, Engr." a copy of which plat is recorded in the office of the Recorder of Deeds of the City of Providence on Plat Card 880.

Said lot is bounded and described as follows: Beginning at a point in the northeasterly line of Manton Avenue at its intersection with the southerly line of land now or lately of Celia B. Lopez and running thence southeasterly bounding southwesterly on said Manton Avenue thirteen and 77/100 (13.77) feet to an angle in said Avenue; thence turning an interior angle of $173^{\circ}42'$ and running southeasterly bounding southwesterly on said Manton Avenue one hundred fifty-six and 5/100 (156.05) feet to a strip of land laid out and designated as Ashville Avenue on said above mentioned plat, being other land of the undersigned; thence turning an interior angle of $50^{\circ}14'30''$ and running northeasterly bounding southeasterly on said last named land one hundred ten and 42/100 (110.42) feet to said Lopez land; thence turning an interior angle of $89^{\circ}40'30''$ and running westerly bounding northerly on said Lopez land one hundred twenty-nine and 5/10 (129.5) feet to said Manton Avenue and the point and place of beginning.

PARCEL II: That certain strip or parcel of land with all the buildings and improvements thereon situate on the northeasterly side of Manton Avenue in the City of Providence, State of Rhode Island, laid out and designated as Ashville Avenue on that plat entitled, "Dyerville Plat No. 2 Providence, R.I. April 1901 R. H. Tingley, Engr." a copy of which plat is recorded in the office of the Recorder of Deeds of the City of Providence on Plat Card 880.

Said strip is bounded and described as follows: Beginning at a granite bound set in the northeasterly line of Manton Avenue at the southwesterly corner of Lot No. 42 on said plat, being other land of the undersigned and running northeasterly bounding northwesterly on said Lot No. 42 one hundred ten and 42/100 (110.42) feet to a granite bound and land now or lately of Celia B. Lopez; thence turning and running southeasterly bounding northeasterly on said Lopez land forty (40) feet to Lot No. 43 on said plat, being other land of the undersigned; thence turning and running southwesterly bounding southeasterly in part on said Lot No. 43, in part on Lots No. 44 and 45 on said plat, being still other land of the undersigned, one hundred thirty-nine and 92/100 (139.92) feet to Manton Avenue; thence turning and running northwesterly bounding southwesterly on said Manton Avenue to said granite bound at the point and place of beginning.

PARCEL III: That certain tract or parcel of land with all the buildings and

CITY OF PROVIDENCE
STATE OF RHODE ISLAND AND PROVIDENCE PLANTATIONS

PETITION TO THE CITY COUNCIL

TO THE HONORABLE CITY COUNCIL OF THE CITY OF PROVIDENCE:

~~undersigned~~

~~The undersigned respectfully petitions the Mayor and City Council for compensation for injuries or damages~~

~~sustained on~~

~~street work~~

~~19~~

-2-

improvements thereon situate on the northeasterly side of Manton Avenue in the City of Providence, State of Rhode Island, bounded and described as follows:

Beginning at a point in the northeasterly line of Manton Avenue at its intersection with the southeasterly boundary line of Ashville Avenue, as laid out on the hereinafter mentioned plat, now being other land of the undersigned, and running thence northeasterly bounding northwesterly on said Ashville Avenue one hundred thirty-nine and 92/100 (139.92) feet to land now or lately of Celia B. Lopez; thence turning and running southeasterly bounding northeasterly on said Lopez land twenty-three and 5/10 (23.5) feet to an angle; thence continuing southeasterly bounding northeasterly in part on said Lopez land and in part on land now or lately of Andrea Mignanelli and wife, seventy-six and 5/10 (76.5) feet to land now or lately of Genarro Dillatorre and wife; thence turning and running southerly bounding easterly on said last named land forty-nine and 73/100 (49.73) feet to land now or lately of Danille Castantini and wife; thence turning and running in a straight line southwesterly bounding southeasterly on said last named land to Manton Avenue; thence turning and running northwesterly bounding southwesterly on said Manton Avenue sixty-one and 09/100 (61.09) feet to said Ashville Avenue and the point and place of beginning.

Said tract comprises the whole of Lots No. 43, 45 and portions of Lots No. 44 and 46 on that plat entitled, "Dyerville Plat No. 2 Providence, R. I. April 1901 R.H. Tingley, Engr." a copy of which plat is recorded in the office of the Recorder of Deeds of the City of Providence on Plat Card 880.

That the title of the undersigned therein is a title in fee simple subject only to the possibility that there is a highway, driftway, or gangway so called, across the same, in which the public or the City of Providence might have rights; that said highway, driftway, or gangway so-called, has long since ceased to be used, if it ever was used by the public and has for many years been used exclusively by the owners of land adjoining the same, with claim of full title to them, all of which land is now owned by the undersigned; that said highway, driftway or gangway, so-called, has ceased to be useful to the public.

That said highway is further described as Parcel ^{II}~~I~~ above mentioned, and described. However otherwise described, being the only highway, driftway or gangway, so-called, of any kind located in that tract of land above mentioned and described, as being composed of the aforementioned and described parcels of land, Parcel ~~I~~ ^{T.R.D.} Parcel ~~II~~ ^{III}.

WHEREFORE, the undersigned respectfully petition that this Honorable Body

COMMIT
IN CILA

-3-

JAN 31 1921

RECEIVED IN CILA

RECEIVED IN CILA

RECEIVED IN CILA

decree that said highway, driftway or gangway, so-called, described as Parcel II above, has ceased to be useful to the public and that it be abandoned as a public highway, driftway or gangway; and that notice of the pendency of this petition and of the action proposed herein be given in accordance with law.

JAN MOGIELNICKI, et ux, EVA MOGIELNICKI

By their Attorneys,

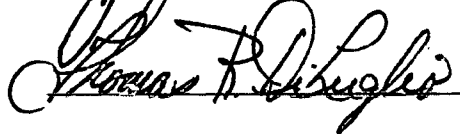
RECEIVED
CILA

JAN 31 1921

FILED

MAR 19 12 40 PM '57

**CITY CLERK'S OFFICE
PROVIDENCE, R.I.**

APR 11 1957

CITY OF PROVIDENCE, R.I.

RECEIVED

URGENT

TO THE CITY CLERK

FROM THE CITY CLERK

RE: [illegible]

**IN CITY
COUNCIL**

MAR 21 1957

**FIRST READING
REFERRED TO COMMITTEE ON
PUBLIC WORKS
The Mayor's Office**

*Mr. D. A. [illegible]
[illegible]*

The City of Providence — Legislative Department
CITY CLERK'S OFFICE—OFFICIAL MEMORANDUM

Providence, R. I., March 22, 1957

TO: Deputy Director of Public Works

SUBJECT: Petition for abandonment of Ashville Street

CONSIDERED BY: Committee on Public Works

**ACTION TAKEN: Voted: to refer for study, report, and recommendation attached
petition.**

City Clerk

The City of Providence — Leg Department

CITY CLERK'S OFFICE—OFFICIAL MEMORANDUM

March 22, 195.

Providence, R. I.,

TO: City Plan Commission

SUBJECT: Petition for abandonment of Ashville Street

CONSIDERED BY: Committee on Public Works

ACTION TAKEN: Voted: to refer for study, report, and recommendation attached
petition.

City Clerk



City Plan Commission

EDWARD WINSOR, *Chairman*
JERRY LORENZO RALPH MATERA

WALTER H. REYNOLDS, *Mayor*
LUCIO E. CARLONE, *Secretary*

PAUL A. SAN SOUZI, *Vice Chairman*
RAYMOND J. NOTTAGE HARRY PINKERSON

FRANK H. MALLEY, *Director*
DIETER HAMMERSCHLAG, *Senior Planner*
ANTHONY A. VERRECCHIA, *Senior Planner*

*Suite 103, City Hall,
Providence 3, Rhode Island
April 10, 1957*

Committee on Public Works
City Hall
Providence, R. I.

SUBJECT: REFERRAL NO. 879 - ABANDONMENT OF ASHVILLE STREET

Gentlemen:

The subject referral received consideration by the City Plan Commission at a meeting held on Tuesday, April 9, 1957.

This referral is a request for the abandonment of Ashville Street.

On the field trip it was found that the street in question bisects the property of the petitioner.

This is a paper street, and due to the terrain in this area it is unlikely that this street will be paved. As the abandonment of this street does not conflict with any present or contemplated City Plans,

The Commission

VOTED: To offer no objection to the granting of this petition.

Very truly yours,

FRANK H. MALLEY
DIRECTOR
CITY PLAN COMMISSION

FHM:MMH

c.c. Councilman John F. Brock
Councilman William D'Abate



CITY OF PROVIDENCE • RHODE ISLAND • Walter H. Reynolds • Mayor

DEPARTMENT OF PUBLIC WORKS

Charles F. McElroy
Director
John E. Meade
Deputy Director

September 11, 1957.

CITY HALL

Subject: Proposed Abandonment of Asheville Ave.

Mr. Ralph Matera,
Chairman
Public Works Committee,
City Hall, Providence, R. I.

Dear Sir:

Asheville Avenue was platted as a street
in 1901, but it is not used as a highway.

We have no objection to the abandonment
of the street.

Very truly yours,

John E. Meade
Dep. Director of Public Works.

JEM:MC.

FILED

SEP 19 2 23 PM '57

**CITY CLERK'S OFFICE
PROVIDENCE, R. I.**

12/12/57
Is clear
title

THE CITY OF PROVIDENCE
CITY SERGEANT'S OFFICE

y that I have caused the notice, of which a true copy is
d upon the following named persons, by handing to each of
at their last and usual place of abode in this State a true
ASHVILLE AVENUE, from Manton Avenue
northeasterly to its termination.

bandonment as a public highway.

11/15

will call you this afternoon
for another appointment

THOMAS R. DI LUGLIO
ATTORNEY AND COUNSELLOR AT LAW

TEMPLE 1-7772
RES. SCITUATE 1-3315

LAW OFFICES
619 INDUSTRIAL BANK BUILDING
PROVIDENCE, RHODE ISLAND

Address

ki & wf. Eva

605 Manton Avenue
"

Larry Arden
Dep City Sergeant

This is to certify that I have caused a true copy of the attached
Resolution to be served upon the above named persons, firms and /or
corporations, as the case may be, by handing to each said person, firm
and/or corporation, as the case may be, or by leaving at their last and
usual place of abode in this state, a true copy of said notice, to wit:

Bernard Patton
Dep City Sergeant

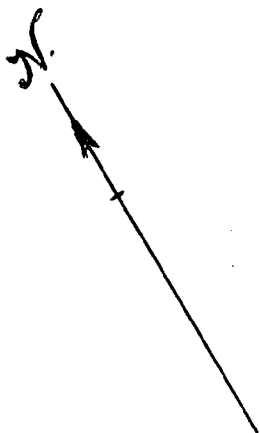

CITY OF PROVIDENCE

061573

Mar. 25, 1957

*Shaded area to be abandoned as a public highway
as laid out on that certain plat entitled "Dyerville Plat
No. 2, Providence, R. I. by R.H. Tingley, Eng'r. April 1901,"
and recorded on plat card 880 in the Recorder of
Deeds Office.*

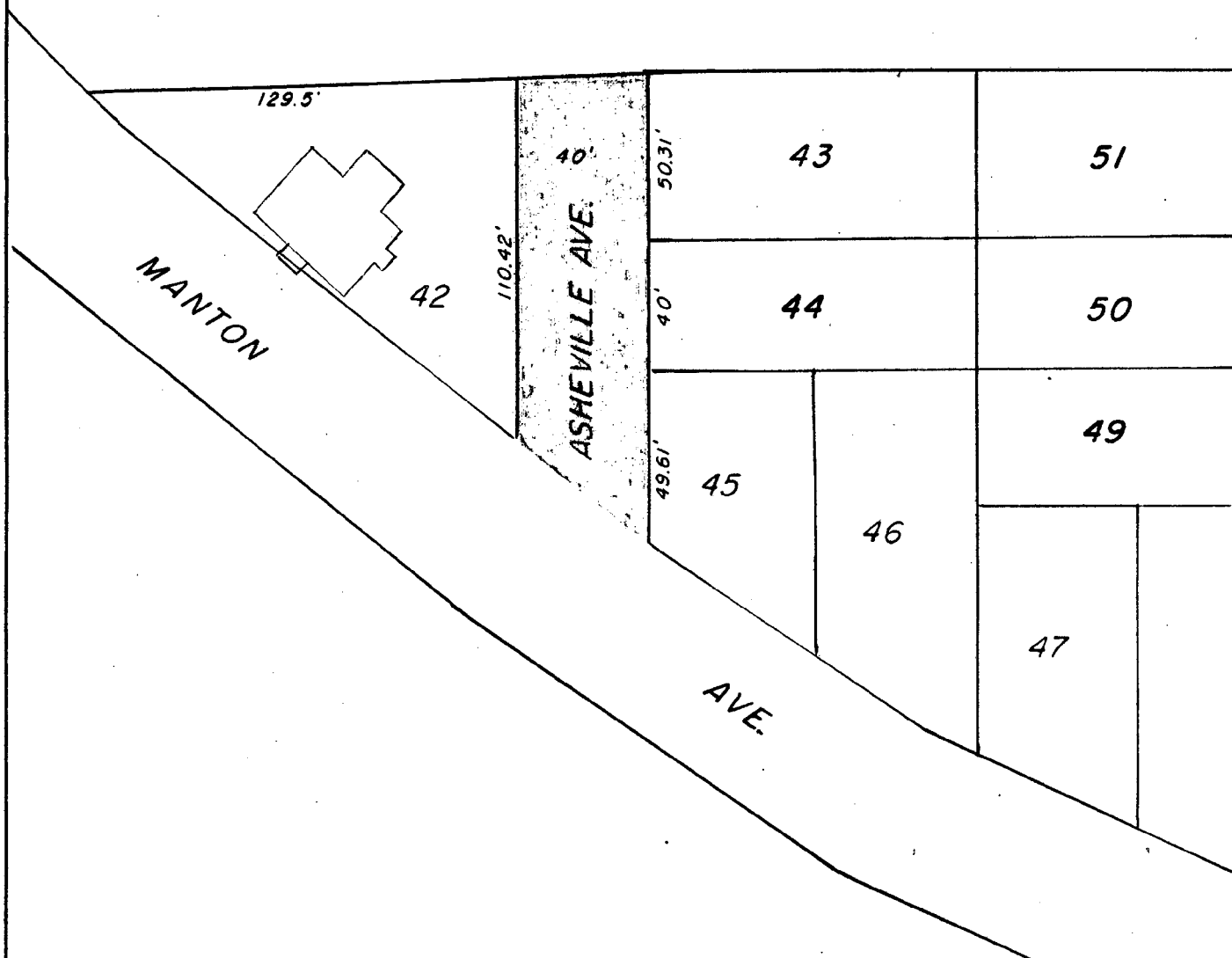

CITY OF PROVIDENCE
Public Works Department
Proposed Abandonment
of Asheville Avenue.
By E.A.K. City Engineer
Scale 1"=50' Date 3-25-57
Approved: *[Signature]*
Accepted: *[Signature]*

THE CITY OF PROVIDENCE
STATE OF RHODE ISLAND AND PROVIDENCE PLANTATIONS

RESOLUTION OF THE CITY COUNCIL

No. 362

Approved July 3, 1958

Resolved, DECREED AND ORDERED,

That

the portion of Maiden Lane, from Snow Street, easterly to the range of the westerly line of Moulton Street, as defined by the shaded area on the accompanying plan entitled, "Providence, R. I., P. W. Dept., Engineering Office, City Property Section, Plan No. 061710, Date April 25, 1958," has ceased to be useful to the public and the same is abandoned as a public highway and the damage to the abutters is appraised at nothing and so awarded, and it is further

ORDERED, That the Superintendent of Street Signs and Numbers be and he is hereby directed to cause a sign to be placed on part of Maiden Lane, from Snow Street, easterly to the range of the westerly line of Moulton Street, abandoned as aforesaid, having thereon the words, "Not a Public Highway", and it is further

ORDERED, That after the entry of this order or decree the City Clerk shall cause a notice thereof to be published in a newspaper published in the County of Providence, at least once each week for three successive weeks and a further and personal notice shall be served by the City Sergeant upon every owner of land abutting upon part of Maiden Lane, from Snow Street, easterly to the range of the westerly line of Moulton Street, which has been abandoned, who is known to reside within this State.

IN CITY COUNCIL

JUL 3 - 1958

READ and PASSED

Walter H. Reynolds
ACTING President
Deverett Whelan
Clerk

APPROVED

JUL 3 1958

Walter H. Reynolds
MAYOR

RESOLUTION
OF THE
CITY COUNCIL

CITY OF PROVIDENCE
STATE OF RHODE ISLAND AND PROVIDENCE PLANTATIONS

PETITION TO THE CITY COUNCIL

TO THE HONORABLE CITY COUNCIL OF THE CITY OF PROVIDENCE:

The undersigned respectfully petition your honorable body
to abandon as a Public Highway, Maiden Lane from Snow Street easterly to
the range of the westerly line of Moulton Street.

Remax Realty Company

James H. Legal Sec'y

RHODE ISLAND HOSPITAL

By *Sam C. Linn*
President

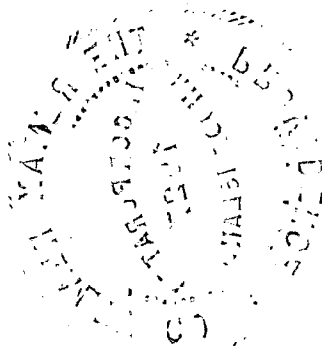

FILED

MAR 17 9 35 AM '58
CITY CLERK'S OFFICE
PROVIDENCE, R.I.

**IN CITY
COUNCIL**

MAR 20 1958

**FIRST READING
REFERRED TO COMMITTEE ON
PUBLIC WORKS
.....
The undersigned is a member of the**

*Meow Bayle & Gray
(City Engineer)*

The City of Providence — Legislative Department

CITY CLERK'S OFFICE—OFFICIAL MEMORANDUM

Providence, R. I., March 21, 1958

TO: Deputy Director of Public Works

SUBJECT: Maiden Lane from Snow Street easterly to the range of the
westerly line of Moulton Street.

CONSIDERED BY: Committee on Public Works

ACTION TAKEN: VOTED: To refer for study, report and recommendation
attached petition.

Devereux Whelan

City Clerk

The City of Providence — Legislative Department
CITY CLERK'S OFFICE—OFFICIAL MEMORANDUM

Providence, R. I., ~~March 21,~~ 1958

TO: City Plan Commission

SUBJECT: Maiden Lane from Snow Street easterly to the range of the
westerly line of Moulton Street.

CONSIDERED BY: Committee on Public Works

ACTION TAKEN: VOTED: To refer for study, report and recommendation
attached petition.

Devereux Whelan

City Clerk

THE CITY OF PROVIDENCE

WATER SUPPLY BOARD

JOHN A. DOHERTY, CHAIRMAN

EARL H. ASHLEY

UGO RICCIO

JOHN J. TIERNEY

MICHAEL N. CARDARELLI, EX-OFFICIO

552 ACADEMY AVENUE

PROVIDENCE 8, R. I.

PHILIP J. HOLTON, JR.

CHIEF ENGINEER

JOHN T. WALSH

LEGAL ADVISOR

March 21, 1958

Councilman Ralph Matera, Chairman
Public Works Committee
City Clerk's Office, City Hall
Providence, Rhode Island

Dear Councilman Matera:

On the docket of the City Council for Thursday, March 20th, is a petition of the Remax Realty Company and the Rhode Island Hospital to abandon as a public highway Maiden Lane from Snow St. easterly to the range of the westerly line of Moulton St.

In this portion of Maiden Lane, we have a section of 6" cast iron main laid in 1909 and a 4" cast iron service that supplies #158 Washington St., owned by the Remax Realty Company.

If this street is abandoned, the petitioner will have to reimburse this department for the depreciated value of our facilities, which total \$360.56. They also would have to pay for relocating the 4" service, which would have to be laid in Snow Street.

Yours very truly,

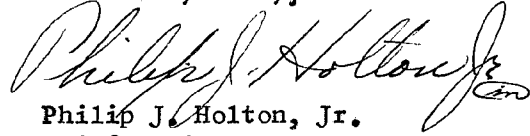
Philip J. Holton, Jr.
Chief Engineer

PJH/M

CC: W. P. Ingham, Div. Engr.

FILED

MAR 20 4 18 PM '58

CITY CLERK'S OFFICE
PROVIDENCE, R.I.



City Plan Commission

EDWARD WINSOR, *Chairman*
JERRY LORENZO RALPH MATERA

WALTER H. REYNOLDS, *Mayor*
LUCIO E. CARLONE, *Secretary*

PAUL A. SAN SOUZI, *Vice Chairman*
RAYMOND J. NOTTAGE HARRY PINKERSON

FRANK H. MALLEY, *Director*
DIETER HAMMERSCHLAG, *Chief Planner*

*Suite 103, City Hall,
Providence 3, Rhode Island*

April 24, 1958

Committee on Public Works
City Hall
Providence, Rhode Island

SUBJECT: Referral No. 981 - ABANDONMENT OF A PORTION OF MAIDEN
LANE

Gentlemen:

The subject referral received consideration by the City Plan Commission at a meeting held on April 22, 1958.

This referral is a request for the abandonment as a public highway a portion of Maiden Lane.

On the field trip it was found that the area in question is unpaved and lies between Snow Street and Mathewson Street.

The City Plan Commission is at present undertaking a Downtown Providence Master Plan Project. The area in question lies in the project area. Since the importance of some streets may be changed considerably by the Master Plan study,

The Commission

VOTED: To recommend that this request be denied until completion of the Project.

Very truly yours,

FRANK H. MALLEY
DIRECTOR
CITY PLAN COMMISSION

FHM:MMH

c.c. Councilman William A. Gray
Councilman Russell J. Boyle



CITY OF PROVIDENCE • RHODE ISLAND • Walter H. Reynolds • Mayor

DEPARTMENT OF PUBLIC WORKS

Charles F. McElroy
Director

MAY 15, 1958.

John E. Meade
Deputy Director.

CITY HALL

SUBJECT: PROPOSED ABANDONMENT OF MAIDEN LANE FROM
SNOW STREET TO THE RANGE OF THE WESTERLY
LINE OF MOULTON STREET.

MR. RALPH MATERA,
CHAIRMAN, PUBLIC WORKS COMMITTEE,
CITY HALL, PROVIDENCE, R. I.

DEAR SIR:

OUR RECORDS SHOW THIS SECTION OF MAIDEN LANE TO BE
A PLATTED STREET FOURTEEN (14) FEET IN WIDTH.

THIS SECTION OF THE STREET IS AND HAS BEEN USED
FOR A LONG PERIOD OF TIME FOR THE PARKING OF CARS AND AS
A LOADING ZONE FOR THE CITY HALL HARDWARE COMPANY AND IS
OF INSUFFICIENT WIDTH TO BE OF VALUE AS A PUBLIC HIGHWAY.

VERY TRULY YOURS,

John E. Meade
JOHN E. MEADE
DEP. DIRECTOR OF PUBLIC WORKS.

JEM:MC.

FILED

MAY 15 4 46 PM '58

**CITY CLERK'S OFFICE
PROVIDENCE, R.I.**

THE CITY OF PROVIDENCE

CITY SERGEANT'S OFFICE

This is to Certify that I have caused the notice, of which a true copy is hereto annexed, to be served upon the following named persons, by handing to each of said persons, or by leaving at their last and usual place of abode in this State a true copy of said notice, to wit:- MAIDEN LANE, from Snow Street easterly to the range of the westerly line of Moulton Street.

Abandonment as a public highway.

Plat 25

<u>Lot</u>	<u>Name</u>	<u>Address</u>
334	The Remax Realty Company	148 Washington Street
335	Rhode Island Hospital	593 Eddy Street

Harry Coleman
Dep City Sergeant

This is to certify that I have caused a true copy of the attached Resolution to be served upon the above named persons, firms and/ or corporations, as the case may be, by handing to each said person, firm and/or corporation, as the case may be, or by leaving at their last and usual place of abode in this state, a true copy of said notice, to wit:

Bernard Patton
Dep City Sergeant

July 1, 1958

Philip J. Holton, Jr.
Chief Engineer
Water Supply Board
552 Academy Avenue
Providence 8, R. I.

Dear Phil:

In accordance with your March 21, 1958 communication, addressed to the Committee on Public Works; enclosed is check number 10589 of the City Hall Hardware Company, in the amount of \$360.56 representing depreciation value of facilities in a portion of Haiden Lane.

In conferring with James Armstrong, their attorney, who attended a Public Hearing yesterday; in addition to requesting the above check, I informed him that a charge of approximately \$266.00 plus, whatever cost a private plumber might charge, will have to be paid by the abutting owners additionally.

Very sincerely yours,

Vincent Vespia

VV;ep

Enclosurer

PROVIDENCE, R. I.
 PUBLIC WORKS DEPT. - ENGINEERING OFFICE
 CITY PROPERTY SECTION
 Plan No. **061710**
 Date **April 25, 1958.**

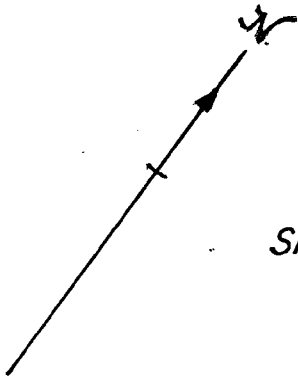

Shaded area to be abandoned.

Washington St.

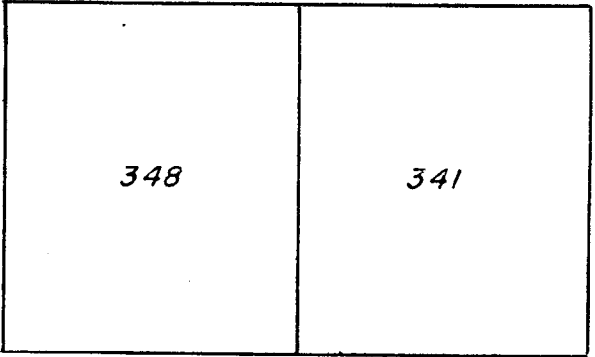
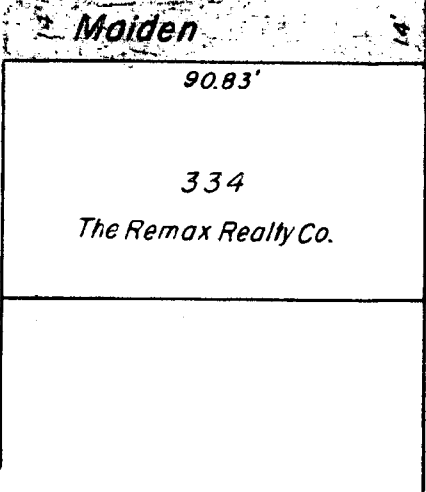
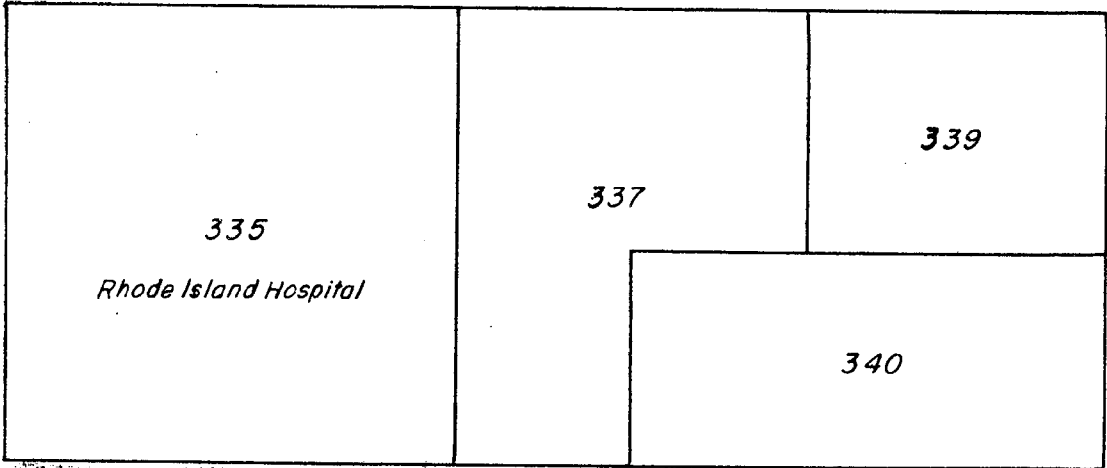

CITY OF PROVIDENCE, R. I.
 Public Works Dept. - Engineering Office
 Showing **Proposed Abandonment.**
 Drawn by **E.A.K.** Checked by **L.P.R.**
 Scale **1" = 40'** Date **4-25-58**
 Correct **L.P.R.** Associate Eng.
 Approved **[Signature]**
 CHIEF ENGINEER

Lot numbers from Assessor's Plat 25.

THE CITY OF PROVIDENCE
STATE OF RHODE ISLAND AND PROVIDENCE PLANTATIONS

RESOLUTION OF THE CITY COUNCIL

No. 363

Approved July 3, 1958

Resolved, DECREED AND ORDERED

That the grade of Argol Street from Nellie Street to Edgeworth Avenue be defined as delineated upon the plan and profile 054449 on file in Engineering Office of the Public Works Department and this day presented to the City Council.

IN CITY COUNCIL

JUL 3 - 1958

READ and PASSED

William A. Gray
ACTING President
Everett Whelan
Clerk

APPROVED

JUL 3 1958

Nathan H. Reynolds
MAYOR

RESOLUTION
OF THE
CITY COUNCIL

THE CITY OF PROVIDENCE
STATE OF RHODE ISLAND AND PROVIDENCE PLANTATIONS

RESOLUTION OF THE CITY COUNCIL

No. 364

Approved July 3, 1958

Resolved, DECREED AND ORDERED,

That that Argol Street from Nellie Street to Edgeworth Avenue is hereby established as a public highway pursuant to the provisions of Chapter 1549 of the Public Laws of 1917.

IN CITY COUNCIL

JUL 3 - 1958

READ and PASSED

William A. Gray
ACTING President
Devereux Kelan
Clerk

APPROVED

JUL 3 1958

Walter A. Reynolds
MAYOR

RESOLUTION
OF THE
CITY COUNCIL