

**THE CITY OF PROVIDENCE**  
STATE OF RHODE ISLAND AND PROVIDENCE PLANTATIONS

# RESOLUTION OF THE CITY COUNCIL

No. 402

EFFECTIVE ~~APPROVED~~ July 18, 2011

WHEREAS, The Rhode Island Departments of Environmental Management and Transportation are about to begin construction of Segment 1B/2 of the Blackstone River Bikeway from Waterman Street, Providence to Pawtucket Landing, Pawtucket; and

WHEREAS, In the City of Providence, the bikeway will share the paved surface on Alfred Stone Road, Blackstone Boulevard, Irving Avenue and River Drive; and

WHEREAS, Design plans have been coordinated with the City's Departments of Planning and Development, Public Works, and Parks; and

WHEREAS, The bikeway project proposes to re-align the geometry of the Irving Avenue and River Drive intersection to formalize the current signing restriction and install new curbing, sidewalks and signs to reinforce the existing traffic movement;

NOW, THEREFORE, BE IT RESOLVED,

1. Traffic shall not be permitted to enter the northern leg of River Drive.
2. The stop sign which currently stops traffic eastbound on Irving Avenue onto River Drive southbound shall be removed.
3. "No Entry" signs shall be installed to alert the public to this formalized change in traffic pattern.
4. This Resolution shall take effect upon passage.

**IN CITY COUNCIL**

**JUL 07 2011**

**READ AND PASSED**

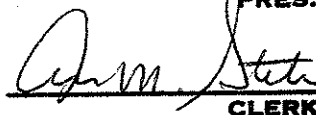
  
**PRES.**  
  
**CLERK**

Effective without the  
Mayor's Signature

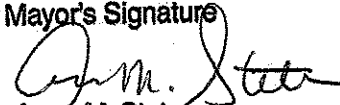
  
Anna M. Stetson  
City Clerk



Two Capitol Hill, Rm. 226  
Providence, RI 02903-1124  
PHONE 401-222-2023  
FAX 401-222-3006; TDD 401-222-4971

Ms. Anna M. Stetson  
City Clerk  
Providence City Hall  
25 Dorrance Street  
Providence, RI 02903

Dear Ms. Stetson:

The Rhode Island Department of Environmental Management and Department of Transportation will soon be constructing the subject project. While in the City of Providence, the bikeway will share the paved surface on Alfred Stone Road, Blackstone Boulevard, Irving Avenue and River Drive. Design plans have been coordinated with the City's Planning and Development, Public Works and Parks Departments.

The current design and striping configuration requires the elimination of public parking from the southerly curb line of Alfred Stone Road to accommodate the proposed bike lanes. The southern curb line frontage is undeveloped as it follows the perimeter of Swan Point Cemetary and the parking spaces are underutilized. Parking along the northerly curblin in front of residential properties will remain.

We respectfully request the City institute an ordinance to restrict parking along the southerly curbline of Alfred Stone Road from Blackstone Boulevard to the Pawtucket/Providence city line. We estimate this will eliminate 48 rarely utilized parking spaces for a length of 1050 feet.

2000

THE  
COURT  
OF  
COMMONS  
IN  
PARLIAMENT  
ASSEMBLED

# Education

# THE

# Exhibition

Page 2

Letter to Anna M. Stetson

Re. Parking Restrictions

Date: March 30, 2011

Also, the bikeway project proposes to re-align the geometry of the Irving Avenue and River Drive intersection. The new design will formalize the current signing restriction which restricts traffic from entering the northern leg of River Drive. New curbing, sidewalks and signs will reinforce the existing traffic movement. Given the proposed geometry improvements, we respectfully request the City institute an ordinance to restrict traffic from entering the northbound leg, if it doesn't already exist, and allow removal of the existing "Stop" sign which stops traffic eastbound on Irving Avenue onto River Drive southbound.

Plans have been attached showing the requested restrictions. If you should have any questions or require additional information, please contact myself or Mr. Lambri Zerva at 222-2023 ext. 4060

Very truly yours,



Vincent J. Palumbo, P.E.  
Managing Engineer

LZ/

Attachments

cc: Farhoumand, Smith, Palumbo, Rocchio, Bailey-DEM, D'Amelio-VHB; files

REV.	DATE	BY	REASON	NO.	DATE	BY	REASON	NO.
1	01/15/18	RL	ISSUED	35	01/15/18	RL	ISSUED	48

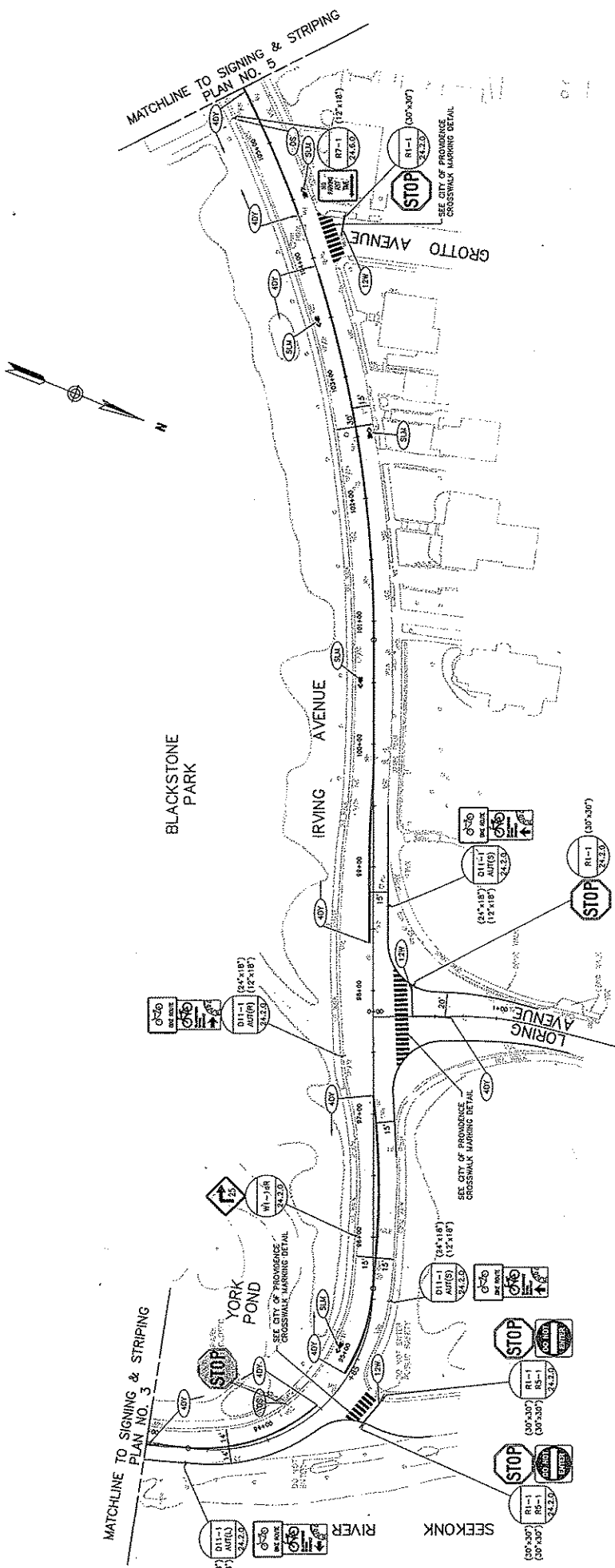

VANASSE HANGEN BRUSTLIN, INC.  
TRANSPORTATION ENGINEERING  
ENVIRONMENTAL SERVICES  
PROVIDENCE, RHODE ISLAND

RHODE ISLAND				RHODE ISLAND			
DEPARTMENT OF TRANSPORTATION				PROVIDENCE/PAW/TUCKET.			
BLACKSTONE RIVER BIKEWAY				RHODE ISLAND			
SEGMENT 1B/2				SIGNING & STRIPING			
				PLAN NO. 4			
CHECKED BY _____				DATE _____			
SCALE 1"=40'							
REVISIONS							
NO.	DATE	BY					