

*son*

Raymond F. McElroy  
491 Eaton St

---

THE CITY OF PROVIDENCE  
STATE OF RHODE ISLAND AND PROVIDENCE PLANTATIONS

RESOLUTION OF THE CITY COUNCIL

No. 364

Approved June 8, 1956

Resolved,

That this Minute on the life and character of the late Raymond P. McElroy, former City Clerk from 1931 to 1939, be and the same is hereby adopted and ordered inscribed on the records of the City Council.

MINUTE

Raymond P. McElroy was born in the City of Providence on May 26, 1899, the son of the late Owen and Sarah (McKenna) McElroy.

Following his formal education in Parochial Schools, Classical High School, and Sweeney Business College, he was appointed Secretary to the then Congressman Jeremiah E. O'Connell in Washington.

Fortified with the experience of this association on the National level, he returned to the City of Providence and was elected by the City Council as its City Clerk in 1931. During his tenure of office many outstanding and worthwhile legislative reforms were adopted.

In recognition of his accomplishments as Providence City Clerk, he was elected President of the New England Town and City Clerk's Association.

Mr. McElroy's administrative ability was recognized subsequently by his appointment as Deputy State Racing Administrator, which position he held with distinction until his death.

His happy faculty of making friends and holding them was evidenced by his membership in the Fraternal Order of Eagles, of which he was an enthusiastic official until his death. In this organization he rose to National prominence by being chosen Worthy Grand President. Prior to that time he held several important offices in the local and State level.

RESOLUTION  
OF THE  
CITY COUNCIL

# The City of Providence

STATE OF RHODE ISLAND AND PROVIDENCE PLANTATIONS

PAGE 2.

In the passing of Raymond P. McElroy, public servant, devoted husband, father, Catholic layman, and nationally recognized fraternal brother, the Citizens of the City of Providence pay tribute to him.

NOW, THEREFORE, BE IT RESOLVED, that the City Council extend its expression of condolence to his devoted wife and family in their great loss.

AND BE IT FURTHER RESOLVED, that a certified copy of this Resolution be transmitted to the family of the deceased.

**IN CITY COUNCIL**

JUN 7 - 1956

**READ and PASSED**

*by a unanimous rising vote*  
*Angelo Arilla*  
*Robert T. Melaw*  
**Clerk**

**APPROVED**

JUN 8 1956

*Walter H. Reynolds*  
**MAYOR**

No.

CHAPTER  
AN ORDINANCE

IN CITY OF

1911 - 1912

RECEIVED BY

1911

1911

CITY OF PROVIDENCE  
STATE OF RHODE ISLAND AND PROVIDENCE PLANTATIONS

PETITION TO THE CITY COUNCIL

364-A

TO THE HONORABLE CITY COUNCIL OF THE CITY OF PROVIDENCE:

The undersigned respectfully petitions your honorable body for change from C-1 Limited Commercial Zone to C-4 Heavy Commercial Zone, Lot 903 and Lot 902, excepting a 17 foot, approximately, strip of land on the easterly side of Lot 902, which strip of land is in Zone R-3, on Tax Assessors' Plat 48; said lots forming a tract on the southeast corner of Oxford Street and Broad Street, being numbered 316 and 318 on Oxford Street and numbered 868 to 878 inclusive on Broad Street.

*Sven David Rosene.*

*Charles Alexander*

IN CITY COUNCIL

JUN 7 - 1956

READ: *and denied*

*Doverett Whelan*  
CLERK

**FILED**

**MAR 22 12 06 PM '56**

**CITY CLERK'S OFFICE  
PROVIDENCE, R.I.**

**IN CITY  
COUNCIL**

**APR 5 - 1956**

**AND HEARING  
REFERRED TO COMMITTEE ON  
ORDINANCES  
Deverickston CLERK**

*Mr. Moscovitz  
(by request)*

CITY COUNCIL

DATE March 22, 19 56

RECEIVED OF Sven Arvid Rosene and Charles Z. Alexander

PAID - City of Providence  
R-22-56

TEN AND 00/100

DOLLARS

Fee for Petition to the City Council for a change in the Zoning of

Lot 903 and 902

Flat 48 A 316 and 318 Oxford St. and

868 to 878 Broad Street

\$10.00

PAID - City of Providence James M. Gordon, City Collector

10.00



902

(R-3 + C-1)

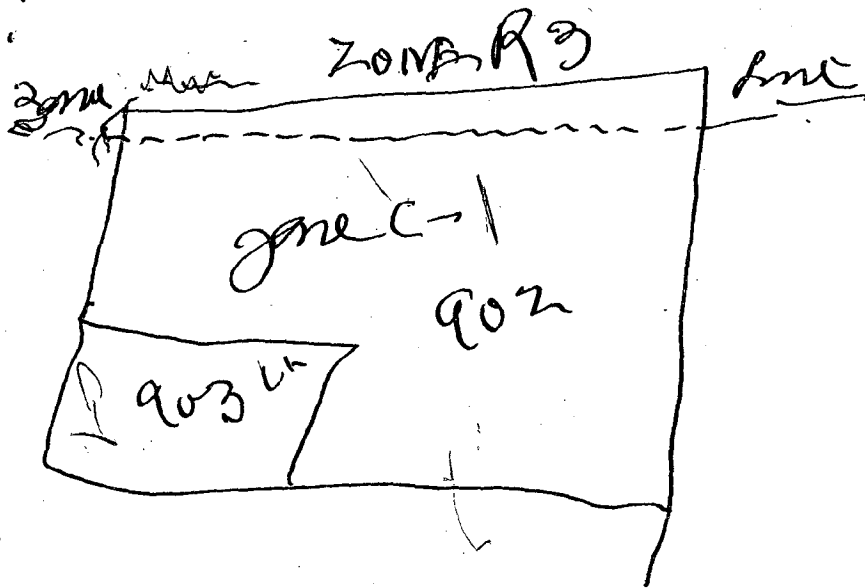

R-3 + C-1

C-4 902

**The City of Providence — Legislative Department**

**CITY CLERK'S OFFICE—OFFICIAL MEMORANDUM**

Providence, R. I., April 6, 1956

TO: City Plan Commission,

SUBJECT: Zoning Petition - Sven Arvid Rosene - Charles Z. Alexander

CONSIDERED BY: Committee on Ordinances

ACTION TAKEN: Voted to refer for study, report and recommendation

Accompanying Petition

*City Clerk*

Sven Arvid Rosens  
316 & 318 Oxford St & 868-878 Broad St.

Plat 48, Lot 902, 903

(12)

Plat 48

Lot 902

Charles J. Alexander & Marion S

Alexander & Sven A. Rosens

170 Westminster St Box 711

903

"

901

Arthur R. Clark & my Anna L

164 Babcock St

900

Patrick P. Curran & Frances B

Curran 89 Westwinds Ave

Cranston

899

Thomas A. Handig Jr, Doris A. Quinn

& Mary E. Handig 50 Farragut Ave

13

"

897

Same as # 900 (P.P. Curran & J.B. Curran)

863

"

862

"

841

John M. Muller  
309 Oxford St

840

"

839

Alice J. Bruns  
313 Oxford St

838

Raymond M. Loea, Jr.  
315 Oxford St

837

Viola Harris  
319 Oxford St

904

Joseph R. Solomon & wife Elizabeth  
410 Bedford St

905

"

Plot 52

Lot 11

Gullo Realty Co  
170 Street Lake Ave

ad. 10

James Cahill & O'Connor

3/20/56  
to  
M. Behrens.  
11/56



## City Plan Commission

EDWARD WINSOR, *Chairman*  
JERRY LORENZO      RALPH MATERA

WALTER H. REYNOLDS, *Mayor*  
LUCIO E. CARLONE, *Secretary*

PAUL A. SAN SOUCI, *Vice Chairman*  
RAYMOND J. NOTTAGE      HARRY PINKERSON

FRANK H. MALLEY, *Director*  
MILLARD HUMSTONE, *Senior Planner*

*Suite 103, City Hall,  
Providence 3, Rhode Island*

April 25, 1956

Committee on Ordinances  
City Hall  
Providence, R. I.

SUBJECT: Referral No. 806 - ZONING CHANGE AT THE CORNER OF BROAD AND  
OXFORD STREETS

Gentlemen:

The subject referral received consideration by the City Plan Commission at a meeting held on Tuesday, April 24, 1956.

This referral is a request for a change in zoning from a C-1 Zone to a C-4 Zone of Lots 902 and 903, excepting a 17-foot strip of land on the easterly side of Lot 902, on Assessor's Plat 48 located at the corner of Broad and Oxford Streets. The area in question contains 10,778 square feet.

On the field trip it was found that the area is occupied by two dwellings and a one-story commercial structure.

The Commission

VOTED: To offer no objection to the granting of this petition.

Very truly yours,

  
FRANK H. MALLEY  
DIRECTOR  
CITY PLAN COMMISSION

FHM:MMH

c.c. Councilman James L. Cahill  
Councilman Charles H. O'Connor

100

To the Members of the Ordinance Committee of the City Council.

The undersigned, being owners of property adjacent to the Southeast corner of Broad and Oxford Streets are unalterably opposed to the petition of Sven Arvid Rosene, et al., to change the zone of Lots 902 and 903 on Plat 48 from C-1 limited to C-4 heavy commercial and respectfully request that the petition be denied.

Raymond M. Lega Jr. 315 Oxford St.

Frank P. Tramm 859 Broad St.

Mrs. Viola Harris 319 Oxford St.

John W. Mullen 309 Oxford St  
223 Oxford St

Irene M. Lovett 303 Oxford St.  
187 Waldo St.

Alice J Grant 313 Oxford St.

Richard Goodwin 301 Oxford Street

FUNDS HELD IN TRUST BY THE COMMISSIONERS  
OF SINKING FUNDS

NAME OF FUND	Dec. 31, 1955	Mar. 31, 1956	Increase or Decrease
Premium on Serial Bonds Sold.....	\$ 21,883.47	\$ 21,883.47	.....
Valley View Housing Reserve.....	54,656.70	58,484.60	\$3,827.90
North Burial Ground Perpetual Care Fund	592,474.54	594,980.04	795.14
North Burial Grd. Per. Care Fd.—Income	406.81	1,201.95	2,505.50
Fire Insurance Fund.....	54,359.60	53,207.10	1,152.50
Water Works Depreciation and Extension Fund. . . . .	771,914.87	773,914.87	2,000.00
	\$1,495,695.99	\$1,503,672.03	\$7,976.04

Respectfully submitted by request of the Board of Commissioners.

*Walter H. Reynolds*  
WALTER H. REYNOLDS,  
Mayor and Chairman

IN CITY COUNCIL  
JUN 7 - 1956

READ:  
WHEREUPON IT IS ORDERED THAT  
THE SAME BE RECEIVED.

*Everett Whelan*  
CLERK

S E R I A L   B O N D S—(Continued)

Serial Bonds Issued for	Due	Rate	Debt Mar. 31, 1956	Payments Due in 1956
Total brought forward.....			\$31,729,500.	
Unemployment Relief .....	Feb. 1, 1957	2½	80,000.	80,000.
Unemployment Relief .....	May 1, 1958	2	150,000.	50,000.
Unemployment Relief .....	Feb. 1, 1959	2	300,000.	100,000.
Unemployment Relief .....	Aug. 1, 1959	2½	460,000.	115,000.
Unemployment Relief .....	Sept. 1, 1960	2	100,000.	20,000.
Unemployment Relief .....	April 1, 1961	2	900,000.	150,000.
Unemployment Relief .....	April 1, 1963	1½	800,000.	100,000.
World War Memorial.....	July 1, 1962	4	63,000.	9,000.
<b>Total.....</b>			<b>\$34,582,500.</b>	

Payments begin in: (1958—g); (1959—a).

S I N K I N G   F U N D   B O N D S

Bonds Issued for	Due	Rate	Debt Mar. 31, 1956	Sinking Fund		Increase or Decrease
				Dec. 31, 1955	Mar. 31, 1956	
Schools.....	May 2, 1957	4	\$ 1,000,000.	\$ 945,369.52	\$ 948,320.77	\$ 2,951.25
Schools.....	Jan. 3, 1958	4	600,000.	488,581.92	491,778.79	3,196.87
Schools.....	Mar. 1, 1959	4½	1,000,000.	948,798.01	953,489.01	4,691.00
Sewers.....	May 2, 1957	4	1,000,000.	929,319.97	933,925.18	4,605.21
Water Supply.....	July 1, 1956	4	1,000,000.	1,000,000.00	1,002,787.50	2,787.50
Water Supply.....	Feb. 1, 1962	4½	1,000,000.	930,473.85	932,691.34	2,217.49
Water Supply.....	May 1, 1962	4	2,000,000.	1,844,449.73	1,852,998.61	8,548.88
Water Supply.....	July 1, 1962	4	1,000,000.	971,346.59	975,509.09	4,162.50
Water Supply.....	Dec. 1, 1962	4	2,500,000.	2,279,280.93	2,282,116.49	2,835.56
Water Supply.....	Feb. 1, 1964	4½	2,000,000.	1,158,019.60	1,162,032.10	4,012.50
Water Supply.....	Oct. 1, 1964	4	1,500,000.	698,650.01	699,592.51	942.50
Water Supply.....	July 1, 1965	4	2,500,000.	637,895.07	639,760.07	1,865.00
Water Supply.....	Jan. 3, 1968	4	1,500,000.	708,982.35	710,261.10	1,278.75
Redemp. City Debt .....				816,070.58	779,277.14	36,793.44
<b>Total.....</b>			<b>\$18,600,000.</b>	<b>\$14,357,238.13</b>	<b>\$14,364,539.70</b>	<b>\$ 7,301.57</b>

BONDED INDEBTEDNESS MARCH 31, 1956  
 Serial Bond ..... \$34,582,500.00  
 Sinking Fund Bonds ..... 18,600,000.00  
 Total Bonded Debt ..... \$53,182,500.00  
 Sinking Fund ..... \$14,364,539.70  
 Premium on Serial Bonds Sold ..... 21,883.47  
 Valley View Housing Reserve ..... 58,484.60  
 14,444,907.77  
 Net Bonded Debt ..... \$38,737,592.23  
 Less Net Water Bonded Debt ..... 4,742,251.19  
 Net Bonded Debt Exclusive of Water Debt ..... \$33,995,341.04

WATER SUPPLY BONDED INDEBTEDNESS  
 INCLUDED IN THE FOREGOING  
 Sinking Fund Bonds ..... \$15,000,000.00  
 Sinking Funds ..... 10,257,748.81  
 Net Water Bonded Debt ..... \$4,742,251.19



## CITY OF PROVIDENCE

---

### Three Hundred and Seventh Quarterly Report of the Board of Commissioners of Sinking Funds.

TO THE HONORABLE THE CITY COUNCIL OF THE CITY OF  
PROVIDENCE:

The Board of Commissioners of Sinking Funds make this  
their Three Hundred and Seventh Quarterly Report of the  
quarter ending December 31, 1955.

The bonds comprising the funded debt, (including Serial  
Bonds) the purposes for which they were issued, the amounts  
of the sinking funds, and the increase in same are shown by  
the following table:

December 31, 1955

# SERIAL BONDS

Serial Bonds Issued for	Due	Rate	Debt Dec. 31, 1955	Payments Due in 1955
Emergency Housing—Series I.....	June 1, 1974	2.40	1,441,000.	59,000.
Emergency Housing—Series II.....	July 1, 1980	2	1,125,000.	45,000.
Funding.....	April 1, 1960	2	125,000.	25,000.
Funding.....	July 1, 1960	2	125,000.	25,000.
Funding.....	June 1, 1965	2	550,000.	50,000.
Highway.....	Feb. 1, 1957	2½	140,000.	70,000.
Highway.....	May 1, 1958	2	75,000.	25,000.
Highway.....	Jan. 1, 1974	2	240,000.	10,000.
Highway 1950-52 Construction.....	July 1, 1977	2.30	600,000	(g) 23,000.
Highway—1954.....	Jan. 1, 1974	2½	285,000.	15,000.
Highway Reconstruction—Series I.....	Jan. 1, 1971	2	800,000.	50,000.
Highway Reconstruction—Series II.....	Jan. 1, 1971	2	800,000.	50,000.
Highway Reconstruction—Series III.....	July 1, 1971	2	800,000.	50,000.
Highway Reconstruction—Series A.....	July 1, 1975	2	500,000.	(f) 21,000.
Highway Reconstruction—Series B.....	July 1, 1975	2	200,000.	(f) 8,000.
Highway Reconstruction—Series C.....	July 1, 1975	2	500,000.	(f) 21,000.
Highway Reconstruction—Series D.....	July 1, 1977	2.30	1,000,000.	(g) 39,000.
Incinerator & Sludge Disposal—Series I.....	Jan. 1, 1971	2	790,000.	40,000.
Incinerator & Sludge Disposal—Series A.....	July 1, 1975	2	650,000.	(f) 27,000.
Incinerator & Sludge Disposal—Series B.....	July 1, 1975	2	175,000.	(f) 7,000.
Modernizing Fire Dept.—Series I.....	Jan. 1, 1974	2	480,000.	20,000.
Modernizing Fire Dept.—Series II.....	July 1, 1975	2	750,000.	(f) 31,000.
Modernizing Fire Dept.—Series A.....	July 1, 1975	2	250,000.	(f) 10,000.
Modernizing Fire Dept.—Series B.....	July 1, 1977	2.30	250,000.	(g) 10,000.
Mun. Bldg., P.W.A. Docket 1150 F.....	Feb. 1, 1959	2	160,000.	40,000.
Mun. Dock, P.W.A. Docket 1132 F.....	Sept. 1, 1958	1½	165,000.	55,000.
Municipal Wharf Shed.....	July 1, 1977	2.30	1,250,000.	(g) 49,000.
Park and Playground.....	July 1, 1957	4	32,000.	16,000.
Providence Public Library.....	Jan. 1, 1978	2½	1,950,000.	(a) 97,000.
Public Improvements.....	June 1, 1965	2	1,925,000.	175,000.
Recreational Facilities.....	June 1, 1974	2.40	828,000.	36,000.
Rehabilitation for Hurricane Damage.....	Aug. 1, 1964	2	630,000.	70,000.
Refunding (Issue 1941).....	June 1, 1965	2	1,925,000.	175,000.
Refunding (Issue 1942).....	June 1, 1965	2	189,500.	15,000.
Refunding (Issue 1943).....	June 1, 1965	2	200,000.	20,000.
Refunding (Issue 1944).....	June 1, 1965	2	200,000.	25,000.
Refunding (Issue 1945).....	June 1, 1965	2	260,000.	25,000.
Refunding—Series II.....	June 1, 1971	1½	1,935,000.	109,000.
Refunding—Series II-B.....	June 1, 1972	1.8	484,000.	25,000.
Refunding—Series II-C.....	June 1, 1972	2.20	565,000.	27,000.
Refunding—Series II-D.....	June 1, 1972	2.40	693,000.	36,000.
School.....	Dec. 1, 1959	4½	200,000.	50,000.
School.....	July 1, 1961	4	300,000.	50,000.
School.....	April 1, 1962	4½	350,000.	50,000.
School.....	July 1, 1962	4	112,000.	16,000.
School.....	Mar. 1, 1964	3½	135,000.	15,000.
School, P.W.A. Docket 6579.....	Jan. 1, 1965	3	1,300,000.	130,000.
School.....	April 1, 1973	3½	360,000.	20,000.
School—1954.....	Jan. 1, 1978	2½	1,600,000.	(a) 80,000.
School Athletic Fields—Series I.....	Jan. 1, 1973	2	460,000.	20,000.
School Athletic Fields—Series II.....	Jan. 1, 1974	2	480,000.	20,000.
Sewer.....	April 1, 1958	3½	60,000.	20,000.
Sewer.....	Jan. 1, 1974	2	240,000.	10,000.
Sewer 1950-52 Construction.....	July 1, 1977	2.30	400,000.	(g) 16,000.
Sewer 1954 Construction.....	Jan. 1, 1974	2½	190,000.	10,000.
Total carried forward.....			\$32,229,500.	

S E R I A L B O N D S—(Continued)

Serial Bonds Issued for	Due	Rate	Debt Dec. 31, 1955	Payments Due in 1955
Total brought forward.....			\$32,229,500.	
Unemployment Relief .....	Feb. 1, 1957	2½	160,000.	80,000.
Unemployment Relief .....	May 1, 1958	2	150,000.	50,000.
Unemployment Relief .....	Feb. 1, 1959	2	400,000.	100,000.
Unemployment Relief .....	Aug. 1, 1959	2½	460,000.	115,000.
Unemployment Relief .....	Sept. 1, 1960	2	100,000.	20,000.
Unemployment Relief .....	April 1, 1961	2	900,000.	150,000.
Unemployment Relief .....	April 1, 1963	1½	800,000.	100,000.
World War Memorial .....	July 1, 1962	4	63,000.	9,000.
<b>Total</b> .....			<b>\$35,262,500.</b>	

Payments begin in: (1956—f); (1958—g); (1959—a).

S I N K I N G F U N D B O N D S

Bonds Issued for	Due	Rate	Debt Dec. 31, 1955	Sinking Fund		Increase or Decrease
				Sept. 30, 1955	Dec. 31, 1955	
Schools.....	May 2, 1957	4	\$ 1,000,000.	\$ 917,897.80	\$ 945,369.52	\$ 27,471.72
Schools.....	Jan. 3, 1958	4	600,000.	473,662.38	488,581.92	14,919.54
Schools.....	Mar. 1, 1959	4½	1,000,000.	921,375.72	948,798.01	27,422.29
Sewers.....	Jan. 2, 1956	4	700,000.	638,636.31	655,736.57	17,100.26
Sewers.....	May 2, 1957	4	1,000,000.	902,560.27	929,319.97	26,759.70
Water Supply.....	July 1, 1956	4	1,000,000.	1,001,003.56	1,000,000.00	1,003.56
Water Supply.....	Feb. 1, 1962	4½	1,000,000.	924,226.50	930,473.85	6,247.35
Water Supply.....	May 1, 1962	4	2,000,000.	1,831,040.83	1,844,449.73	13,408.90
Water Supply.....	July 1, 1962	4	1,000,000.	967,258.95	971,346.59	4,087.64
Water Supply.....	Dec. 1, 1962	4	2,500,000.	2,261,351.00	2,279,280.93	17,929.93
Water Supply.....	Feb. 1, 1964	4½	2,000,000.	1,151,252.15	1,158,019.60	6,767.45
Water Supply.....	Oct. 1, 1964	4	1,500,000.	693,192.75	698,650.01	5,457.26
Water Supply.....	July 1, 1965	4	2,500,000.	624,916.02	637,895.07	12,979.05
Water Supply.....	Jan. 3, 1968	4	1,500,000.	703,480.51	708,982.35	5,501.84
Redemp. City Debt.....				810,941.02	816,070.58	5,129.56
<b>Total</b> .....			<b>\$19,300,000.</b>	<b>\$14,822,795.77</b>	<b>\$15,012,974.70</b>	<b>\$190,178.93</b>

BONDED INDEBTEDNESS DECEMBER 31, 1955			
Serial Bonds .....			\$35,262,500.00
Sinking Fund Bonds .....			19,300,000.00
Total Bonded Debt .....			\$54,562,500.00
Sinking Fund .....			\$15,012,974.70
Premium on Serial Bonds Sold .....			21,863.47
Valley View Housing Reserve .....			54,656.70
			15,089,514.87
Net Bonded Debt .....			\$39,472,985.13
Less Net Water Bonded Debt .....			4,770,901.87
Net Bonded Debt Exclusive of Water Debt .....			\$34,702,083.26

WATER SUPPLY BONDED INDEBTEDNESS INCLUDED IN THE FOREGOING	
Sinking Fund Bonds .....	\$15,000,000.00
Sinking Funds .....	10,229,098.13
Net Water Bonded Debt .....	\$4,770,901.87

FUNDS HELD IN TRUST BY THE COMMISSIONERS  
OF SINKING FUNDS

NAME OF FUND	Sept. 30, 1955	Dec. 31, 1955	Increase or Decrease
Premium on Serial Bonds Sold.....	\$ 21,620.97	\$ 21,883.47	\$ 262.50
Valley View Housing Reserve.....	51,448.90	54,656.70	3,207.80
North Burial Ground Perpetual Care Fund	591,144.54	592,474.54	1,330.00
North Burial Grd. Per. Care Fd.—Income	811.51	406.81	404.70
Fire Insurance Fund.....	61,073.35	54,359.60	6,713.75
Water Works Depreciation and Extension Fund. ....	764,823.62	771,914.87	7,091.25
	\$1,490,922.89	\$1,495,695.99	\$4,773.10

Respectfully submitted by request of the Board of Commissioners.

*Walter H. Reynolds*  
WALTER H. REYNOLDS  
Mayor and Chairman

IN CITY COUNCIL  
JUN 7 - 1956

READ:

WHEREUPON IT IS ORDERED THAT  
THE SAME BE RECEIVED.

*Everett Whelan*  
CLERK

# SERIAL BONDS

Serial Bonds Issued for	Due	Rate	Debt Mar. 31, 1956	Payments Due in 1956
Emergency Housing—Series I.....	June 1, 1974	2.40	\$ 1,441,000.	\$ 60,000.
Emergency Housing—Series II.....	July 1, 1980	2	1,125,000.	45,000.
Funding.....	April 1, 1960	2	125,000.	25,000.
Funding.....	July 1, 1960	2	125,000.	25,000.
Funding.....	June 1, 1965	2	550,000.	50,000.
Highway.....	Feb. 1, 1957	2½	70,000.	70,000.
Highway.....	May 1, 1958	2	75,000.	25,000.
Highway.....	Jan. 1, 1974	2	230,000.	10,000.
Highway 1950-52 Construction.....	July 1, 1977	2.30	600,000.	(g) 23,000.
Highway—1954.....	Jan. 1, 1974	2½	270,000.	15,000.
Highway Reconstruction—Series I.....	Jan. 1, 1971	2	750,000.	50,000.
Highway Reconstruction—Series II.....	Jan. 1, 1971	2	750,000.	50,000.
Highway Reconstruction—Series III.....	July 1, 1971	2	800,000.	50,000.
Highway Reconstruction—Series A.....	July 1, 1975	2	500,000.	21,000.
Highway Reconstruction—Series B.....	July 1, 1975	2	200,000.	8,000.
Highway Reconstruction—Series C.....	July 1, 1975	2	500,000.	21,000.
Highway Reconstruction—Series D.....	July 1, 1977	2.30	1,000,000.	(g) 39,000.
Incinerator & Sludge Disposal—Series I.....	Jan. 1, 1971	2	750,000.	40,000.
Incinerator & Sludge Disposal—Series A.....	July 1, 1975	2	650,000.	27,000.
Incinerator & Sludge Disposal—Series B.....	July 1, 1975	2	175,000.	7,000.
Modernizing Fire Dept.—Series I.....	Jan. 1, 1974	2	460,000.	20,000.
Modernizing Fire Dept.—Series II.....	July 1, 1975	2	750,000.	31,000.
Modernizing Fire Dept.—Series A.....	July 1, 1975	2	250,000.	10,000.
Modernizing Fire Dept.—Series B.....	July 1, 1977	2.30	250,000.	(g) 10,000.
Mun. Bldg., P.W.A. Docket 1150 F.....	Feb. 1, 1959	2	120,000.	40,000.
Mun. Dock, P.W.A. Docket 1132 F.....	Sept. 1, 1958	1½	165,000.	55,000.
Municipal Wharf Shed.....	July 1, 1977	2.30	1,250,000.	(g) 49,000.
Park and Playground.....	July 1, 1957	4	32,000.	16,000.
Providence Public Library.....	Jan. 1, 1978	2½	1,950,000.	(a) 97,000.
Public Improvements.....	June 1, 1965	2	1,925,000.	175,000.
Recreational Facilities.....	June 1, 1974	2.40	828,000.	36,000.
Rehabilitation for Hurricane Damage.....	Aug. 1, 1964	2	630,000.	70,000.
Refunding (Issue 1941).....	June 1, 1965	2	1,925,000.	175,000.
Refunding (Issue 1942).....	June 1, 1965	2	189,500.	15,000.
Refunding (Issue 1943).....	June 1, 1965	2	200,000.	20,000.
Refunding (Issue 1944).....	June 1, 1965	2	200,000.	20,000.
Refunding (Issue 1945).....	June 1, 1965	2	260,000.	25,000.
Refunding—Series II.....	June 1, 1971	1½	1,935,000.	110,000.
Refunding—Series II-B.....	June 1, 1972	1.8	484,000.	26,000.
Refunding—Series II-C.....	June 1, 1972	2.20	565,000.	28,000.
Refunding—Series II-D.....	June 1, 1972	2.40	693,000.	37,000.
School.....	Dec. 1, 1959	4½	200,000.	50,000.
School.....	July 1, 1961	4	300,000.	50,000.
School.....	April 1, 1962	4½	350,000.	50,000.
School.....	July 1, 1962	4	112,000.	16,000.
School.....	Mar. 1, 1964	3½	120,000.	15,000.
School, P.W.A. Docket 6579.....	Jan. 1, 1965	3	1,170,000.	130,000.
School.....	April 1, 1973	3½	360,000.	20,000.
School—1954.....	Jan. 1, 1978	2½	1,600,000.	(a) 80,000.
School Athletic Fields—Series I.....	Jan. 1, 1973	2	440,000.	20,000.
School Athletic Fields—Series II.....	Jan. 1, 1974	2	460,000.	20,000.
Sewer.....	April 1, 1958	3½	60,000.	20,000.
Sewer.....	Jan. 1, 1974	2	230,000.	10,000.
Sewer 1950-52 Construction.....	July 1, 1977	2.30	400,000.	(g) 16,000.
Sewer 1954 Construction.....	Jan. 1, 1974	2½	180,000.	10,000.
Total carried forward.....			\$31,729,500.00	

CITY OF PROVIDENCE

---

Three Hundred and Eighth Quarterly Report of  
the Board of Commissioners of Sinking Funds.

TO THE HONORABLE THE CITY COUNCIL OF THE CITY OF  
PROVIDENCE:

The Board of Commissioners of Sinking Funds make this  
their Three Hundred and Eighth Quarterly Report of the  
quarter ending March 31, 1956.

The bonds comprising the funded debt, (including Serial  
Bonds) the purposes for which they were issued, the amounts  
of the sinking funds, and the increase in same are shown by  
the following table:

March 31, 1956

# Weekly Report of the Superintendent of the Dexter Asylum.

To the Honorable Mayor and the Honorable the City Council of the City of Providence

The Superintendent of the Dexter Asylum herewith reports on admissions and discharges for the week ending May 27, 19 56

Admitted, 0 Discharged, 0 Remaining, 26

## ADMISSIONS

DATE	NAME	AGE	BIRTHPLACE	ADMITTED BY DIRECTOR OF PUBLIC WELFARE

## DISCHARGES

NAME	DISCHARGED BY	NO.

Respectfully submitted,

*James M. Gorman* Superintendent  
Director of Public Welfare

JUN 7 - 1956

In City Council, .....

Read, whereupon it is ordered that the same be received.

*Everett Whelan* Clerk.

WEEKLY REPORT

OF THE

DEXTER ASYLUM

WEEK ENDING

May 27,

1956



## Weekly Report of the Superintendent of the Dexter Asylum.

To the Honorable Mayor and the Honorable the City Council of the City of Providence

The Superintendent of the Dexter Asylum herewith reports on admissions and discharges for the week ending June 3, 1956

Admitted, 0 Discharged, 0 Remaining, 26

### ADMISSIONS

DATE	NAME	AGE	BIRTHPLACE	ADMITTED BY DIRECTOR OF PUBLIC WELFARE

### DISCHARGES

NAME	DISCHARGED BY	NO.

Respectfully submitted,

*James V. McGraw* Superintendent  
Director of Public Welfare

JUN 7 - 1956

In City Council, .....

Read, whereupon it is ordered that the same be received.

*Devereux Whelan* Clerk.

WEEKLY REPORT

OF THE

DEXTER ASYLUM

WEEK ENDING

June 3, 6

195

## Weekly Report of the Superintendent of the Dexter Asylum.

To the Honorable Mayor and the Honorable the City Council of the City of Providence

The Superintendent of the Dexter Asylum herewith reports on admissions and discharges for the week ending May 20, 1956

Admitted, 0 Discharged, 0 Remaining, 26

### ADMISSIONS

DATE	NAME	AGE	BIRTHPLACE	ADMITTED BY DIRECTOR OF PUBLIC WELFARE

### DISCHARGES

NAME	DISCHARGED BY	NO.

Respectfully submitted,

*James T. McGovern* Superintendent  
Director of Public Welfare

**JUN 7 - 1956**

In City Council, .....

Read, whereupon it is ordered that the same be received.

*Everett Whelan* Clerk.

WEEKLY REPORT

OF THE

DEXTER ASYLUM

WEEK ENDING

195