

THE CITY OF PROVIDENCE  
STATE OF RHODE ISLAND AND PROVIDENCE PLANTATIONS

# RESOLUTION OF THE CITY COUNCIL

No. 210

Approved March 29,

IN CITY COUNCIL

RECEIVED 16 CON. COUNCIL  
FIRST READING  
MAY 15 1975

RESOLVED, that His Honor the Mayor is authorized to execute a deed of conveyance to Our Lady of Fatima Council - Knights of Columbus, of Five Thousand (5,000) Square Feet of the westerly portion of Lot 566, as set out and delineated on City Assessor's Plat 14, said area being located along Gano Street, said conveyance shall be subject to negotiations and conditions by the Mayor, the Committee on City Property, and the City Solicitor.

IN CITY COUNCIL

MAR 20 1975  
READ AND PASSED

*Ralph Tanguay* Acting PRES.  
*Vincent Vespecci* CLERK

APPROVED

MAYOR

MAR 29 1975

*Monte Cianci*

IN CITY COUNCIL

MAR 6 1975

FIRST READING

REFERRED TO COMMITTEE ON CITY PROPERTY

Vermont Wesley  
CLERK

Councilman Javies  
and Councilman Brasil  
By Request

THE COMMITTEE ON

City Property

Approves Passage of  
The Within Resolution

Vermont Wesley

March 7, 1975 *Ch*

PROVIDENCE, R. I.  
 P. W. DEPT. - ENGINEERING OFFICE  
 CITY PROPERTY SECTION  
 Plan No. 063916  
 Date March 20, 1975

Note:

Cross-Hatched Area (A-B-C-D-A)  
 Indicates Proposed Sale.

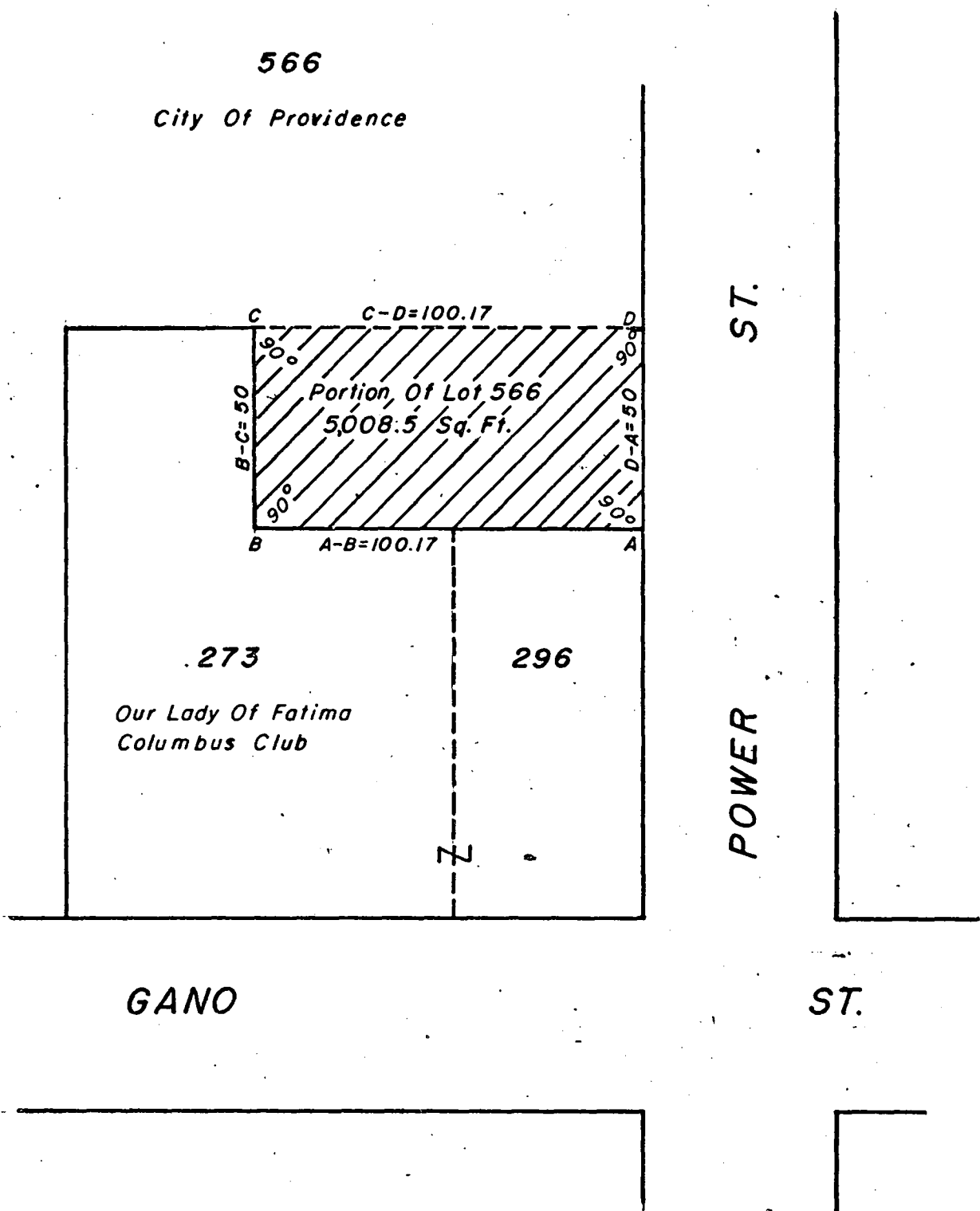

CITY OF PROVIDENCE, R. I.  
 Public Works Dept. - Engineering Office  
 Showing Proposed Sale, Portion Of  
 Lot 566.  
 Drawn by J.A.M. Checked by A.P.  
 Scale 1"=40' Date 3-20-75  
 Corrected by J. J. L. Associate Eng.  
 Approved Joseph J. L.  
 CHIEF ENGINEER

Lot Numbers From Assessor's Plat 14