

THE CITY OF PROVIDENCE
STATE OF RHODE ISLAND AND PROVIDENCE PLANTATIONS

RESOLUTION OF THE CITY COUNCIL

No. 242

Effective: ~~Approved~~ April 26, 1982

RESOLVED, That His Honor the Mayor is hereby authorized to execute a Deed of Conveyance to Paul O. Bjorklund, President of Bjorklund Paving Co., Inc., 162 Vermont Avenue, Providence, Rhode Island, 02905, of that certain tract or parcel of land situated along Swan Street, as set out and delineated on Lot 117, City Assessor's Plat 47, comprising of an area of approximately 4,993 square feet of land, more or less, for the Sum of One Thousand Two Hundred Fifty Dollars (\$1,250.00).

IN CITY COUNCIL

APR 15 1982
READ AND PASSED

Robert F. Lynley PRES.

Rose M. Mendonca CLERK

Effective without the Mayor's signature April 26, 1982.

Rose M. Mendonca

THE COMMITTEE ON

CITY PROPERTY

Approves Passage of
The Within Resolution

Jose M. Mendonca
Clerk Chairman

April 5, 1982

PROVIDENCE, R. I.
 P. W. DEPT. - ENGINEERING OFFICE
 CITY PROPERTY SECTION
 Plan No. 064187
 Date April 14, 1982

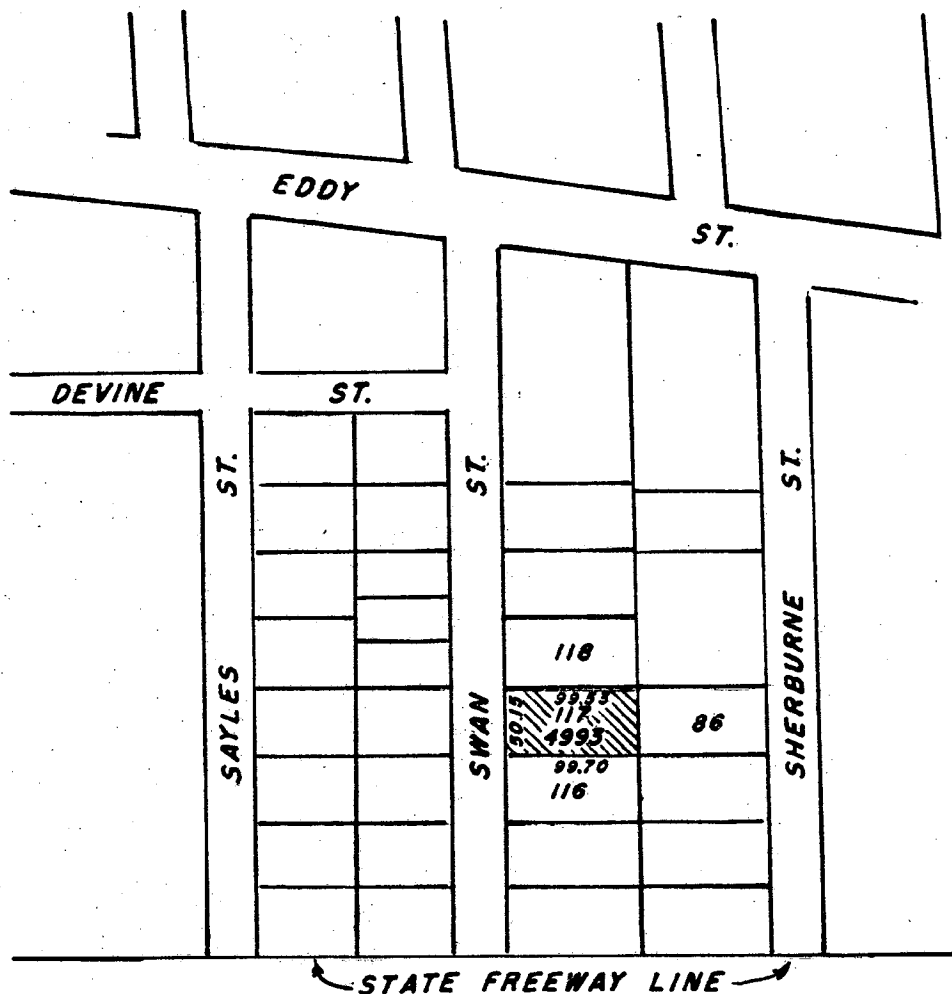

CITY OF PROVIDENCE, R. I.
 Public Works Dept. Engineering Office
 Showing Proposed Sale Lot 117
 Assrs. Plot 47
 Drawn by L.D.A. Checked by R.J.Q.
 Scale Not to Scale Date April 14, 1982
 Corrected S. J. Ringly Associate Eng.
 Approved _____ CHIEF ENGINEER

Note: Cross-Hatched Area Proposed Sale

Lot Numbers Assessor's Plot 47

32
19

January 11, 1982

Mr. Harry Johnson
Chairman
City Properties Committee
c/o Office of City Clerk
City Hall
Providence, RI 02903

RE: Plat 47, Lot 117

Dear Sir:

Please be advised that the undersigned, President of Bjorklund Paving Co., Inc., hereby makes proposal to purchase the above-referenced parcel of real estate for the sum of \$1,250.00 for the purposes of constructing a dwelling to store construction equipment provided that the above property is free and clear of all liens, encumbrances, etc.

Very truly yours,

BJORKLUND PAVING CO., INC.

Paul O. Bjorklund
Paul O. Bjorklund, Pres.

Copy R
124-1414M
2/5/82

Swan ST

FILED
JAN 11 2 03 PM '82
DEPT. OF CITY CLERK
PROVIDENCE, R.I.

29-016-701

CITY OF PROVIDENCE

TAX EXEMPT

NOT LISTED AS TAX REVERTED



THE CITY ASSESSOR

CITY HALL, PROVIDENCE, RHODE ISLAND 02903

421-5900

MEMORANDUM

TO: Harry A. Johnson, Chairman
Committee on City Property

FROM: Theodore C. Littler, City Assessor

DATE: February 5, 1982

In response to your request for an appraised valuation of a parcel of land identified as Assessor's Plat 47, Lot 117, please be advised that the offer of \$1,250 made for the purchase of this city-owned parcel of land is appropriate in my opinion.

In reviewing recent sales of lots in the subject area, it would appear that the fair market value of such lots is in the \$1,200 to \$1,400 range.

ads

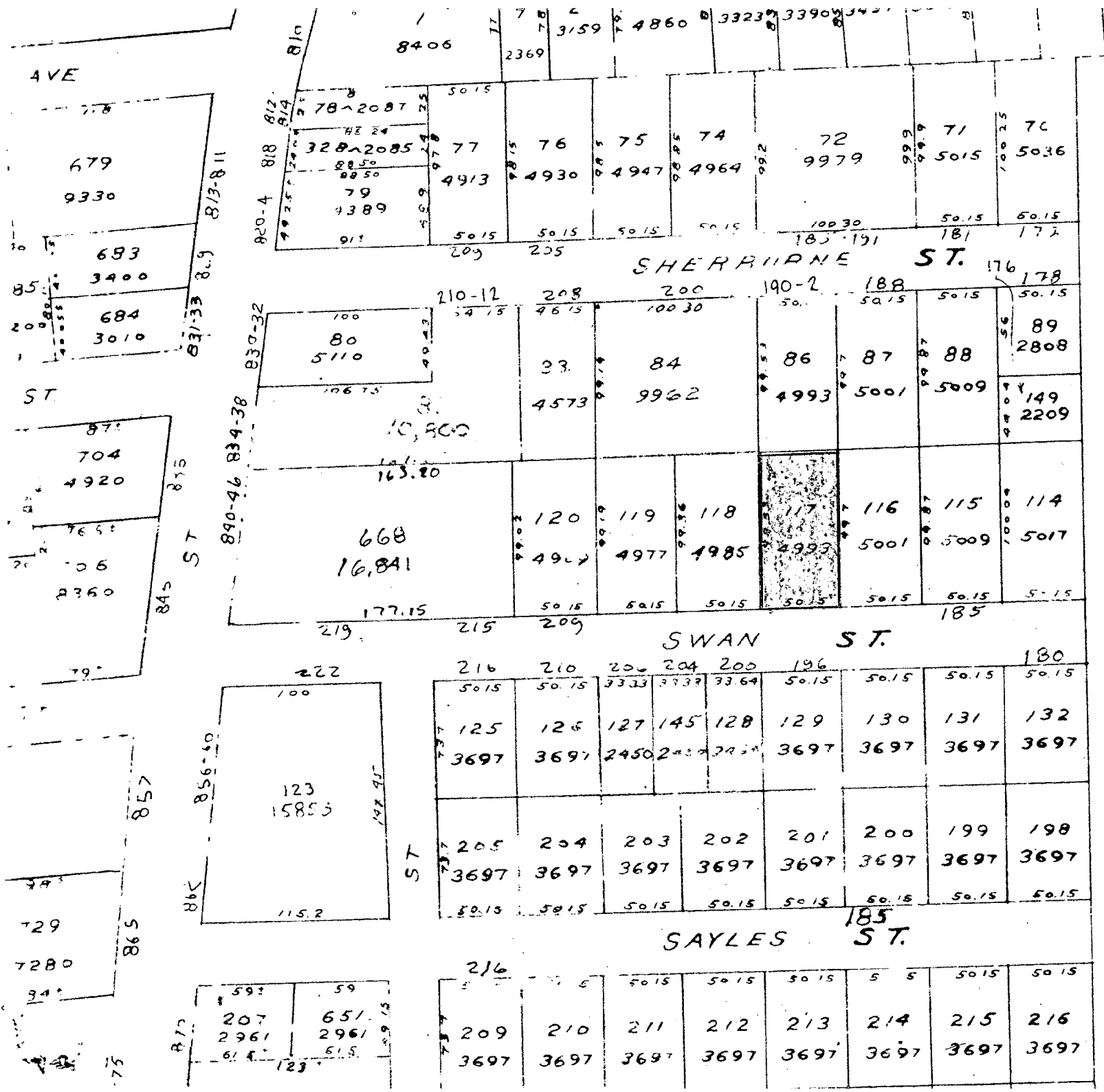

City of Phoenix
Dec 41

PLAT
47

City of Providence



Rhode Island

Department of City Clerk

MEMORANDUM

DATE: April 7, 1982

TO: James Lembo, Deputy Director of Public Works

SUBJECT: REQUEST FOR TRACING

CONSIDERED BY: Councilman Harry A. Johnson, Chairman - Committee on City Property

DISPOSITION: VOTED: A tracing is requested of that land located on Lot 117, City Assessor's Plat 47, situated along Swan Street so that the same may be presented to the City Council with recommendation of Sale.

City Clerk

April 29, 1982

Paul O. Bjorklund, President
Bjorklund Paving, Co., Inc.
162 Vermont Avenue
Providence, Rhode Island 02905

Dear Mr. Bjorklund,

Enclosed is certified copy of Resolution No. 242,
effective April 26, 1982, the same being self-explanatory.

Will you kindly communicate with the City Solicitor's
Office so that the deed of conveyance will be executed.

Very truly yours,

Rose M. Mendonca,
City Clerk.

RMM/jma
Enclosure