

City of Providence

STATE OF RHODE ISLAND

CHAPTER 2022-12

No. 160 AN ORDINANCE IN AMENDMENT TO ORDINANCE 2012-17,
NO. 182, APPROVED MARCH 30, 2012, ENTITLED "AN
ORDINANCE APPORTIONING THE FIFTEEN WARDS", AS
AMENDED

Approved April 25, 2022

Be it ordained by the City of Providence:

SECTION 1. Section 204 of the Code of Ordinances is hereby amended to read as follows:

The City of Providence is hereby apportioned into fifteen wards in accordance with Section 204 of the Providence Home Rule Charter of 1980, as approved by the Electors of the City of Providence at the General Election held November 4, 1980 and validated by the General Assembly on May 7, 1981.

FIRST WARD

The First Ward of the City of Providence shall consist of all that part of the City bounded by a line beginning at the intersection of Henderson Expy and the Providence - East Providence Boundary line; thence West on Henderson Expy; thence North on River Rd; thence West on Angell St; thence South on Brook St; thence West on Waterman St; thence South on Thayer St; thence West on Charlesfield St; thence South on Brown St; thence West on Power St; thence Northwest on S Main St; thence Northwest on N Main St; thence West on Park Row; thence Southeast on the Mosshasuck river; thence Southwest on Steeple St; thence west on Memorial Blvd; thence South on I- 95; thence Northeast on I- 195; thence southeasterly on Providence River; thence northeasterly on the Providence – East Providence boundary line to the point of beginning.

SECOND WARD

The Second Ward of the City of Providence shall consist of all that part of the City bounded by a line beginning at the intersection of Power St and S Main St; thence East on Power St; thence North on Brown St; thence East on Charlesfield St; thence North on Thayer St; thence East on Waterman St; thence North on Brook St; thence East on Angell St; thence South on River Rd; thence East on Henderson Expy; thence North on the Providence - East Providence border; thence west on the Providence - Pawtucket border; thence South on Hope St; thence Southeast on Blackstone Blvd; thence Southwest on North Ave; thence South on Hope St; thence East on 8th St; thence Southeast on Winfield Rd; thence Southwest on Lorimer Ave; thence East on Rochambeau Ave; thence South on Elmgrove Ave; thence West on Doyle Ave; thence North on Taber Ave; thence Northwest on Emeline St; thence South on Morris Ave; thence West on Olney St; thence South on N Main St; thence South on Benefit St; thence West on Meeting St; thence South on N Main St; thence Southeast on S Main St to the point of beginning.

THIRD WARD

The Third Ward of the City of Providence shall consist of all that part of the City bounded by a line beginning at the intersection of Smith St and the Mosshasuck River; thence South on the Mosshasuck River; thence East on Park Row; thence South on N Main St; thence East on Meeting St; thence North on Benefit St; thence North on N Main St; thence East on Olney St; thence North on Morris Ave; thence East on Emeline St; thence South on Taber Ave; thence East on Doyle Ave; thence North on Elmgrove Ave; thence West on Rochambeau Ave; thence North on Lorimer Ave; thence Northwest on Winfield Rd; thence West on 8th St; thence North on Hope St; thence Northeast on North Ave; thence Northwest on Blackstone Blvd; thence North on Hope St; thence West on the Providence - Pawtucket boundary line; thence Southwest on I- 95; thence Southeast on New York, New Haven and Hartford RR; thence East on Smith St to the point of beginning.

FOURTH WARD

The Fourth Ward of the City of Providence shall consist of all that part of the City bounded by a line beginning at the intersection of Douglas Ave and I - 95; thence Northeast on I- 95; thence West on the Providence - Pawtucket Boundary line; thence continue on the Providence - North Providence boundary line; thence Southeast on Douglas Ave; thence East on Concannon St; thence North on Moy St; thence East on Branch Ave; thence South on Louisquisset Pike; thence Southwest on the eastern boundary of Corliss Park and Mansion Park; thence South on Appian St; thence Southwest on Corina St; thence Southeast on Douglas Ave; thence Northeast on Berkshire St; thence Southeast on March St; thence Northeast on Chad Brown St; thence Southeast on the southern boundary of census block 440070027003019; thence Southwest on Fillmore St; thence Southeast on Douglas Ave; thence Northeast on Chalkstone Ave; thence South on N Davis St; thence East on Douglas Ave to the point of beginning.

FIFTH WARD

The Fifth Ward of the City of Providence shall consist of all that part of the City bounded by a line beginning at the intersection of Chalkstone Ave and Leah St; thence South on Leah St; thence East on Roanoke St; thence North on Carleton St; thence East on Chalkstone Ave; thence Northwest on Rosebank Ave; thence Northeast on Pleasant Valley Pkwy; thence Northwest on Convent St; thence Northeast on Maude St; thence Northwest on Smith St; thence North on Tyndall Ave; thence West on Eaton St; thence South on River Ave; thence Northwest on Smith St; thence North on Enfield Ave; thence West on Isabella Ave; thence North on Gentian Ave; thence East on Texas Ave; thence Northwest on Admiral St; thence Southwest on the Providence - North Providence boundary line; thence continue on the Providence - Johnston boundary line; thence Northeast on Manton Ave; thence East on Chalkstone Ave to the point of beginning.

SIXTH WARD

The Sixth Ward of the City of Providence shall consist of all that part of the City bounded by a line beginning at the intersection of the Providence - Johnston boundary line and the Woonasquatucket river; thence Northwest on the Providence - Johnston boundary line; thence Northeast on Manton Ave; thence east on Chalkstone Ave; thence South on Leah St; thence East on Roanoke St; thence North on Carleton St; thence East on Chalkstone Ave; thence South on Bergen St; thence West on Regent Ave; thence South on Huron St; thence West on the Northern boundary of census block 440070022003006; thence South on Academy Ave; thence West on Atwells Ave; thence South on Putnam St; thence West on Amherst St; thence Northwest on Manton Ave; thence Southwest on Salmon St, continuing on the western boundary of census block 440070019003001; thence east on Hwy 6; thence Southerly, Westerly, and Northwesterly on the Woonasquatucket river to the point of beginning.

SEVENTH WARD

The Seventh Ward of the City of Providence shall consist of all that part of the City bounded by a line beginning at the intersection of the Providence - Cranston boundary line and Terrace Ave; thence North on Terrace Ave; thence West on Shafter St; thence North on Laurel Hill Ave; thence East on Plainfield St; thence North on Webster Ave; thence East on Eastwood Ave; thence South on Heath St; thence East on Laban St; thence Northeast on Plainfield St; thence Northwest on US Hwy 6; thence Southerly, Westerly, and Northwesterly on the Woonasquatucket river; thence Westerly, Southerly, and Easterly on the Providence - Johnston boundary line to the point of beginning.

EIGHTH WARD

The Eighth Ward of the City of Providence shall consist of all that part of the City bounded by a line beginning at the intersection of the onramp of State Route 10 and Park Ave; thence North on State Rte 10; thence North on Elmwood Ave; thence South on Reservoir Ave; thence Northwest on Amtrak railroad; thence Northeast on the eastern boundary of census block 440070014004026; thence Southeast on Huntington Ave; thence East on Carter St; thence North on Bucklin St; thence North on Dexter St; thence West on Sprague St; thence North on Diamond St; thence West on Hollis St; thence North on Parade St; thence West on Chapin Ave; thence South on Messer St; thence West on Union Ave; thence South on State Rte 10; thence Southerly, Easterly, and Southeasterly on Providence - Cranston boundary line to the point of beginning.

NINTH WARD

The Ninth Ward of the City of Providence shall consist of all that part of the City bounded by a line beginning at the intersection of the onramp of State Route 10 and Park Ave; thence Easterly and Northerly on the Providence - Cranston boundary line; thence West on Montgomery Ave; thence west on F C Greene Memorial Blvd; thence Northeast on Hawthorne Ave; thence Northwest on Broad St; thence West on Plenty St; thence West on Bellevue Ave; thence South on Bucklin St; thence West on Carter St; thence Northwest on Huntington Ave; thence Southwest on the eastern boundary of census block 440070014004026; thence Southeast on Amtrak railroad; thence North on Reservoir Ave; thence Southeast on Elmwood Ave; thence Southeast on the onramp of State Route 10 to the point of beginning.

TENTH WARD

The Tenth Ward of the City of Providence shall consist of all of that part of the City bounded by a line beginning at the intersection of Montgomery Ave and F C Greene Memorial Blvd; thence Northwest F C Greene Memorial Blvd; thence Northeast on Hawthorne Ave; thence Northwest on Broad St; thence East on Gladstone St; thence North on Baxter St; thence East on Potters Ave; thence South on Gordon Ave; thence East on Oxford St; thence North on I- 95; thence East on Public St, extending to the Providence - East Providence boundary line; thence South on the Providence - East Providence boundary line; thence west on the Providence - Cranston boundary line; thence West on Montgomery Ave to the point of beginning.

ELEVENTH WARD

The Eleventh Ward of the City of Providence shall consist of all of that part of the City bounded by a line beginning at the intersection of Gordon Ave and Oxford St; thence East on Oxford St; thence North on I- 95; thence East on Public St; thence North on the Providence river; thence Southwest on I- 195; thence West on I- 95; thence Southwest on Westminster St; thence South on Bridgham St; thence Southwest on Cranston St; thence South on Parade St; thence East on Hollis St; thence South on Diamond St; thence East on Sprague St; thence South on Dexter St; thence South on Bucklin St; thence East on Bellevue Ave; thence East on Plenty St; thence South on Broad St; thence East on Gladstone St; thence North on Baxter St; thence East on Potters Ave; thence South on Gordon Ave to the point of beginning.

TWELFTH WARD

The Twelfth Ward of the City of Providence shall consist of all of that part of the City bounded by a line beginning at the intersection of Atwells Ave and the Woonasquatucket River; thence Northeast on the Woonasquatucket River; thence South on I- 95; thence East on Memorial Blvd; thence Northeast on Steeple St; thence North on the Moshassuck river; thence West on Smith St; thence North on New York New Haven and Hartford RR; thence Southwest on I- 95; thence Northwest on Douglas Ave; thence North on N Davis St; thence West on Chalkstone Ave; thence Northwest on Douglas Ave; thence Northeast on Fillmore St; thence Northwest on the southern boundary of Census Block 440070027003019; thence Southwest on Chad Brown St; thence Northwest on March St; thence Southwest on Berkshire St; thence South on Douglas Ave; thence West on Eaton St; thence South on Pembroke Ave; thence Northwest on Smith St; thence Southwest on Maude St; thence Southeast on Convent St; thence Southwest on Pleasant Valley Pkwy; thence Southeast on Rosebank Ave; thence West on Chalkstone Ave; thence South on Bergen St; thence West on Regent Ave; thence South on Huron St; thence West on the Northern boundary of census block 440070022003006; thence South on Academy Ave; thence East on Atwells Ave to the point of beginning.

THIRTEENTH WARD

The Thirteenth Ward of the City of Providence shall consist of all of that part of the City bounded by a line beginning at the intersection of Union Ave and Messer St; thence North on Messer St; thence East on Chapin Ave; thence Northeast on Cranston St; thence Northwest on Bridgham St; thence East on Westminster St; thence Northwest on I- 95; thence Southwest on the Woonasquatucket river; thence East on Atwells Ave; thence Southwest on US Hwy 6; thence South on State Rte 10; thence East on Union Ave to the point of beginning.

FOURTEENTH WARD

The Fourteenth Ward of the City of Providence shall consist of all of that part of the City bounded by a line beginning at the intersection of Pembroke Ave and Eaton St; thence East on Eaton St; thence North on Douglas Ave; thence Northeast on Corina St; thence North on Appian St; thence Northeast on the eastern boundary of Corliss / Mansion Park; thence Northeast on Hawkins St; thence Northwest on Louisquisset Pike; thence West on Branch Ave; thence South on Moy St; thence West on Concannon St; thence Northwest on Douglas Ave; thence Southwest on the Providence - North Providence boundary line; thence Southeast on Admiral St; thence West on Texas Ave; thence South on Gentian Ave; thence East on Isabella Ave; thence South on Enfield Ave; thence Southeast on Smith St; thence North on River Ave; thence Southeast on Eaton St; thence South on Tyndall Ave; thence Southeast on Smith St; thence North on Pembroke Ave to the point of beginning.

FIFTEENTH WARD

The Fifteenth Ward of the City of Providence shall consist of all of that part of the City bounded by a line beginning at the intersection of Terrace Ave and the Providence - Cranston boundary line; thence Northwest on Terrace Ave; thence West on Shafter St; thence North on Laurel Hill Ave; thence East on Plainfield St; thence North on Webster Ave; thence East on Eastwood Ave; thence South on Heath St; thence East on Laban St; thence Northeast on Plainfield St; thence Northwest on US Hwy 6; thence Northeast on the western boundary of census block 440070019003001, continuing on Salmon St; thence Southeast on Manton Ave; thence East on Amherst St; thence North on Putnam St; thence East on Atwells Ave; thence Southwest on US Hwy 6; thence South on State Rte 10; thence Northerly and Westerly on the Providence - Cranston boundary line to the point of beginning.

SECTION 2. It shall be understood and intended that in bounding and describing the said Wards, that the said boundary lines of streets, streams, rivers and railroads is meant in all instances the central line of such street, stream, river or railroad, unless the same be otherwise specified.

SECTION 3. This Ordinance shall be liberally construed to effectuate the purposes thereof and to apportion the City into fifteen wards in compliance with the Home Rule Charter of the City of Providence. It is intended that the fifteen wards described herein completely encompass all the area within the City and contain all the citizens resident in the City. It is further intended that the ward boundaries provided for in this Ordinance result in the creation of wards containing substantially equal population, that natural boundaries be used and recognized neighborhoods be included within wards without arbitrary divisions thereof, so far as practicable.

SECTION 4. This Ordinance shall take effect upon its passage; provided, however, that the provisions hereof shall first be effective in connection with elections to be held on or subsequent to the first day of September, 2022, and for the purpose of greater clarity, the first election under the provisions of this Ordinance for City Council Wards hereby created, shall be held on the Tuesday next after the first Monday in November, 2022, and the first primary election under the provisions of this Ordinance for nomination of candidates for City Council from each of the fifteen wards shall be held on the second Tuesday after the first Monday in September, 2022, provided however, that if any of the provisions of this Ordinance or the application of such provision to any court of competent jurisdiction, or if any action performed under the provision of this Ordinance is restrained or enjoined by any court of competent jurisdiction, the remaining provisions of this Ordinance shall not be deemed impaired or affected thereby but shall be deemed to remain in full force and effect.

IN CITY COUNCIL
APR 11 2022
FIRST READING
READ AND PASSED

Tina L. Mastromarino CLERK
ACTING

IN CITY
COUNCIL
APR 14 2022
FINAL READING
READ AND PASSED

JOHN J. IGLOZZI, PRESIDENT
Tina L. Mastromarino ACTING CLERK

I HEREBY APPROVE.

Mayor

Date:

4/25/22

From: Shirley Francis-Fraser <sffras@gmail.com>

To: tmastroianni@provri.gov, wardboundaries@providenceri.gov

Cc: Nirva LaFortune <nirvaward3@gmail.com>, Jessica Cigna <jessica.cigna@gmail.com>

Bcc:

Date: Tue, 29 Mar 2022 20:06:31 -0400

Subject: Reject Map 2 Stop Mt Hope Gerrymandering and Voter Disfranchisement

Dear City Council Members:

The proposed redistricting map gerrymanders Mt Hope. In addition to taking land from Ward 3's Mt Hope area and placing it in Ward 2, the map puts the Nathan Bishop Middle School in Ward 2. Nathan Bishop Middle School has been a polling place in Mt Hope for numerous years. Moving it to Ward 2 could disenfranchise voters. Please reject the proposed redistrict Map (Map2) and save the Mt Hope neighborhood. Map 1, which leaves the Mt. Hope neighborhood intact, should have been proposed by the Ward Boundary Committee.

Sincerely,

Shirley Francis-Fraser

To Whom It May Concern,

The proposed redistricting map gerrymanders Mt Hope. In addition to taking land from Ward 3's Mt Hope area and placing it in Ward 2, the map puts the Nathan Bishop Middle School in Ward 2.

Nathan Bishop Middle School has been a polling place in Mt Hope for numerous years. Moving it to Ward 2 could disenfranchise many voters.

Please reject the proposed redistrict Map (Map2) and save the Mt Hope neighborhood. Map 1, which leaves the Mt. Hope neighborhood intact, should have been proposed by the Ward Boundary Committee.

Sincerely,

Marisol Feliciano

Ladies and gentlemen:

The proposed redistricting map gerrymanders Mt Hope. In addition to taking land from Ward 3's Mt Hope area and placing it in Ward 2, the map puts the Nathan Bishop Middle School in Ward 2. Nathan Bishop Middle School has been a polling place in Mt Hope for numerous years. Moving it to Ward 2 could disenfranchise voters. Please reject the proposed redistrict Map (Map2) and save the Mt Hope neighborhood. Map 1, which leaves the Mt. Hope neighborhood intact, should have been proposed by the Ward Boundary.

Thank you!

Jim Vincent, president

NAACP Providence Branch

From: vin [usacompassioncorps.com](mailto:vin@usacompassioncorps.com) <vin@usacompassioncorps.com>
Sent: Wednesday, March 30, 2022 11:11 AM
To: tmastroianni@provri.gov; Wardboundaries@providenceri.gov
Cc: nirvaward3@gmail.com; jessica.cigna@gmail.com
Subject: Proposed Redistricting Map - Mt. Hope disenfranchisement

The proposed redistricting map gerrymanders Mt Hope. In addition to taking land from Ward 3's Mt Hope area and placing it in Ward 2, the map puts the Nathan Bishop Middle School in Ward 2. Nathan Bishop Middle School has been a polling place in Mt Hope for numerous years. Moving it to Ward 2 could disenfranchise voters. Please reject the proposed redistrict Map (Map2) and save the Mt Hope neighborhood. Map 1, which leaves the Mt. Hope neighborhood intact, should have been proposed by the Ward Boundary Committee.

Thank you for your consideration.

Vin



Vincent Marzullo, Founder
USA Compassion Corps
28 Crossland Road
West Warwick, RI 02893
401-486-6404
Daily acts of compassion strengthen social unity.

March 29, 2022

Dear Members of the Committee on Ward Boundaries:

My name is Regina Clement and a resident and home owner in Providence. I have become increasingly concerned about the council's decision to adopt the proposed Ward Boundaries/Redistricting Map that was presented at the March 28, 2022 public hearing. Upon reviewing the proposed map, I find that many questions/concerns raised by residents in several wards have been completely ignored or half heartedly addressed. I feel more opportunities for public hearings should be considered, especially after notice of meetings have been made with short notice or no notice at all.

Several Wards within Providence will be losing historic landmarks/locations in the City's attempt to re-draw the Ward Boundaries. For example, several Communities of Color have expressed concern about voter disenfranchisement in the proposed removal of land and polling places in Ward 3. It is critically

important that Communities of Color be involved, as the redistricting process impacts our ability to build and maintain independent political power and advance the issues that impact our communities daily. Redistricting has real life impacts on Communities of Color and the marginalized. For example, Ward 3/Mt Hope, an area which has historically elected Candidates of Color, is being challenged with this redistricting proposal.

I would like to encourage the Council to reconsider approving this proposed map in the hopes of including Communities of Color and the marginalized in the process of finalizing the map for Ward Boundaries.

Sincerely,

Regina L. Clement

To the honorable members of the Providence City Council:

Since February, residents of the Mount Hope neighborhood of the city of Providence have battled the gerrymandering of their beloved community. The proposed redistricting map gerrymanders Mount Hope neighborhood. In addition to taking land from Ward 3 Mount Hope area and placing it in Ward 2, the map puts the Nathan Bishop Middle School in Ward 2. Nathan Bishop Middle School has been a polling place in Mt Hope for numerous years. Moving it to Ward 2 could disenfranchise voters.

Please reject the proposed redistrict Map (Map2) and save the Mt Hope neighborhood. Map 1, which leaves the Mount Hope neighborhood intact, should have been proposed by the Ward Boundary Committee.

Respectfully,
NAACP Providence Branch

(Received on March 30, 2022)

Council President John J. Iglizzi
City of Providence
25 Dorrance Street, Room 310
Providence, RI 02903

Regarding Ward Boundaries Testimony

To the Providence City Council Members,

I'll never tire to say that it was my pleasure to serve the residents of Providence as a member of the Providence Ward Boundaries Committee over the last year and I once again thank you for the opportunity to do so.

I have been cc'd on several of the pieces of emailed testimony submitted to the city council on March 29 and 30 regarding Ward 3 and so I have read what was submitted.

I am saddened to read this recent testimony as it insinuates that the committee engaged in gerrymandering. This is an unfortunate accusation and could not be further from the truth. The committee held all of its meetings in public, held five public hearings and accepted public testimony for over a year, it reported its subcommittee work in public committee meetings, and as the committee chair I was present in every meeting between city councilors and the mapping consultants. At no time were changes to boundaries for political gain nor to hurt any particular group of voters or any neighborhood. In fact, because of the its work, the committee was lauded by press and a good government group for its transparency.

Further, Councilors LaFortune and Anthony, councilors for the Wards in which gerrymandering has been insinuated, both spoke in public about their requests and have been completely transparent about what they did request for changes to the Ward boundaries. In no way did either city councilor ask for changes to "district boundaries with the intent of creating undue advantage for a party, group, or socio-economic class within the constituency." As documented in the Ward Boundaries Committee report, the committee purposefully landed on the proposed boundaries to ensure that Ward 3 remain as high as possible in its proportion of non-Hispanic Black residents.

An ask in the testimony is to move Nathan Bishop back in to Ward 3. Upon hearing testimony from Councilors LaFortune and Anthony at the final committee meeting on March 7 2022, the committee recognized that Nathan Bishop should be moved back into Ward 3 and in its final report directed the council to try to find a viable map which can do that. This was done weeks in advance of this uninformed testimony. Also, I must note that Nathan Bishop has only been in Ward 3 for the past decade. In Exhibit 1 below it is noted that Ward 3's boundaries were moved to include Nathan Bishop Middle in 2012 (Orange Solid lines) after the school had been in Ward 2 in the 1992 (Black Solid lines) and 2002 (Blue Solid lines) ward boundaries. Finally, in comparing the maps in Exhibit 1 and 2, you can see that Nathan Bishop is not in the city-designated Mount Hope neighborhood but is in the Blackstone Neighborhood.

Thank you for your time and attention to this. These are my personal opinions that I submit this as a private citizen and not on behalf of the committee.

Jessica Cigna

Former Chair of the Ward Boundaries Committee

150 Dexterdaled Rd

Exhibit 1: Historical and Proposed Ward 3 lines

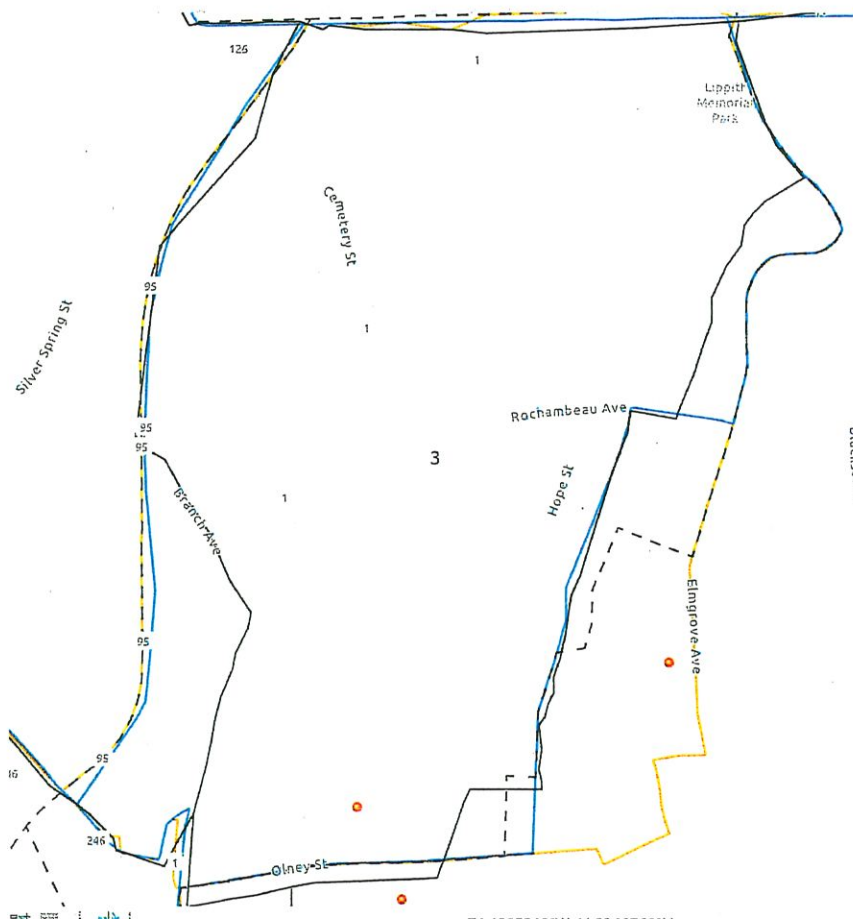

Dashed Black lines= Ward 3 Proposed in 2022

Solid Orange lines = Ward 3 2012-2021

Solid Blue lines = Ward 3 2002 to 2011
Solid Black lines = Ward 3 1992 to 2001

(Received on April 1, 2022)

Received on April 4, 2022 at 6:37 PM from Mr. Gerard Catala

KEEP ROGER WILLIAMS PARK IN WARD 9 / KEEP OUR PARK IN NINE (KOPIN)

"The residents of Ward 9 are tired of struggling to get by with no attention to our community's concerns and needs while being plagued with systematic expectation to cope with being ignored and voiceless. We need to make sure the City Council knows, we demand they "KEEP OUR PARK IN NINE"... are tired of being ignored, we are tired simply KOPIN". - Gerard C. Catala

To all our friends, neighbors, and supporters, please take the time to sign this very important community petition to "KEEP ROGER WILLIAMS PARK IN WARD 9's Elmwood section of Providence.

As we all know, every 10 years, per our City of Providence's Home Rule Charter, we have to redraw our City's Ward Boundaries. This process is conducted by a special committee consisting of 5 members who are "qualified electors" domiciled in the City Of Providence using information taken from the U.S. Census.

The criteria for redrawing our Ward Boundaries can be found at the following website: https://library.municode.com/ri/providence/codes/code_of_ordinances?nodeId=PTIHORUCH_ARTIIEI_204WAWABO

Based on explanations and justifications contained in the Ward Boundaries Final report, It is my position, the reasoning and formula that was used by the Redistricting Committee to produce and subsequently submit for confirmation, a map that would extract Roger Williams Park and deracinate the residents of Elmwood / South Elmwood from Ward 9 was done arbitrarily and is not in direct accordance with the criteria set forth by our City's Home Rule Charter section 204 (C) 1-6. This petition demands the current map submitted to the Full Council for consideration be amended to leave the voters/electors and Roger Williams Park along with all its structures, buildings and amenities in its current geographical location, sustained within the boundaries of Ward 9.

Though the definition is vague and almost undefined, based on the criteria used and precedence set by the Committee to keep buildings, schools, landmarks, and other historical churches and green spaces in their respective Wards, it is my further position that Roger Williams Park should in fact be protected and considered a COMMUNITY OF INTEREST.

204. - Wards and ward boundaries. The geographic integrity of any local neighborhood, or local community of interest, shall be respected in a manner that minimizes their division to the extent possible without violating the requirements of any of the preceding subdivisions. A community of interest is a contiguous population which shares common social and economic interests that should be included within a single ward for purposes of its effective and fair representation. Examples of such shared interests are those common to an urban area, an industrial area, and those common to areas in which the people share similar living standards, use the same transportation facilities, have similar work opportunities, or have access to the same media of communication relevant to the election process. Communities of interest shall not include relationships with political parties, incumbents, or political candidates.

The Residents and Businesses of Ward 9 wholly feel the Elmwood / South Elmwood Community including RWP should constitute as a COMMUNITY OF INTEREST cemented within our borders. The same consideration that was taken to maintain borders separating Wards 3 and 2 that focused on keeping the Non- Hispanic Black population of Ward 3 from being split up and intruding into the Ward 2's Blackstone neighborhood should justify the need to keep ward 9's Elmwood and South Elmwood sections contiguous and protected as a Community of Interest.

Even in a state of quandary, the Committee documented the following acknowledgment, "The only item left unanswered with Ward 3 is the loss of Nathan Bishop Middle School to Ward 2 which the Committee acknowledged in its final vote as necessitating further revision by the City Council prior to final passage". I maintain the same acknowledgement should have been made for RWP with regards to the momentous decision to propose a relocation out of Ward 9. The residents of Ward 9 would have been honored to have an advocate at the table that could have articulated this demand and fought the Committee against the Detroit Avenue and Miller Avenue severance (DAMAS).

Additionally, RWP which currently sits within the Ward 9 boundaries, was not only overlooked as a COI but, the newly proposed map attempts to take some of our and places them in ward 10. This will leave Ward 9 with fewer voters and less land opposed to a much better solution to simply extend the borders of Ward 9 Northbound to include the entirety of Providence's Elmwood Section.

In contrast, the same proposed map is attempting to annex the non residential, non voter occupied green space, along with its buildings, parks, baseball fields, tennis courts, the zoo, the historic Carousel and all contiguous land and place it across the natural border that is Elmwood Avenue in an effort to place it into Ward 8. In doing so, this separates and detaches Ward 9 from itself completely ignoring the criteria for keeping communities contiguous. This also takes the smallest geographical Ward south of Downtown and makes us even smaller while the other 3 Wards grow.

Not only does this proposal attempt to take RWP and some lifelong residents out of Ward 9, the new map proposes to extend the Ward 9 boundaries West across Elmwood Ave down towards Bucklin Street but strategically leaves out the Newly renovated Football Field and adjoining Park and Pool. In short, they want to annex RWP from Ward 9 and Keep Bucklin Park along with its amenities in Ward 8. This is UNFAIR, UNJUSTIFIED, and UNACCEPTABLE and we cannot let this go UNADDRESSED.

Point of note: If you look at the map it strategically serpentine from Broad Street to Elmwood Avenue in the park to intentionally place the residence in one Ward while giving another ward the land which contains no electors. The people of Ward 9 demand a justification for such an action that goes against our Home Rule Charter that states **204. - Wards and ward boundaries. "To the extent practicable, and where this does not conflict with the criteria above, wards shall be drawn to encourage geographical compactness such that nearby areas of population are not bypassed for more distant population"**.

Per the final report, There were some concessions and acknowledgments that warranted further action and revision. This included strong objections, some so heartfelt and strong one could construe there was a verbal remonstrance through public testimony to leave downtown, accepted by the committee as another "Community of Interest" unchanged and potentially perpetual. Again, that is within the right of the people to do so which is why testimony is allowed, however, I would argue the same consideration should have been made for RWP, and through this testimony I strongly encourage that RWP and the residents along the borders remain unchanged and confined to nine.

You can find my full justification at: <https://www.facebook.com/groups/1124538585047422>

It is my understanding, the issue of Ward Boundaries will take place at either April 7th or a subsequent City Council Meeting (to be determined) to vote on the proposed map. I strongly suggest we be prepared for both dates. AS TIME IS OF THE ESSENCE, we need to immediately appeal to as many supporters as we can and ask them to join our COMMUNITY OF INTEREST CAUSE, and sign our petition. We need a lot of signatures in a short period of time so we can show up to the City Council Chamber on both days or everyday if need be as an undenied unified force to present our petition to the City Council and DEMAND THEY HEAR OUR VOICES NOW OR HEAR THEM ON ELECTION DAY 2022.

Please share this Group and Petition with Friends and Family, People and Politicians, Students and Staffers, Adults and Adolescents, regardless of where they live in our great city. Encourage everyone to join the group, sign, and support us in our endeavor to KEEP OUR PARK IN NINE as our already overly distressed community is tired of simply KOPIN while the rest of the city is stress free and flourishing.

I, Gerard C. Catala, of 27 Rodman Street and Ward 9 Resident of over 40 years, Humbly and Respectfully call on us all to get involved and get active with this petition and any causes or initiatives that call for a better quality of life and a more impactful equity change. Yes, I'm still serious about change, but, I'm more than ever, "Committed to Community and Elwood has been my community and my home for my entire life... Who or what I would be if I didn't love and fight for her. Thanks for taking the time to read my position and my testimony and I ask that the forgoing is submitted into the City's records and is used to consider amending the current map as proposed to leave Roger Williams Park and the residents surrounding her borders within the territory of ward 9.

Good morning,

I am writing to oppose the use of Chalkstone Ave as an arbitrary line between the 5th and 6th Wards. I am asking that my section of Carleton St and the surrounding area remain a part of the 5th Ward.

As a voter, I feel that Jo-Ann Ryan has been responsive and proactive. I hope to keep her as my representative.

Thank you.

James Scott
13 Carleton St
(Received Tue 4/5/2022 9:22 AM)

Providence Ward Redistricting
Council Proposal

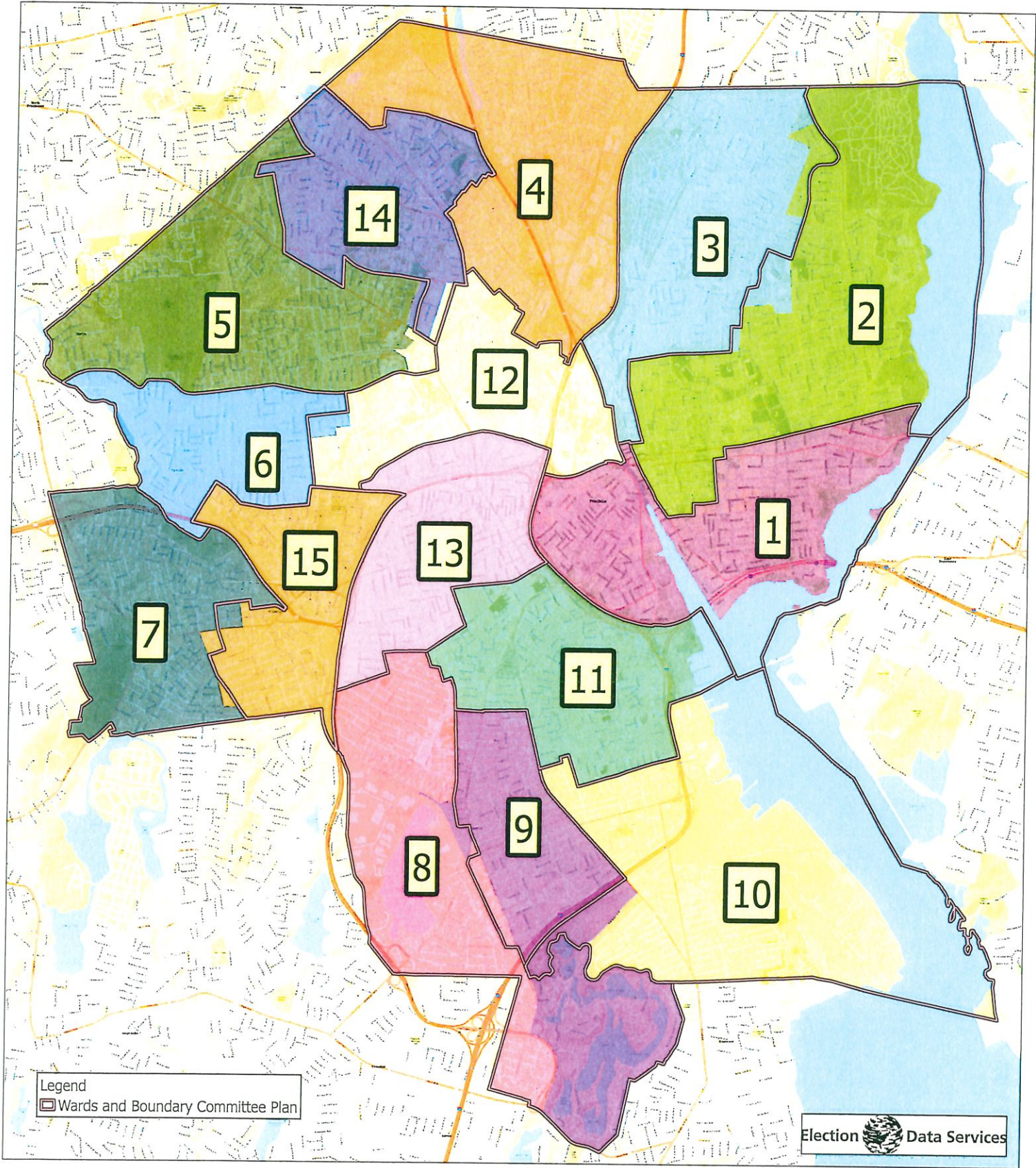

DISTRICT	Adjusted Population Tabulation				Original Population Tabulation				Racial Demographics as Percent of Adjusted Total Population					Racial Demographics as Percent of Adjusted Voting Population				
									NH White	NH Black	NH Asian	Hispanic	Non-White	NH White	NH Black	NH Asian	Hispanic	Non-White
1	13,369	12,754	4.82%	618	13,363	12,729	4.88%	624	58.59%	5.83%	17.21%	11.44%	41.44%	58.59%	5.42%	18.28%	11.02%	41.01%
2	13,361	12,754	4.76%	607	13,361	12,754	4.76%	607	68.91%	3.07%	12.10%	8.27%	31.00%	68.65%	3.88%	12.63%	8.40%	31.45%
3	13,273	12,754	4.85%	619	13,357	12,729	4.83%	628	61.83%	9.81%	14.65%	18.37%	35.14%	56.89%	8.22%	8.80%	8.44%	35.08%
4	12,273	12,754	-3.77%	-481	12,235	12,729	-3.88%	-494	27.96%	17.70%	2.82%	43.54%	72.04%	33.87%	17.00%	2.55%	38.63%	66.13%
5	12,126	12,754	-4.82%	-628	12,112	12,729	-4.80%	-617	48.82%	11.77%	2.40%	30.38%	51.20%	53.84%	11.48%	2.40%	28.32%	46.06%
6	12,230	12,754	-4.27%	-524	12,691	12,729	-4.29%	-538	14.42%	14.25%	3.57%	62.56%	85.58%	17.45%	14.67%	3.95%	59.24%	82.55%
7	13,204	12,754	3.53%	450	13,175	12,729	3.50%	446	14.11%	8.81%	3.41%	63.68%	83.88%	18.84%	8.70%	3.89%	68.88%	83.05%
8	12,819	12,754	0.51%	65	12,784	12,729	0.43%	55	11.03%	10.99%	10.34%	63.69%	88.97%	12.70%	11.20%	10.99%	61.27%	87.20%
9	12,202	12,754	-4.33%	-552	12,178	12,729	-4.33%	-551	11.20%	12.90%	4.54%	68.86%	88.80%	12.89%	12.78%	4.35%	63.72%	87.11%
10	12,203	12,754	-4.54%	-551	12,271	12,729	-4.40%	-458	16.41%	15.23%	3.02%	59.07%	83.59%	18.90%	16.18%	3.11%	55.07%	81.10%
11	13,229	12,754	4.12%	475	12,184	12,729	-4.28%	-545	12.18%	20.91%	3.41%	59.37%	87.82%	14.81%	20.89%	3.71%	55.68%	85.49%
12	13,358	12,754	4.74%	604	13,328	12,729	4.71%	599	27.33%	14.70%	7.49%	44.51%	72.67%	21.55%	14.54%	8.20%	41.00%	68.45%
13	12,430	12,754	-2.54%	-324	12,416	12,729	-2.46%	-313	47.38%	8.34%	5.89%	32.88%	52.82%	51.60%	8.22%	5.91%	29.33%	48.40%
14	12,100	12,754	-2.71%	-345	12,074	12,729	-2.71%	-345	46.04%	15.53%	2.18%	29.83%	53.16%	67.65%	15.88%	2.24%	26.44%	47.98%

Total Deviation - 9.78%
Hispanic VAP Majority Wards - 7
Hispanic VAP Plurality Wards - 2
Largest NH Black Ward - 11 (20.5%)

Introduction

In conformity with Section 204 of the Providence Home Rule Charter, the Providence City Council hosted a public hearing on March 28, 2022 in order to receive testimony regarding the proposed Ward Boundary Map that was submitted to the Council by the Ward Boundary Committee. Following the public hearing, and in response to testimony received during the meeting as well as over the following days via written submissions, the City Council worked with Election Data Services (EDS) to attempt to address concerns raised by local residents.

The Council Proposal, reproduced in full at the start of this report, is the culmination of a several months of effort by the Ward Boundary Committee, the City Council, and the feedback of Providence residents. The vast majority of the map is a result of the diligent work of the Ward Boundary Committee and the full breakdown of the Committee's process can be found through their final report. The deviations from the committee map that have been made by the City Council all fall under the same rationale which was a desire to maintain community amenities in their respective Wards if possible. In an effort to outline the purpose for the changes made from committee that are contained in the Council Proposal, a detailed explanation for each change is outlined below.

Alterations from Committee Map

Wards 2 and 3

In the Ward Boundary Committee report, the Committee recognized that there was an issue with the line that was drawn between Wards 2 and 3. Specifically, the Committee's proposal inadvertently resulted in Nathan Bishop Middle School being removed from Ward 3 and placed into Ward 2. At the City Council Public Hearing there was testimony from the community asking for this to be rectified as Nathan Bishop Middle School is an integral part of the fabric of Ward 3. The Council Proposal results in the school being moved back into Ward 3, however it is important to note that moving the school did result in a sizeable population shift that needed to be rebalanced in order to maintain both Ward 2 and Ward 3 within the acceptable population deviation limits, while keeping communities of interest whole.

Wards 8 and 9

The City Council received significant oral and written testimony around the significance of maintaining Roger Williams Park within Ward 9. The placement of Roger Williams Park back into Ward 9, while not a huge population shift, did necessitate a minor alteration of the boundary line between Wards 8 and 9 in order to maintain the wards within the acceptable population deviation limits. The resulting outcome shown in the Council Proposal has the majority of the boundary line between Wards 8 and 9 respecting the boundary that has existed for the past ten years. This change did not result in any impacts to the Committee Map for the remaining Wards in South Providence.

Wards 7 and 15

The next alteration made in the Council Proposal was to make minor alterations to the boundary between Wards 7 and 15 in order to retain the Scalabrini Dukceovich Center within Ward 15. The Scalabrini Dukceovich Center is a local community center that has been in Ward 15 for many years and was a priority to maintain in the Ward if possible. The Council Proposal modifies the boundary line between the two Wards by using Laurel Hill Avenue as the predominant boundary below Plainfield Street. In order to rebalance the population shift that results from the change south of Plainfield Street, the boundary between Wards 7 and 15 north of Plainfield Street was moved from Ralph Street to Webster Avenue which has been used in the past as a boundary for the two Wards.

Wards 12, 5, 14, and 6

The final changes made in the Council Proposal are all centered around the boundary lines of Wards 12, 5, 14, and 6. The Committee Map expanded Ward 5 beyond the Roger Williams Medical Center, its existing boundary, and had Nathanael Greene Middle School being moved out of Ward 12. The Council Proposal shifts Ward 5 back to its existing boundary along Roger Williams Medical Center while maintaining the Ward within the acceptable population deviation limits.

The Council Proposal also shifts Ward 14 by bringing the Ward down Tyndall Avenue and Pembroke Avenue, rather than Pinehurst Avenue and Oakland Avenue. This alteration allows Ward 12 to retain Oakland Avenue within Ward 12 without impacting the population for Ward 14. The outcome for Ward 12 as a result of the two changes just described pushed its population to the upper limits of acceptable deviation. However, by making these changes it enables the Council Proposal to also expand Ward 6 from Andem Street down to Regent Avenue, thereby retaining Blessed Sacrament Church and Blessed Sacrament Catholic School within Ward 6.

The resulting Wards are still fully within the acceptable population deviation limits while retaining several key community amenities within their original Wards.

Conclusion

The Council Proposal is an effort to respect the exceptional work of the Ward Boundary Committee while retaining several key community amenities within their existing Wards. The changes are based off feedback received by the City Council from the local community members and in the case of Wards 2 and 3, at the request of the Ward Boundary Committee. The full history of the Ward Boundary process, including all maps reviewed by the Ward Boundary Committee, can be found by visiting the City Council's website at:

<https://council.providenceri.gov/ward-boundaries/>

Mastroianni, Tina

From: Ryan Taylor <ryan@cleverpixel.net>
Sent: Monday, April 11, 2022 9:47 AM
To: Mastroianni, Tina; Bouchard, Sean
Subject: Redistricting Ordinance technical amendment letter

On April 7, 2022, Election Data Services sent a metes and bounds report on the proposed Redistricting boundaries for Providence's Wards. It was later shown that due to a software glitch, not all of the boundary lines were fully identified by name or census block boundary. A complete metes and bounds report was submitted later in the evening as soon as possible after the glitch was discovered. Due to requirements on Agenda posting deadlines, this complete metes and bounds report is being introduced as a technical amendment to the Ordinance.

Ryan Taylor
Election Data Services