

RESOLUTION OF THE CITY COUNCIL



No. 172

Approved April 9, 2025

RESOLVED, DECREED AND ORDERED:

Petitioner THE NARRAGANSETT ELECTRIC COMPANY, a domestic utility currently doing business as Rhode Island Energy, located at 280 Melrose Avenue in Providence, has requested an easement over, under, and across City-owned land at 60 Camden Avenue (Assessor's Lot 215, Map 69). The City Council hereby authorizes the Mayor to enter into the easement attached as Exhibit A.

IN CITY COUNCIL
APR 03 2025
READ AND PASSED

RACHEL M. MILLER, PRESIDENT

CLERK

I HEREBY APPROVE.



Mayor

Date: 4/9/2025

GRANT OF EASEMENT

THE CITY OF PROVIDENCE, a Municipal Corporation organized under the laws of the State of Rhode Island (Grantor") for consideration paid, grants to THE NARRAGANSETT ELECTRIC COMPANY, a Rhode Island corporation having a principal place of business at 280 Melrose Street, Providence, Rhode Island 02907, ("Grantee"), its successors and assigns, with Quitclaim Covenants, a perpetual right and easement as described in Section 1 below ("Easement") in, under, through, over, across, and upon the Grantor's land, as described in Section 2 below ("Grantor's Land").

Section 1 – Description of Easement

The "Easement" granted by the Grantor to the Grantee consists of the perpetual right and easement:

- a) To install, construct, reconstruct, repair, replace, add to, maintain and operate an underground distribution system ("Distribution System") for the distribution of electric current to include a padmounted transformer, together with all the necessary wires, cables, conduits, transformers, handhole, pedestals, switches, anchors, guys, bollards, equipment, streetlights, fixtures and appurtenances installed therein and attached thereto, in, under, through, over, across and upon the Grantor's land, as may from time to time be required for the purpose of supplying electric service to the Grantor's Land and land of others adjoining the Grantor's Land;
- b) To clear and keep cleared from time to time the portions of the Grantor's Land wherein the Distribution System is located of such trees, shrubs, bushes, above ground and below ground structures, objects and surfaces as may in the opinion and judgment of the Grantee, its successors and assigns, interfere with the safe and proper operation of the Distribution System;
- c) To make such excavation or excavations as may be reasonable and necessary to construct, reconstruct, repair and remove the Distribution System. But the Grantee shall properly backfill any excavation and restore the surface of the Grantor's Land in as good condition as before the excavation was made; and
- d) To pass over and across the Grantor's Land as reasonable and necessary for all the purposes described in this Section.

Section 2 – Description of Grantor's Land

The "Grantor's Land" consists of land situated on the westerly side of Camden Avenue in the City of Providence, County of Providence, State of Rhode Island, designated as Lot 215, Providence Tax Assessor's Map 69, being a portion of those certain tracts or parcels of land conveyed to the Grantor by deed recorded with the Records of Land Evidence in Providence on November 18, 2013 in Book 10741, Page 209.

RE13798294PE
PG 1 \$49.00
49 PROVRI GEN

TO BE RECORDED AT:
City of Providence, City Clerk
25 Dorrance St, Providence, RI 02903

After recording return to:
Peter Espinal
The Narragansett Electric Co
280 Melrose St.
Providence, RI 02907

Property Address: 60 Camden Avenue, Providence, R.I.

Section 3 – Location of the Distribution System

The “Distribution System” shall extend in a general southerly direction from Pole #9-1 which is located on abutting property to the North, to the proposed padmounted transformer, which is to be located within certain portions of Grantor’s Land with an easement area around the padmounted transformer measuring fifteen (15) feet wide by fifteen (15) feet deep in size, as approximately shown on a sketch attached hereto as “Exhibit “A”, copies of which are in the possession of the Grantor and the Grantee herein. Final and definitive locations of said “Distribution System” shall become established by the installation and erection thereof by the Grantee. Said Distribution System shall be located in a location mutually satisfactory to the Grantor and to the Grantee and such location shall become established by and upon the installation thereof by the Grantee. The Grantor, for itself, its successors and assigns, covenant and agrees with the Grantee, for itself, its successors and assigns, that this Grant of Easement and the location of the Underground System may not be changed or modified without the written consent of the Grantee, its successors and assigns, which consent may be withheld by the Grantee in its sole discretion.

Section 4 – Distribution System Ownership

It is agreed that the Distribution System shall remain the property of the Grantee, its successors and assigns, and that the Grantee, its successors and assigns shall pay all taxes assessed thereon.

Exhibit A – Not to Scale

The exact location of said Facilities to be established by and upon the installation and erection of the Facilities thereof.

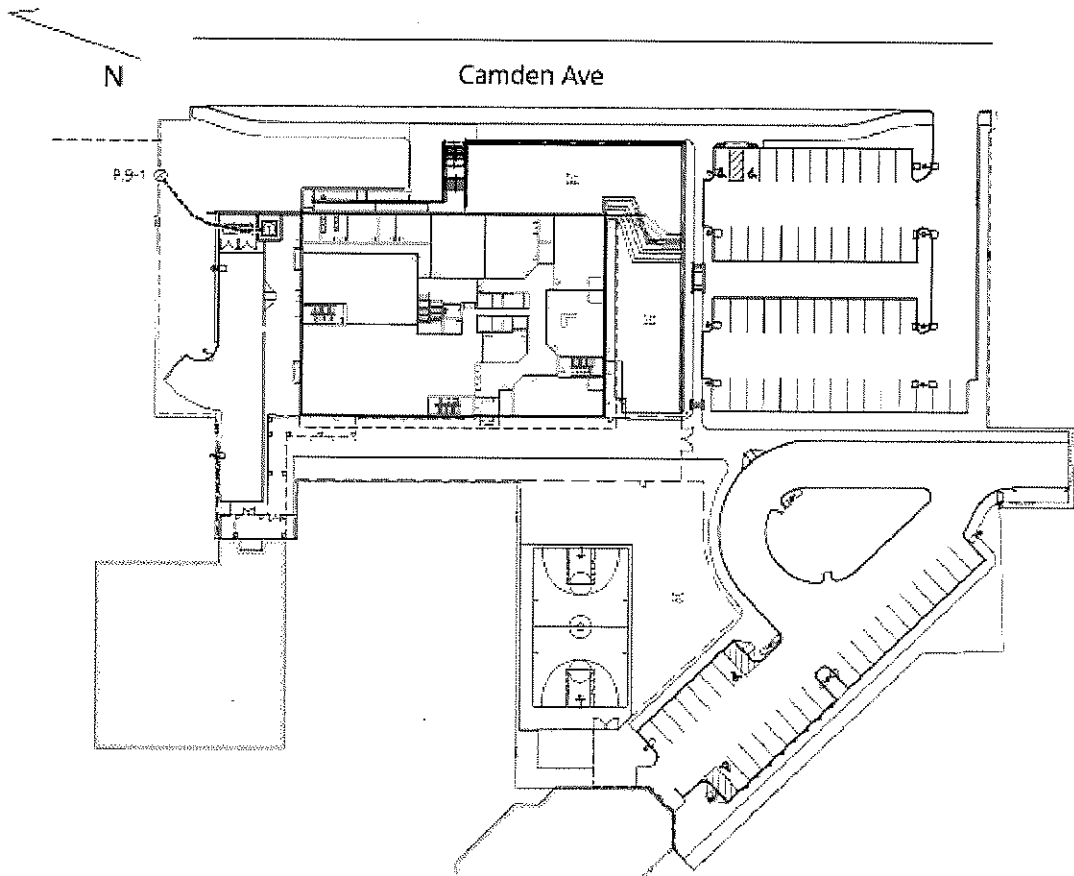

LEGEND

- ⊙ Existing Pole
- ⊠ New Proposed Padmount Transformer
- New Proposed UG Cable

ELECTRIC DISTRIBUTION EASEMENT

LEGEND		The Narragansett Electric Company	
See Above Sketch		Owner(s): Providence School Dept.	Address: 60 Camden Ave. Providence, RI
Date: 7/24/2024 Drawn By:		Sketch to Accompany Easement for: WR 30944539	
DRAWING NOT TO SCALE. DISTANCES ARE APPROXIMATE.			

IN WITNESS WHEREOF, CITY OF PROVIDENCE, RHODE ISLAND, has caused these presents to be signed by its proper officer for that purpose duly authorized this 9th day of April, 2025.

In the presence of:

CITY OF PROVIDENCE, RHODE ISLAND

Michael Napolitano

Brett P. Smiley

By: Brett P. Smiley
Its: Mayor

[Signature]

STATE OF RHODE ISLAND
COUNTY OF PROVIDENCE

In person in said County on the 9th day of April, 2025, before me personally appeared the above named Brett P. Smiley, to me known and known by me to be the party executing the foregoing instrument, and he acknowledged said instrument, by him executed, to be his free act and deed, individually and in said capacity, and the free act and deed of the CITY OF PROVIDENCE, RHODE ISLAND.

Shastery Gonzalez Peña
Notary Public
Printed Name: Shastery Gonzalez Peña
My Commission Expires: 11/19/2025

In the presence of:

APPROVED AS TO FORM AND CONTENT

Michael e Napolitano

[Signature]

By: Jeffrey Dana, Esq.
Its: City Solicitor

Shastery Gonzalez Pena
Notary Public, State of Rhode Island
My Commission Expires Nov. 19, 2025

STATE OF RHODE ISLAND
COUNTY OF PROVIDENCE

In person in said County on the 9th day of APRIL, 2025, before me personally appeared the above named Jeffrey Dana, Esq., to me known and known by me to be the party executing the foregoing instrument, and he acknowledged said instrument, by him executed, to be his free act and deed, individually and in said capacity, and the free act and deed, in said capacity, and the free act and deed of said City Solicitor's Office.

Wendy A. Brown
Notary Public
Printed Name: WENDY A. BROWN
My Commission Expires: _____

WENDY A. BROWN
Notary Public, State of Rhode Island
ID # 754573