

THE CITY OF PROVIDENCE
STATE OF RHODE ISLAND AND PROVIDENCE PLANTATIONS

RESOLUTION OF THE CITY COUNCIL

No. 663

Approved December 20, 1974

THE CITY OF PROVIDENCE
CITY COUNCIL
ON

John R. Keane
Mayor
of
Providence

RESOLVED, That His Honor the Mayor be, and he is, hereby authorized to allow the Marr Scaffolding Company of Boston, Massachusetts, which presently is leasing a certain parcel of land from the City located on Ernest Street in the Fields Point section of Providence, to sublease approximately 40,000 square feet of the easterly portion of said parcel to the John J. Hudson, Inc. of Providence, Rhode Island.

That said sublease shall be for a term of FIVE (5) YEARS, commencing immediately upon passage of this resolution. Further, that the rent for said sublease shall be ELEVEN (11¢) CENTS per square foot, to be paid on the same day and in the same manner as the Marr Scaffolding Company pays to the City. That either party to said sublease has the right to terminate said sublease upon giving the other SIX (6) MONTHS written notice.

Said sublease is conditioned upon the same restrictions as the sublessor's lease with the City.

IN CITY COUNCIL
DEC 19 1974

READ AND PASSED

PRES.

Vincent Zucchi
CLERK

APPROVED

MAYOR

Joseph A. Pawley Jr.
DEC 20 1974

RESOLUTION GRANTING THE MAYOR
AUTHORITY TO ALLOW MARR SCAF-
FOLDING COMPANY TO SUBLEASE
SPACE ON ERNEST STREET TO JOHN
J. HUDSON, INC.

THE COMMITTEE ON

City Property

Approves Passage of
The Within Resolution

Ernest Hudson

Ernest

December 10, 1974

PROVIDENCE, R. I.
 P. W. DEPT. - ENGINEERING OFFICE
 CITY PROPERTY SECTION
 Plan No. 063857
 Date Dec. 18, 1974

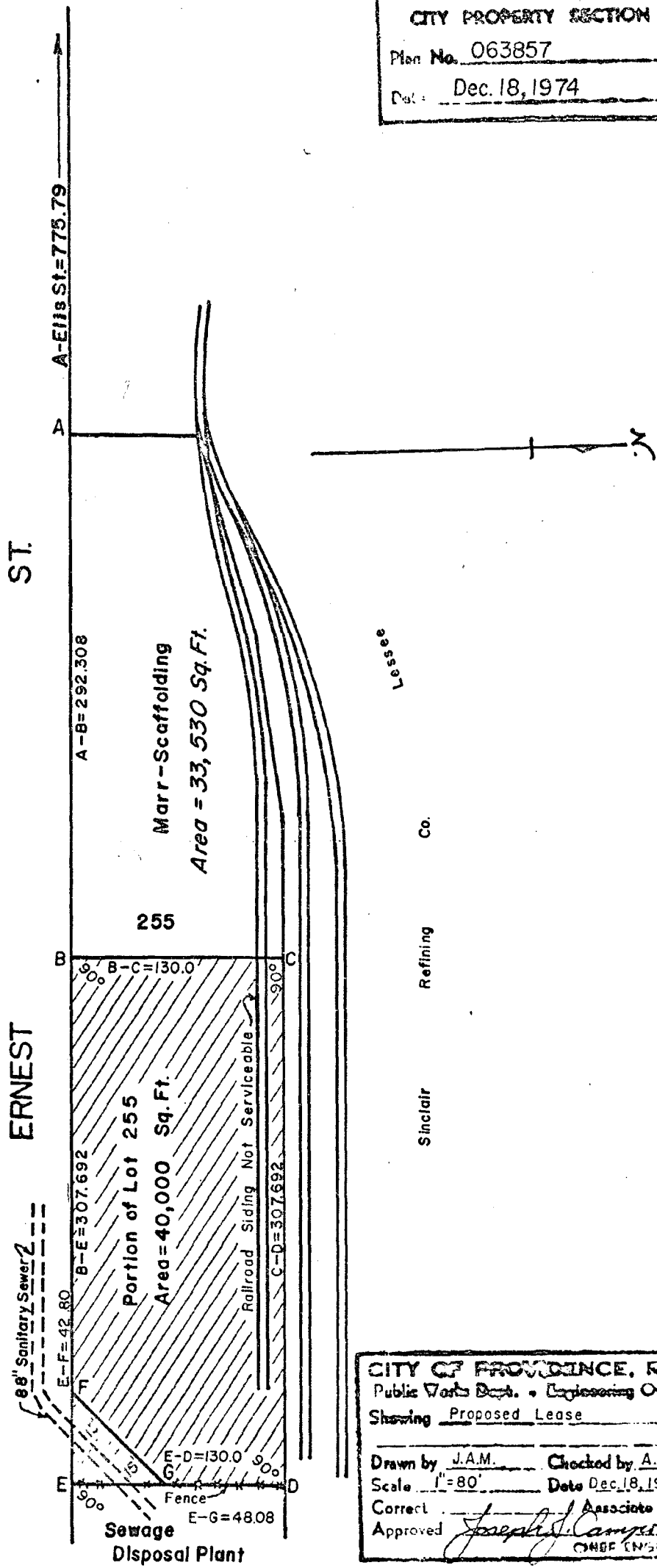

Notes:
 Cross Hatched Area
 (B-C-D-E-B) Indicates
 Proposed Lease.

Shaded Area Indicates
 Proposed Sewer
 Easement

CITY OF PROVIDENCE, R. I.
 Public Works Dept. - Engineering Office
 Showing Proposed Lease
 Drawn by J.A.M. Checked by A.P.
 Scale 1"=80' Date Dec. 18, 1974
 Correct Associate Engr.
 Approved Joseph J. Camper
 CHIEF ENGINEER

Lot numbers from Assessors Plat 56