

RESOLUTION OF THE CITY COUNCIL

No. 794

Approved December 18, 2000

RESOLVED, DECREED, AND ORDERED:

That the following-named street shown on a cross-hatched area on the accompanying map entitled "Prov., RI, DPW-Engineering Office, Street line Section Plan No. 064613 dated October 2, 1998."

VIZ: Cottage Street from Dean Street to the Service Road and West Fountain Street from Dean Street to the Service Road and shown as a cross-hatched area on the accompanying plan and designated by the letters A-B-C-D-A- and E-F-G-H, respectively, having ceased to be useful to the public and are proposed to be abandoned to Petitioner as a public highway. Said abandonment is specifically conditioned precedent upon the following:

1. Petitioner shall convey an easement acceptable to the Narragansett Electric Company which will permit retention of its facilities in their existing location, together with the right to inspect, maintain, operate and replace the same and with twenty-four hour access to said facilities, or in the alternative should it be determined by the petitioner that any such facilities need be relocated in order to comply with an intended use, the Petitioner shall assume all costs of relocation.

2. Petitioner shall convey an easement acceptable to Providence Gas Company which will permit retention of its facilities in their existing location, together with the right to inspect, maintain, operate and replace the same and with twenty-four hour access to said facilities, or in the alternative should it be determined by the Petitioner that any such facilities need be relocated in order to comply with an intended use, the Petitioner shall assume all costs of relocation;

3. Petitioner shall convey an easement acceptable to Bell Atlantic Company which will permit retention of its facilities in their existing location, together with the right to inspect, maintain, operate and replace the same and with twenty-four hour access to said facilities, or in the alternative should it be determined by the Petitioner that any

IN CITY COUNCIL
SEP 17 1998
FIRST READING
REFERRED TO COMMITTEE ON
PUBLIC WORKS
Michael P. Clements *MB*

THE COMMITTEE ON
Public Works
Recommends R.H.
Barbara A. Pearce *MB*
10/14/98 Clerk
(P.H. Held)

THE COMMITTEE ON
PUBLIC WORKS
Approves Passage of
The Within Resolution
Barbara A. Pearce *MB*
11/9/98 Clerk

From the Clerk's Desk

such facilities need be relocated in order to comply with an intended use, the Petitioner shall assume all costs of relocation;

4. The City of Providence shall retain for itself, its heirs, successors and assigns full sewer easements in the abandoned streets which will permit retention of its facilities in their existing location, together with the right to inspect, maintain, operate and replace the same and with twenty-four hour access to said facilities, or in the alternative should it be determined by the Petitioner that any such facilities need be relocated in order to comply with an intended use, the Petitioner shall assume all costs of relocation;

5. Petitioner shall meet the conditions to which reference is made in that communication from the Providence Water Supply Board dated September 29, 1998.

6. The Department of Planning & Development shall obtain final City Council approval for the entirety of the Department of Public Safety Complex.

ORDERED, That the Traffic Engineer be and he is hereby directed to cause a sign to be place on the above-named highway abandoned as aforesaid, having thereon the words, "Not a Public Highway", and it is further

ORDERED, That after the entry of this order or decree the City Clerk shall cause a notice thereof to be published in a newspaper, published in the County of Providence at least once a week for three successive weeks and a further and personal notice shall be served by the City Sergeant upon every owner of land abutting the above-named highway which has been abandoned, who is known to reside within the State.

IN CITY COUNCIL
DEC 14 2000
READ AND PASSED

PRES.

CLERK

APPROVED

DEC 18 2000

MAYOR



Condemnation line platted from best available records.

State Condemnation Map,
Plat No. 1107 - 9-9-59

West Fountain sq. footage=13,032.0
Cottage St. sq. footage=8,790.0
Total sq. footage=21,822.0

PROVIDENCE, R. I.
P. W. DEPT. - ENGINEERING OFFICE
STREET LINE SECTION
Plan No. 064613
Date Oct. 2, 1998

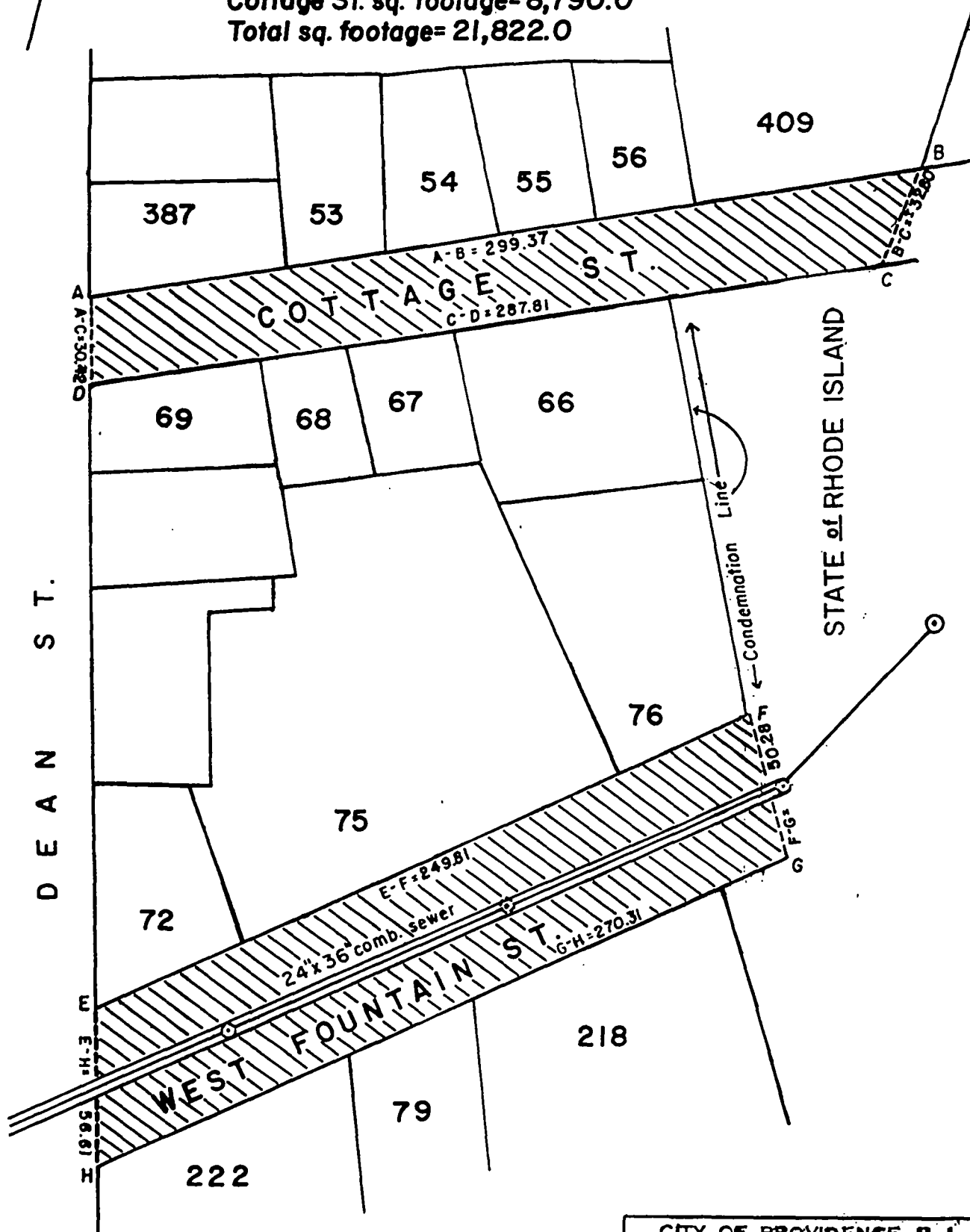

NOTES: Cross-hatched areas (A-B-C-D-A) & (E-F-G-H-E) indicates proposed abandonments.

Full sewer easement will be required for West Fountain St.

Lot numbers taken from A.P. 25.

CITY OF PROVIDENCE, R. I.
Public Works Dept. - Engineering Office
Showing Proposed abandonments of a portion of Cottage & W. Fountain Sts.
Drawn by A. Zislaides Checked by J.T.M.
Scale 1" = 50' Date 10-2-98
Correct T. Jones Associate Engr.
Approved [Signature] CHIEF ENGINEER

RESOLUTION OF THE CITY COUNCIL

No. 794

Approved December 18, 2000

RESOLVED, DECREED, AND ORDERED:

That the following-named street shown on a cross-hatched area on the accompanying map entitled "Prov., RI, DPW-Engineering Office, Street line Section Plan No. 064613 dated October 2, 1998."

VIZ: Cottage Street from Dean Street to the Service Road and West Fountain Street from Dean Street to the Service Road and shown as a cross-hatched area on the accompanying plan and designated by the letters A-B-C-D-A- and E-F-G-H, respectively, having ceased to be useful to the public and are proposed to be abandoned to Petitioner as a public highway. Said abandonment is specifically conditioned precedent upon the following:

1. Petitioner shall convey an easement acceptable to the Narragansett Electric Company which will permit retention of its facilities in their existing location, together with the right to inspect, maintain, operate and replace the same and with twenty-four hour access to said facilities, or in the alternative should it be determined by the petitioner that any such facilities need be relocated in order to comply with an intended use, the Petitioner shall assume all costs of relocation.

2. Petitioner shall convey an easement acceptable to Providence Gas Company which will permit retention of its facilities in their existing location, together with the right to inspect, maintain, operate and replace the same and with twenty-four hour access to said facilities, or in the alternative should it be determined by the Petitioner that any such facilities need be relocated in order to comply with an intended use, the Petitioner shall assume all costs of relocation;

3. Petitioner shall convey an easement acceptable to Bell Atlantic Company which will permit retention of its facilities in their existing location, together with the right to inspect, maintain, operate and replace the same and with twenty-four hour access to said facilities, or in the alternative should it be determined by the Petitioner that any

such facilities need be relocated in order to comply with an intended use, the Petitioner shall assume all costs of relocation;

4. The City of Providence shall retain for itself, its heirs, successors and assigns full sewer easements in the abandoned streets which will permit retention of its facilities in their existing location, together with the right to inspect, maintain, operate and replace the same and with twenty-four hour access to said facilities, or in the alternative should it be determined by the Petitioner that any such facilities need be relocated in order to comply with an intended use, the Petitioner shall assume all costs of relocation;

5. Petitioner shall meet the conditions to which reference is made in that communication from the Providence Water Supply Board dated September 29, 1998.

6. The Department of Planning & Development shall obtain final City Council approval for the entirety of the Department of Public Safety Complex.

ORDERED, That the Traffic Engineer be and he is hereby directed to cause a sign to be place on the above-named highway abandoned as aforesaid, having thereon the words, "Not a Public Highway", and it is further

ORDERED, That after the entry of this order or decree the City Clerk shall cause a notice thereof to be published in a newspaper, published in the County of Providence at least once a week for three successive weeks and a further and personal notice shall be served by the City Sergeant upon every owner of land abutting the above-named highway which has been abandoned, who is known to reside within the State.

IN CITY COUNCIL
DEC 14 2000
READ AND PASSED

PRES.

CLERK

APPROVED

DEC 18 2000

MAYOR

A true copy.
Attest:

Michael R. Clement
City Clerk

Condemnation line platted from best available records.

State Condemnation Map,
Plat No. 1107 - 9-9-59

West Fountain sq. footage=13,032.0
Cottage St. sq. footage=8,790.0
Total sq. footage=21,822.0

PROVIDENCE, R. I.

P. W. DEPT. - ENGINEERING OFFICE

STREET LINE SECTION

Plan No. 064613

Date Oct. 2, 1998

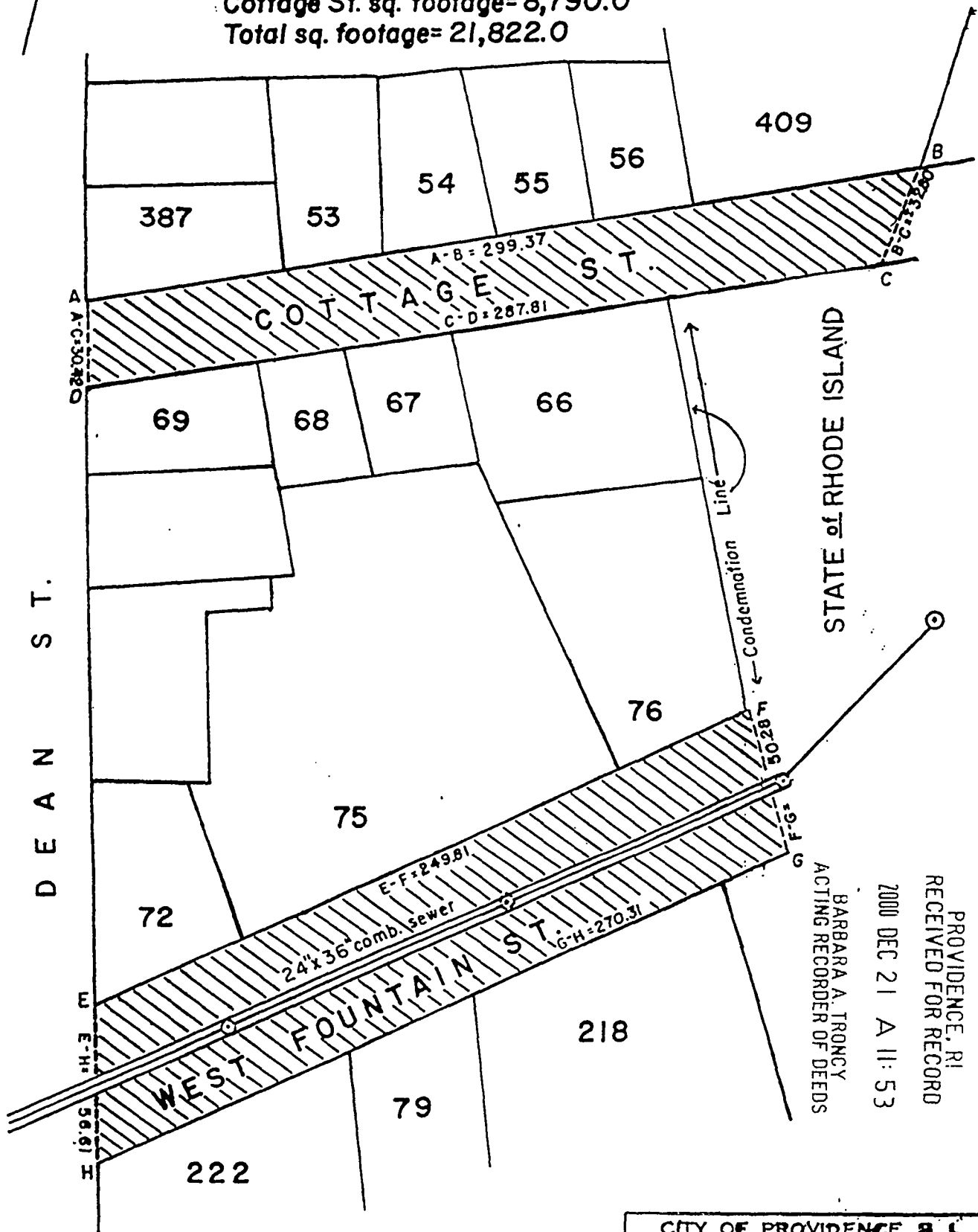

STATE OF RHODE ISLAND

PROVIDENCE, RI
RECEIVED FOR RECORD
2000 DEC 21 A 11:53
BARBARA A. TRONCY
ACTING RECORDER OF DEEDS

NOTES: Cross-hatched areas (A-B-C-D-A) & (E-F-G-H-E) indicates proposed abandonments.

Full sewer easement will be required for West Fountain St.

Lot numbers taken from A.P. 25.

CITY OF PROVIDENCE, R. I.

Public Works Dept. - Engineering Office

Showing Proposed abandonments of a portion of Cottage B. W. Fountain Sts.

Drawn by A. Zislades Checked by J.T.M.

Scale 1" = 50' Date 10-2-98

Corrected by T. M. Associate Engineer

Approved by H. J. Dao CHIEF ENGINEER

4544/119-121

PROVIDENCE, RI
RECEIVED FOR RECORD

2000 DEC 21 A 11: 53

BARBARA A. TRONCY
ACTING RECORDER OF DEEDS

48756

THE CITY OF PROVIDENCE

CITY SERGEANT'S OFFICE

THIS IS TO CERTIFY, That I have caused the notice, of which a true copy is hereto annexed, to be served upon the following named persons, by handing to each of said persons, or by leaving at their last and usual place of abode in this State a true copy of said notice, to wit:

PETITION TO ABANDON COTTAGE STREET, FROM DEAN STREET TO THE SERVICE ROAD, & WEST FOUNTAIN STREET FROM DEAN STREET TO THE SERVICE ROAD.

<u>PLAT</u>	<u>LOT</u>	<u>NAME AND ADDRESS</u>
25	60	Richard A. Kettle 92 Carpenter Street Providence, RI 02903
25	67	James Ajootian 200 Smith Street Providence, RI 02908
25	68	Charles J. Ajootian 200 Smith Street Providence, RI 02908
25	69	Charles J. Ajootian 200 Smith Street Providence, RI 02908
25	72	Gilbert Enterprises 170 Westminster Street (mailed) Providence, RI 02903 9/28/96
25	75	Hurley & Johnston 290 North Beacon Street Brighton, MA 02135
25	76	Raymond H. Gadigian 307 Fountain Street (mailed) Providence, RI 02903 9/28/96
25	79	Phoenix J. Finnegan 1445 Wampanoag Trail East Providence, RI 02915
25	218	Civil Process Service P.O. Box 10026 Cranston, RI 02910
25	222	West Fountain Proper 21 Fly JIB Court Jamestown, RI 02835
25	53	Angelo Lest Tucci P.O. Box 6122 Providence, RI 02940

<u>PLAT</u>	<u>LOT</u>	<u>NAME AND ADDRESS</u>
25	54	Angelo Lest Tucci P.O. Box 6122 Providence, RI 02940
25	55	Kettle Real Estate 92 Carpenter Street Providence, RI 02903
25	56	Kettle Real Estate 92 Carpenter Street Providence, RI 02903
25	387	Jason Rubin P.O. Box 113931 North Providence, RI 02911
25	409	Speedy Muffler King, Inc. P.O. Box 1392 Buffalo, NY 14240

PETITIONER

Thomas E. Deller
Providence Redevelopment Agency
400 Westminster Street
Providence, RI 02903

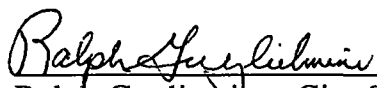

Ralph Gugliemino, City Sergeant
9/28/98

Councilwoman Balbina A. Young
Ward 11
Councilman Terrence M. Hassett
Ward 12
Councilman John J. Lombardi
Ward 13



DEPARTMENT OF PLANNING AND DEVELOPMENT

"Building Pride in Providence"

December 9, 1998

Monroe Muffler Brake, Inc.
200 Hollender Parkway
Rochester, New York 14615

4578 Abandonment of Cottage Street adjacent to Speedy Muffler King, Inc.,
62 Carpenter St., Providence, RI 02903 (AP 25, lot 409)

Gentlemen :

The Providence Redevelopment Agency is in the process of acquiring property approximately bounded by Carpenter St., Service Road #7, Washington St. and Dean St. in Providence to relocate the Providence Police and Fire Departments. This, however, does not include your property. As part of the plan for the area the City will be abandoning Cottage Street. As an abutting owner to Cottage Street you are entitled to one half of the right-of-way at fair market value estimated at \$10,000. - 1255 sq.ft. at approx. \$8.00/sq.ft. A plan illustrating the approximate street abandonment area is attached for your information.

Please indicate below if you are or are not interested and return a signed copy properly executed in the enclosed stamped envelope by December 21, 1998. If you have any questions please contact William Floriani at (401) 351-4300, Ext. 511.

Check one:

I am interested ()

I am not interested ()

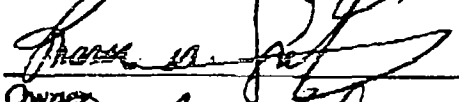
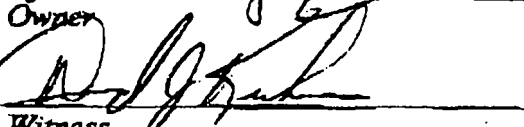

Owner

Witness

Sincerely

Thomas E. Deller, AICP
Deputy Director

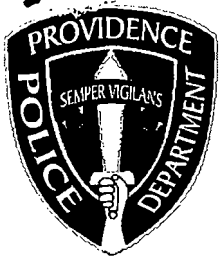
TED/jpb

cc: John F. Palmieri Thomas O'Connor
William Floriani



PROVIDENCE POLICE DEPARTMENT
TRAFFIC BUREAU
209 Fountain Street, Providence, RI 02903
LIEUTENANT JOHN F. GLANCY

8 May 99

To: Colonel Urbano Prignano Jr. Chief of Police
From: Lieutenant John F. Glancy, Commanding Traffic Bureau
Subject: Street Abandonment

Sir:

After reviewing the attached petition, and conducting an investigation, I feel that the abandonment of Cottage St and portions of W. Fountain St., to make room for the new Police Headquarters would not have an impact on public safety or the traffic in the area.

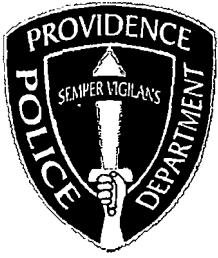

PROVIDENCE POLICE DEPARTMENT
TRAFFIC BUREAU
209 Fountain Street, Providence, RI 02903

9 NOV 98

To: COLONEL URBANO PRIGNANO JR. CHIEF OF POLICE
From: LIEUTENANT JOHN F. GLANCY COMMANDING TRAFFIC BUREAU
Subject: PETITION TO ABANDON CERTAIN CITY STREETS

A handwritten signature in black ink, appearing to be 'JF Glancy', is written over the 'From:' line of the letterhead.

Sir:

After reviewing a proposal to abandon a certain section of COTTAGE ST in order to facilitate the new Police Headquarters, and conducting a study of the area , it is felt that this abandonment will have no effect on the traffic flow.

JAMES F. RATTIGAN
CHIEF OF DEPARTMENT

DAVID N. BOCK
ASS'T. CHIEF OF DEPARTMENT



VINCENT A. CIANCI, JR.
MAYOR

JOHN J. PARTINGTON
COMMISSIONER

Department of Public Safety, Fire Department
"Building Pride In Providence"

September 23, 1998

Councilman Robert M. Clarkin
Department of City Clerk
City Hall
Providence, RI 02903

Dear Councilman Clarkin:

Please be advised that the Providence Fire Department has no objection to abandoning Cottage Street from Dean Street to Service Road and West Fountain Street from Dean Street to Service Road.

If you have any further questions, please do not hesitate to contact me.

Yours truly,

James F. Rattigan
Chief of Department

JFR:lra

Ferdinand C. Ihenacho, P.E.

Director



VINCENT A. CIANCI, JR.

Mayor

Department of Public Works

"Building Pride In Providence"

October 13, 1998

Hon. Robert M. Clarkin
Chairman of the Public Works Committee
Providence City Council - City Hall
Providence, R.I. 02903

Re: Abandonment of Cottage Street
From Dean St. to Service Road

& West Fountain St.
Dean St. to Service Road

Dear Councilman Clarkin:

This department has no objection to the proposed abandonment of Cottage St. from Dean St. to Service Rd., and West Fountain St. from Dean St. to Service Rd., as shown on the accompanying plan entitled, "Prov., RI, PW Dept. -Engineering Office, Street line Section, Plan No. 064613, Date: October 2, 1998.

Proposed abandonments for Cottage St., designated as cross-hatched area A-B-C-D-A on the accompanying plan, and proposed abandonment for W. Fountain St. as E-F-G-H-E on the accompanying plan. Lot numbers were taken from City of Providence Assessor's Plat 25. A list of abutting property owners is also enclosed for your perusal. A full sewer easement will be required for the abandonment of W. Fountain St. - Square footage for this proposed abandonment is: Cottage St. 8,790.0 Sq.Ft. and for W. Fountain St., 13,032.0 Sq.Ft. Total Square Footage is 21,822.0 Sq. Ft.

If we can further assist in this regard, please advise.

Very truly yours,

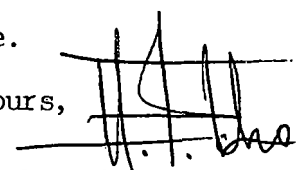
Ferdinand C. Ihenacho, P.E.
Director

CC: G. Florio, Ass't.Dir./DPW
M. Clement - City Clerk
J. D'Amico, Esq.-Law Dept.
JTM
JLC DPW/Eng.
SZ

700 Allens Avenue • Providence, Rhode Island 02905

(401) 467-7950 (Voice) • 751-0203 (TDD) • 941-2567 (Facsimile)

ARMANDO PARILLO
Chairman
JOEL D. LANDRY, II, ESQ.
Vice Chairman
ROBERT J. KILDUFF, ESQ., P.E.
Secretary
FERNANDO S. CUNHA, ESQ.
Legal Advisor
BOYCE SPINELLI
Ex-Officio



VINCENT A. CIANCI, JR.
Mayor
RICHARD O. RAFANOVIC, P.E.
General Mgr./Chief Engr.
JOSEPHINE DIRUZZO
City Councilwoman
EVELYN V. FARGNOLI
Council President
MARY A. NOCERA
Member
JOSEPH D. CATALDI
Member

September 29, 1998

Mr. Michael Clement
City Clerk
City Hall
25 Dorrance Street
Providence, R.I. 02903

SUBJECT: Petition for Street Abandonment
Portion of West Fountain Street and Cottage Street
Providence, R. I.

Dear Mr. Clement:

We have received a copy of the Petition to the City Council for the abandonment of a portion of West Fountain Street and Cottage Street to review as to the potential impact on the Providence Water system. Our records indicate that each street has in place a Providence Water 6" main, several water service lines and a fire hydrant located on the street.

It is the understanding of Providence Water, pursuant to a conversation with Tom Deller of the Providence Redevelopment Agency, that all existing buildings fronting the above referenced streets will be purchased and demolished, thus eliminating the need for water services from the main located in the area to be developed.

Providence Water will conditionally approve the proposed abandonment provided that the following conditions can be met:

1. Any services that might remain must be relocated so that the existing main can be severed from the distribution system.
2. New services for proposed facility are to be tapped off the main in Dean Street.
3. The Providence Fire Department approves the abandonment or relocation of existing fire hydrants.
4. All costs relating to the above stipulations be borne by the project proponent.

If you have any questions, please feel free to contact me at 521-6300 Ext. 7244

Respectfully,

PROVIDENCE WATER SUPPLY BOARD

Richard O. Rafanovic, P.E.
Chief Engineer & General Manager

A handwritten signature in black ink, appearing to read "Peter McLaughlin".

By: Peter McLaughlin
Regulatory Services Program Manager

cc: P. Gadoury, P.E.
R. Kilduff, P. E.
Petitioner
File

abdn11

PETITION TO THE CITY COUNCIL

13
Cottage St.

TO THE HONORABLE CITY COUNCIL OF THE CITY OF PROVIDENCE:

The undersigned respectfully petitions your honorable body

Whereas, the City of Providence plans to relocate the existing Police and Fire facility;

Whereas, the City of Providence and the Providence Redevelopment Agency will seek to develop the existing site as a hotel;

The Providence Redevelopment Agency is requesting that the City Council abandon Cottage St., from Dean St. to the Service Rd., and West Fountain St from Dean St. to the Service Rd. The abandonment is necessary for the relocation of the Police and Fire Station and the development of a hotel on the existing Police and Fire Station site.

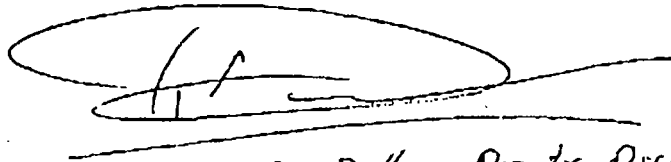

Thomas E. Diller, Deputy Director

no rules Dept
property involved
B 10/30
NO OBJECTIONS

Condemnation line plotted from best available records.

State Condemnation Map,
 Plat No. 1107 - 9-9-59

West Fountain sq. footage=13,032.0
 Cottage St. sq. footage=8,790.0
 Total sq. footage=21,822.0

PROVIDENCE, R. I.
 P. W. DEPT. - ENGINEERING OFFICE
 STREET LINE SECTION
 Plan No. 064613
 Date Oct. 2, 1988

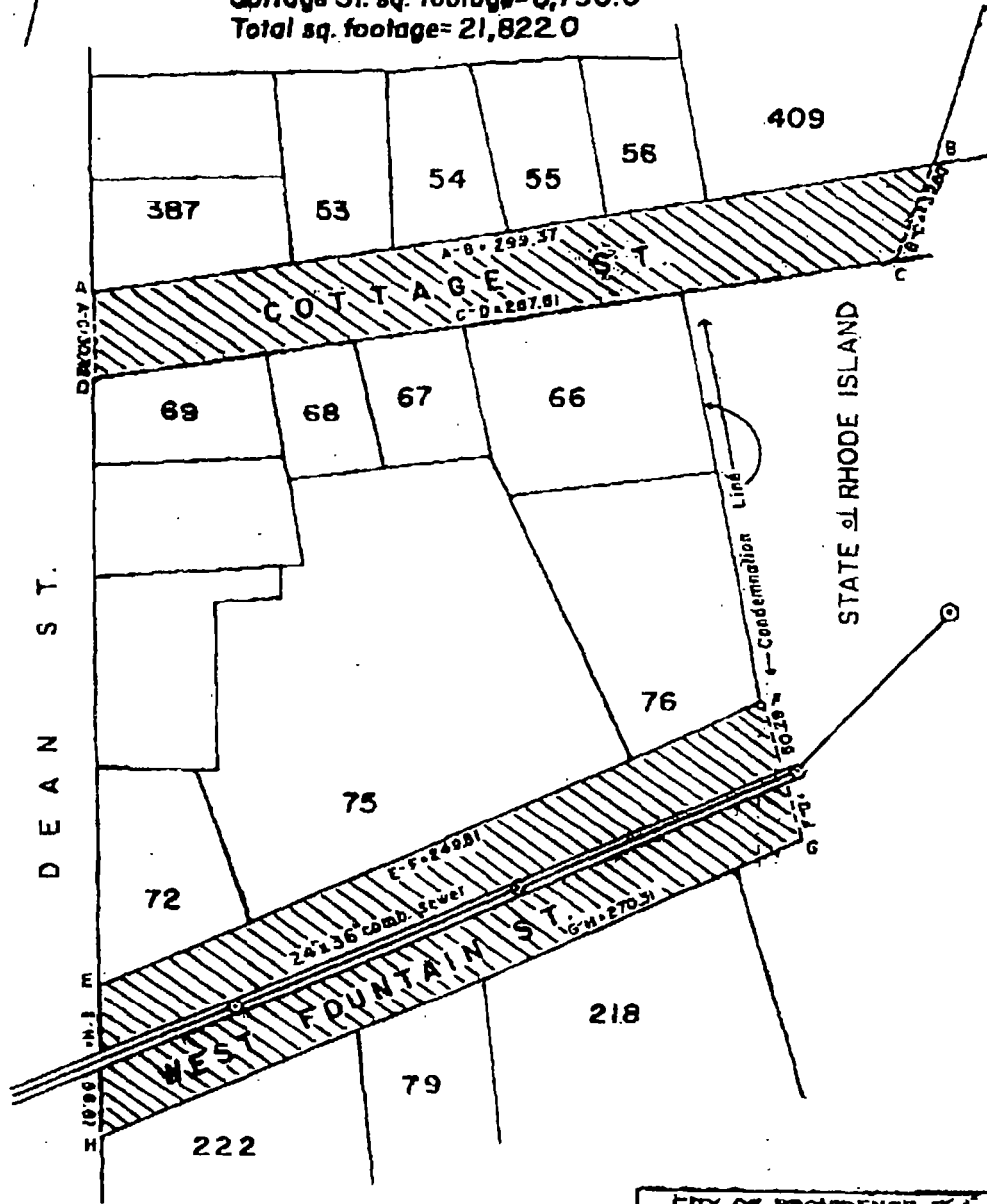

NOTES: Cross-hatched areas (A-B-C-D-A) & (E-F-G-H-E) indicates proposed abandonments.
 Full sewer easement will be required for West Fountain St.
 Lot numbers taken from A.P. 25.

CITY OF PROVIDENCE, R. I.
 Public Works Dept. - Engineering Office
 Showing Proposed abandonments of a portion of Cottage & West Fountain Sts.
 Drawn by A. J. [signature] Checked by J. T. [signature]
 Scale 1" = 50' Date 10-2-88
 Corrected by T. [signature] Associate Eng.
 Approved [signature] Chief Engineer

756
 N-61

IRENE J. TESTA
Traffic Engineer

JOSEPH W. CAPRIO
Deputy Director



VINCENT A. CIANCI, JR.
Mayor

Department of Traffic Engineering
"Building Pride In Providence"

MEMORANDUM

TO: Councilman Robert Clarkin, Chairman
Committee on Public Works

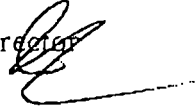
FROM: Irene J. Testa, Director 

DATE: 10/26/98

RE: **PROPOSED ABANDONMENTS**

Request: To abandon a portion of West Fountain Street.

Disposition: No objection to said abandonment.

IRENE J. TESTA
Traffic Engineer

JOSEPH W. CAPRIO
Deputy Director



VINCENT A. CIANCI, JR.
Mayor

Department of Traffic Engineering
"Building Pride In Providence"

MEMORANDUM

TO: Councilman Robert Clarkin, Chairman
Committee on Public Works

FROM: Irene J. Testa, Director

DATE: 10/26/98

RE: **PROPOSED ABANDONMENTS**

Request: To abandon a portion of Cottage Street.

Disposition: No objection to said abandonment.

GEORGE CALCAGNI

Chair



VINCENT A. CIANCI, JR.

Mayor

PROVIDENCE CITY PLAN COMMISSION

"Planning the Future of Providence"

November 2, 1998

Councilman Robert M. Clarkin, Chairman
Committee on Public Works
City Hall
Providence, Rhode Island 02903

ATTENTION: Mr. Michael R. Clement, City Clerk

CPC Ref. No. 3137 - Petition to abandon Cottage Street and West Fountain Street from Dean Street to the Service Road.

Dear Councilman Clarkin: ✓

The City Plan Commission at its regular meeting on Thursday, September 24, 1998, reviewed and evaluated the request from the Committee on Public Works on the petition to abandon Cottage Street and West Fountain Street from Dean Street to the Service Road.

Due to the relocation of the Police and Fire Stations it is necessary for the Providence Redevelopment Agency to obtain portions of these streets. The Providence Redevelopment Agency has initiated the condemnation procedures of all abutting properties and will become the owner of record.

The Commission has reviewed and evaluated the request for consistency with the City's Comprehensive Plan. The Commission found the proposed abandonment is consistent with *Providence 2000: The Comprehensive Plan*.

The City Plan Commission voted to recommend that the Committee on Public Works to approve the petition to abandon the aforesaid public right-of-ways after the condemnation process is complete.

Regards,

A handwritten signature in black ink, appearing to read "T. E. Deller", is written over a horizontal line. The signature is enclosed in a large, loopy oval shape.

Thomas E. Deller, AICP, Deputy Director

cc: Providence Redevelopment Agency, Petitioner
George Calcagni, Chair

3137-Public Works



Narragansett Electric
A NEES company

October 30, 1998

BY FAX AND U.S. MAIL

Ms. Barbara A. Poirier
Department of City Clerk
Providence City Hall
25 Dorrance Street
Providence, Rhode Island 02903

Re: Petition to Abandon Portions of Cottage Street and West Fountain Street

Dear Ms. Poirier:

The Narragansett Electric Company (NEC) presently has overhead and underground facilities situated within the proposed abandoned portions of Cottage Street and West Fountain Street. NEC has no objection to the proposed abandonment provided that in the event the streets are abandoned, an easement acceptable to NEC will permit the retention of our facilities in their existing locations along with the right to access them.

If you have any questions feel free to call me at 401-784-7209.

Sincerely,

Michael D. DiNezza
Senior Real Estate Representative

Bell Atlantic - New England
Right of Way Department
85 High Street
Pawtucket, RI 02860
401 727-9555



October 13, 1998

Providence City Council
Providence City Hall
25 Dorrance Street
Providence, Rhode Island 02903

Attn: Mr. Robert Clarkin

RE: PETITION TO ABANDON A PORTION OF COTTAGE STREET AND WEST
FOUNTAIN STREET.

Bell Atlantic presently has aerial facilities in said street.

These facilities include poles, anchors and aerial cable that provide service to the surrounding area.

Bell Atlantic will not object to the granting of said petition, provided that in the event the petition is granted, the petitioner will convey an easement acceptable to Bell Atlantic, which will permit retention of its facilities in existing locations with the right to inspect, maintain, operate and replace the same and with twenty-four hour access to said facilities.

If it is decided by the petitioner that telephone facilities are to be relocated, the petitioner will assume all costs of the relocation.

Very truly yours,

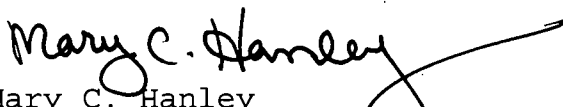
Mary C. Hanley
E/P Manager - Right of Way



September 22, 1998

Councilman Robert M. Clarkin, Chairman
Committee on Public Works
Providence City Council
Providence, RI 02903

Dear Councilman Clarkin:

Providence Gas Company operates facilities within the street listed below. Should this street be abandoned Providence Gas Company will require an easement for this entire area so that we can continue to operate, maintain and gain free access to our facilities.

Cottage Street

Sincerely,

Thomas Gavula/WS

Thomas Gavula
Director
Engineering

401 • 222 • 6680
401 • 222 • 2584 FAX
401 • 222 • 6680 TDD
<http://www.narrabay.com>

Paul Pinault, P.E.
Executive Director



Ms. Barbara Poirier
Second Deputy City Clerk
Department of City Clerk
City Hall
25 Dorrance Street
Providence, RI 02903

Dear Ms. Poirier:

The NBC does not own any facility in these streets. Therefore, we do not have any objection to the abandonment of this property.

We appreciate your notification of this abandonment and the opportunity to comment.

Sincerely,

John Zuba
Project Coordinator

JZ:1z

cc: Joseph Filippone

RESOLUTION OF THE CITY COUNCIL

No. 794

Approved December 18, 2000

RESOLVED, DECREED, AND ORDERED:

That the following-named street shown on a cross-hatched area on the accompanying map entitled "Prov., RI, DPW-Engineering Office, Street line Section Plan No. 064613 dated October 2, 1998."

VIZ: Cottage Street from Dean Street to the Service Road and West Fountain Street from Dean Street to the Service Road and shown as a cross-hatched area on the accompanying plan and designated by the letters A-B-C-D-A- and E-F-G-H, respectively, having ceased to be useful to the public and are proposed to be abandoned to Petitioner as a public highway. Said abandonment is specifically conditioned precedent upon the following:

1. Petitioner shall convey an easement acceptable to the Narragansett Electric Company which will permit retention of its facilities in their existing location, together with the right to inspect, maintain, operate and replace the same and with twenty-four hour access to said facilities, or in the alternative should it be determined by the petitioner that any such facilities need be relocated in order to comply with an intended use, the Petitioner shall assume all costs of relocation.

2. Petitioner shall convey an easement acceptable to Providence Gas Company which will permit retention of its facilities in their existing location, together with the right to inspect, maintain, operate and replace the same and with twenty-four hour access to said facilities, or in the alternative should it be determined by the Petitioner that any such facilities need be relocated in order to comply with an intended use, the Petitioner shall assume all costs of relocation;

3. Petitioner shall convey an easement acceptable to Bell Atlantic Company which will permit retention of its facilities in their existing location, together with the right to inspect, maintain, operate and replace the same and with twenty-four hour access to said facilities, or in the alternative should it be determined by the Petitioner that any

such facilities need be relocated in order to comply with an intended use, the Petitioner shall assume all costs of relocation;

4. The City of Providence shall retain for itself, its heirs, successors and assigns full sewer easements in the abandoned streets which will permit retention of its facilities in their existing location, together with the right to inspect, maintain, operate and replace the same and with twenty-four hour access to said facilities, or in the alternative should it be determined by the Petitioner that any such facilities need be relocated in order to comply with an intended use, the Petitioner shall assume all costs of relocation;

5. Petitioner shall meet the conditions to which reference is made in that communication from the Providence Water Supply Board dated September 29, 1998.

6. The Department of Planning & Development shall obtain final City Council approval for the entirety of the Department of Public Safety Complex.

ORDERED, That the Traffic Engineer be and he is hereby directed to cause a sign to be place on the above-named highway abandoned as aforesaid, having thereon the words, "Not a Public Highway", and it is further

ORDERED, That after the entry of this order or decree the City Clerk shall cause a notice thereof to be published in a newspaper, published in the County of Providence at least once a week for three successive weeks and a further and personal notice shall be served by the City Sergeant upon every owner of land abutting the above-named highway which has been abandoned, who is known to reside within the State.

IN CITY COUNCIL
DEC 14 2000
READ AND PASSED

PRES.

CLERK

APPROVED

DEC 18 2000

MAYOR

A true copy.

Attest:

Michael R. Clement
City Clerk



DEPARTMENT OF CITY CLERK

CITY HALL, PROVIDENCE, R.I. 02903

MICHAEL R. CLEMENT, CITY CLERK



Jason Rubin
P.O. Box 113931
North Providence, RI 02904

RUBI931 029112009 1700 22 12/30/00
NOTIFY SENDER OF NEW ADDRESS
RUBIN, JASON
2034 BROAD ST
CRANSTON RI 02905-3339

02911-0131





Condemnation line platted from best available records.

State Condemnation Map,
Plat No. 1107 - 9-9-59

West Fountain sq. footage=13,032.0
Cottage St. sq. footage=8,790.0
Total sq. footage=21,822.0

PROVIDENCE, R. I.
P. W. DEPT. - ENGINEERING OFFICE
STREET LINE SECTION
Plan No. 064613
Date Oct. 2, 1998

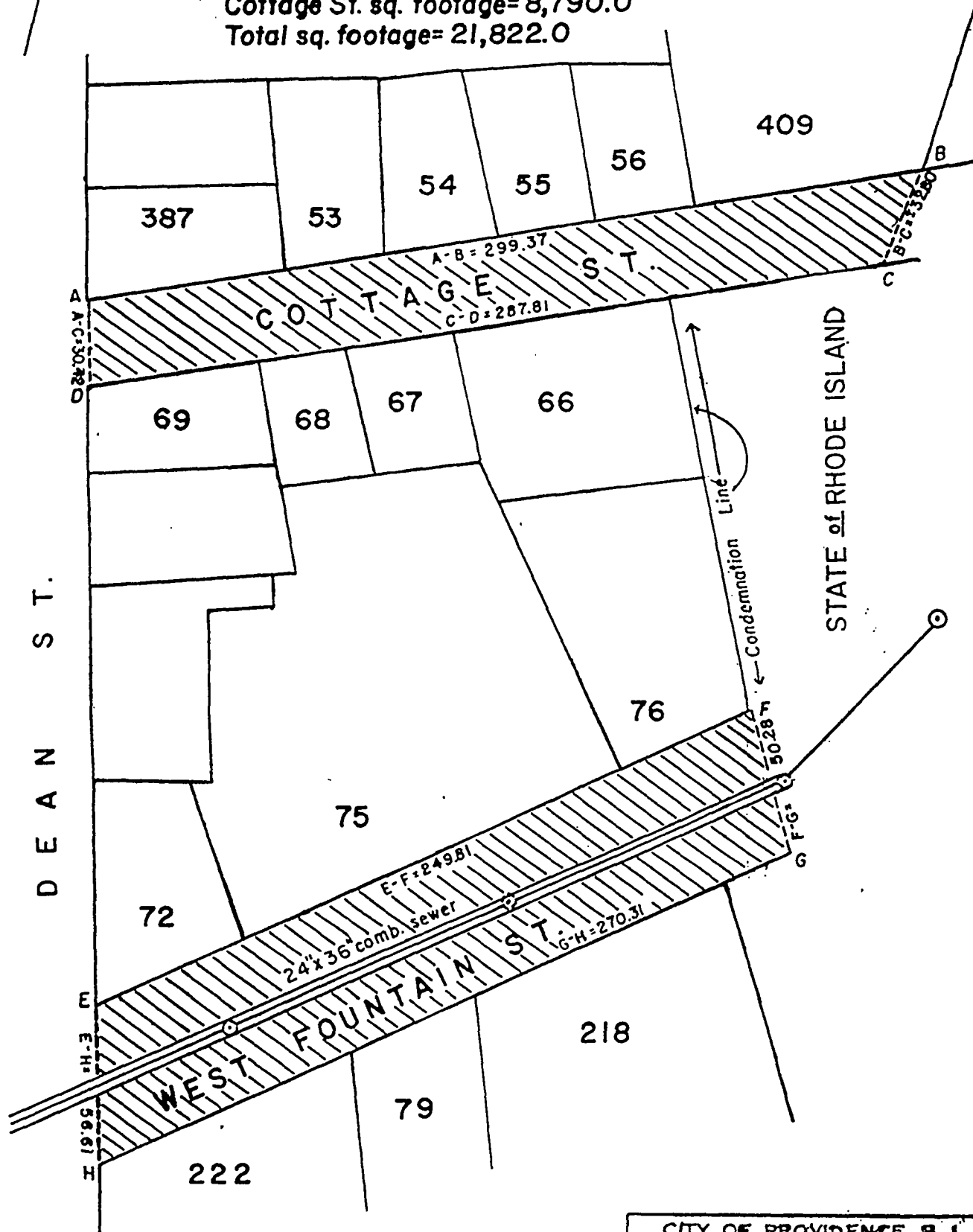

NOTES: Cross-hatched areas (A-B-C-D-A) & (E-F-G-H-E) indicates proposed abandonments.

Full sewer easement will be required for West Fountain St.

Lot numbers taken from A.P. 25.

CITY OF PROVIDENCE, R. I.
Public Works Dept. - Engineering Office
Showing Proposed abandonments of a portion of Cottage & W. Fountain Sts.
Drawn by A. Zislades Checked by J.T.M.
Scale 1" = 50' Date 10-2-98
Corrected by T. M. Associate Engr.
Approved by J. T. M. CHIEF ENGINEER



DEPARTMENT OF CITY CLERK

CITY HALL, PROVIDENCE, R.I. 02903

MICHAEL R. CLEMENT, CITY CLERK

NSH
317

Raymond H. Gadigian
307 Fountain Street

~~PROVIDENCE, R.I. 02903~~

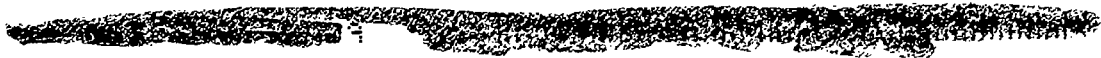
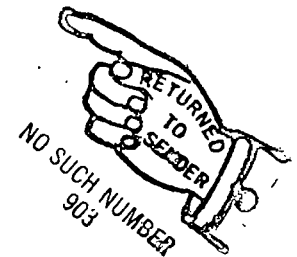
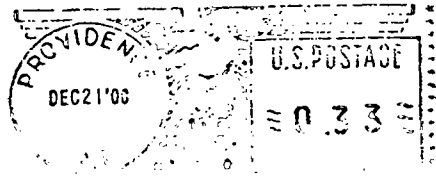

RESOLUTION OF THE CITY COUNCIL

No. 794

Approved December 18, 2000

RESOLVED, DECREED, AND ORDERED:

That the following-named street shown on a cross-hatched area on the accompanying map entitled "Prov., RI, DPW-Engineering Office, Street line Section Plan No. 064613 dated October 2, 1998."

VIZ: Cottage Street from Dean Street to the Service Road and West Fountain Street from Dean Street to the Service Road and shown as a cross-hatched area on the accompanying plan and designated by the letters A-B-C-D-A- and E-F-G-H, respectively, having ceased to be useful to the public and are proposed to be abandoned to Petitioner as a public highway. Said abandonment is specifically conditioned precedent upon the following:

1. Petitioner shall convey an easement acceptable to the Narragansett Electric Company which will permit retention of its facilities in their existing location, together with the right to inspect, maintain, operate and replace the same and with twenty-four hour access to said facilities, or in the alternative should it be determined by the petitioner that any such facilities need be relocated in order to comply with an intended use, the Petitioner shall assume all costs of relocation.

2. Petitioner shall convey an easement acceptable to Providence Gas Company which will permit retention of its facilities in their existing location, together with the right to inspect, maintain, operate and replace the same and with twenty-four hour access to said facilities, or in the alternative should it be determined by the Petitioner that any such facilities need be relocated in order to comply with an intended use, the Petitioner shall assume all costs of relocation;

3. Petitioner shall convey an easement acceptable to Bell Atlantic Company which will permit retention of its facilities in their existing location, together with the right to inspect, maintain, operate and replace the same and with twenty-four hour access to said facilities, or in the alternative should it be determined by the Petitioner that any

such facilities need be relocated in order to comply with an intended use, the Petitioner shall assume all costs of relocation;

4. The City of Providence shall retain for itself, its heirs, successors and assigns full sewer easements in the abandoned streets which will permit retention of its facilities in their existing location, together with the right to inspect, maintain, operate and replace the same and with twenty-four hour access to said facilities, or in the alternative should it be determined by the Petitioner that any such facilities need be relocated in order to comply with an intended use, the Petitioner shall assume all costs of relocation;

5. Petitioner shall meet the conditions to which reference is made in that communication from the Providence Water Supply Board dated September 29, 1998.

6. The Department of Planning & Development shall obtain final City Council approval for the entirety of the Department of Public Safety Complex.

ORDERED, That the Traffic Engineer be and he is hereby directed to cause a sign to be place on the above-named highway abandoned as aforesaid, having thereon the words, "Not a Public Highway", and it is further

ORDERED, That after the entry of this order or decree the City Clerk shall cause a notice thereof to be published in a newspaper, published in the County of Providence at least once a week for three successive weeks and a further and personal notice shall be served by the City Sergeant upon every owner of land abutting the above-named highway which has been abandoned, who is known to reside within the State.

IN CITY COUNCIL
DEC 14 2000
READ AND PASSED

PRES.

CLERK

APPROVED

DEC 18 2000

MAYOR

A true copy.
Attest:

Michael R. Clement
City Clerk



Condemnation line platted from best available records.

State Condemnation Map,
Plat No. 1107 - 9-9-59

West Fountain sq. footage=13,032.0
Cottage St. sq. footage=8,790.0
Total sq. footage=21,822.0

PROVIDENCE, R. I.
P. W. DEPT. - ENGINEERING OFFICE
STREET LINE SECTION
Plan No. 064613
Date Oct. 2, 1998

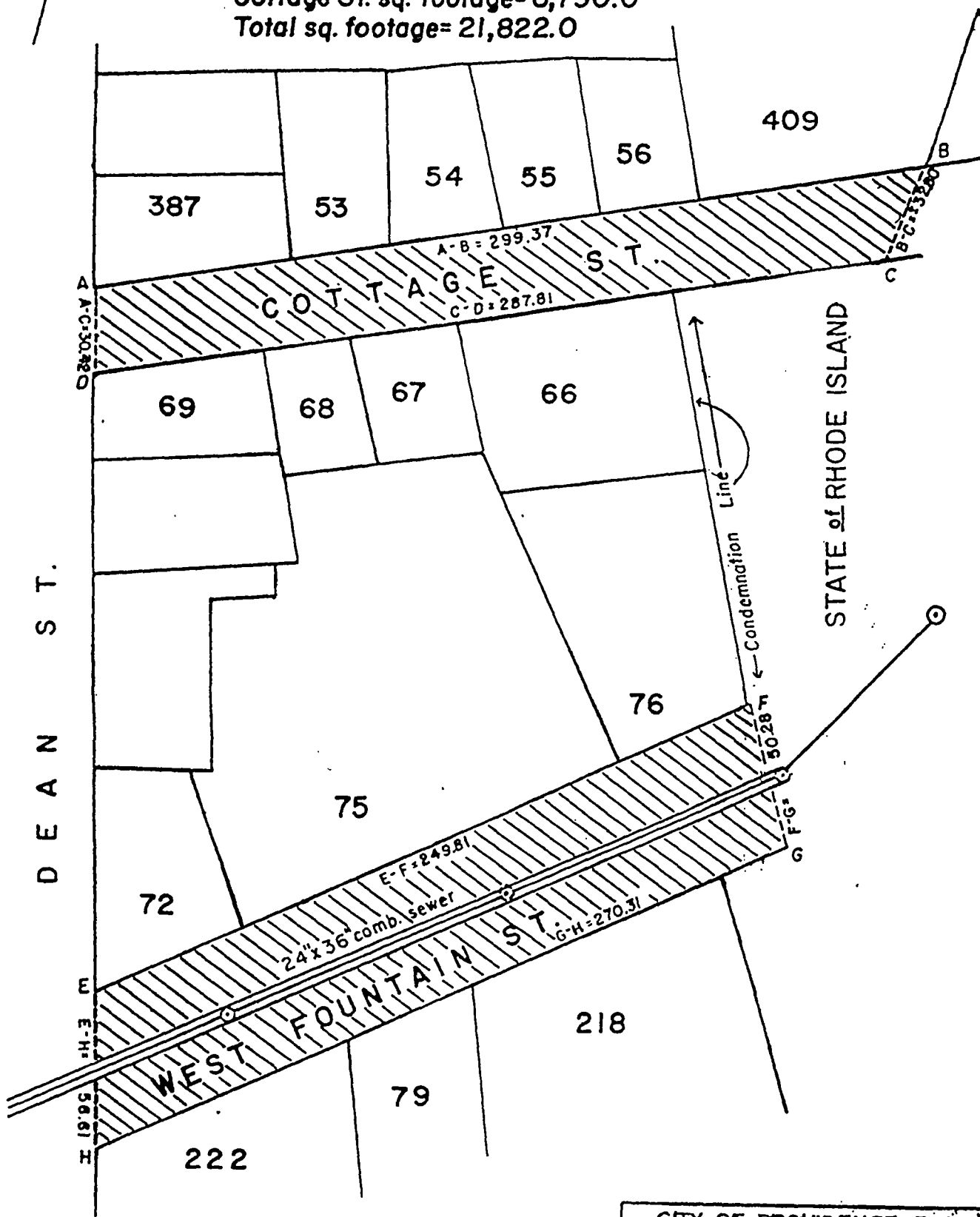

NOTES: Cross-hatched areas (A-B-C-D-A) & (E-F-G-H-E) indicates proposed abandonments.

Full sewer easement will be required for West Fountain St.

Lot numbers taken from A.P. 25.

CITY OF PROVIDENCE, R. I.
Public Works Dept. - Engineering Office
Showing Proposed abandonments of a portion of Cottage & W. Fountain Sts.
Drawn by A. Zislades Checked by J.T.M.
Scale 1" = 50' Date 10-2-98
Corrected by T. M. Associate Engr.
Approved by J.T.M. CHIEF ENGINEER



DEPARTMENT OF CITY CLERK

CITY HALL, PROVIDENCE, R.I. 02903

MICHAEL R. CLEMENT, CITY CLERK

← RETURN TO SENDER-ATTEMPTED UNKNOWN

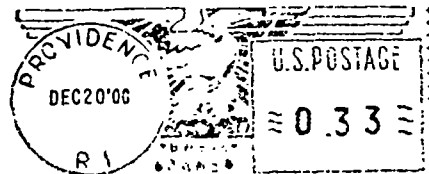

Hurley & Johnston
290 North Beacon Street
Brighton, MA 02135

02135-1384358/1727

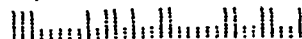

RESOLUTION OF THE CITY COUNCIL

No. 794

Approved December 18, 2000

RESOLVED, DECREED, AND ORDERED:

That the following-named street shown on a cross-hatched area on the accompanying map entitled "Prov., RI, DPW-Engineering Office, Street line Section Plan No. 064613 dated October 2, 1998."

VIZ: Cottage Street from Dean Street to the Service Road and West Fountain Street from Dean Street to the Service Road and shown as a cross-hatched area on the accompanying plan and designated by the letters A-B-C-D-A- and E-F-G-H, respectively, having ceased to be useful to the public and are proposed to be abandoned to Petitioner as a public highway. Said abandonment is specifically conditioned precedent upon the following:

1. Petitioner shall convey an easement acceptable to the Narragansett Electric Company which will permit retention of its facilities in their existing location, together with the right to inspect, maintain, operate and replace the same and with twenty-four hour access to said facilities, or in the alternative should it be determined by the petitioner that any such facilities need be relocated in order to comply with an intended use, the Petitioner shall assume all costs of relocation.

2. Petitioner shall convey an easement acceptable to Providence Gas Company which will permit retention of its facilities in their existing location, together with the right to inspect, maintain, operate and replace the same and with twenty-four hour access to said facilities, or in the alternative should it be determined by the Petitioner that any such facilities need be relocated in order to comply with an intended use, the Petitioner shall assume all costs of relocation;

3. Petitioner shall convey an easement acceptable to Bell Atlantic Company which will permit retention of its facilities in their existing location, together with the right to inspect, maintain, operate and replace the same and with twenty-four hour access to said facilities, or in the alternative should it be determined by the Petitioner that any

such facilities need be relocated in order to comply with an intended use, the Petitioner shall assume all costs of relocation;

4. The City of Providence shall retain for itself, its heirs, successors and assigns full sewer easements in the abandoned streets which will permit retention of its facilities in their existing location, together with the right to inspect, maintain, operate and replace the same and with twenty-four hour access to said facilities, or in the alternative should it be determined by the Petitioner that any such facilities need be relocated in order to comply with an intended use, the Petitioner shall assume all costs of relocation;

5. Petitioner shall meet the conditions to which reference is made in that communication from the Providence Water Supply Board dated September 29, 1998.

6. The Department of Planning & Development shall obtain final City Council approval for the entirety of the Department of Public Safety Complex.

ORDERED, That the Traffic Engineer be and he is hereby directed to cause a sign to be place on the above-named highway abandoned as aforesaid, having thereon the words, "Not a Public Highway", and it is further

ORDERED, That after the entry of this order or decree the City Clerk shall cause a notice thereof to be published in a newspaper, published in the County of Providence at least once a week for three successive weeks and a further and personal notice shall be served by the City Sergeant upon every owner of land abutting the above-named highway which has been abandoned, who is known to reside within the State.

IN CITY COUNCIL
DEC 14 2000
READ AND PASSED

PRES.

CLERK

APPROVED

DEC 18 2000

MAYOR

A true copy.
Attest:

Michael R. Clement
City Clerk



Condemnation line platted from best available records.

State Condemnation Map,
Plat No. 1107 - 9-9-59

West Fountain sq. footage=13,032.0
Cottage St. sq. footage=8,790.0
Total sq. footage=21,822.0

PROVIDENCE, R. I.
P. W. DEPT. - ENGINEERING OFFICE
STREET LINE SECTION
Plan No. 064613
Date Oct. 2, 1998

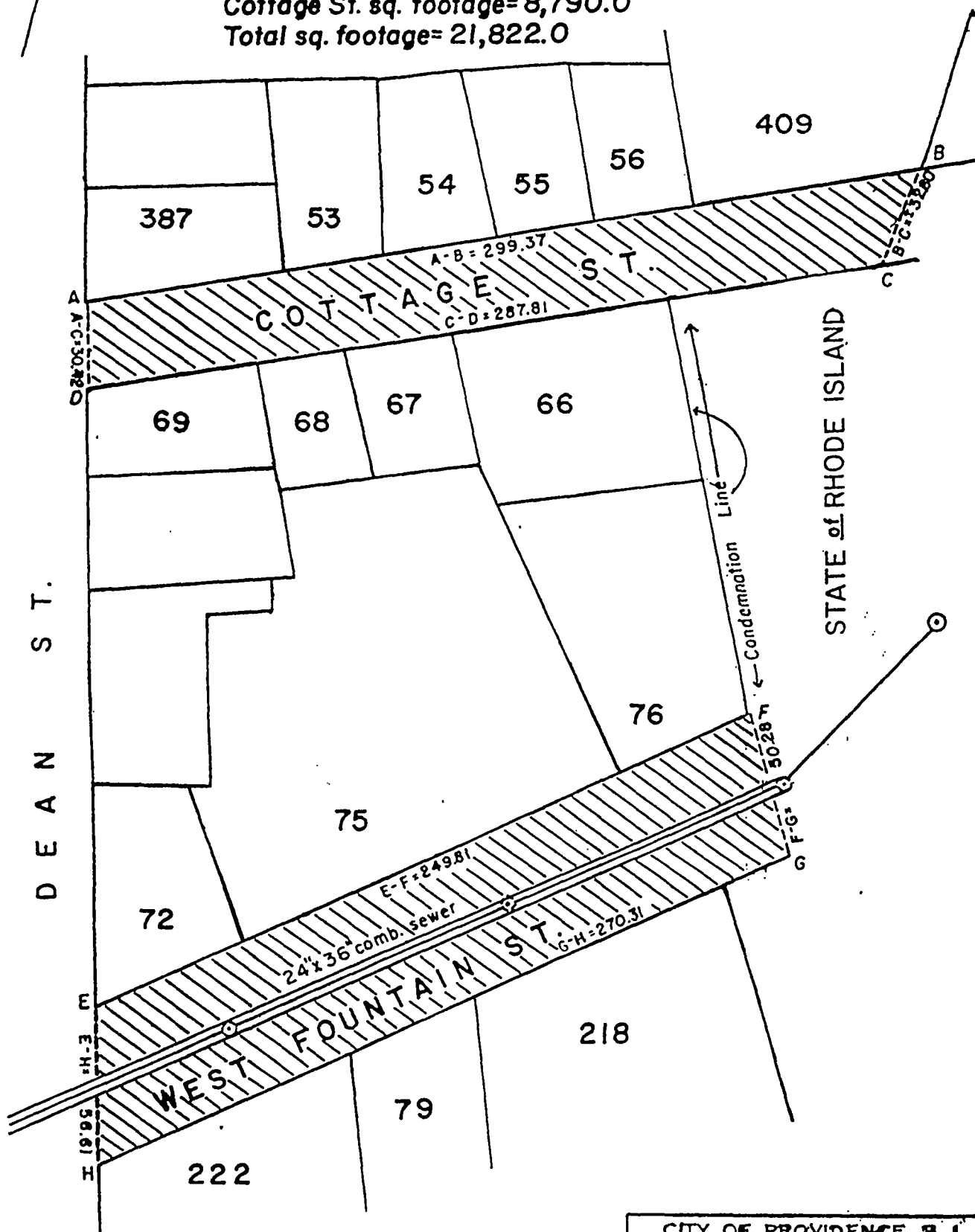

NOTES: Cross-hatched areas (A-B-C-D-A) & (E-F-G-H-E) indicates proposed abandonments.

Full sewer easement will be required for West Fountain St.

Lot numbers taken from A.P. 25.

CITY OF PROVIDENCE, R. I.
Public Works Dept. - Engineering Office
Showing Proposed abandonments of a portion of Cottage & West Fountain Sts.
Drawn by A. Zislaides Checked by J.T.M.
Scale 1" = 50' Date 10-2-98
Correct T. M. M. Associate Engr.
Approved [Signature] Chief Engineer



DEPARTMENT OF CITY CLERK

CITY HALL, PROVIDENCE, R.I. 02903

MICHAEL R. CLEMENT, CITY CLERK



ADDRESSEE UNKNOWN

Gilbert Enterprises
170 Westminster Street
Providence, RI 02903



02903-2101 30



RESOLUTION OF THE CITY COUNCIL

No. 794

Approved December 18, 2000

RESOLVED, DECREED, AND ORDERED:

That the following-named street shown on a cross-hatched area on the accompanying map entitled "Prov., RI, DPW-Engineering Office, Street line Section Plan No. 064613 dated October 2, 1998."

VIZ: Cottage Street from Dean Street to the Service Road and West Fountain Street from Dean Street to the Service Road and shown as a cross-hatched area on the accompanying plan and designated by the letters A-B-C-D-A- and E-F-G-H, respectively, having ceased to be useful to the public and are proposed to be abandoned to Petitioner as a public highway. Said abandonment is specifically conditioned precedent upon the following:

1. Petitioner shall convey an easement acceptable to the Narragansett Electric Company which will permit retention of its facilities in their existing location, together with the right to inspect, maintain, operate and replace the same and with twenty-four hour access to said facilities, or in the alternative should it be determined by the petitioner that any such facilities need be relocated in order to comply with an intended use, the Petitioner shall assume all costs of relocation.

2. Petitioner shall convey an easement acceptable to Providence Gas Company which will permit retention of its facilities in their existing location, together with the right to inspect, maintain, operate and replace the same and with twenty-four hour access to said facilities, or in the alternative should it be determined by the Petitioner that any such facilities need be relocated in order to comply with an intended use, the Petitioner shall assume all costs of relocation;

3. Petitioner shall convey an easement acceptable to Bell Atlantic Company which will permit retention of its facilities in their existing location, together with the right to inspect, maintain, operate and replace the same and with twenty-four hour access to said facilities, or in the alternative should it be determined by the Petitioner that any

such facilities need be relocated in order to comply with an intended use, the Petitioner shall assume all costs of relocation;

4. The City of Providence shall retain for itself, its heirs, successors and assigns full sewer easements in the abandoned streets which will permit retention of its facilities in their existing location, together with the right to inspect, maintain, operate and replace the same and with twenty-four hour access to said facilities, or in the alternative should it be determined by the Petitioner that any such facilities need be relocated in order to comply with an intended use, the Petitioner shall assume all costs of relocation;

5. Petitioner shall meet the conditions to which reference is made in that communication from the Providence Water Supply Board dated September 29, 1998.

6. The Department of Planning & Development shall obtain final City Council approval for the entirety of the Department of Public Safety Complex.

ORDERED, That the Traffic Engineer be and he is hereby directed to cause a sign to be place on the above-named highway abandoned as aforesaid, having thereon the words, "Not a Public Highway", and it is further

ORDERED, That after the entry of this order or decree the City Clerk shall cause a notice thereof to be published in a newspaper, published in the County of Providence at least once a week for three successive weeks and a further and personal notice shall be served by the City Sergeant upon every owner of land abutting the above-named highway which has been abandoned, who is known to reside within the State.

IN CITY COUNCIL
DEC 14 2000
READ AND PASSED

PRES.

CLERK

APPROVED

DEC 18 2000

MAYOR

A true copy.
Attest:

Michael R. Clement
City Clerk



Condemnation line platted from best available records.

State Condemnation Map,
Plat No. 1107 - 9-9-59

West Fountain sq. footage=13,032.0
Cottage St. sq. footage=8,790.0
Total sq. footage=21,822.0

PROVIDENCE, R. I.
P. W. DEPT. - ENGINEERING OFFICE
STREET LINE SECTION
Plan No. 064613
Date Oct. 2, 1998

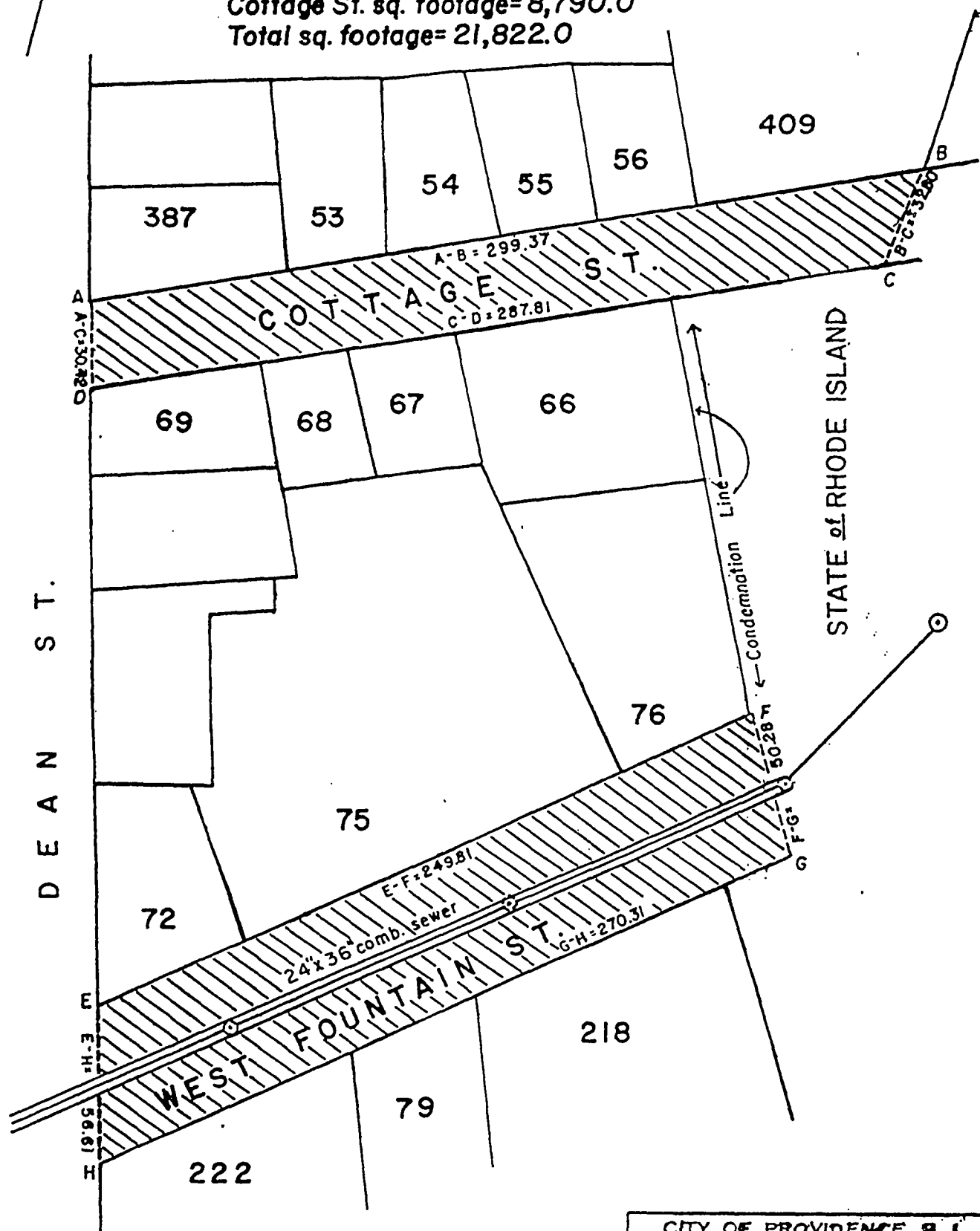

NOTES: Cross-hatched areas (A-B-C-D-A) & (E-F-G-H-E) indicates proposed abandonments.
Full sewer easement will be required for West Fountain St.
Lot numbers taken from A.P. 25.

CITY OF PROVIDENCE, R. I.
Public Works Dept. - Engineering Office
Showing Proposed abandonments of a portion of Cottage St. & West Fountain Sts.
Drawn by A. Zislides Checked by J.T.M.
Scale 1" = 50' Date 10-2-98
Correct T. M. Jones Associate Engr.
Approved [Signature] CHIEF ENGINEER