

THE CITY OF PROVIDENCE  
STATE OF RHODE ISLAND AND PROVIDENCE PLANTATIONS

# RESOLUTION OF THE CITY COUNCIL

No. 256

*Approved* May 10, 2002

RESOLVED, That the Traffic Engineer is requested to prohibit motor vehicle traffic along Pleasant Valley Parkway between Rosebank Avenue and Convent Street on Saturday, June 1, 2002 between the hours of 9:00 o'clock a.m. to 5:00 o'clock p.m., to accommodate the National Cancer Survivors' Day.

IN CITY COUNCIL  
MAY 2 2002  
READ AND PASSED

PRES.

CLERK

APPROVED

MAY 10 2002

MAYOR

Councilman Butts (By Bequith)

IRENE J. TESTA  
Traffic Engineer

JOSEPH W. CAPRIO  
Deputy Director



VINCENT A. CIANCI, JR.  
Mayor

Department of Traffic Engineering  
"Building Pride In Providence"

## MEMORANDUM

**TO:** Brett Davey  
Roger Williams Medical Center

**FROM:** IRENE TESTA *Irene Testa*  
DIRECTOR, DEPT. OF TRAFFIC ENGINEERING

**DATE:** 4/19/02

**RE:** NATIONAL CANCER SURVIVORS' DAY

---

*I am in receipt of a copy of your memo to Beth Rossi in Mayor Cianci's Office.*

*I have written a work order to have that portion of Pleasant Valley Parkway between Rosebank Avenue and Convent Street closed between 9:00AM and 5:00PM on Saturday, June 1<sup>st</sup>.*

*If you have any questions in this regard, please feel free to contact me directly.*

*Butler By Bequest*

*cc: Scott Millard, Special Assistant to Mayor Cianci*

CITY OF PROVIDENCE

SATURDAY

WORK ORDER SHEET

DEPARTMENT OF TRAFFIC ENGINEERING

SCHEDULE: 6/1/02

☐ AM JOB

NO: 04 --

TIME: 9AM - 5PM

☐ BASES

DATE: 4/19/02

DATE COMPLETED:

☐ HILTI

FROM: Butler In RW Hosp

CREW:

☐ CORE DRILL

TIME: 7:00 AM PM

LOCATION: ON

PVP

S/N-S-E-W

T/N-S-E-W

AT/BETWEEN

Rosebank Ave and Convent St

C/NE-SE-SW-NW

1. ☐ STUB5. ☐ Install/replace sign(s)-NEC AP UP SP2. ☐ Down Post6. ☐ Install/replace sign(s) & post (s)3. ☐ Bent/Twisted Post7. ☐ Street/Bridge Closed/Detour4. ☐ Loose sign/relag-rebolt-reband8. ☐ SEE OTHER SIDE9. ☐ FORESTRY☐ STOP ☐ 4-WAY ☐ 3-WAY PLATE☐ STOP AHEAD☐ NO PARKING L-D-R☐ SIGNAL AHEAD☐ YIELD☐ STOP FOR PEDS.☐ DO NOT ENTER☐ 15/M: L-D-R☐ ONE WAY (R) (L)☐ 30/M: L-D-R☐ KEEP RIGHT☐ 1/HR: L-D-R☐ NO RIGHT TURN ☐ NO LEFT TURN☐ 2/HR: L-D-R☐ NO "U" TURN ☐ NO TURNS☐ NPTC: L - R☐ RIGHT TURN ONLY ☐ LEFT TURN ONLY☐ NPSD: L-D-R☐ NO THRU TRUCKS☐ BUS STOP L - R☐ X-WALK☐ ADVANCE☐ NPLZ: L-D-R☐ SCHOOL☐ ADVANCE☐ NPTS: L-D-R☐ DEAD END☐ NSSAT: L-D-R☐ CURVE (R) (L) ☐ CHEVRON (R) (L)☐ NS: L-D-R☐ 90° CURVE (R) (L)☐ NPTZ: L-D-R☐ TWO WAY TRAFFIC☐ 10/HR: L-D-R☐ DA☐ DA (ISLAND)☐ /HR: L-D-R☐ HANDICAPPED☐ /M: L-D-R☐ CHILDREN☐ OTHER:☐ 25 M.P.H.☐ STREET NAME

Close off

street for

National Cancer

Survivors Day

See attached

map.

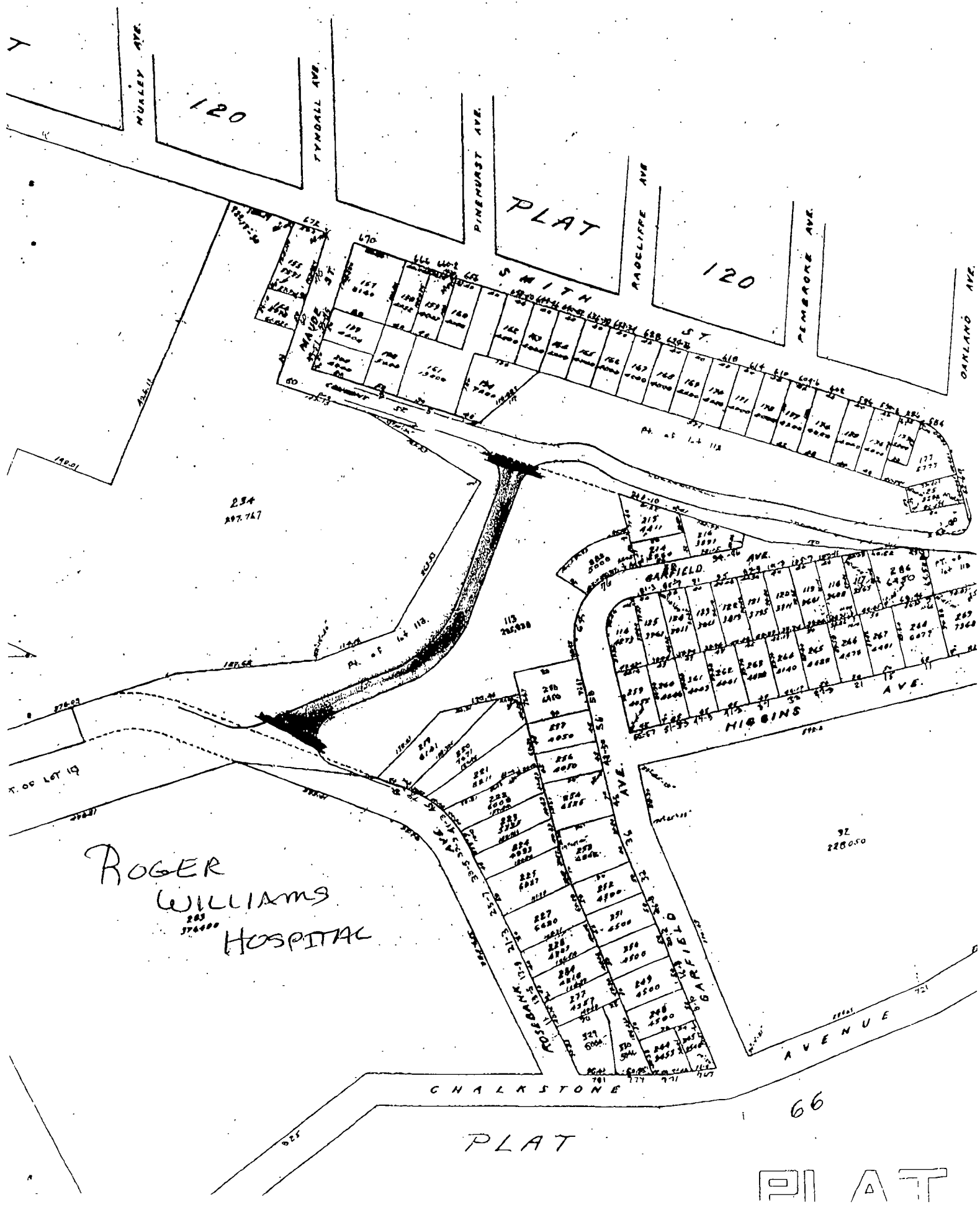



Executive Office, City of Providence, Rhode Island

VINCENT A. CIANCI, JR.  
MAYOR

## Facsimile Cover Sheet

**Scott A. Millard**

Special Assistant to Mayor

Citizen's Assistance Coordinator

(401) 421-7740, ext. 221 □ (401) 274-8240 Fax

TO:

*Arene Testa*

COMPANY NAME:

*Traffic Engineering*

FAX NUMBER:

*781-4044*

If you have any questions regarding this fax, please call (401) 421-7740, ext. 221

PAGE

*1* of *2*

(including cover sheet)

DATE/TIME

*4-18-02 4:00pm*

MESSAGE/COMMENTS:

*Councilman Butler approved street  
closure (Resolution)*

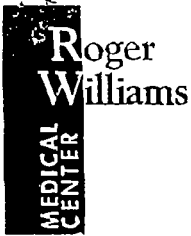

*Public Relations Office*

Roger Williams Hospital

825 Chalkstone Avenue  
Providence  
Rhode Island 02908-4735  
(401) 456-2000

April 11, 2002

To: **Beth Rossi, Providence City Hall (fax: 274-8240)**

From: **Brett Davey, Roger Williams Medical Center**

Subject: **National Cancer Survivors' Day**

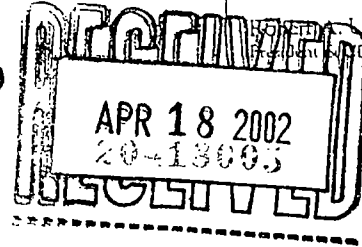

Beth,

I spoke with Doreen Picozzi last week and she recommended I send you a fax with the details about what we're doing for National Cancer Survivors Day.

The date of the event is June 1, 2002. It should run from 11 a.m. to 3 p.m. For setup and breakdown purposes, we would like the area from 9 a.m. to 5 p.m. The event will include speakers, booths, and food.

What we're hoping to do is to cordon off the end of Pleasant Valley Parkway to use for the event. It is the end of the Parkway behind the old Lying-In Hospital, a building that is now medical offices and a nursing home owned by the hospital. The two streets at the end of the cordoned-off area are Rosebank and Convent.

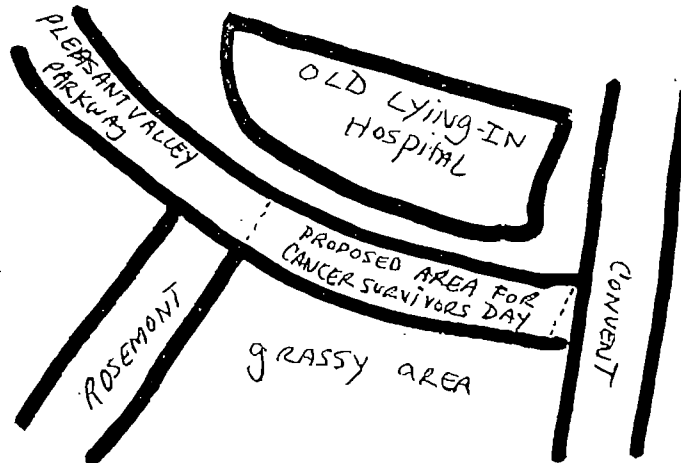

This is a low traffic area that is essentially used as a short cut for most people.

When you drive down this road – on the opposite side from the nursing home – there is a small patch of grass. We would like to use that as well.

The hospital can create signage to let people know there is an event so they won't cut through. What we need is authorization from the city to do so and whatever else you tell me is necessary! Please call me at 456-2421 and tell me what the next step is. Thanks!



A Major Teaching and Research Affiliate of  
The Boston University School of Medicine

*permut  
gloria*  
*Council  
Traffic  
Police.  
Park  
street  
sweeping  
Saturday  
781-4044  
Traffic*

*sent*  
*1. Entertainment  
applications  
black*  
*2. Food  
disposal  
one  
day*  
*Robert  
Public Safety*

IRENE J. TESTA  
Traffic Engineer

JOSEPH W. CAPRIO  
Deputy Director



VINCENT A. CIANCI, JR.  
Mayor

Department of Traffic Engineering  
"Building Pride In Providence"

FAX - (401) 781-4044

*Street  
Cass  
Complete*  
*Clark's  
Office*  
*Daly*  
*FD*

# FAX

TO:

SCOTT

FROM: IRENE J. TESTA

DATE:

4/19 /2001

**FAX:**

NUMBER OF PAGES INCLUDING COVER SHEET:

2 3 (4) 5 6 7 8 9 10 11 12

2 3 4 5 6 7 8 9 10 11 12

2 3 4 5 6 7 8 9 10 11 12

COMMENTS:

\_\_\_\_\_  
\_\_\_\_\_  
\_\_\_\_\_