

THE CITY OF PROVIDENCE
STATE OF RHODE ISLAND AND PROVIDENCE PLANTATIONS

RESOLUTION OF THE CITY COUNCIL

No. 563

Approved November 28, 1989

RESOLVED, DECREED AND ORDERED

That the following named street shown as cross-hatched area on the accompanying plan entitled, "Providence, Rhode Island, Department of Public Works - Engineering Office, Street Line Section Plan No. 064363, dated November 13, 1986",

VIZ:

Mississippi Avenue, shown as cross-hatched area on the accompanying plan and designated by the letters (A-B-C-D-A), having ceased to be useful to the public and the same is proposed to be abandoned as a Public Highway, provided that an easement shall be granted to the Providence Gas Company for their existing gas mains to operate, maintain, and replace when required, and the damage to the abutters is appraised at nothing and so awarded, and it is further,

ORDERED, That the Traffic Engineer, be and he is hereby directed to cause a sign to be placed on the above-named highway abandoned as aforesaid, having thereon the words, "Not a Public Highway", and it is further

ORDERED, That after the entry of this order or decree, the City Clerk shall cause a notice, thereof, to be published in a newspaper published in the County of Providence at least once a week for three successive weeks, and a further and personal notice shall be served by the City Sergeant upon every owner of land abutting the above-named highway which has been abandoned, who is known to reside within the State.

IN CITY COUNCIL

NOV 16 1989

READ AND PASSED

Nicholas W. Epton
PRES.

Rose M. Mendonca
CLERK

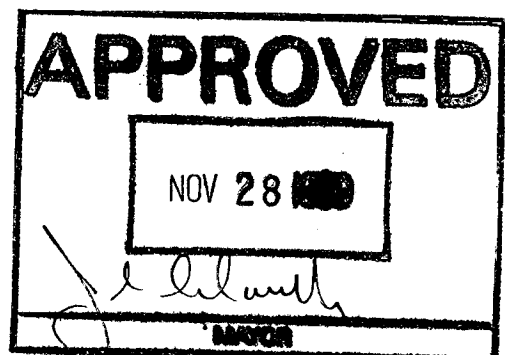

**THE COMMITTEE ON
PUBLIC WORKS**

**Approves Passage of
The Within Resolution**

Rose M. Hughes
Chair Chairman

November 1, 1959

PETITION TO THE CITY COUNCIL

TO THE HONORABLE CITY COUNCIL OF THE CITY OF PROVIDENCE:

The undersigned respectfully petitions your honorable body

to consider my request for abandonment of Mississippi Avenue. This street is recorded on Plat #87 and shows as a paper street measuring 40 feet by 128 feet in the records at City Hall.

I am the new owner of the house at 1014 Narragansett Boulevard, my driveway abutts Mississippi Avenue.

One of the reoccurring problems is students and neighbors misjudge the boundries and as a result are parking directly in my driveway, blocking access to the rear entrance of my home.

Also, during my efforts to maintain my property, I have noticed the increasing volume of trash and beer bottles left either by owners of the cars parked on Mississippi Avenue overnight, or by teenagers who are drinking in the area. As a result, I find myself cleaning my property as well as Mississippi Avenue.

Another major concern of mine is that the street will slowly become a city dumping site. To substantiate my fears, there has been an abandoned car parked there since February and the trash problem has become increasingly worse.

I have spoken to Mr. Friedman, the owner of Paramount Resturaunt Supply, and he said neither he nor his brother would have any objections should you decide in my favor. The same holds true for Michael Marsh, the owner of the Shell Gas Station located on the south-erly side of Mississippi Avenue.

Should your honorable body decide in favor of abandonment, I would have the legal right to restrict any loitering or drinking on Mississippi Avenue, thus helping to contain the trash problem in the area. And I could have some recourse for the abandoned car situation. Last but not least be able to have unrestricted access to my driveway.

I am aware of the previous rejection for abandonment, however since that time there has been some changes to the street. Landfill has been brought in and an eight foot fence has been erected to prevent children and teenagers from loitering behind Paramount Rest-uraunt Supplies Warehouse, located directly at the end of the street. I am also aware of the drainage line and maintenance responsibility involved.

I do appreciate your time and consideration towards this important matter.

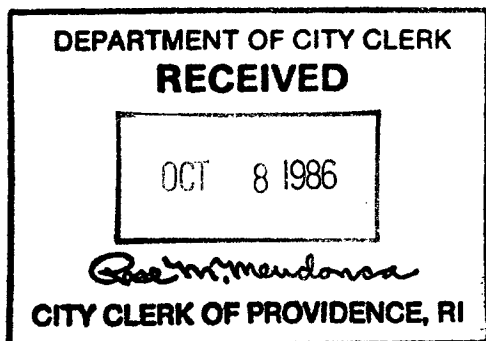

*Check # 199
Amount \$75.00*

Sincerely,
GWEN C. ALTENBAUGH
Gwen C. Altenbaugh
1014 Narragansett Blvd.
Providence, R.I. 02905
401-941-4377
P.O. Box 5822
Pav. R.I. 02903

OFFICE OF THE CLERK
CITY OF LOS ANGELES

IN CITY COUNCIL
OCT 16 1986

FIRST READING
REFERRED TO COMMITTEE ON PUBLIC WORKS

Raem Monahan CLERK

THE COMMITTEE ON *March 11, 1987*
PUBLIC WORKS

Recommends *Be Continued*
Michael R. Clement
Clerk

From the Clerk's Desk

70	71	72	73	74	75	76	77	78	79	80	81	82	83	84
3200	3200	3200	3200	3200	3200	3200	3200	3200	3200	3200	3200	3200	3200	3200
215	216	217	218	219	220	221	222	223	224	225	226	227	228	229
AVENUE														
111	112	114	115	116	117	118	119	120	121	122	123	124	125	126
3200	6400	3200	3200	3200	3200	3200	3200	3200	3200	3200	3200	3200	3200	3200
153	154	155	156	157	158	159	160	161	162	163	164	165	166	167
3200	3200	3200	3200	3200	3200	3200	3200	3200	3200	3200	3200	3200	3200	3200
219	220	221	222	223	224	225	226	227	228	229	230	231	232	233
AVENUE														
195	196	197	198	199	200	201	202	203	204	205	206	207	208	209
3200	3200	3200	3200	3200	3200	3200	3200	3200	3200	3200	3200	3200	3200	3200
241	242	243	244	245	246	247	248	249	250	251	252	253	254	255
3200	3200	3200	3200	3200	3200	3200	3200	3200	3200	3200	3200	3200	3200	3200
219	220	221	222	223	224	225	226	227	228	229	230	231	232	233
AVENUE														
279	280	281	282	283	284	285	286	287	288	289	290	291	292	293
3200	3200	3200	3200	3200	3200	3200	3200	3200	3200	3200	3200	3200	3200	3200
321	322	323	324	325	326	327	328	329	330	331	332	333	334	335
3200	3200	3200	3200	3200	3200	3200	3200	3200	3200	3200	3200	3200	3200	3200
219	220	221	222	223	224	225	226	227	228	229	230	231	232	233
AVENUE														
359	360	361	362	363	364	365	366	367	368	369	370	371	372	373
3200	3200	3200	3200	3200	3200	3200	3200	3200	3200	3200	3200	3200	3200	3200
394	395	396	397	398	399	400	401	402	403	404	405	406	407	408
4500	4500	9000	4500	4500	4500	4500	4500	4500	4500	4500	3825	5175	5175	5175
219	220	221	222	223	224	225	226	227	228	229	230	231	232	233
AVENUE														
427	428	430	431	432	433	434	435	436	437	438	439	440	441	442
350	9000	4500	4500	4500	4500	4500	4500	4500	4500	4500	4500	4500	4500	4500
463	464	465	466	467	468	469	470	471	472	473	474	475	476	477
3200	3200	3200	3200	3200	3200	3200	3200	3200	3200	3200	3200	3200	3200	6400
219	220	221	222	223	224	225	226	227	228	229	230	231	232	233
AVENUE														
501	502	503	504	505	506	507	508	509	510	511	512	513	514	515
3200	3200	3200	3200	3200	4800	3200	3200	3200	3200	3200	3200	3200	3200	6400
536	537	538	539	540	541	542	543	544	545	546	547	548	549	550
3200	3200	3200	3200	3200	3200	3200	3200	3200	3200	3200	3200	3200	3200	6400
219	220	221	222	223	224	225	226	227	228	229	230	231	232	233
AVENUE														
563	564	565	566	567	568	569	570	571	572	573	574	575	576	577
3200	3200	3200	3200	3200	3200	3200	3200	3200	3200	3200	3200	3200	3200	3200
582	583	584	585	586	587	588	589	590	591	592	593	594	595	596
3200	3200	3200	3200	3200	3200	3200	3200	3200	3200	3200	3200	3200	3200	3200
219	220	221	222	223	224	225	226	227	228	229	230	231	232	233
CRANSTON														

BOULEVARD

NARRAGANSETT

674	673	672	671	670	669	668	667	666	665	664	662	661
3200	3840	3200	3200	3200	3200	3200	3200	3200	3200	4800	4800	3200
123	124	125	126	127	128	129	130	131	132	133	134	135
VERMONT												
677	678	679	680	681	682	683	684	685	686	687	688	689
3440	3600	3200	3200	3200	3200	3200	3200	4000	5600	3200	3200	3200
123	124	125	126	127	128	129	130	131	132	133	134	135
VERMONT												
747	748	749	750	751	752	753	754	755	756	757	758	759
3840	3200	3200	3200	3200	3200	3200	3200	3200	3200	3200	3200	3200
123	124	125	126	127	128	129	130	131	132	133	134	135
VERMONT												
812	811	810	809	808	807	806	805	804	803	802	801	800
3520	3200	3200	3200	4800	4800	4254	5346	4000	5600	5600	5600	5600
123	124	125	126	127	128	129	130	131	132	133	134	135
WASHINGTON												
916	917	918	919	920	921	922	923	924	925	926	927	928
7964	3200	3200	3200	3200	3200	3200	3200	3200	3200	3200	3200	3200
123	124	125	126	127	128	129	130	131	132	133	134	135
WASHINGTON												
1110	1109	1108	1107	1106	1105	1104	1103	1102	1101	1100	1099	1098
5747	4027	3200	3200	5430	3200	3200	7240	3200	4800	3200	6000	6000
123	124	125	126	127	128	129	130	131	132	133	134	135
WASHINGTON												
126	127	128	129	130	131	132	133	134	135	136	137	138
945	946	947	948	949	950	951	952	953	954	955	956	957
5280	4320	3840	3200	3200	3200	3200	3200	4800	3200	8000	6400	6400
123	124	125	126	127	128	129	130	131	132	133	134	135
WASHINGTON												
1026	1027	1028	1029	1030	1031	1032	1033	1034	1035	1036	1037	1038
4800	4800	3840	3200	3200	4000	4000	3600	3600	4000	4800	4800	4800
123	124	125	126	127	128	129	130	131	132	133	134	135
WASHINGTON												
1032	1033	1034	1035	1036	1037	1038	1039	1040	1041	1042	1043	1044
9440	6400	4000	7200	4800	6000	6000	4000	4400	3600	3600	3600	3600
123	124	125	126	127	128	129	130	131	132	133	134	135
MISSISSIPPI												
1064	1065	1066	1067	1068	1069	1070	1071	1072	1073	1074	1075	1076
14389	14389	14389	14389	14389	14389	14389	14389	14389	14389	14389	14389	14389
123	124	125	126	127	128	129	130	131	132	133	134	135
MISSISSIPPI												

City of Providence



Rhode Island

Department of City Clerk

MEMORANDUM

DATE: October 17, 1986

TO: Anthony G. Stanzione, Director of Public Works

SUBJECT: MISSISSIPPI AVENUE - ABANDONMENT

CONSIDERED BY: Committee on Public Works

DISPOSITION: Attached is a copy of the subject matter, for your study and report back in writing to the above named committee.

It is also requested that you provide the committee with a list of abutting property owners and tracing of the area, as soon as practical.

Michael R. Clement,
First Deputy City Clerk

City of Providence



Rhode Island

Department of City Clerk

MEMORANDUM

DATE: October 17, 1986

TO: *

SUBJECT: MISSISSIPPI AVENUE, ABANDONMENT

CONSIDERED BY: Committee on Public Works

DISPOSITION: Attached is a copy of the subject matter, for your study and report back in writing to the above named Committee, as soon as practical.

* Kathleen Field, Associate Planner - *ah*
Wiley J. Archer, Chief of Water Supply Board - *ah*
Charles A. Pisaturo, Commissioner of Public Safety - *ah*
B. James Suzman, Traffic Engineer - *ah*

Michael R. Clement,
First Deputy City Clerk

City of Providence



Rhode Island

Department of City Clerk

MEMORANDUM

DATE: December 5, 1986

TO: Nancy Derrig, Superintendent of Parks

SUBJECT: MISSISSIPPI AVENUE - ABANDONMENT

CONSIDERED BY: Committee on Public Works

DISPOSITION: Attached is a copy of the subject matter,
for your study and report back in writing to the
above named Committee, as soon as practical.

ok

Michael R. Clement,

City Clerk

First Deputy

ROCCO A. DE LUCA
~~ANTHONY G. STANZIONE, P.E.~~
DIRECTOR



JOSEPH R. PAOLINO, JR.
MAYOR

Department of Public Works
"Building Pride In Providence"

February 11, 1987

Hon. James A. Petrosinelli
Committee on Public Works
Providence City Council
City Hall - Providence, R.I. 02903

Re: Proposed Abandonment of Mississippi Avenue

Dear Councilman Petrosinelli:

The Department of Public Works does not recommend the abandonment of Mississippi Avenue.

Very truly yours,

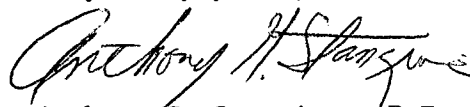
Anthony G. Stanzione, P.E.
City Engineer

AGS:jlc

CC: R. DeLuca - Director
R. Quigley - Assoc. Eng.

GEORGE A. CALCAGNI
CHAIRMAN
ARMANDO PARILLO
VICE CHAIRMAN
JAMES A. LOMBARDI
Secretary
JOHN E. MARTINELLI
Legal Advisor
JEROME I. BARON
Ex-Officio



JOSEPH R. PAOLINO, JR.
MAYOR
WILEY J. ARCHER, P.E.
CHIEF ENGR./GENERAL MANAGER
EVELYN V. FARGNOLI
City Councilwoman
ANDREW J. ANNALDO
City Councilman
MARY A. NOCERA
Member
LOUIS ORABONA
MEMBER

Water Supply Board
"Building Pride In Providence"

October 23, 1986

Councilman James Petrosinelli, Chairman
Committee on Public Works
City Clerk's Office
City Hall
Providence, Rhode Island

Dear Councilman Petrosinelli:

This department received a copy of a Petition for the abandonment of Mississippi Avenue in the City of Providence.

The Water Supply Board has no facilities in this area to be abandoned and therefore has no objection to the abandonment.

Very truly yours,

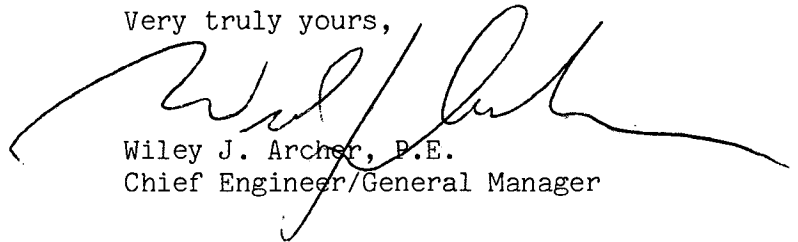

Wiley J. Archer, P.E.
Chief Engineer/General Manager

mtd

cc: Mr. Edward Bondarevskis
Senior Principal Engineer, WSB

FILED

OCT 24 9 47 AM '86

DEPT. OF CLERK
PROVIDENCE, R.I.

B. JAMES SUZMAN
TRAFFIC ENGINEER



JOSEPH R. PAOLINO, JR.
MAYOR

Department of Traffic Engineering

"Building Pride In Providence"

TO: Michael R. Clement, First Deputy City Clerk
FROM: B. James Suzman, Traffic Engineer
DATE: December 1, 1986
RE: Abandonments
FOR: Transmittal to Committee on Public Works

Be advised that I have reviewed proposed abandonments of Mississippi Avenue (10-17-86 memorandum) and Parkside Road and Towner Street (11-24-86 memorandum). No objection is offered to any of these proposed abandonments- assuming Fire Department concurrence.

Department of Traffic Engineering
60 Ernest Street
Providence, Rhode Island 02905

Mr. Michael R. Clement, First Deputy City Clerk
City Clerk's Office
City Hall

PAID

DEC 1 2 11 PM '96

DEPT. OF THE CITY
PROVIDENCE, R.I.

-1





Department of Traffic Engineering

"Building Pride In Providence"

M E M O R A N D U M

TO: Committee on Public Works

FROM: B. James Suzman, Traffic Engineer

DATE: December 1, 1986

RE: MISSISSIPPI AVENUE ABANDONMENT

Request: To abandon a portion of Mississippi Avenue.

Disposition: No objection to said abandonment.

FILED

DEC 4 9 22 AM '86

DEPT. OF JUSTICE
PROVIDENCE, R.I.

CHARLES A. PISATURO, ESQ.
COMMISSIONER
CHIEF MICHAEL F. MOISE
FIRE CHIEF



JOSEPH R. PAOLINO, JR.
MAYOR

Department of Public Safety, Fire Department

"Building Pride In Providence"

October 29, 1986

To: Charles A. Pisaturo, Commissioner of Public Safety
From: Michael F. Moise, Chief of Department
Subject: Street Abandonment - Mississippi Street

Dear Sir:

The request for the abandonment of Mississippi Avenue will pose no operational problems to the Providence Fire Department.

Respectfully,

Michael F. Moise
Chief of Department

MFM/ds

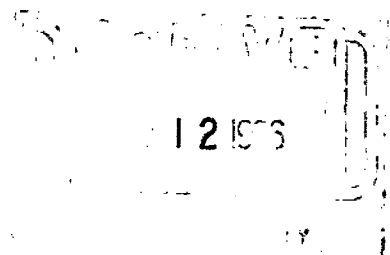

FILED
NOV 13 11 37 AM '86
DEPT. OF CORRECTIONS
PROVIDENCE, R.I.



Department of Public Safety

"Building Pride In Providence"

December 2, 1986

Ms. Rose Mendonca
City Clerk
Providence City Hall
Providence, RI 02903

RE: Proposed Street Abandonment MISSISSIPPI AVENUE

Dear Ms. Mendonca:

I forward herewith responses from the Chief of the Fire Department and the Chief of Police with regard to the above street abandonment request. I have no objection to the abandonment of Mississippi Avenue.

Very truly yours,

A handwritten signature in cursive script that reads "Charles A. Pisaturo". The signature is written in dark ink and is positioned above a horizontal line.

Charles A. Pisaturo
Commissioner of Public Safety

dn
Enc.

DEC 2 1986

FILED

DEC 4 9 22 AM '86

DEPT. OF JUSTICE
PROVIDENCE, R.I.

City of Providence



Rhode Island

Department of City Clerk

MEMORANDUM

DATE: October 17, 1986

TO: Charles A. Pisaturo, Commissioner of Public Safety

SUBJECT: MISSISSIPPI AVENUE, ABANDONMENT

CONSIDERED BY: Committee on Public Works

DISPOSITION: Attached is a copy of the subject matter, for your study and report back in writing to the above named Committee, as soon as practical.

217

Michael R. Clement
Michael R. Clement,
First Deputy City Clerk

CHARLES A. PISATURO, ESQ.
COMMISSIONER
CHIEF MICHAEL F. MOISE
FIRE CHIEF



JOSEPH R. PAOLINO, JR.
MAYOR

Department of Public Safety, Fire Department
"Building Pride In Providence"

October 29, 1986

To: Charles A. Pisaturo, Commissioner of Public Safety
From: Michael F. Moise, Chief of Department
Subject: Street Abandonment - Mississippi Street

Dear Sir:

The request for the abandonment of Mississippi Avenue will pose no operational problems to the Providence Fire Department.

Respectfully,

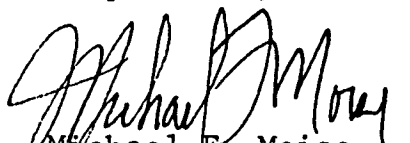
Michael F. Moise
Chief of Department

MFM/ds

PROVIDENCE POLICE DEPARTMENT

Headquarters

October 23, 1986

To: The Honorable Charles A. Pisaturo, Public Safety Commissioner
From: Colonel Anthony J. Mancuso, Chief of Police
Subject: Petition for Street Abandonment - Portion of Mississippi Ave.

Sir:

In accordance with your directive of October 21, 1986 regarding the captioned matter, attached is a copy of a report compiled by Lieutenant William V. Devine, Director, Traffic Bureau, which you will find to be self-explanatory in nature.

Respectfully submitted,

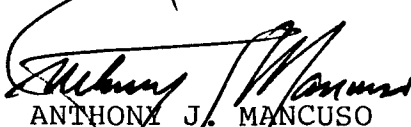
ANTHONY J. MANCUSO
Colonel
Chief of Police

Attachment

0005j

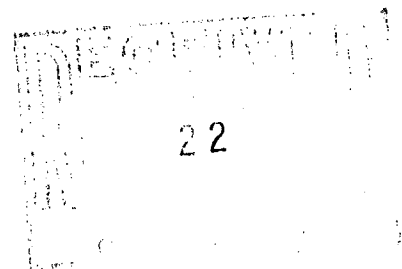

PROVIDENCE POLICE DEPARTMENT

October 22, 1986

To: Colonel Anthony Mancuso, Chief of Police

From: Lieut. William V. Devine, Traffic Bureau

Subject: Petition for Street Abandonment - Portion Mississippi Avenue

Sir:

On October 21, 1986, your office received a proposal of a portion of a street abandonment, Mississippi Avenue, I was directed to respond to the area and investigate this street abandonment petition and forward a written report on my recommendation to this abandonment.

On October 22, 1986, Sgt. Raymond Hastings, of my command, responded to the area of proposed abandonment. After speaking with Sgt. Hastings on his survey of this area I feel that Public Safety would not be compromised and I have no objection to this petition being granted.

Respectfully submitted,



Lieut. William V. Devine,
Traffic Bureau

CITY OF PROVIDENCE
STATE OF RHODE ISLAND AND PROVIDENCE PLANTATIONS

PETITION TO THE CITY COUNCIL

TO THE HONORABLE CITY COUNCIL OF THE CITY OF PROVIDENCE:

The undersigned respectfully petitions your honorable body

to consider my request for abandonment of Mississippi Avenue. This street is recorded on Plat #87 and shows as a paper street measuring 40 feet by 128 feet in the records at City Hall.

I am the new owner of the house at 1014 Narragansett Boulevard, my driveway abutts Mississippi Avenue.

One of the reoccurring problems is students and neighbors misjudge the boundries and as a result are parking directly in my driveway, blocking access to the rear entrance of my home.

Also, during my efforts to maintain my property, I have noticed the increasing volume of trash and beer bottles left either by owners of the cars parked on Mississippi Avenue overnight, or by teenagers who are drinking in the area. As a result, I find myself cleaning my property as well as Mississippi Avenue.

Another major concern of mine is that the street will slowly become a city dumping site. To substantiate my fears, there has been an abandoned car parked there since February and the trash problem has become increasingly worse.

I have spoken to Mr. Friedman, the owner of Paramount Resturaunt Supply, and he said neither he nor his brother would have any objections should you decide in my favor. The same holds true for Michael Marsh, the owner of the Shell Gas Station located on the south-erly side of Mississippi Avenue.

Should your honorable body decide in favor of abandonment, I would have the legal right to restrict any loitering or drinking on Mississippi Avenue, thus helping to contain the trash problem in the area. And I could have some recourse for the abandoned car situation. Last but not least be able to have unrestricted access to my driveway.

I am aware of the previous rejection for abandonment, however since that time there has been some changes to the street. Landfill has been brought in and an eight foot fence has been erected to prevent children and teenagers from loitering behind Paramount Rest-uraunt Supplies Warehouse, located directly at the end of the street. I am also aware of the drainage line and maintenance responsibility involved.

I do appreciate your time and consideration towards this important matter.

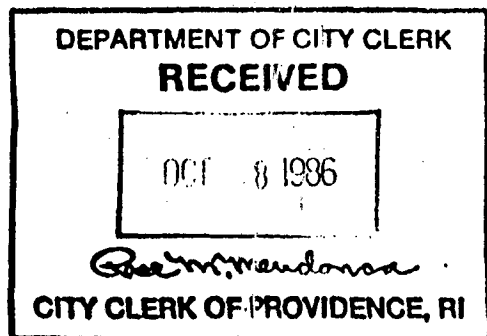

Sincerely,

GWEN C. ALTENBACH
Gwen C. Altenbach
1014 Narragansett Blvd.
Providence, R.I. 02905

401-941-4377

Check # 199
Amount \$ 75.00



The City Plan Commission

44 Washington Street

PROVIDENCE, RHODE ISLAND 02903

November 26, 1986

Committee on Public Works
c/o City Clerk
City Hall
Providence, Rhode Island 02903

Attn: Rose M. Mendonca, City Clerk

Gentlemen:

Since the City Plan Commission did not have a quorum at its November meeting, the Chairperson has requested that I send along to the Committee on Public Works the staff recommendation for the following petition:

Abandonment of Mississippi Avenue

If the Committee on Public Works wishes to have the City Plan Commission consider the above petition at its December meeting, the Commission is willing to do so. The reason we are sending over the attached is to at least provide the Committee with some input should they hold their meeting in the near future.

Sincerely yours,

A handwritten signature in cursive script that reads "Kathleen D. Field".

Kathleen D. Field
Associate Director of Planning

KDF/jp
Attachment

CPC REFERRAL NO. 2201 - Abandonment of Mississippi Avenue

A communication was received from the Committee on Public Works dated October 17, 1986 requesting the City Plan Commission's recommendations on the proposed abandonment of Mississippi Avenue from Narragansett Boulevard to its easterly terminus.

The petitioner is Mr. Gwen C. Altenbaugh of 1014 Narragansett Boulevard, Providence, Rhode Island, owner of adjacent property described as Assessor's lot 1061 on Plat 87.

A field inspection revealed that Mississippi Avenue is a dead end street, partially paved (approximately 50 feet from Narragansett Boulevard is paved) and used by the petitioner as a driveway to his property. The southern side of a paved portion is used as parking by neighborhood tenants.

The adjacent lot 1064 is occupied by the Shell Gas Station.

Behind the eastern terminus of Mississippi Avenue there is a steep embankment and the level of terrain drops approximately 40 ft. down.

Since the petitioner in his petition to the City Council acknowledged that he contacted all adjacent property owners and no objection was offered to his petition, the staff recommends that the Commission advise the Committee on City Property that no objection is offered to this abandonment.



Department of Public Parks
"Building Pride In Providence"

December 10, 1986

Mr. Michael Clement, First Deputy City clerk
City Clerk's Office
City Hall
Providence, Rhode Island 02903

RE: PROPOSED ABANDONMENT OF: 1. MISSISSIPPI AVENUE FROM NARRAGANSETT BLVD. EASTERLY
2. TOWNER STREET FROM CLARK STREET SOUTHERLY
3. CLARK STREET FROM TOWNER TO HYLESTEAD STREET
4. PERRIN STREET FROM FREEDOM ROAD SOUTHERLY
5. MONGENAIS STREET FROM ITS TERMINUS AT 32/34 MONGENAIS STREET NORTHERLY
6. PARKSIDE ROAD FROM EAST ORCHARD AVENUE TO ITS NORTHERLY TERMINUS
7. CORSICA STREET FROM FRUIT HILL AVENUE TO GENOA AVENUE

Dear Mr. Clement,

In researching the Department of Public Parks site map and records, our conclusion is that the proposed abandonments of the above named streets or portions of them, will in no way conflict with any Parks Department facility or future plans for the areas.

Therefore, the Department of Public Parks has no objection to the proposed abandonments.

Enclosed are maps indicating the streets in question colored in red and the nearest Department of Public Parks facility colored in green.

Sincerely,

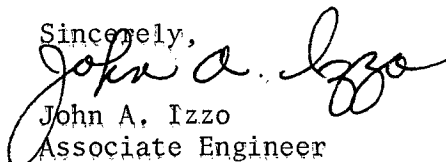
John A. Izzo
Associate Engineer

Enclosures

cc: Nancy L. Derrig, Superintendent of Parks

FILED

DEC 15 2 48 PM '86

DEPT. OF CORRECTIONS
PROVIDENCE, R.I.

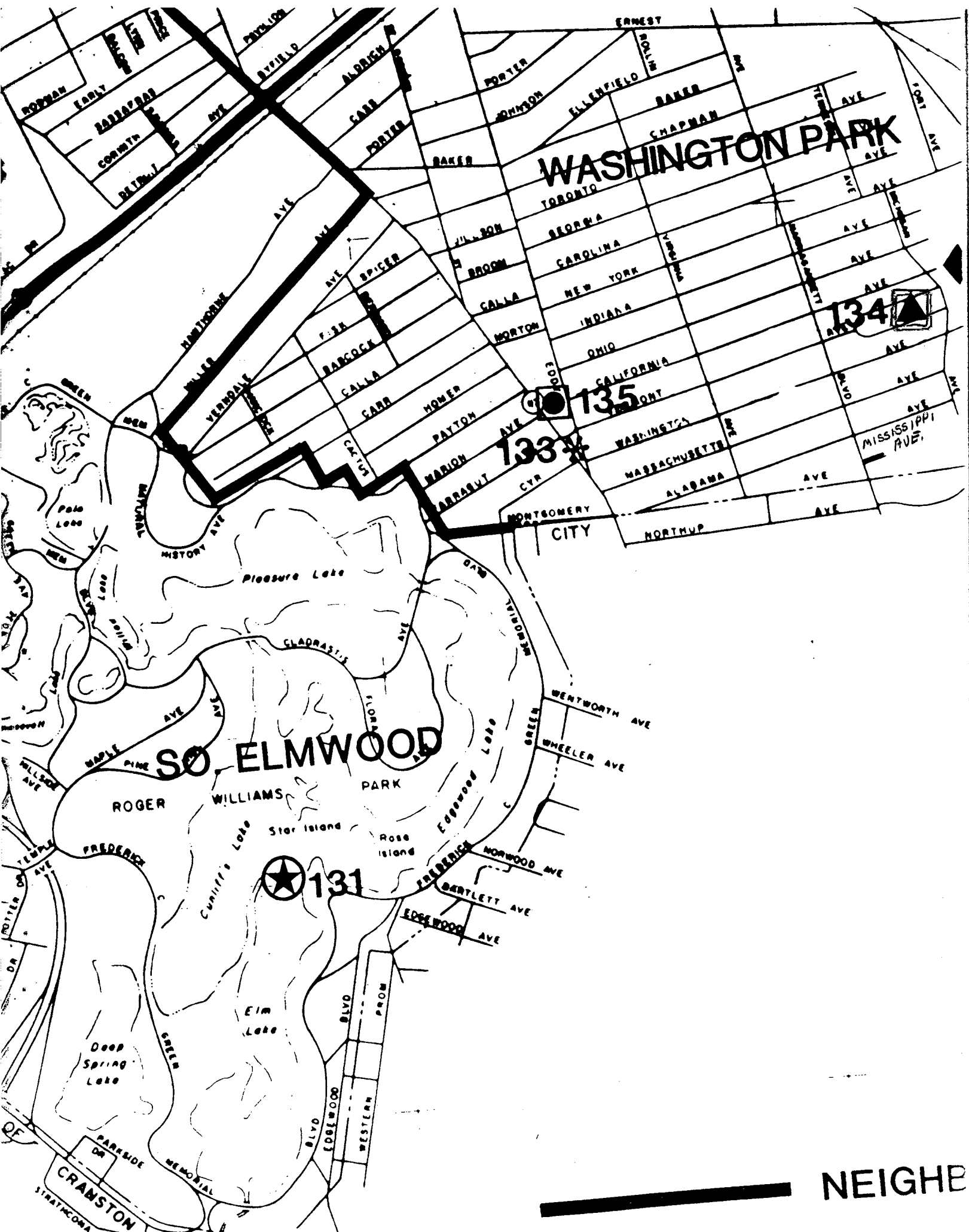

NEIGHB



The City Plan Commission

44 Washington Street

PROVIDENCE, RHODE ISLAND 02903

December 29, 1986

Committee on Public Works
c/o City Clerk
City Hall
Providence, RI 02903

Attention : Rose M. Mendonca, City Clerk

Subject : Referral No. 2201 - Proposed Abandonment of Mississippi Avenue

Gentlemen:

The City Plan Commission at its December 18, 1986 regular monthly meeting reviewed and evaluated the subject referral from your Committee.

The petitioner is Gwen C. Altenbaugh of 1014 Narragansett Boulevard, Providence, Rhode Island, owner of adjacent property described as Assessor's Lot 1061 on Plat 87.

A field inspection revealed that Mississippi Avenue is a dead end street, partially paved (approximately 50 feet from Narragansett Boulevard is paved) and used by the petitioner as a driveway to his/her property. The southern side of a paved portion is used as parking by neighborhood tenants.

The adjacent Lot 1064 is occupied by the Shell Gas Station.

Behind the eastern terminus of Mississippi Avenue there is a steep embankment and the level of terrain drops approximately 40 feet down.

Since the petitioner in his petition to the City Council acknowledged that he contacted all adjacent property owners and no objection was offered to his petition, the Commission voted to advise the Committee on City Property that no objection is offered to this abandonment.

Sincerely yours,

Kathleen D. Field
Associate Director of Planning

KDF:p

cc: Councilman Lloyd T. Griffin, Jr.

FILED

JAN 2 9 57 AM '87

DEPT. OF CLERK
PROVIDENCE, R.I.

Mississippi Avenue

Plot 87

Lot 1061

Gwendolyn C. Altenbaugh
1012-1014 Narragansett Blvd
Providence, R.I. 02905

Lot 1064

John J. Greene, Jr. & Wf. Sara
2626 West Oakland Park Blvd Suite 102
Fort Lauderdale Florida 33311

Ratlins

THE CITY OF PROVIDENCE

CITY SERGEANT'S OFFICE

THIS IS TO CERTIFY, That I have caused the notice, of which a true copy is hereto annexed, to be served upon the following named persons, by handing to each of said persons, or by leaving at their last and usual place of abode in this State a true copy of said notice, to wit: PETITION OF GWEN C. ALTENBAUGH, TO ABANDON MISSISSIPPI AVENUE.

PLAT LOT

87 1061

Gwendolyn C. Altenbaugh
1012-1014 Narragansett Blvd.
Providence, RI 02905

87 1064

John J. Greene, Jr. & Sara
2626 West Oakland Park Blvd. Suite 102
Fort Lauderdale, FLA 33311

mailed

COUNCILMAN JOHN H. ROLLINS
WARD TEN

Ralph P. Guglielmino
CITY SERGEANT

2/10/87
DATE



April 1, 1987

Committee on Public Works
Providence City Council
City Hall
Providence, RI 02901

Attention: Rose Mendonca, City Clerk

Gentlemen:

Re: Highway Abandonments

The Providence Gas Company has gas mains in the following streets and requests easements in these streets to operate, maintain, and replace when required:

✓ Mississippi Avenue
East Drive
Clark Street
Towner Street
Mongenaïs Street

If there are any questions, please contact me. Thank you.

Very truly yours,

PROVIDENCE GAS COMPANY

A handwritten signature in cursive script, appearing to read "Robert C. Barker Jr.".

Robert C. Barker Jr.
Manager of Engineering

RCB/jv

R. . Barker

ProvGas

100 Weybosset Street
Providence, Rhode Island 02903

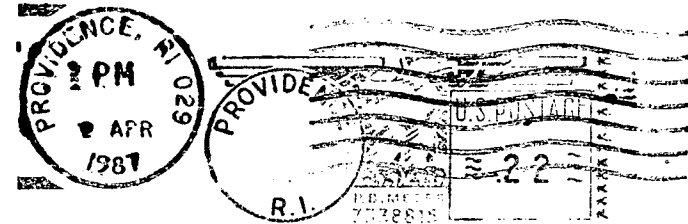

Committee on Public Works
Providence City Council
City Hall
Providence, RI 02901

Attention: Rose Mendonca, City Clerk

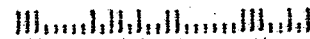

FILED

APR 3 9 35 PM '87

**DEPT. OF CITY CLERK
PROVIDENCE, R.I.**

15

City of Providence



Rhode Island

Department of City Clerk

MEMORANDUM

DATE: July 11, 1989

TO: B. James Suzman, Director of Public Works

SUBJECT: ABANDONMENT - MISSISSIPPI AVENUE.

CONSIDERED BY: Committee on Public Works

DISPOSITION: Attached is a copy of the subject matter, for your study and report back in writing to the above named Committee.

It is also requested that you provide the Committee with a new list of abutting property owners and a tracing of the area, as soon as practical, because the subject matter has been pending since October of 1986.

Michael R. Clement
First Deputy City Clerk

City of Providence



Rhode Island

Department of City Clerk

MEMORANDUM

DATE: July 11, 1989

TO: *

SUBJECT: ABANDONMENT - MISSISSIPPI AVENUE.

CONSIDERED BY: Committee on Public Works

DISPOSITION: Attached are copies of the subject matter for your study and report back in writing, to the above named Committee.

The Committee is requesting an updated report because this subject matter has been pending in Committee since October of 1986.

*B. James Suzman, Traffic
Domenic Mainelli, Chief of Water Supply Board
Charles A. Pisaturo, Commissioner of Public Safety
Thomas Deller, Associate Director of Planning
Nancy L. Derrig, Superintendent of Parks

Michael R. Clement
First Deputy City Clerk

NANCY L. DERRIG
SUPERINTENDENT OF PARKS



JOSEPH R. PAOLINO, JR.
MAYOR

Department of Public Parks

"Building Pride In Providence"

July 28, 1989

Mr. Michael Clement
First Deputy City Clerk
Office of the City Clerk
City Hall
Prov., R.I.

RE: Abandonment of Mississippi Ave.

Dear Mr. Clement:

Upon review of all Department of Public Parks Plans, and records. It is the conclusion of the Parks Department that the abandonment of Mississippi Ave., will in no way effect any Park Department existing facility, and or future plans for that area.

Enclosed is a map indicating the street in question marked in **RED**, and the nearest Park Department facility marked in **GREEN**.

Sincerely yours,

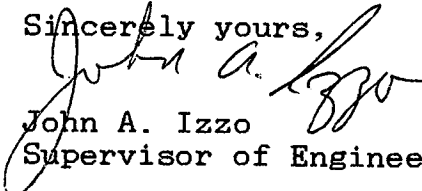
John A. Izzo
Supervisor of Engineering & Planning

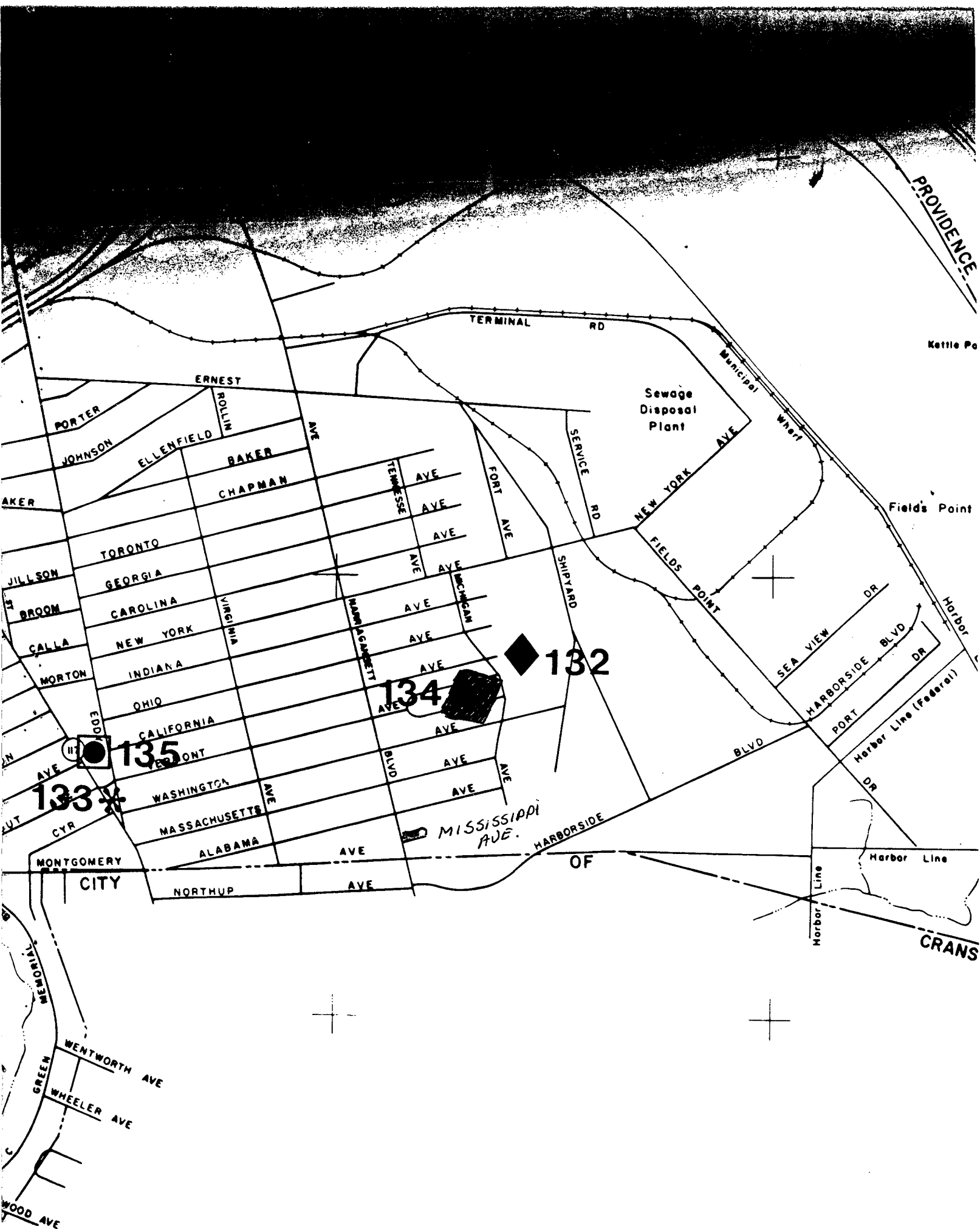

PROVIDENCE

Kettle Po

Sewage Disposal Plant

Fields Point

Harbor

132

134

135

133

MISSISSIPPI AVE.

OF

Harbor Line

CRANS

CITY

NORTHUP

AVE

AVE

ALABAMA

MASSACHUSETTS

WASHINGTON

VERMONT

CALIFORNIA

OHIO

INDIANA

NEW YORK

CAROLINA

GEORGIA

TORONTO

VIRGINIA

CHAPMAN

BAKER

ELLENFIELD

JOHNSON

ERNEST

TERMINAL RD

SERVICE RD

SHIPYARD

NEW YORK AVE

FIELDS POINT

SEA VIEW DR

HARBORSIDE BLVD

PORT DR

Harbor Line (Federal)

Harbor Line

WENTWORTH AVE

WHEELER AVE

WOOD AVE

GEORGE A. CALCAGNI
CHAIRMAN
ARMANDO PARILLO
VICE CHAIRMAN
JAMES A. LOMBARDI
SECRETARY
JOHN E. MARTINELLI
LEGAL ADVISOR
JEROME I. BARON
EX-OFFICIO



JOSEPH R. PAOLINO, JR.
MAYOR
DOMENIC J. MAINELLI, P.E.
CHIEF ENGR./GENERAL MANAGER
RAYMOND COLA
CITY COUNCILMAN
ANDREW J. ANNALDO
CITY COUNCILMAN
MARY A. NOCERA
MEMBER
LOUIS ORABONA
MEMBER

Water Supply Board
"Building Pride In Providence"

July 21, 1989

Councilman James Petrosinelli, Chairman
Committee on Public Works
City Clerk's Office
City Hall
Providence, Rhode Island

Re: Abandonment of Mississippi Avenue

Dear Councilman Petrosinelli:

Reference is made to an application to abandon Mississippi Avenue in the City of Providence under cover of a memorandum dated July 11, 1989.

The Water Supply Board has no facilities in the street under consideration. We have no objection to the abandonment.

Very truly yours,

Hans T. Bergey
Acting General Manager

HTB/mtd

cc: Steven Santaniello
Michael Russo



Water Supply Board
552 Academy Avenue
Providence, Rhode Island 02908-2792

Councilman James Petrosinelli, Chairman
Committee on Public Works
City Clerk's Office
City Hall
Providence, Rhode Island

FILED

JUL 24 1 58 PM '89

DEPT. OF CITY CLERK
PROVIDENCE, R.I.

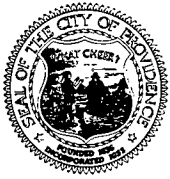

The City Plan Commission

44 WASHINGTON STREET

PROVIDENCE, RHODE ISLAND 02903

August 7, 1989

Committee on Public Works
c/o City Clerk
City Clerk's Office
City Hall
Providence, Rhode Island 02903

Attention: Rose M. Mendonca, City Clerk

Subject: Referral No. 2296 - Proposed Abandonment of Mississippi Avenue

Gentlemen:

The City Plan Commission at its July 18, 1989 regular monthly meeting reviewed and evaluated the subject referral from your Committee.

Since the Commission, at its December 18, 1989 regular monthly meeting, reviewed and evaluated an identical petition, this is the Commission's updated recommendation on the proposed abandonment of Mississippi Avenue from Narragansett Boulevard to its easterly terminus.

The petitioner is Mr. Gwen C. Altenbaugh of 1014 Narragansett Boulevard, Providence, Rhode Island, owner of adjacent property described as Assessor's Lot 1061 on Plat 87.

A field inspection revealed that Mississippi Avenue is a dead end street, partially paved (approximately 50 feet from Narragansett Boulevard is paved) and used by the petitioner as a driveway to his property. The southern side of a paved portion is used as parking by neighborhood tenants.

The adjacent lot 1064 is occupied by the Shell Gas Station.

Behind the eastern terminus of Mississippi Avenue there is a steep embankment and the level of terrain drops approximately 40 feet down.

Committee on Public Works
August 7, 1989
Page 2

REFERRAL NO. 2296

Since the petitioner in his petition to the City Council acknowledged that he contacted all adjacent property owners and no objection was offered to his petition, the Commission voted to advise the Committee on Public Works that no objection is offered to this abandonment.

Sincerely yours,

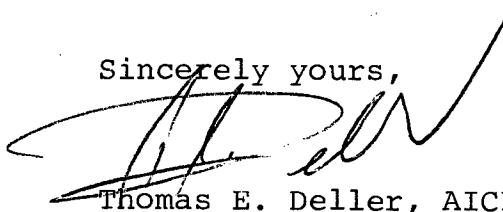
A handwritten signature in dark ink, appearing to read 'T. E. Deller', is written over the typed name.

Thomas E. Deller, AICP
Associate Director of Planning

TED/jp

cc: Councilman John H. Rollins
Thomas V. Moses, Esq.

CITY PLAN COMMISSION PROVIDENCE, R.I.

Ref. No. 2201 Subject: Abandonment of Mississippi Avenue
 Plat No. 87 Lot No. —
 Lot Area: 128' X 50'

LAND USE LEGEND

- 00 Vac. Land
- 10 One Fam.
- 11 One Fam. & Nonres.
- 12 One Fam. & Home Occ.
- 13 One Fam. & Prof. Off.
- 15 Auxiliary to Res.
- 20 Two Fam.
- 21 Two Fam. & Nonres.
- 22 Two Fam. & Home Occ.
- 23 Two Fam. & Prof. Off.
- 25 Two Fam. & One Fam.
- 30 Three Fam.
- 31 Three Fam. & Nonres.
- 32 Three Fam. & Home Occ.
- 33 Three Fam. & Prof. Off.
- 35 Three Fam. & One Fam.
- 36 Three Fam. & Two Fam.
- 40 Apt. 4 Fam. or More
- 41 Apt. & Nonres.
- 42 Apt. & Home Occ.
- 43 Apt. & Prof. Off.
- 45 Apt. & One Fam.
- 46 Apt. & Two Fam.
- 47 Apt. & Three Fam.
- 48 Lodging House
- 49 Fraternity
- 51 Limited Comm.
- 52 Parking Lot
- 53 Gen. Comm.
- 54 Nonstruct. Gen. Comm.
- 55 Parking Gar.
- 56 Heavy Comm.
- 57 Nonstruct. Heavy Comm.
- 58 Auto. Service Sta.
- 59 Stor. Gar. for Comm. Veh.
- 64 Gen. Ind.
- 65 Nonstruct. Gen. Ind.
- 67 Heavy Ind.
- 68 Nonstruct. Heavy Ind.
- 71 Utility
- 75 Railroad
- 81 Instit. (not elsewhere class.)
- 82 Parochial School
- 93 Church
- 94 Private School or Coll.
- 95 Cemetery
- 91 Park, Golf Course
- 92 Playground & Playfield
- 95 Public Bldg. (exc. schools)
- 95 Public School (E.S., J.H., H.S.)



AREA IN QUESTION

Date: 10/27/86 By: GT Scale: —

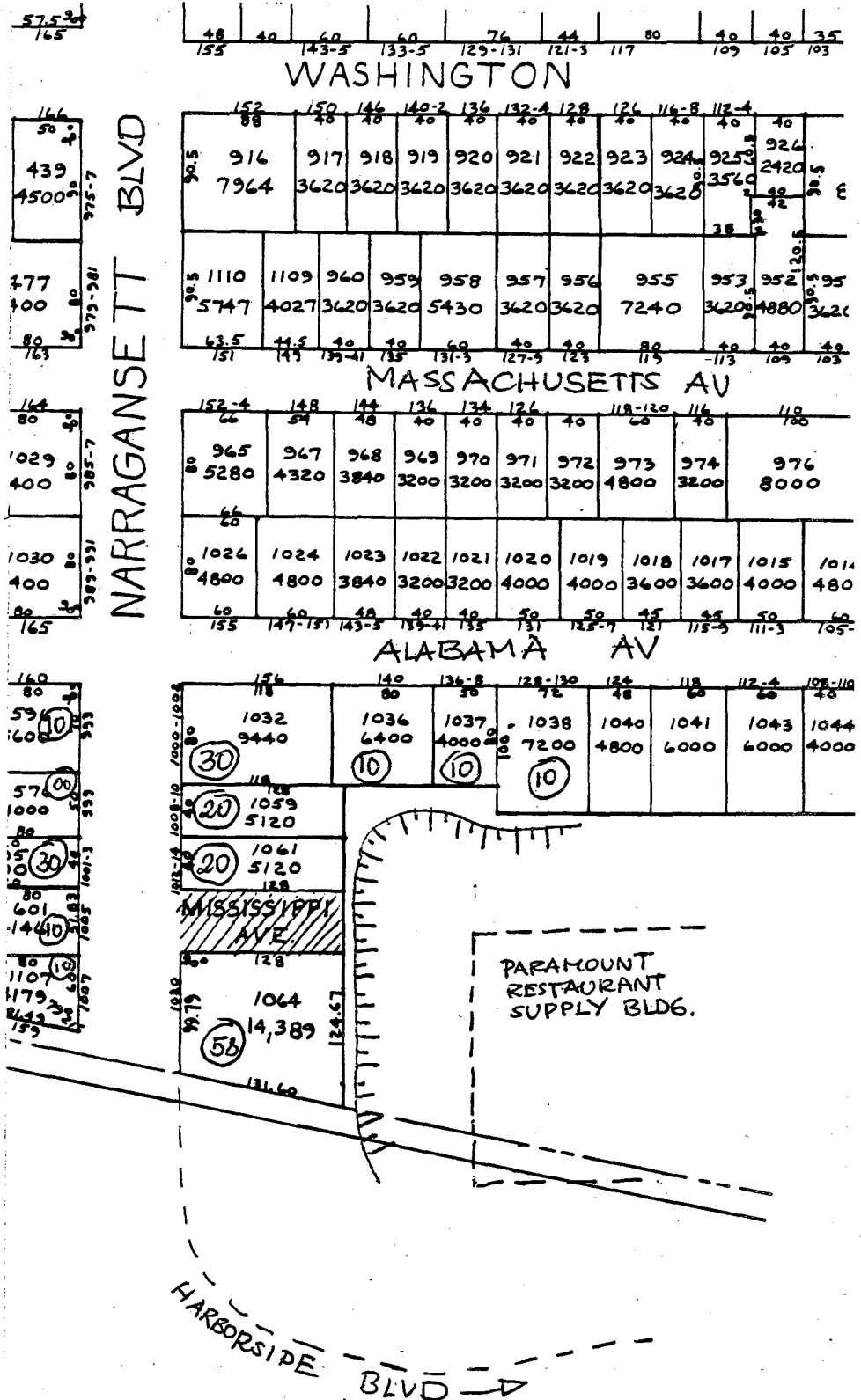

To Whom it may Concern,

I am requesting the abatement of
Mississippi Ave. Should the decision be in my
favor I would give the Providence Gas
Company easement rights if and when necessary.

Thank-you,
Owner, occupant of 1014 Narragansett
Blvd.

Allen C Altenbaugh
9-19-89



DEPARTMENT OF CITY CLERK
CITY HALL, PROVIDENCE, R. I. 02903

ROSE M. MENDONCA, CITY CLERK

RETURN
TO
SENDER
ADDRESSEE UNKNOWN
FT. LAUDERDALE, FL 33311

REGISTERED
MAIL

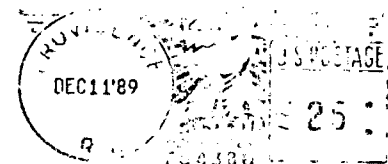

Mr. and Mrs. John J. Greene Jr.

2626 West Oakland Park Blvd. Suite 102

GREENES 333115109 IN 12/14/89

For

RETURN TO SENDER
NO FORWARD ORDER ON FILE
UNABLE TO FORWARD
RETURN TO SENDER

RESOLUTION OF THE CITY COUNCIL

No. 563

Approved November 28, 1989

RESOLVED, DECREED AND ORDERED

That the following named street shown as cross-hatched area on the accompanying plan entitled, "Providence, Rhode Island, Department of Public Works - Engineering Office, Street Line Section Plan No. 064363, dated November 3, 1986",

VIZ:

Mississippi Avenue, shown as cross-hatched area on the accompanying plan and designated by the letters (A-B-C-D-A), having ceased to be useful to the public and the same is proposed to be abandoned as a Public Highway, provided that an easement shall be granted to the Providence Gas Company for their existing gas mains to operate, maintain, and replace when required, and the damage to the abutters is appraised at nothing and so awarded, and it is further,

ORDERED, That the Traffic Engineer, be and he is hereby directed to cause a sign to be placed on the above-named highway abandoned as aforesaid, having thereon the words, "Not a Public Highway", and it is further

ORDERED, That after the entry of this order or decree, the City Clerk shall cause a notice, thereof, to be published in a newspaper published in the County of Providence at least once a week for three successive weeks, and a further and personal notice shall be served by the City Sergeant upon every owner of land abutting the above-named highway which has been abandoned, who is known to reside within the State.

A true copy,
Attest:

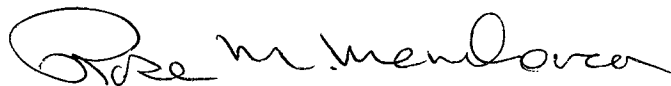

Rose M. Mendonca
City Clerk

N

PROVIDENCE R. I.
P. W. DEPT. - ENGINEERING OFFICE
STREET USE SECTION
Plan No. 064363
Date November 3, 1986

Narragansett Blvd.

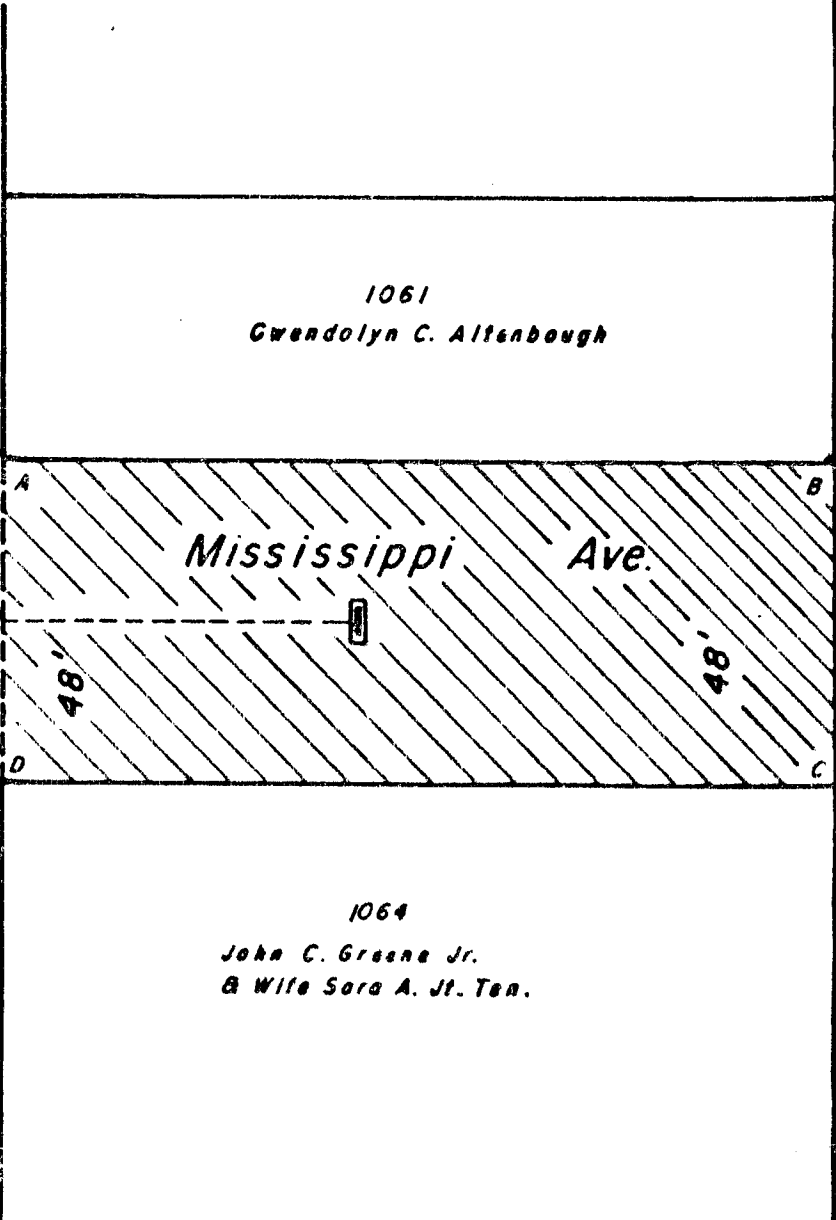

Notes:

Cross-Hatched Area (A-B-C-D-A)
Indicates Proposed Abandonment.

Drainage Structure in Mississippi
Ave. will Become Private.

City will Have no Responsibility
For Said Drainage Structure.

City Not to be Responsible For Remaining
Sewer Connection in Narra. Blvd.

Lot Numbers From Assessor's Plat 87

CITY OF PROVIDENCE R. I.
Public Works Dept. - Engineering, Street
Showing Proposed Abandonment
Drawn by J.A.M. Checked by R.J.D.
Scale 1" = 30' Date 11-3-86
Carred by J. J. [Signature] Approved by [Signature]
Approved [Signature]

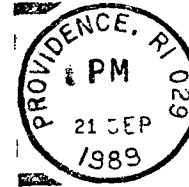

Providence City Hall
Prov RI 02903

ATTN Mike Clemmens

SEP 22 1989

SEP 22 9 20 AM '89

DEPT. OF CITY CLERK
PROVIDENCE, R.I.



PROVIDENCE R. I.
P. W. DEPT. - ENGINEERING OFFICE
STREET LANE SECTION
Plan No. 064363
Date November 3, 1986

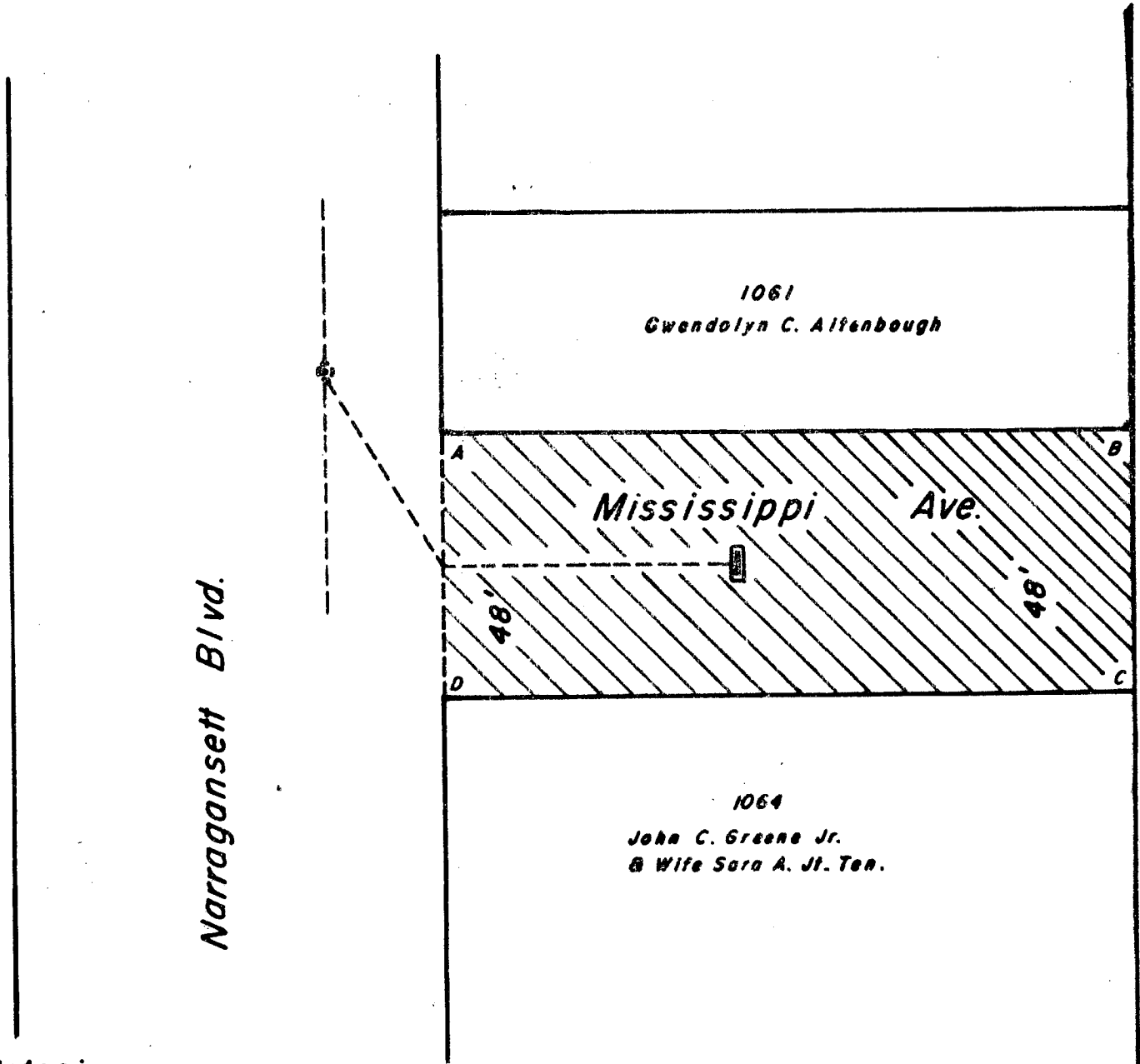

Notes:

- Cross-Hatched Area (A-B-C-D-A) Indicates Proposed Abandonment.
- Drainage Structure in Mississippi Ave. will Become Private.
- City will Have no Responsibility For Said Drainage Structure.
- City Not to be Responsible For Remaining Sewer Connection in Narra. Blvd.

Lot Numbers From Assessor's Plat 87

CITY OF PROVIDENCE R. I.
Public Works Dept. - Engineering Office
Showing Proposed Abandonment
Drawn by J.A.M. Checked by R.J.R.
Scale 1" = 30' Date 11-3-86
Corrected [Signature] Assistant Eng.
Approved [Signature] P.W. DEPT. - ENGR.