

# RESOLUTION OF THE CITY COUNCIL

No. 207

Approved May 25, 2016

RESOLVED, That His Honor, the Mayor, is hereby authorized to  
apply for a grant from the Rhode Island Department of Environmental  
Management in the amount of \$80,000.00 to construct walking paths at the  
Alvarez High School/Textron site in the City of Providence.

IN CITY COUNCIL

MAY 19 2016

READ AND PASSED

FRES.

CLERK

I HEREBY APPROVE

Mayor

Date:

5/25/16



# Lincoln lace Park

Providence, RI

Adventure Park Draft Master Plan

MASTERS OF THE LAND  
Landscape Architecture  
100 North Main Street, Suite 200  
Providence, RI 02903  
Phone: 401.455.1234  
www.mastersoftheland.com

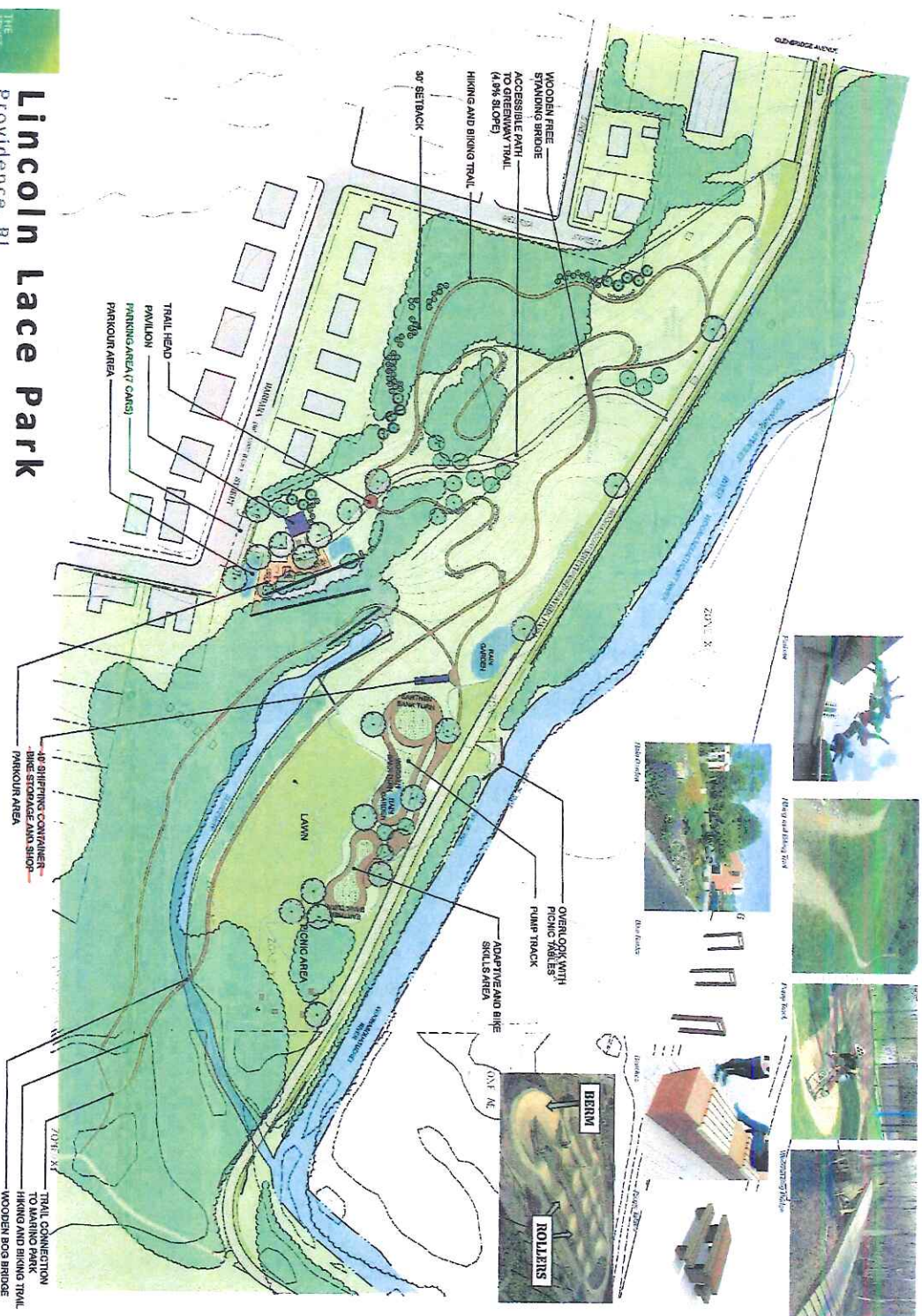



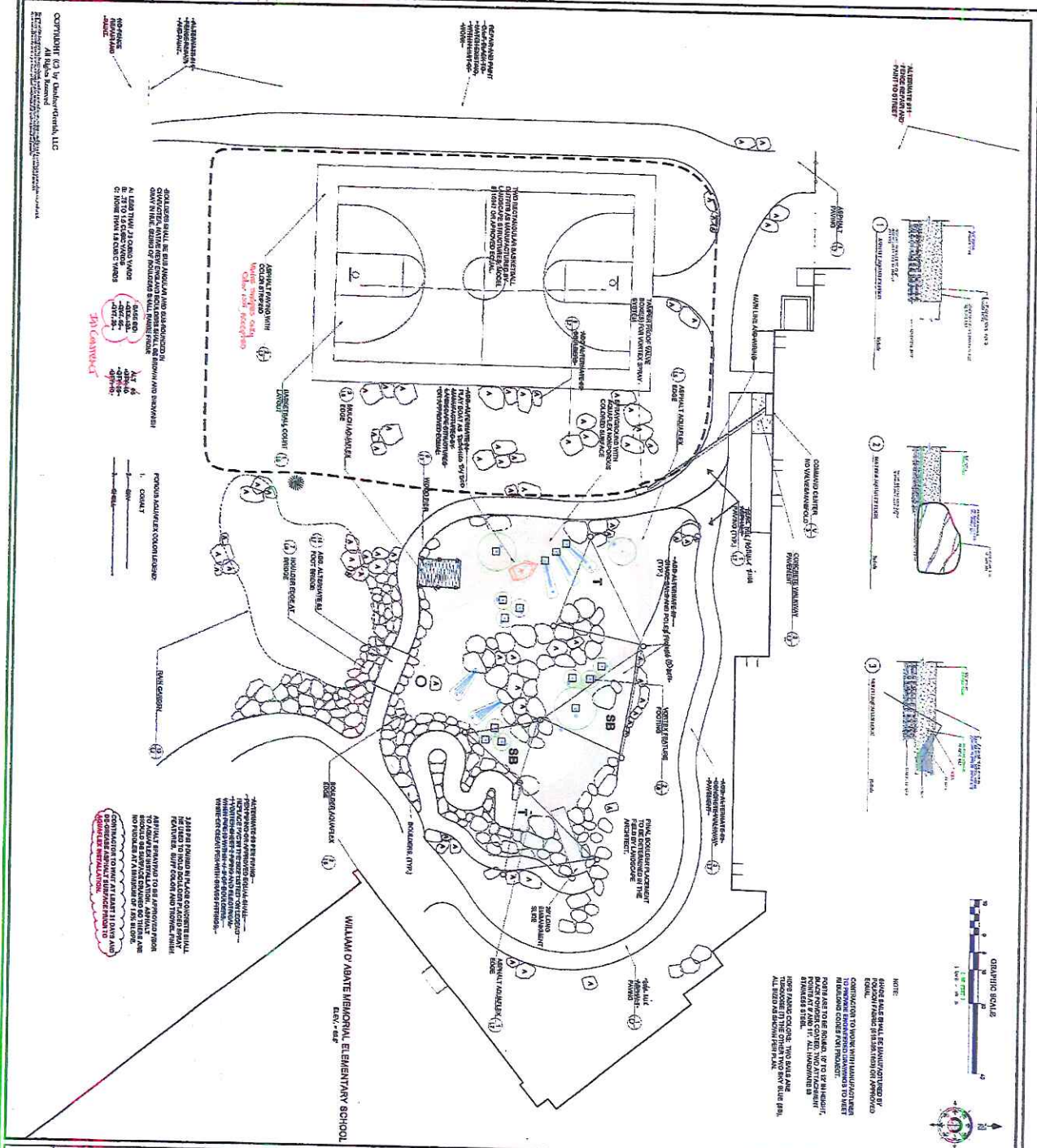

## Joslin Park Spray Ground

Providence, Rhode Island

### Materials Plan

DESIGNED BY: **PHG SCALE**

DRAWN BY: **PHG**

CHECKED BY: **PHG**

DATE: **09-08-15**

**L5**

**GARNER**

LANDSCAPE ARCHITECTS, LLC



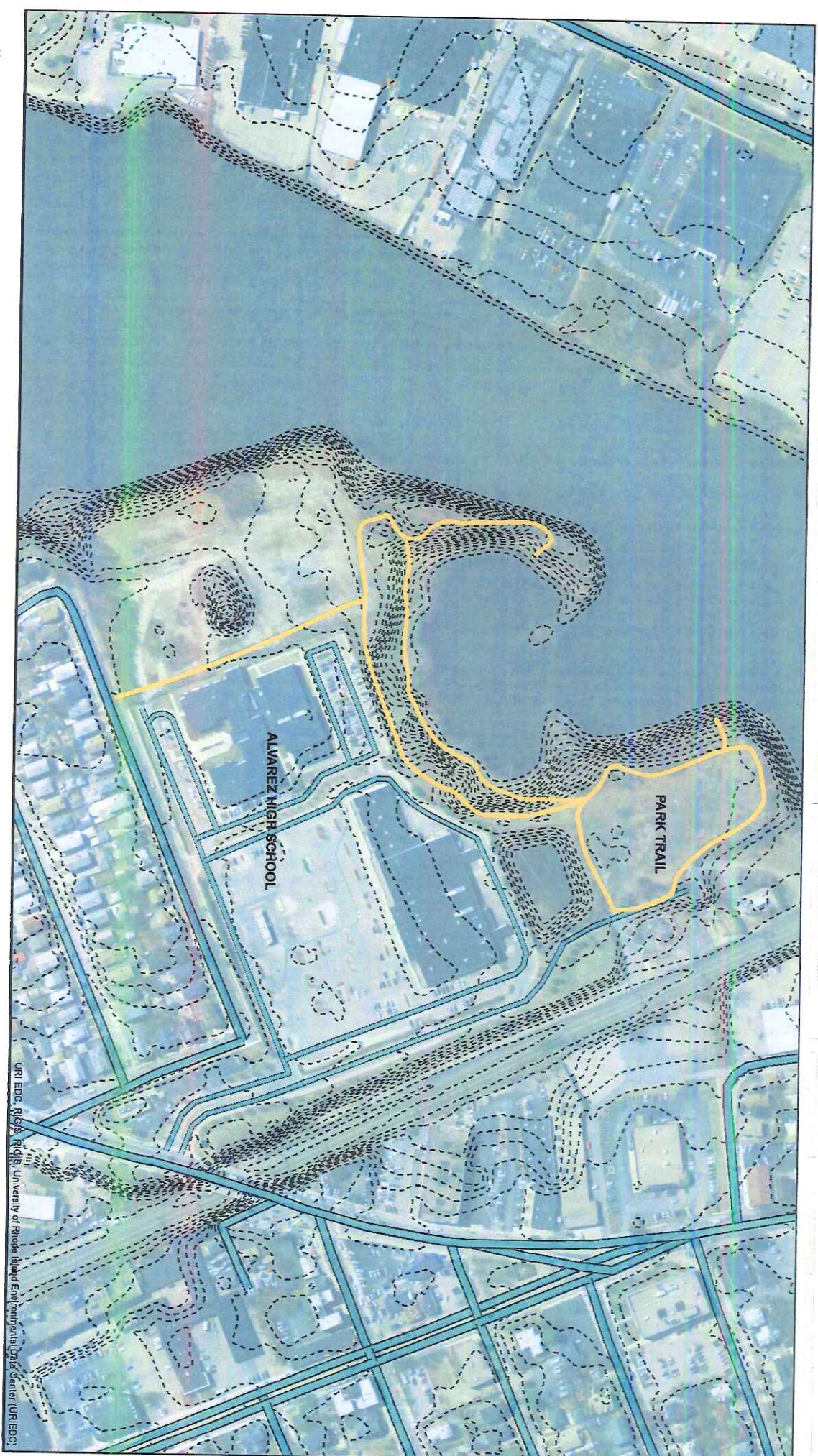

# PARKS DEPARTMENT PRELIMINARY TRAIL CONCEPT



1 inch = 258 feet

PREPARED BY PROV PARK DEPT.