



D. Everett Whelan
City Clerk

125
CITY OF PROVIDENCE • RHODE ISLAND • Walter H. Reynolds • Mayor

OFFICE OF THE CITY CLERK

CITY HALL

February 10, 1958

Vincent Vespia
First Deputy
William E. McWilliams
Second Deputy

Mr. D. Everett Whelan
City Clerk
City Hall
Providence, Rhode Island

Dear Sir:

In accordance with the provisions of City Council Resolution No. 79, approved February 7, 1958, I hereby make the following appointments to the Special Committee on Municipal Celebration of July 4, 1958:

Councilman Jacob J. Alprin
Councilman Jerry Lorenzo
Councilman John A. Powers, Jr.
Councilman Thomas L. Payne
Councilman David Yanover.

Very truly yours,

Angelo Aiello
President, City Council

AA:1am

IN CITY COUNCIL

FEB 20 1958

READ:
WHEREUPON IT IS ORDERED THAT
THE SAME BE RECEIVED.

CLERK



CITY OF PROVIDENCE • RHODE ISLAND • Walter H. Reynolds • Mayor

TRAFFIC ENGINEERING DEPARTMENT

ROGER T. CHANDLER

Traffic Engineer

EDWIN F. COLBY

Assistant Traffic Engineer

147 Fountain Street

Providence 3, R. I.

February 14, 1958

The Honorable City Council
City Hall
Providence, Rhode Island

Gentlemen:

In response to City Council Resolution #601, the Traffic Engineering Department has written the enclosed regulation for Gray Street.

Very truly yours,

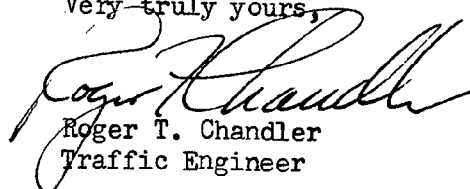

Roger T. Chandler
Traffic Engineer

JIL/bt

Enclosure

IN CITY COUNCIL

FEB 20 1958

READ:

WHEREUPON IT IS ORDERED THAT
THE SAME BE RECEIVED.

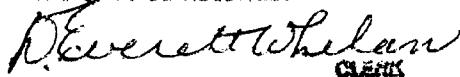

Everett Whelan
CLERK



CITY OF PROVIDENCE • RHODE ISLAND • Walter H. Reynolds • Mayor

TRAFFIC ENGINEERING DEPARTMENT

ROGER T. CHANDLER
Traffic Engineer
EDWIN F. COLBY
Assistant Traffic Engineer

147 Fountain Street
Providence 3, R. I.

TR-WO-2111
2/11/58

Commissioner John B. Dunn
Department of Public Safety
Police Headquarters
La Salle Square
Providence, Rhode Island

SUBJECT: Parking Restriction - Gray Street

Dear Commissioner Dunn:

Because of the very narrow section of street having poor alignment, it is felt that traffic flow will be materially aided by the prohibition of parking on one side. Therefore, NO PARKING ANYTIME is hereby established on the west side of Gray Street, between Chalkstone Avenue and Fowler Street.

Very truly yours,

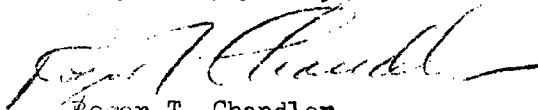
Roger T. Chandler
Traffic Engineer

JIL/bt

Copies: Distribution List A
City Council

TO THE HONORABLE THE CITY COUNCIL OF THE CITY OF PROVIDENCE:

At a meeting of the School Committee held on February 17, 1958,
the following resolution was adopted:

Resolution No. 333

RESOLUTION requesting bond issue.

RESOLVED, That the City Council be and hereby is requested to obtain
legislative authorization, if necessary, and to submit to the voters
at the next general election, a proposal authorizing a bond issue in
the amount of \$1,000,000.00 for Classical High School.

Respectfully submitted,

James H. Foley
Secretary, Providence School Committee

IN CITY COUNCIL
FEB 20 1958

READ:
WHEREUPON IT IS ORDERED THAT
THE SAME BE RECEIVED.

Robert Whelan
Clerk

TO THE HONORABLE THE CITY COUNCIL OF THE CITY OF PROVIDENCE:

At a meeting of the School Committee of the City of Providence, held February 10, 1958, the following resolution was adopted:

Resolution 342.

RESOLVED, That Plot Plan No. 4021, which delineates the separation of the school grounds adjacent to the new South Providence Elementary School from the area controlled by the Recreation Department of the City of Providence, said plan indicating a four-foot chain link fence as the physical separating medium for the two areas concerned, be and hereby is approved.

Motion made and passed to include pedestrian gate only, from parking lot to Gay Street.

Respectfully submitted,

James H. Foley
Secretary School Committee

IN CITY COUNCIL

FEB 20 1958

READ:

WHEREUPON IT IS ORDERED THAT
THE SAME BE RECEIVED.

R. Everett Wheeler
Clerk

500 1000

FEB 13 11 25 AM '58

CITY CLERK'S OFFICE
PROVIDENCE, R.I.

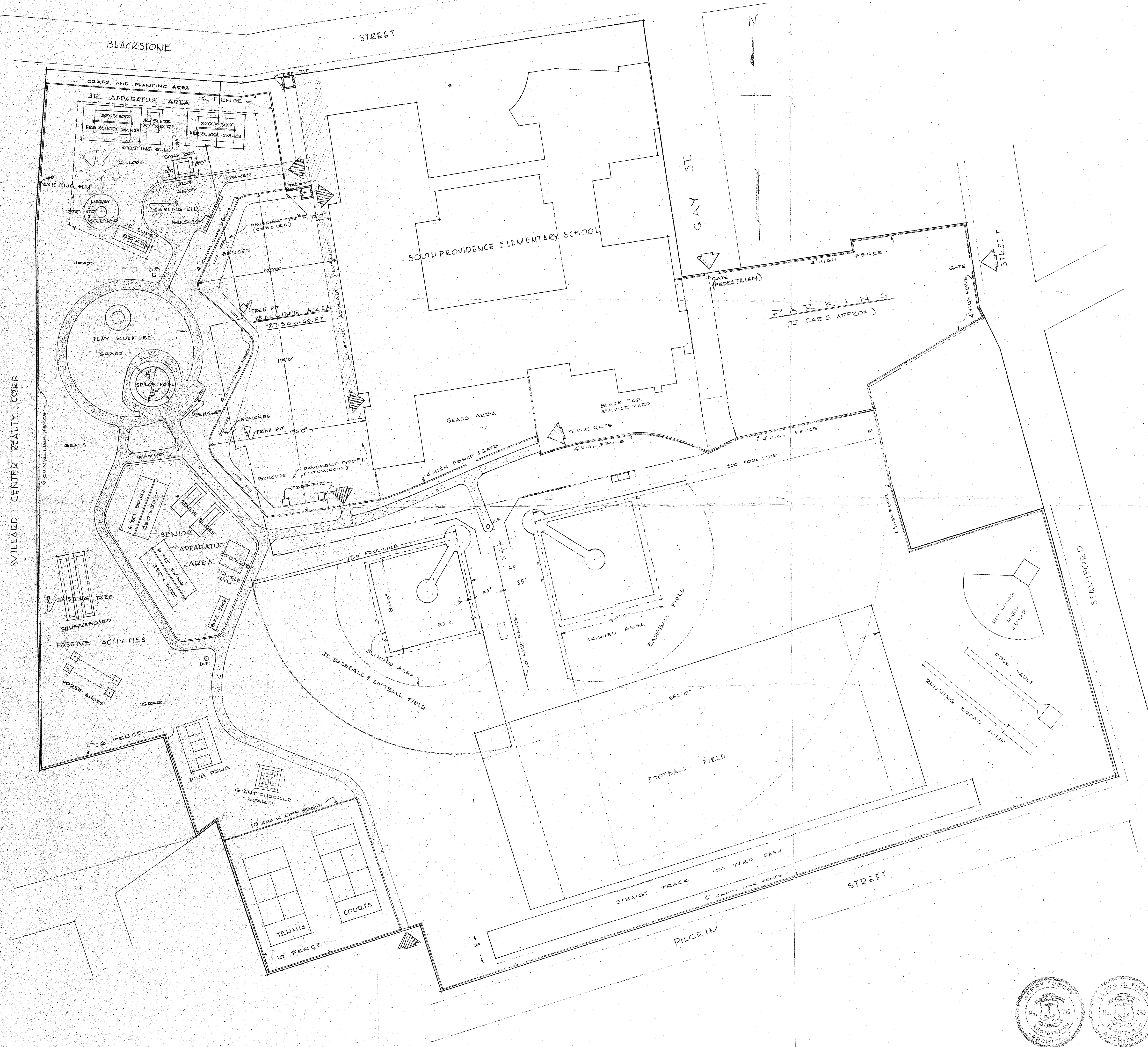

SOUTH PROVIDENCE PLAYFIELD
CITY OF PROVIDENCE
RHODE ISLAND
RECREATION DEPARTMENT

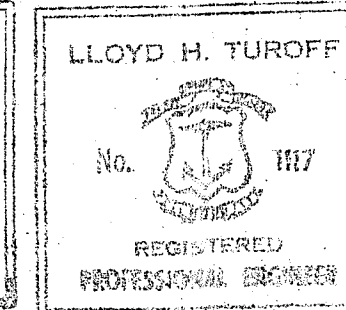
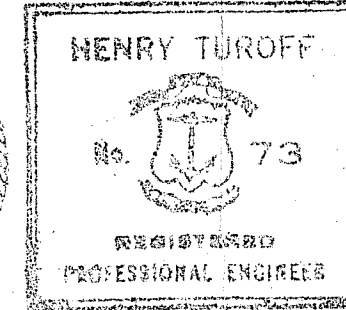
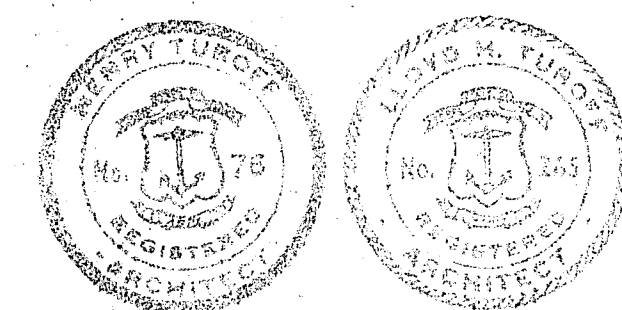

GENERAL PLAYFIELD LAYOUT		PROJ. NO.
DATE: JAN. 1953	REVISIONS:	4021
DRAWN BY: L.T.		DWG. NO.
CHECKED BY: L.T.		
DESIGNED BY: L.T.		
APPROVED BY: L.T.		
SIGNED: HENRY T. TURROFF		
REGISTERED PROFESSIONAL ENGINEER		
PROVIDENCE, R. I.		



Peter J. Hicks, Jr.
Public Service Engineer

129
CITY OF PROVIDENCE • RHODE ISLAND • Walter H. Reynolds • Mayor

Office of the Public Service Engineer

112 Union St. Providence 3, R. I.

February 6, 1958

Mr. D. Everett Whelan
City Clerk
City Hall
Providence, R. I.

Dear Mr. Whelan:

I enclose herewith the bill of the Narragansett Electric Company for the Street Lighting of the City of Providence for the month of January, 1958.

The total net amount of the bill is \$41,451.19.

Yours very truly,



PETER J. HICKS, JR./
PUBLIC SERVICE ENGINEER

PJH, JR/pc
Enclosure

IN CITY COUNCIL

FEB 20 1958

APPROVED:

D. Everett Whelan
Clerk

Sent to City Controller 2/21/57