

THE CITY OF PROVIDENCE  
STATE OF RHODE ISLAND AND PROVIDENCE PLANTATIONS

# RESOLUTION OF THE CITY COUNCIL

No. 635

Approved October 27, 1978

RESOLVED, That His Honor the Mayor be and he is hereby authorized to execute a Deed of Conveyance to Daniel P. DeCesare, D.D.S., for a tract of land being a portion of Lot 566, as set out and delineated on City Assessor's Plat 14, containing approximately 9,193 square feet of land, more or less, situated along Gano Street, in the City of Providence, for the sum of Ten Thousand Five Hundred (\$10,500.00) Dollars.

IN CITY COUNCIL  
OCT 11 9 1978

READ AND PASSED

*Ralph Tignol* PRES.

*Rose M. Mendonca* CLERK

APPROVED

MAYOR

*Christopher A. Cronin, Jr.*

OCT 27 1978

THE COMMITTEE ON  
CITY PROPERTY

Approves Passage of  
The Within Resolution

*Jose M. Mendonca*  
*Chairman*  
October 10, 1975

CC 1 S 100

PAUL L. SEGAL, D.D.S.  
DANIEL P. DECESARE, D.D.S.  
GEORGE W. PIRIE, D.M.D.  
July 27, 1978

Councilman Johnson  
Chairman of the Committee on  
City Property  
Department of City Clerk  
City Hall  
Providence, RI

ATTENTION: Rose M. Mendonca

Dear Mrs. Mendonca,

In response to your letter regarding the portion of lot 566, City Assessor's Plat 14, located along Gano Street, I am definitely interested in purchasing this lot.

As I have corresponded with your office before, my interest in this lot concerns cleaning it up, landscaping it, and beautifying it. This lot has been used as a dump for many years and, at this time, is very filthy and rat infested. It has been a constant source of problems to our new office, as the rats migrate around our parking lot and doorways, are a constant menace to the children in our neighborhood and our patients. I feel that if we could purchase the lot and clean it up, it will not only enhance our new building, but also enhance the neighborhood.

I would like to offer the City of Providence the sum of \$10,500 for this land. I would like to purchase it and work on it as soon as the committee can act on my proposal.

Very truly yours,



Daniel P. DeCesare, D.D.S.

DPDC/cams

DRS. PAUL L. SEGAL AND DANIEL P. DECESARE, INC.  
167 GANO STREET, PROVIDENCE, RHODE ISLAND 02906 PHONE: 401-274-2600  
PRACTICE LIMITED TO PERIODONTICS

PAUL L. SEGAL, D.D.S.  
DANIEL P. DECESARE, D.D.S.  
GEORGE W. PIRIE, D.M.D.

March 9, 1978

Rose M. Mendonca  
City Clerk of Providence  
City Hall  
Providence, R. I.

Dear Ms. Mendonca

Enclosed is a copy of the map for Plat #14 showing our property and the property we wish to purchase. We own lots #245, 246, 247 and would like to purchase the land adjacent to it, on the north side, which is the "pie" shaped piece of Engineer's Field outlined in red.

There is no specific lot number for this piece of land except for that number which designates Engineer's Field (#566).

We would appreciate your prompt action regarding this land, The land is still infested with rats and is being used as a dumping ground for all sorts of debris.

Yours truly

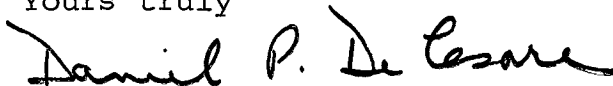

Daniel P. DeCesare D.D.S.

FILED

MAR 10 9 23 AM '78

DEPT. OF CITY CLERK  
PROVIDENCE, R.I.

THE COMMITTEE ON  
CITY PROPERTY

Recommends

*Approval*  
Rose M. Mendonca

Clerk

*Oct 10, 1975*

THE COMMITTEE ON  
CITY PROPERTY

Recommends

*Referral for survey*  
Rose M. Mendonca

Clerk

*March 20, 1975*

PROVIDENCE, R. I.  
 P. U. DEPT. - ENGINEERING  
 CITY PROPERTY SECTION  
 No. 064050  
 APRIL 25, 1978

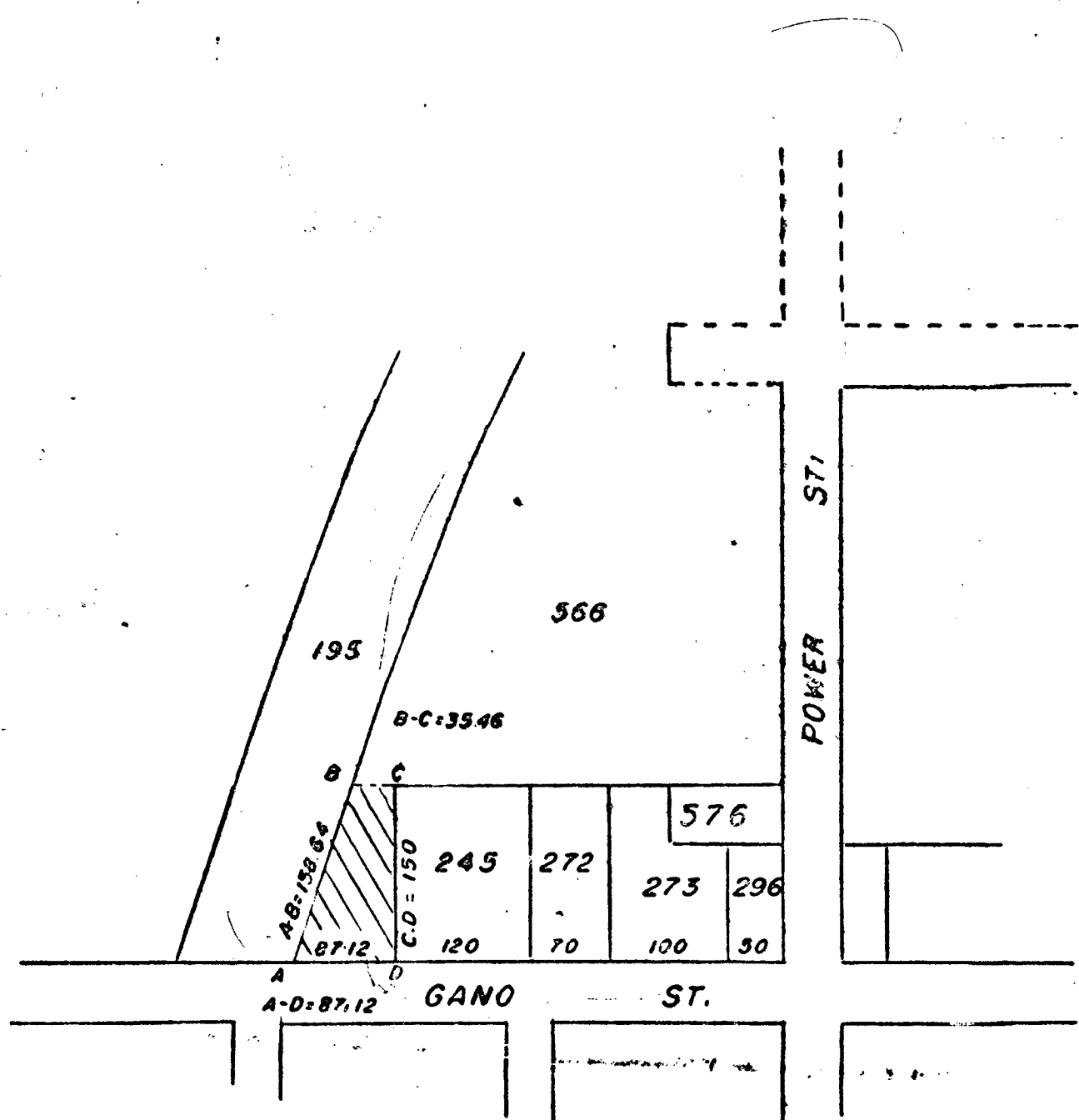
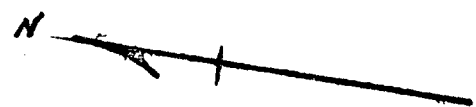

Cross hatched area  
 A-B-C-D-A Contains 9193.50 Sq. Ft.  
 Lot Numbers From Assr's Plat 14

CITY OF PROVIDENCE, R. I.  
 Public Works Dept. Engineering Office  
 Showing Proposed Sale  
 Drawn by \_\_\_\_\_ Checked by JHR  
 Sealed NOT TO SCALE Date \_\_\_\_\_  
 Certified [Signature] Approved [Signature]  
 Approved [Signature]

October 31, 1978

Daniel P. DeCesare D.D.S.  
167 Gano Street  
Providence, RI 02906

Dear Dr. DeCesare,

Enclosed is Resolution No. 635 approved October 27, 1978  
executing a deed of conveyance to Daniel P. DeCesare, D.D.S.  
for a tract of land being a portion of Lot 566 on City Assessor's  
Plat 14.

The City Solicitor's Department will contact you relative  
to execution the deed of conveyance.

Very truly yours,

Rose M. Mendonca,  
City Clerk.

RMM/jma