

THE CITY OF PROVIDENCE
STATE OF RHODE ISLAND AND PROVIDENCE PLANTATIONS

RESOLUTION OF THE CITY COUNCIL

No. 423

Approved September 11, 1973

Resolved, that the Director of the Department of Public Works is authorized to condemn for highway purposes, that portion of Benedict Street, from the State Service Road to a point near Sorrento Street, and also portions of Lots 50 and 431, on City Assessors' Plat 42; all in accordance with accompanying Plan Number 063791 dated September 5, 1973.

IN CITY COUNCIL
READ AND PASSED
Robert J. Harte
Clerk
Robert J. Harte

SEP 6 1973

APPROVED
MAYOR
Joseph A. Pawley
SEP 11 1973

Council President Hapton
and Councilman Rogers, by request

READ AND PASSED
IN CITY COUNCIL
AT THE

PROVIDENCE, R. I.
P. W. DEPT. - ENGINEERING OFFICE
CITY PROPERTY SECTION
Plan No. 063791
Date September 5, 1973

Date September 5, 1973

Note: *Cross-Hatched Area Indicates Land To Be Condemned*

CITY OF PROVIDENCE, R. I.
Public Works Dept. - Engineering Office
Showing Cross-Hatched Area Indicates
Land To Be Condemned
Drawn by J. Dennis. Checked by A. P.
Scale 1" = 40' Date Sept. 5, 1973
Corrected by J. Dennis Associate Engr.
Approved *[Signature]* CHIEF ENGINEER

Lot Numbers From Assessor's Plat 42

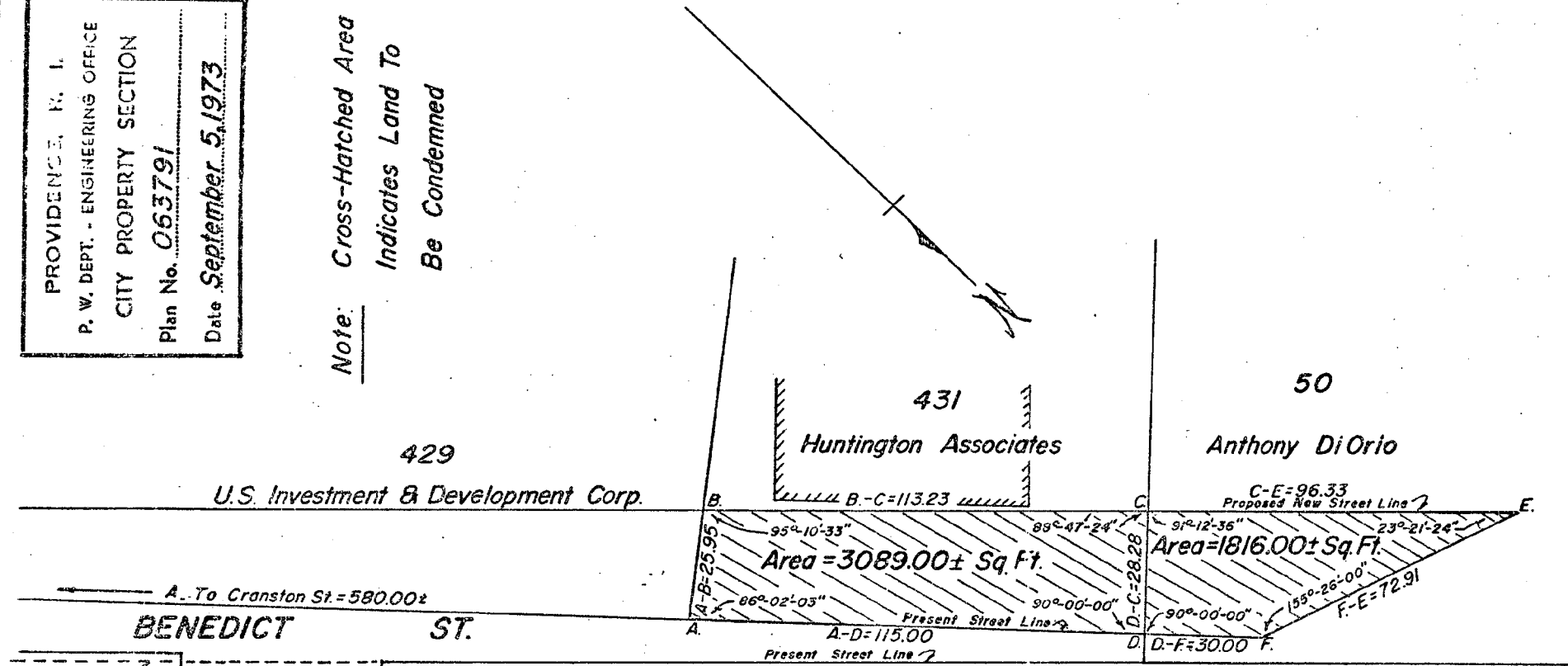

STATEMENT
PLAT OF LAND CONDEMNED

PURSUANT TO THE PROVISIONS OF CHAPTER 2118 OF THE PUBLIC LAWS
ENTITLED "AN ACT RELATING TO THE TAKING OF LAND IN THE CITIES
OF PROVIDENCE AND PAWTUCKET FOR HIGHWAY PURPOSES," PASSED BY
THE GENERAL ASSEMBLY AT ITS JANUARY SESSION A. D. 1921 AND BY AND
IN ACCORDANCE WITH THE RESOLUTION OF THE CITY COUNCIL OF
THE CITY OF PROVIDENCE NUMBERED.....APPROVED.....
CONDEMNING CERTAIN LAND FOR HIGHWAY PURPOSES

MAYOR OF THE CITY OF PROVIDENCE