

THE CITY OF PROVIDENCE
STATE OF RHODE ISLAND AND PROVIDENCE PLANTATIONS

RESOLUTION OF THE CITY COUNCIL

No. 561

Approved September 25, 1981

RESOLVED, That His Honor the Mayor is hereby authorized to execute a Deed of Conveyance to Andrew J. Patrick, Jr., of 37 Potters Avenue, Providence, Rhode Island, of that certain lot or parcel of land comprising of approximately Five Thousand, Five Hundred Thirty-Five (5,535) square feet of land, more or less, situated on Lot 390, as set out and delineated on City Assessor's Plat 46, located along 35 Potters Avenue, for the sum of One Thousand, One Hundred and Seven Dollars (\$1,107.00).

IN CITY COUNCIL

SEP 17 1981
READ AND PASSED

Ralph Laing

Rose M. Menelander CLERK

APPROVED
Vincent A. Cianci

SEP 25 1981

THE COMMITTEE ON

CITY PROPERTY

Approves Passage of
The Within Resolution

Rose M. Mendelsohn
Clerk Chairman
September 9, 1951

PROVIDENCE R. I.
 P. W. DEPT. - ENGINEERING OFFICE
 CITY PROPERTY SECTION
 Plan No. *064096*
 Date *September 19, 1979*

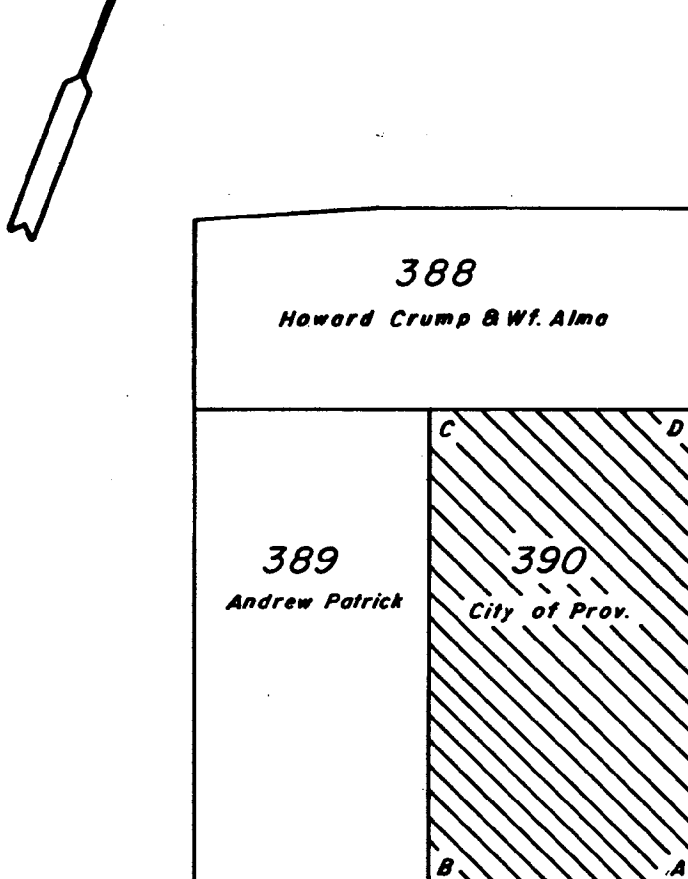
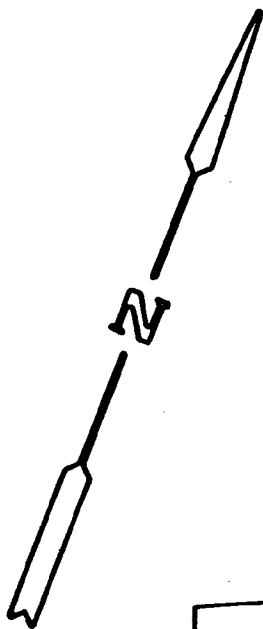

ST.

TEMPLE

POTTERS

AVE.

Note:

**Cross-Hatched Area (A-B-C-D-A)
 Indicates Proposed Sale.**

Said Lot Contains 5,535 Sq. Ft.

CITY OF PROVIDENCE R. I.
 Public Works Dept. Engineering Office
 Showing Proposed Sale
 Drawn by J. A. M. Checked by A. J. P.
 Scale 1" = 40' Date 9-19-79
 Correct [Signature] Associate Engr.
 Approved [Signature] CHIEF ENGINEER

Lot Numbers From Assessor's Plat 46

768
J-91

October 2, 1981

Mr. Andrew J. Patrick, Jr.
37 Potters Avenue
Providence, RI 02905

Dear Mr. Patrick,

Enclosed is certified copy of Resolution No. 561,
approved September 25, 1981, the same being self explan-
atory.

Will you kindly communicate with the City Solicitor's
Office so that the deed of conveyance for said land will be
executed.

Very truly yours,

Rose M. Mendonca,
City Clerk.

RMM/jma
Enclosure

January 21, 1981

Harry A. Johnson,
Chairman of the Committee
on City Property
c/o City Clerk
City Hall
Providence, RI 02903

Dear Sir

I am interested in purchasing Lot 390 on City Assessor's Plat 46.

I would like to make an appointment as soon as possible so we can talk about my interest in the vacancy above.

Call me at 461-6522 or please send your answer in a letter addressed to - Mr. Andrew J. Patrick Jr.; PO BOX 2100; Providence, RI 02905.

Sincerely yours

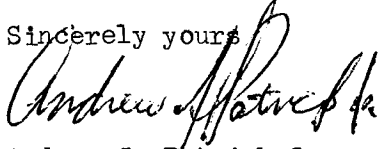

Andrew J. Patrick Jr.

AJP/dd

FILED

JAN 22 10 13 AM '81

DEPT. OF CIV. CLERK
PROVIDENCE, R. I.

6/25/79

Mr. Andrew J. Patrick Jr.
37 Potters Avenune
Providence Rhode Island 02905

Chairperson Committee Property
Councilman Harry W. Johnson
c/o City Clerk Dept.
Providence Rhode Island

Dear Mr. Harry W. Johnson,
In regards to property at 35 Potters Avenune lot number 46/390
I Mr. Andrew J. Patrick would like to purchase this property from
the city of Providence. I have been maintaing this property for
the last past five years, I feel the sum of \$500.00 dollars is a fair
one in addition, it would put the property back on the tax roll. I
currently own the a joining property and acquistion of this lot would
help maintain my property and the other property for the safe and
sanitary condition of my neighborhood. I also have been recieving rat
posion from the city to fight this problem. I will be responsible for
the securing of the areas. Inclosed you will find a photo of the
property as it stand today before it was clean.

Thank you for your cooperation and concern I do hope that your
decision is favorable to my concern.

Thank you

Andrew J. Patrick Jr.

THE COMMITTEE ON
PROPERTY

Recommends *Re Continued*

Rose M. Mendon
Clerk

5/25/79

THE COMMITTEE ON

CITY PROPERTY

Recommends

Sale of Property

Rose M. Mendon
Clerk

9/1/79



THE CITY ASSESSOR
CITY HALL, PROVIDENCE, RHODE ISLAND 02903

MEMORANDUM

TO: COMMITTEE ON CITY PROPERTY
FROM: THEODORE C. LITTLER
DATE: JULY 2, 1979
RE: REQUEST FOR APPRAISED VALUE

Pursuant to your request for an appraisal of property at 35 and 50 Potters Avenue, the following is submitted for your information.

Surveys conducted by this office indicate the properties located in areas between Eddy and Cahill Streets to Prairie Avenue from Public, through to Harriet and Mystic Streets, generally are selling in a range of 20¢ to 80¢ per square foot.

Keeping everything in proper perspective, it is the opinion of this office at a 3,200 sq. ft. lot would have a value of approximately 54¢ per sq. foot or ~~\$1,500~~ to ~~\$1,700~~.

5 B 35 27 A
100
00

November 18, 1980

Mr. Andrew F. Patrick, Jr.
37 Potters Avenue
Providence, RI 02905

Dear Mr. Patrick:

I have been directed by Councilman Harry A. Johnson, Chairman of the Committee on City Property to correspond with you relative to your request to purchase Lot 390 on City Assessor's Plat 46, located along 35 Potters Avenue.

This area of land contains approximately 5,535 square feet of land and the Committee voted to offer that lot to you for the sum of One Thousand, One Hundred Seven Dollars, (\$1,107.00).

If you are interested in purchasing this parcel, kindly submit your offer to the Chairman of the Committee on City Property in care of this Department.

Very truly yours,

Rose M. Mendonca,
City Clerk.

RMM:hgg

August 25, 1981

Mr. Andrew J. Patrick, Jr.
P.O. Box 211
Providence, RI 02905

Dear Mr. Patrick:

I have been informed by Mr. Joseph J. Johnson, Chairman of the City of Providence, that he invites you to attend the first scheduled meeting of the City Committee to be held Wednesday, September 9, 1981 at 6:58 o'clock P.M. (L.D.M.) in the City of Providence, Rhode Island's Department, Third Floor Level of City Hall.

The members of the City Committee will consider your request to purchase Lot 885 on the Assessor's Map 10.

Very truly yours,

Rose M. Mendonca,
City Clerk of Providence.

RMM:hgg