

THE CITY OF PROVIDENCE  
STATE OF RHODE ISLAND AND PROVIDENCE PLANTATIONS

# RESOLUTION OF THE CITY COUNCIL

No. 258

Approved June 4, 2004

RECEIVED  
CITY OF PROVIDENCE  
JUN 10 2004  
CITY CLERK

IT IS HEREBY RESOLVED, That His Honor, the Mayor, is authorized to grant a utility easement on Ship Street in the City of Providence to Brown University. Said easement shall be granted specifically upon the following provisions:

1. Said easement shall be utilized only for the construction and maintenance of duct banks containing electrical cables for utility infrastructure, installed between a proposed emergency generator located at AP 21, Lot 37, and the University's building located at 70 Ship Street, AP 21, Lot 105. Said easement shall not exceed the area of three hundred eighty square feet, plus or minus, with dimensions of ten feet by forty feet and indicated on the accompanying map marked as Exhibit A.

2. Said easement shall be deemed to run with the land and shall operate against any successors in title and the easement or a memorandum of same shall be recorded by Brown University in the Office of Land Records for the City of Providence.

3. Brown University shall execute an indemnification and hold-harmless agreement with the City of Providence. Said agreement shall be approved by the Department of Law of the City of Providence.

4. Brown University shall supply the City of Providence with an insurance policy naming said City of Providence, its agents, officers, servants and employees as additional-named insureds in a sum not less than one hundred thousand dollars (\$100,000.00) which policy shall be approved by the Department of Law of the City of Providence.

5. In the event that the City of Providence or its designee shall, for any public purpose, require the extinguishment of the easement granted herein, upon the ninety (90) days notice, Brown University shall, at its own expense, and without claim against the City, its officers, servants or employees, for any damages whatsoever, remove said duct banks from the easement area.

CITY COUNCIL  
JUN 3 2004  
READ AND PASSED

*Balbir Singh*  
PRES. ACTING

*Richard S. Clement*  
CLERK

IN CITY COUNCIL  
FEB 5 2004  
FIRST READING  
REFERRED TO COMMITTEE ON  
PUBLIC WORKS  
Michelle R. Clend Clerk  
*City Property  
Jointly*

THE COMMITTEE ON  
PUBLIC WORKS  
Approves Passage of  
The Within Resolution  
John M. Staln Clerk  
*City Property  
Jointly*  
5-18-04

6. Such other terms and conditions as may be reflected in the record and minutes of the City Council Committee on Public Works and Committee on City Property, jointly, and/or as may be deemed appropriate by the Mayor or the Department of Law.

**APPROVED**

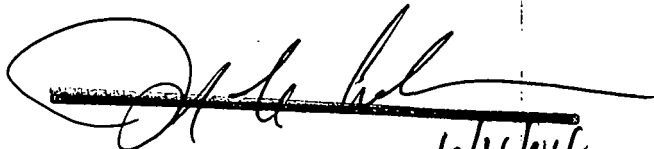
A handwritten signature in black ink, appearing to be "H. L. Hall", written over a horizontal line.

**MAYOR**

6/4/04

MAKRAM H. MEGALLI, P. E.

Director

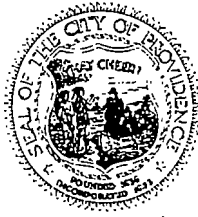

DAVID N. CICILLINE

Mayor

## Department of Public Works

*"Building Pride in Providence"*

April 16, 2004

Honorable Terrance M. Hassett  
Chairman of the Public Works Committee  
Providence City Council  
City Hall  
Providence, RI 02903

**RE: Petition from University., Requesting Utility Easement  
On Ship Street, Starting Approximately 38 Feet Easterly of Bassett Street**

Dear Councilman Hassett:

This Department has no objections to the proposed utility easement request in conjunction with the attached plan, entitled " Prov., R.I.- P.W. Dept. – Engineering Office, Street Line Section, Plan No. 064757, Date: April 2, 2004.

Said easement request is noted on the accompanying plan as dashed line for the proposed easement for electrical conduit and is approxiamtely 40' x 10' equals 386 ± Sq. Ft.

If we can further assist you in this regard, please contact

Very truly yours,

A handwritten signature in black ink, appearing to read "William C. Bombard", with a long horizontal line extending from the end of the signature.

William C. Bombard, P.E.  
City Engineer

WCB:om

cc: Makram H. Megalli, P.E., Director  
A. Southgate, Esq.  
T. Deller  
G. Florio  
JLC  
SZ

PROVIDENCE, R. I.  
 DEPT. • ENGINEERING OFFICE  
 STREET LINE SECTION  
 Plan No. 064757  
 Date April 2, 2004

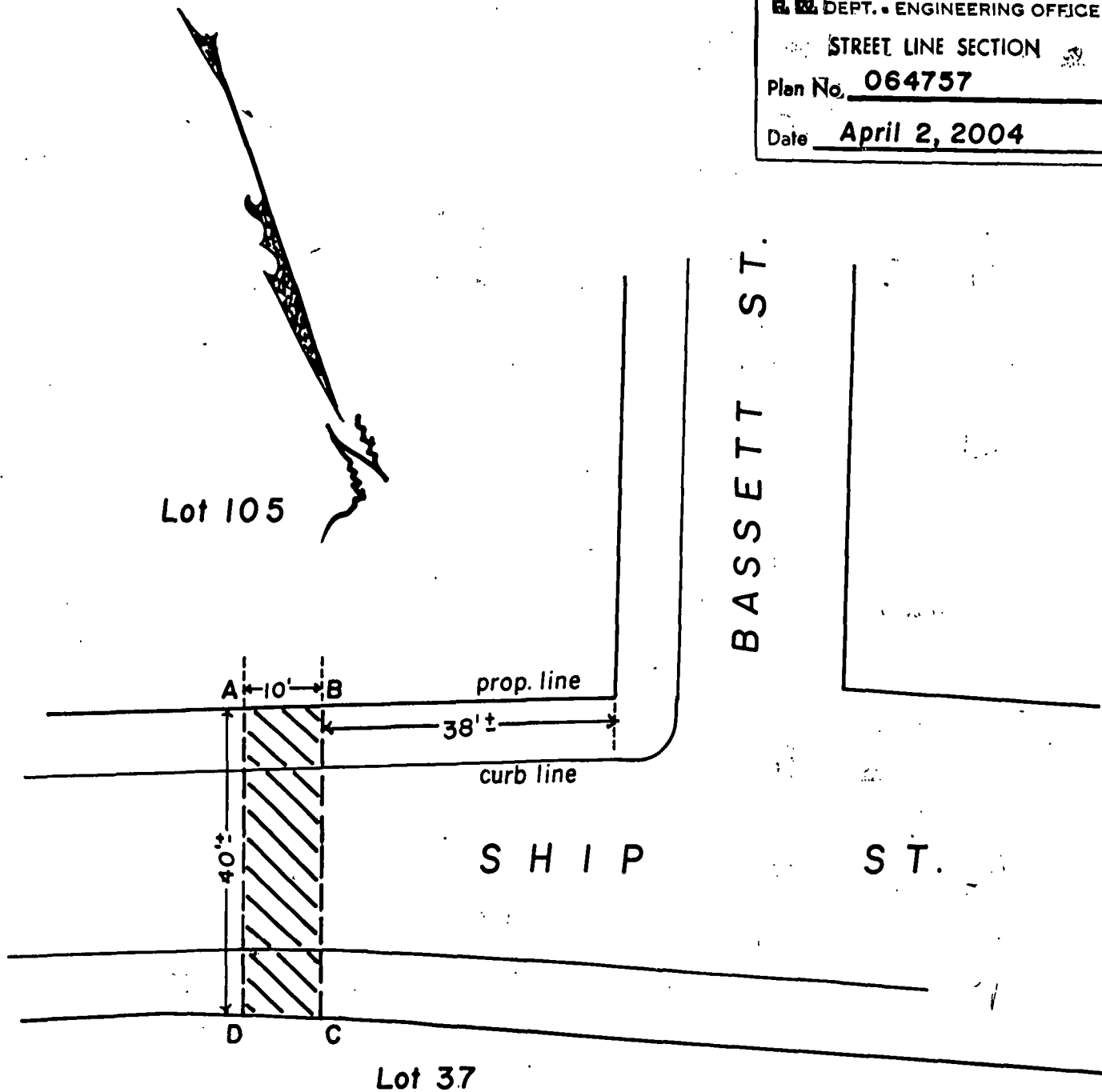

NOTES: Cross-hatched area (A-B-C-D-A) indicates proposed easement for electrical conduit. (Brown University)  
 Total square footage = 386' ±

Lot numbers taken from A.P. 21.

CITY OF PROVIDENCE, R. I.  
 Public Works Dept. • Engineering Office  
 Showing proposed easement on Ship St.  
 Drawn by A. Zisades Checked by \_\_\_\_\_  
 Scale 1" = 20' Date \_\_\_\_\_  
 Correct James A. McGee Associate Engr.  
 Approved William C. Bombard  
 CHIEF ENGINEER

City of Providence  
State of Rhode Island and Providence Plantations

PETITION TO THE CITY COUNCIL

TO THE HONORABLE CITY COUNCIL OF THE CITY OF PROVIDENCE

*The undersigned respectfully petitions your honorable body*

Due to renovations on the Brown University Facility located at 70 Ship Street, AP 21 lot 105, Brown University's Department of Facilities Management respectfully requests that a utility easement be established for University use as indicated on the attached drawings and further described as follows:

Construct duct banks containing electrical cables for utility infrastructure owned by Brown University. The proposed duct bank will be installed between a proposed emergency generator located on AP 21 lot 37, and the University's building located at 70 Ship Street and will cross Ship Street.

A ten-foot wide easement, crossing Ship Street in the north-south orientation starting at the southerly side of Ship Street, approximately 46 feet easterly of the intersection of Ship Street and Bassett Street, and ending on the northerly side of Ship Street approximately 42 feet from the easterly face of a concrete and brick pillar located on the west side of a existing stairway. (Dimensions given are to the westerly side of the proposed easement). Please refer to the attached drawing.

Any questions regarding the request may be directed to:

Paul Young  
Project Manager  
Brown University  
Department of Facilities Management  
Box 1941  
Providence, RI 02912  
(401) 863-1336

Attached drawings:

Proposed utility easement at 70 Ship Street Providence, RI  
Drawn by GZA GeoEnvironmental Providence, RI

GARY E. MULCAHY  
Acting Chief

DAVID D. COSTA  
Acting Assistant Chief

DAVID N. CICILLINE  
MAYOR

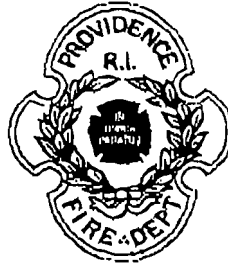

Department of Public Safety, Fire Department  
"Building Pride in Providence"

MEMORANDUM  
Via Facsimile

TO: Office of the City Clerk

FROM: Gary E. Mulcahy  
Acting Chief of Department

DATE: February 19, 2004

SUBJECT: PETITION TO CITY COUNCIL

GEM

This office is in receipt of the Memorandum to the City Clerk which was recently forwarded, a copy of which is attached hereto, regarding a request contained in the petition of Paul Young, Project Manager, Brown University/Department of Facilities Management, requesting that a utility easement be established at Ship Street (Assessor's Plant 21, Lot 105) for University use.

Please be advised this Department has no objection to these proposals.

GEM  
gem/rh  
Attachment

City of Providence  
State of Rhode Island and Providence Plantations

PETITION TO THE CITY COUNCIL

TO THE HONORABLE CITY COUNCIL OF THE CITY OF PROVIDENCE

*The undersigned respectfully petitions your honorable body*

Due to renovations on the Brown University Facility located at 70 Ship Street, AP 21 lot 105, Brown University's Department of Facilities Management respectfully requests that a utility easement be established for University use as indicated on the attached drawings and further described as follows:

Construct duct banks containing electrical cables for utility infrastructure owned by Brown University. The proposed duct bank will be installed between a proposed emergency generator located on AP 21 lot 37, and the University's building located at 70 Ship Street and will cross Ship Street.

A ten-foot wide easement, crossing Ship Street in the north- south orientation starting at the southerly side of Ship Street, approximately 46 feet easterly of the intersection of Ship Street and Bassett Street, and ending on the northerly side of Ship Street approximately 42 feet from the easterly face of a concrete and brick pillar located on the west side of a existing stairway. (Dimensions given are to the westerly side of the proposed easement). Please refer to the attached drawing.

Any questions regarding the request may be directed to:

Paul Young  
Project Manager  
Brown University  
Department of Facilities Management  
Box 1941  
Providence, RI 02912  
(401) 863-1336

Attached drawings:

Proposed utility easement at 70 Ship Street Providence, RI  
Drawn by GZA GeoEnvironmental Providence, RI

RECEIVED TO COMMISSIONER  
FIRST READING  
IN CITY COUNCIL  
MAY 10 2011  
CITY COUNCIL  
RECEIVED TO COMMISSIONER  
FIRST READING  
MAY 10 2011

RECEIVED TO COMMISSIONER  
FIRST READING  
MAY 10 2011  
CITY COUNCIL  
RECEIVED TO COMMISSIONER  
FIRST READING  
MAY 10 2011



FILED  
JAN 28 1 13 PM '04  
DEPT. OF CLERK  
PROVIDENCE, R.I.

THE COMMITTEE ON  
C. Prop & Public Works  
Recommends  
5-18-04 CLERK

IN CITY COUNCIL  
FEB 5 2004  
FIRST READING  
AND  
PUBLIC WORKS  
REFERRED TO COMMITTEE ON  
Michael J. Went CLERK  
REFERRED TO COMMITTEE ON  
CITY PROPERTY  
Michael J. Went CLERK

ELBOW STREET

BASSETT STREET

SHIP STREET

UPPER COURTYARD

LOWER COURTYARD

70 SHIP STREET  
6 STORY BUILDING

AP 21/LOT 105

SIDEWALK AREA

SMH

WGV

PSMH

10' WIDE PROPOSED UTILITY EASEMENT (386sq.ft.)

38'±

46'±

42'±

IRON FENCE AND BRICK AND CONCRETE COLUMNS

PROPERTY LINE

PARKING AREA (133 Spaces)  
AP 21/LOT 37

PROPOSED EMERGENCY GENERATOR

[illegible]

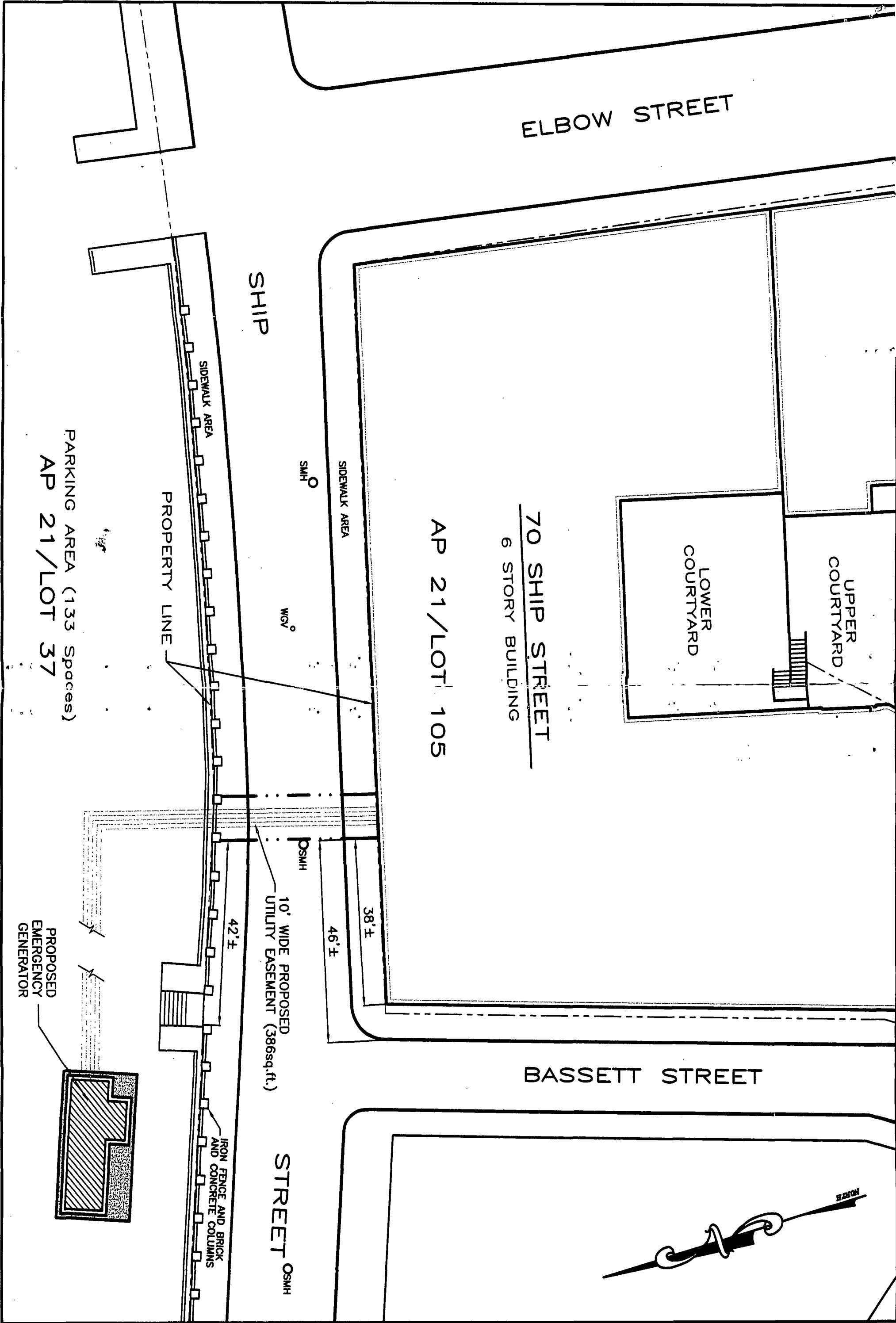

SHEET 1 OF 1	C-1	FIGURE NO. 32763.00	PROJECT NO. 32763.00	BROWN UNIVERSITY DEPARTMENT OF FACILITIES MANAGEMENT	PROJ. MGR. TRG CHK'D BY: PPV REV'D BY: TRG DRAWN BY: MKU SCALE: 1"= 20' DATE: JAN., 2004	 GZA GeoEnvironmental, Inc. 140 Broadway, Providence, RI 02903 (401) 431-4140 Fax (401) 751-0013																																																																																																																																																																																																																																																																																																																																																																																																																																																																																																																																																																																																																																																																																																																																																																																																																																																																																																																																																																																																																																																																																																																																																																																																																																																																																																																																																																																																																																																		
--------------	-----	------------------------	-------------------------	---	---	--	--	--	--	--	--	--	--	--	--	--	--	--	--	--	--	--	--	--	--	--	--	--	--	--	--	--	--	--	--	--	--	--	--	--	--	--	--	--	--	--	--	--	--	--	--	--	--	--	--	--	--	--	--	--	--	--	--	--	--	--	--	--	--	--	--	--	--	--	--	--	--	--	--	--	--	--	--	--	--	--	--	--	--	--	--	--	--	--	--	--	--	--	--	--	--	--	--	--	--	--	--	--	--	--	--	--	--	--	--	--	--	--	--	--	--	--	--	--	--	--	--	--	--	--	--	--	--	--	--	--	--	--	--	--	--	--	--	--	--	--	--	--	--	--	--	--	--	--	--	--	--	--	--	--	--	--	--	--	--	--	--	--	--	--	--	--	--	--	--	--	--	--	--	--	--	--	--	--	--	--	--	--	--	--	--	--	--	--	--	--	--	--	--	--	--	--	--	--	--	--	--	--	--	--	--	--	--	--	--	--	--	--	--	--	--	--	--	--	--	--	--	--	--	--	--	--	--	--	--	--	--	--	--	--	--	--	--	--	--	--	--	--	--	--	--	--	--	--	--	--	--	--	--	--	--	--	--	--	--	--	--	--	--	--	--	--	--	--	--	--	--	--	--	--	--	--	--	--	--	--	--	--	--	--	--	--	--	--	--	--	--	--	--	--	--	--	--	--	--	--	--	--	--	--	--	--	--	--	--	--	--	--	--	--	--	--	--	--	--	--	--	--	--	--	--	--	--	--	--	--	--	--	--	--	--	--	--	--	--	--	--	--	--	--	--	--	--	--	--	--	--	--	--	--	--	--	--	--	--	--	--	--	--	--	--	--	--	--	--	--	--	--	--	--	--	--	--	--	--	--	--	--	--	--	--	--	--	--	--	--	--	--	--	--	--	--	--	--	--	--	--	--	--	--	--	--	--	--	--	--	--	--	--	--	--	--	--	--	--	--	--	--	--	--	--	--	--	--	--	--	--	--	--	--	--	--	--	--	--	--	--	--	--	--	--	--	--	--	--	--	--	--	--	--	--	--	--	--	--	--	--	--	--	--	--	--	--	--	--	--	--	--	--	--	--	--	--	--	--	--	--	--	--	--	--	--	--	--	--	--	--	--	--	--	--	--	--	--	--	--	--	--	--	--	--	--	--	--	--	--	--	--	--	--	--	--	--	--	--	--	--	--	--	--	--	--	--	--	--	--	--	--	--	--	--	--	--	--	--	--	--	--	--	--	--	--	--	--	--	--	--	--	--	--	--	--	--	--	--	--	--	--	--	--	--	--	--	--	--	--	--	--	--	--	--	--	--	--	--	--	--	--	--	--	--	--	--	--	--	--	--	--	--	--	--	--	--	--	--	--	--	--	--	--	--	--	--	--	--	--	--	--	--	--	--	--	--	--	--	--	--	--	--	--	--	--	--	--	--	--	--	--	--	--	--	--	--	--	--	--	--	--	--	--	--	--	--	--	--	--	--	--	--	--	--	--	--	--	--	--	--	--	--	--	--	--	--	--	--	--	--	--	--	--	--	--	--	--	--	--	--	--	--	--	--	--	--	--	--	--	--	--	--	--	--	--	--	--	--	--	--	--	--	--	--	--	--	--	--	--	--	--	--	--	--	--	--	--	--	--	--	--	--	--	--	--	--	--	--	--	--	--	--	--	--	--	--	--	--	--	--	--	--	--	--	--	--	--	--	--	--	--	--	--	--	--	--	--	--	--	--	--	--	--	--	--	--	--	--	--	--	--	--	--	--	--	--	--	--	--	--	--	--	--	--	--	--	--	--	--	--	--	--	--	--	--	--	--	--	--	--	--	--	--	--	--	--	--	--	--	--	--	--	--	--	--	--	--	--	--	--	--	--	--	--	--	--	--	--	--	--	--	--	--	--	--	--	--	--	--	--	--	--	--	--	--	--	--	--	--	--	--	--	--	--	--	--	--	--	--	--	--	--	--	--	--	--	--	--	--	--	--	--	--	--	--	--	--	--	--	--	--	--	--	--	--	--	--	--	--	--	--	--	--	--	--	--	--	--	--	--	--	--	--	--	--	--	--	--	--	--	--	--	--	--	--	--	--	--	--	--	--	--	--	--	--	--	--	--	--	--	--	--	--	--	--	--	--	--	--	--	--	--	--	--	--	--	--	--	--	--	--	--	--	--	--	--	--	--	--	--	--	--	--	--	--	--	--	--	--	--	--	--	--	--	--	--	--	--	--	--	--	--	--	--	--	--	--	--	--	--	--	--	--	--	--	--	--	--	--	--	--	--	--	--	--	--	--	--	--	--	--	--	--	--	--	--	--	--	--	--	--	--	--	--	--	--	--	--	--	--	--	--	--	--	--	--	--	--	--	--	--	--	--	--	--	--	--	--	--	--	--	--	--	--	--	--	--	--	--	--	--	--	--	--	--	--	--	--	--	--	--	--	--	--	--	--	--	--	--	--	--	--	--	--	--	--	--	--	--	--	--	--	--	--	--	--	--	--	--	--	--	--	--	--	--	--	--	--	--	--	--	--	--	--	--	--	--	--	--	--	--	--	--	--	--	--	--	--	--	--	--	--	--	--	--	--	--	--	--	--	--	--	--	--	--	--	--	--	--	--	--	--	--	--	--	--	--	--	--	--	--	--	--	--	--	--	--	--	--	--	--	--	--	--	--	--	--	--	--	--	--	--	--	--	--	--	--	--	--	--	--	--	--	--	--	--	--	--	--	--	--	--	--	--	--	--	--	--	--	--	--	--	--	--	--	--	--	--	--	--	--	--	--	--	--	--	--	--	--	--	--	--	--	--	--	--	--	--	--	--	--	--	--	--	--	--	--	--	--	--	--	--	--	--	--	--	--	--	--	--	--	--	--	--	--	--	--	--	--	--	--	--	--	--	--	--	--	--	--	--	--	--	--	--	--	--	--	--	--	--	--	--	--	--	--	--	--	--	--	--	--	--	--	--	--	--	--	--	--	--	--	--	--	--	--	--	--	--	--	--	--	--	--	--	--	--	--	--	--	--	--	--	--	--	--	--	--	--	--	--	--	--	--	--	--	--	--	--	--	--	--	--	--	--	--	--	--	--	--	--	--	--	--	--	--	--	--	--	--	--	--	--	--	--	--	--	--	--	--	--	--	--	--	--	--	--	--	--	--	--	--	--	--

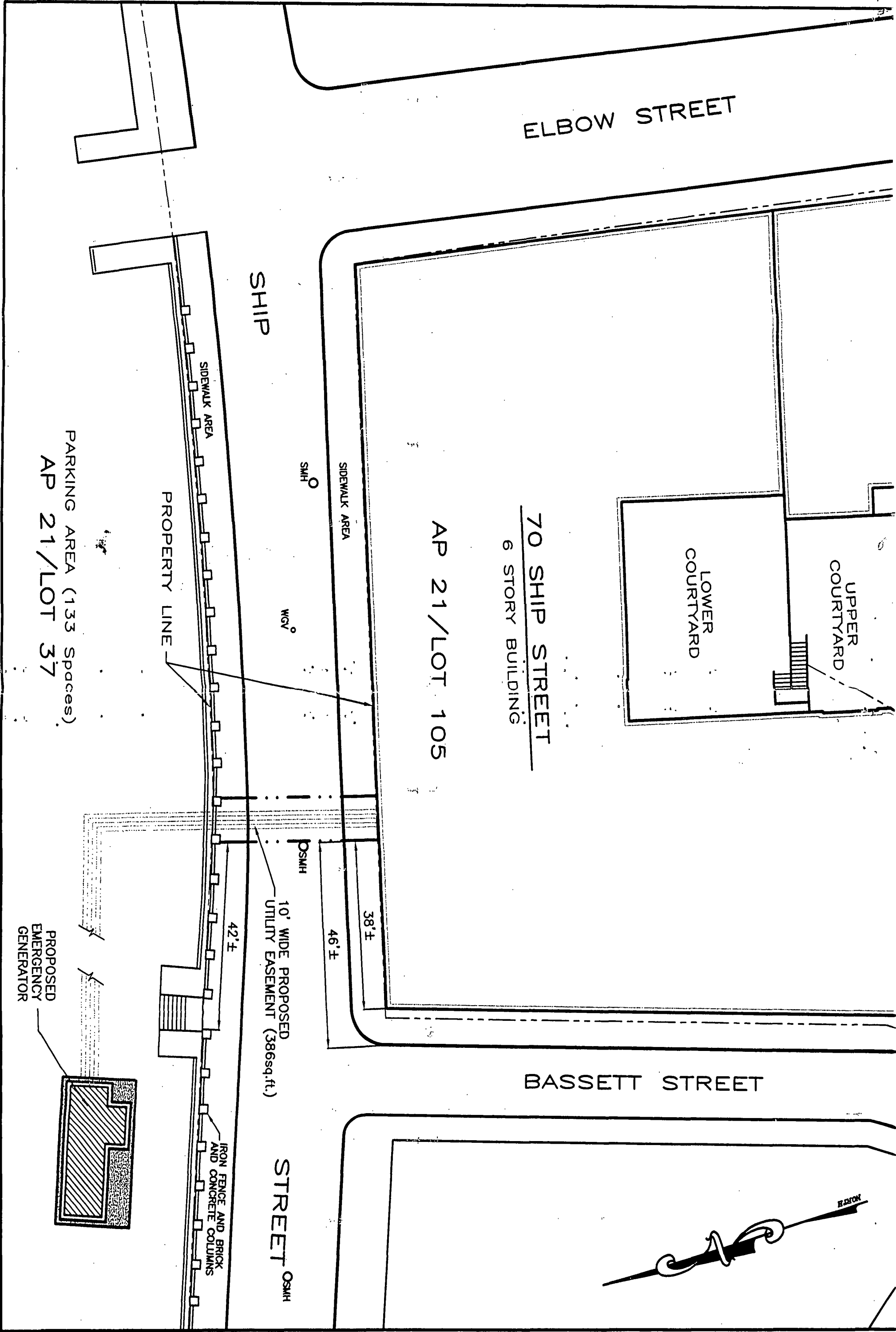

SHEET 1 OF 1	FIGURE NO. <b>C-1</b>	PROJECT NO. 32763.00	<b>BROWN UNIVERSITY</b>		PROJ. MOR. TRG		GZA GeoEnvironmental, Inc. 140 Broadway, Providence, RI 02903 (401) 421-1100 Fax (401) 781-0613			
			DEPARTMENT OF FACILITIES MANAGEMENT		CHK'D BY: PPV					
			<b>PROPOSED UTILITY EASEMENT AT 70 SHIP STREET PROVIDENCE, RI</b>		REV'D BY: TRG					
					DRAWN BY: MKU					
					SCALE: 1" = 20'					
					DATE: JAN., 2004					

City of Providence



Rhode Island

Department of City Clerk

MEMORANDUM

DATE: February 11, 2004

TO: Dean Esserman, Chief of Police

SUBJECT: **PUBLIC WORKS COMMITTEE**

CONSIDERED BY: Anna M. Stetson, Second Deputy City Clerk

DISPOSITION: I have been directed by Councilman Terrence M. Hassett, Chairman, Committee on Public Works to refer to you the accompanying resolutions for study, report and recommendation.

Please report back to this office as soon as practical.

**PETITION FROM PAUL YOUNG, PROJECT  
MANAGER, BROWN UNIVERSITY,  
DEPARTMENT OF FACILITIES  
MANAGEMENT, REQUESTING THAT A  
UTILITY EASEMENT BE ESTABLISHED  
AT SHIP STREET (ASSESSOR'S PLAT 21,  
LOT 105) FOR UNIVERSITY USE.**

A handwritten signature in cursive script, reading "Anna M. Stetson".  
City Clerk

City of Providence



Rhode Island

Department of City Clerk

MEMORANDUM

DATE: February 11, 2004

TO: Chief Gary Mulcahy, Acting Chief of Fire

SUBJECT: **PUBLIC WORKS COMMITTEE**

CONSIDERED BY: Anna M. Stetson, Second Deputy City Clerk

DISPOSITION: I have been directed by Councilman Terrence M. Hassett, Chairman, Committee on Public Works to refer to you the accompanying resolutions for study, report and recommendation.

Please report back to this office as soon as practical.

**PETITION FROM PAUL YOUNG, PROJECT  
MANAGER, BROWN UNIVERSITY,  
DEPARTMENT OF FACILITIES  
MANAGEMENT, REQUESTING THAT A  
UTILITY EASEMENT BE ESTABLISHED  
AT SHIP STREET (ASSESSOR'S PLAT 21,  
LOT 105) FOR UNIVERSITY USE.**

*Anna M. Stetson*  
Second Deputy  
City Clerk

City of Providence



Rhode Island

Department of City Clerk

MEMORANDUM

DATE: February 11, 2004

TO: Makram H. Megalli, Director of Public Works

SUBJECT: **PUBLIC WORKS COMMITTEE**

CONSIDERED BY: Anna M. Stetson, Second Deputy City Clerk

DISPOSITION: I have been directed by Councilman Terrence M. Hassett, Chairman, Committee on Public Works to refer to you the accompanying resolutions for study, report and recommendation.

Please report back to this office as soon as practical.

**PETITION FROM PAUL YOUNG, PROJECT  
MANAGER, BROWN UNIVERSITY,  
DEPARTMENT OF FACILITIES  
MANAGEMENT, REQUESTING THAT A  
UTILITY EASEMENT BE ESTABLISHED  
AT SHIP STREET (ASSESSOR'S PLAT 21,  
LOT 105) FOR UNIVERSITY USE.**

A handwritten signature in dark ink, appearing to read "Anna M. Stetson".

City Clerk

City of Providence



Rhode Island

Department of City Clerk

MEMORANDUM

DATE: March 31, 2004

TO: John Gelati, City Assessor

SUBJECT: **PUBLIC WORKS COMMITTEE**

CONSIDERED BY: Anna M. Stetson, Second Deputy City Clerk

DISPOSITION: I have been directed by Councilman Terrence M. Hassett, Chairman, Committee on Public Works to refer to you the accompanying petitions for study, report and recommendation.

Please report back to this office as soon as practical.

**PETITION FROM JAMES SISSON,  
CONSTRUCTION MANAGER, BROWN  
UNIVERSITY, DEPARTMENT OF FACILITIES  
MANAGEMENT, REQUESTING AN EASEMENT TO  
INSTALL AND MAINTAIN PRIVATE UTILITIES  
WITHIN THE PUBLIC RIGHT-OF-WAY UNDER  
THE SIDEWALK AT PROPOSED LOCATIONS.  
(THAYER STREET)**

**PETITION FROM PAUL YOUNG, PROJECT  
MANAGER, BROWN UNIVERSITY, DEPARTMENT  
OF FACILITIES MANAGEMENT, REQUESTING  
THAT A UTILITY EASEMENT BE ESTABLISHED  
AT SHIP STREET (ASSESSOR'S PLAT 21, LOT 105)  
FOR UNIVERSITY USE.**

**PETITION FROM PAUL DIETEL, PROJECT  
MANAGER, BROWN UNIVERSITY, DEPARTMENT  
OF FACILITIES MANAGEMENT, REQUESTING  
THAT UTILITY EASEMENTS ON MEETING  
STREET AND OLIVE STREET BE ESTABLISHED  
FOR UNIVERSITY USE.**

*Anna M. Stetson*  
Second Deputy City Clerk



**THE CITY OF PROVIDENCE**  
STATE OF RHODE ISLAND AND PROVIDENCE PLANTATIONS

# RESOLUTION OF THE CITY COUNCIL

**No. 258**

**Approved June 4, 2004**

RECEIVED  
CITY COUNCIL  
JUN 10 2004

IT IS HEREBY RESOLVED, That His Honor, the Mayor, is authorized to grant a utility easement on Ship Street in the City of Providence to Brown University. Said easement shall be granted specifically upon the following provisions:

1. Said easement shall be utilized only for the construction and maintenance of duct banks containing electrical cables for utility infrastructure, installed between a proposed emergency generator located at AP 21, Lot 37, and the University's building located at 70 Ship Street, AP 21, Lot 105. Said easement shall not exceed the area of three hundred eighty square feet, plus or minus, with dimensions of ten feet by forty feet and indicated on the accompanying map marked as Exhibit A.

2. Said easement shall be deemed to run with the land and shall operate against any successors in title and the easement or a memorandum of same shall be recorded by Brown University in the Office of Land Records for the City of Providence.

3. Brown University shall execute an indemnification and hold-harmless agreement with the City of Providence. Said agreement shall be approved by the Department of Law of the City of Providence.

4. Brown University shall supply the City of Providence with an insurance policy naming said City of Providence, its agents, officers, servants and employees as additional-named insureds in a sum not less than one hundred thousand dollars (\$100,000.00) which policy shall be approved by the Department of Law of the City of Providence.

5. In the event that the City of Providence or its designee shall, for any public purpose, require the extinguishment of the easement granted herein, upon the ninety (90) days notice, Brown University shall, at its own expense, and without claim against the City, its officers, servants or employees, for any damages whatsoever, remove said duct banks from the easement area.

CITY COUNCIL  
JUN 3 2004  
READ AND PASSED

*Balbir A. Gungor*  
PRES. ACTING

*Richard A. Newport*  
CLERK

6. Such other terms and conditions as may be reflected in the record and minutes of the City Council Committee on Public Works and Committee on City Property, jointly, and/or as may be deemed appropriate by the Mayor or the Department of Law.

**APPROVED**

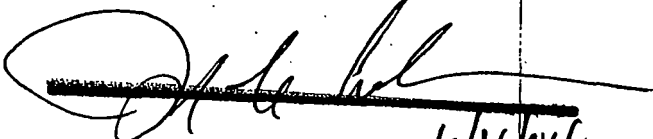
  
**MAYOR** 6/4/04

A true copy.

Attest:

  
Michael R. Clement  
City Clerk

MAKRAM H. MEGALLI, P. E.  
Director



DAVID N. CICILLINE  
Mayor

**Department of Public Works**

*"Building Pride in Providence"*

April 16, 2004

Honorable Terrance M. Hassett  
Chairman of the Public Works Committee  
Providence City Council  
City Hall  
Providence, RI 02903

**RE: Petition from University., Requesting Utility Easement  
On Ship Street, Starting Approximately 38 Feet Easterly of Bassett Street**

Dear Councilman Hassett:

This Department has no objections to the proposed utility easement request in conjunction with the attached plan, entitled " Prov., R.I.- P.W. Dept. - Engineering Office, Street Line Section, Plan No. 064757, Date: April 2, 2004.

Said easement request is noted on the accompanying plan as dashed line for the proposed easement for electrical conduit and is approximately 40' x 10' equals 386 ± Sq. Ft.

If we can further assist you in this regard, please contact

Very truly yours,

A handwritten signature in black ink, appearing to read "William C. Bombard".

William C. Bombard, P.E.  
City Engineer

WCB:om

cc: Makram H. Megalli, P.E., Director  
A. Southgate, Esq.  
T. Deller  
G. Florio  
JLC  
SZ

PROVIDENCE, R. I.  
 DEPT. - ENGINEERING OFFICE  
 STREET LINE SECTION  
 Plan No. **064757**  
 Date **April 2, 2004**

BASSETT ST.

Lot 105

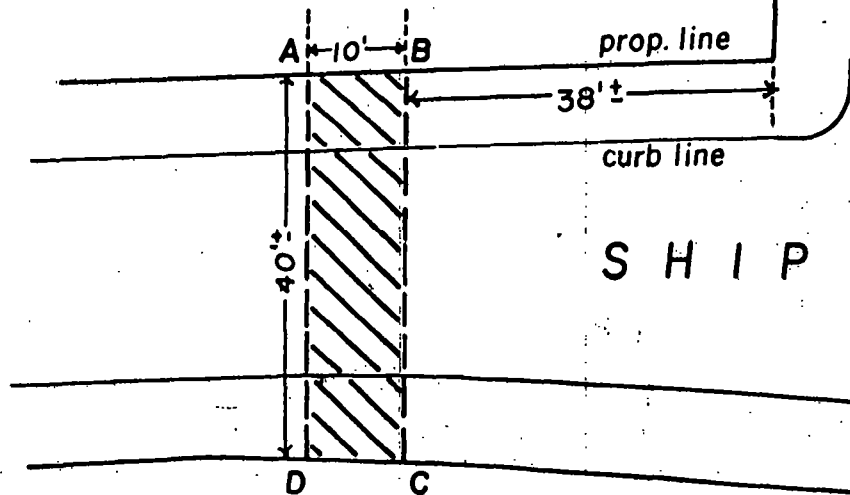

SHIP ST.

Lot 37

NOTES: Cross-hatched area (A-B-C-D-A) indicates proposed easement for electrical conduit. (Brown University)  
 Total square footage = 386'±

CITY OF PROVIDENCE, R. I.  
 Public Works Dept. - Engineering Office  
 Showing proposed easement on Ship St.

Drawn by A. Zisides Checked by \_\_\_\_\_  
 Scale 1" = 20' Date \_\_\_\_\_  
 Correct James A. Morris Associate Engr.  
 Approved William C. Bombard  
 CHIEF ENGINEER

Lot numbers taken from A.P. 21.

GARY E. MULCAHY  
Acting Chief

DAVID N. CICILLINE  
MAYOR

DAVID D. COSTA  
Acting Assistant Chief



Department of Public Safety, Fire Department  
"Building Pride in Providence"

MEMORANDUM  
Via Facsimile

TO: Office of the City Clerk

FROM: Gary E. Mulcahy  
Acting Chief of Department

DATE: February 19, 2004

SUBJECT: PETITION TO CITY COUNCIL

*GEM*

This office is in receipt of the Memorandum to the City Clerk which was recently forwarded, a copy of which is attached hereto, regarding a request contained in the petition of Paul Young, Project Manager, Brown University/Department of Facilities Management, requesting that a utility easement be established at Ship Street (Assessor's Plant 21, Lot 105) for University use.

Please be advised this Department has no objection to these proposals.

*GEM*  
gem/rh  
Attachment

*Richard D. Thorpe*  
Recorder of Deeds

PROVIDENCE, RI  
RECEIVED FOR RECORD  
2004 JUN 14 PM 3:38  
DANBARA A. PRONCY  
RECORDER OF DEEDS

6600/305-309

PROVIDENCE, RI  
RECEIVED FOR RECORD

2004 JUN 14 PM 3:38

BARBARA A. TRONCY  
RECORDER OF DEEDS

C

49407

RECORDED  
INDEXED