

# The City of Providence

STATE OF RHODE ISLAND AND PROVIDENCE PLANTATIONS

## CHAPTER 1006

*moving change  
#85*

No. 74 **AN ORDINANCE** IN AMENDMENT OF CHAPTER 544 OF THE ORDINANCES OF THE CITY OF PROVIDENCE APPROVED SEPTEMBER 21, 1951 AS HERETOFORE AMENDED IS HEREBY FURTHER AMENDED BY CHANGING FROM AN R-3 GENERAL RESIDENCE ZONE TO A C-1 LIMITED COMMERCIAL ZONE - LOT 37 AS SET OUT AND DELINEATED ON CITY ASSESSOR'S PLAT 67 - SAID LOT BEING LOCATED AT 36-38 DUKE STREET.

Approved February 3, 1956

*Be it ordained by the City of Providence:*

SECTION 1: The Zoning Map accompanying and made part of Chapter 544 of the Ordinances of the City of Providence approved September 21, 1951 as heretofore amended and entitled "An Ordinance Zoning the City of Providence and Establishing Use, Height and Area Regulations" is hereby further amended by changing from an R-3 General Residence Zone to a C-1 Limited Commercial Zone, Lot 37 as set out and delineated on City Assessor's Plat 67. Said lot being located at 36-38 Duke Street, bounded and described as follows:

Beginning at a point in the westerly line of Duke Street at the southeasterly corner of Lot 37 on Assessor's Plat 67; thence westerly along the northerly line of Lot 41 to the southwesterly corner of Lot 37; thence northerly along the easterly lines of Lots 512, 30, 31, 32 to the southwesterly boundary of the General Commercial Zone, C-2; thence southeasterly along the southwesterly boundary of the General Commercial Zone, C-2, to the westerly line of Duke Street; thence southerly along the said westerly line of Duke Street to the point and place of beginning.

SECTION 2: This Ordinance shall take effect upon its passage.

**IN CITY  
COUNCIL**

JAN 19 1956

**1<sup>ST</sup> READING  
READ AND PASSED**

*Deverett Whelan*  
CLERK

**IN CITY  
COUNCIL**

FEB 2 - 1956

**FINAL READING  
READ AND PASSED**

*Deverett Whelan*  
CLERK

**APPROVED**

FEB 3 1956

*Walter H. Reynolds*  
MAYOR

**CITY OF PROVIDENCE**  
STATE OF RHODE ISLAND AND PROVIDENCE PLANTATIONS

**PETITION TO THE CITY COUNCIL**

TO THE HONORABLE CITY COUNCIL OF THE CITY OF PROVIDENCE:

*The undersigned respectfully petition your honorable body*

To amend the Zoning Map which is part of the Zoning Ordinance of the City of Providence by changing from R-3 General Residence Zone to a commercial C-1 Limited Commercial Zone; lot 37 on Assessor's Plat 67; said lot being located on Duke Street. 36 & 38 Duke Street

RICHARD E. FRANK COMPANY

By: *Frank Kochler*  
Vice-President

*1, 37  
C-2*

IN CITY  
COUNCIL

NOV 17 1955

NOT READING  
REFERRED TO COMMITTEE ON  
ORDINANCES  
THOMAS W. BROWN, CLERK

NOV 17 4 49 PM '55  
CITY CLERK'S OFFICE  
PROVIDENCE, R. I.

THOMAS W. BROWN  
CITY CLERK

CITY COUNCIL

DATE November 17 19 55

RECEIVED OF Richard E. Frank Co.

TEN AND 00/100

DOLLARS

Fee for Petition to the City Council for a change in the Zoning of

Lot 37

at

67

(36-38 Duke St.)

\$10.00

PAID - City of Providence - James M. Gordon, City Collector

NOV-18-55

10 20

**The City of Providence — Legislative Department**  
**CITY CLERK'S OFFICE—OFFICIAL MEMORANDUM**

Providence, R. I., November 18, 1955

TO: City Plan Commission

SUBJECT: Zoning Petition - Duke Street

CONSIDERED BY: Committee on Ordinances

ACTION TAKEN: Voted: to refer attached petition for study, report, and recommendation.

Richard E. Frank Company  
36-38 Duke Street

Plat 67 Lot 37

(F)

Plat 67

Lot 37 Richard E. Frank & Co  
36-40 Duke St

34 Anna J Hardenbergh Est  
40 RI Hopt Fr Co 15 Westminster

259 Thomas J Cronin & Mary C  
169 Bath St

36 Cyrus S. Helstein & Benjamin  
Helstein 73 Pinehurst Ave

35 The Atlantic Refining Co  
260 So. Broad St, Phila. Pa

33 Sarah J M. Smith Est  
165 Bath St

32 " + Ellen Roney

31 Margaret J Shawcross Est.  
155 Bath St

30 Rosalind U Harley  
149 Bath St

512 Thomas E. Walsh & wife  
145 1/2 Bath St

27 Katherine A. Craghead 1043  
145 Beatrice St 330 Blackstone  
to C. St. Mary T. D. with ...  
Bluff

436 James Favery Esq  
377 Ohio St

435

434

276 Joseph H. Stuffed & wif Mary A  
14 Duane St

385 Edward A. Fitzgerald & wif Margaret  
16 Duane St

386 Albert R. Leary & wif Rosamund  
18 Duane St

41 Marian Zarefian & wif Simon  
18 Duane St

513 Vahé & Harry Samvorian  
137 Charles St

254

"

255 Mary T Conway  
843 Smith St

44 City of Prov

38 Same as #34 / Anna J  
Hardenberg Est.

M S Bihler  
18/6/55

Ward 12  
Commissioner Henry T  
Boyle



THE CITY OF PROVIDENCE

PUBLIC HEARING

Relative to Amendments to the Zoning Ordinance and Zoning Map.

City Clerk's Office,  
December 7, 1955.

NOTICE is hereby given that a PUBLIC HEARING will be held in the City Council Chamber, City Hall, on THURSDAY, DECEMBER 29, 1955, at 2:00 o'clock p.m. (EST) at which time the following petitions in amendment of Chapter 544 of the Ordinances of the City of Providence, approved September 21, 1951, as heretofore amended, will be considered.

PETITION OF PAUL NAZARIAN to change from an R-4 Multiple Dwelling Zone to a C-2 General Commercial Zone Lot 515 as set out and delineated on City Assessor's Plat 37; said lot being located at 269 Althea Street.

PETITION OF RICHARD E. FRANK COMPANY to change from an R-3 General Residence Zone to a C-1 Limited Commercial Zone; Lot 37 as set out and delineated on City Assessor's Plat 67; said lot being at 36-38 Duke Street.

PETITION OF MICHELE SPIRITO to change from an R-3 General Residence Zone to a C-4 Heavy Commercial Zone Lots 4, 5, and 6 as set out and delineated on City Assessor's Plat 43; said lots being located in the vicinity of Huntington Avenue and Madison Street.

All persons interested in the above Petitions are hereby invited to be present at that time and place to be heard thereon.

The Petitions may be seen and information obtained relative to the above in the Office of the City Clerk, City Hall.

By Order of the Committee on Ordinances.

JOHN F. BROCK, Chairman,  
D. EVERETT WHELAN, City Clerk.

CITY OF PROVIDENCE  
THE CITY CLERK  
CITY HALL, PROVIDENCE 3, R. I.

#100  
10-29-55

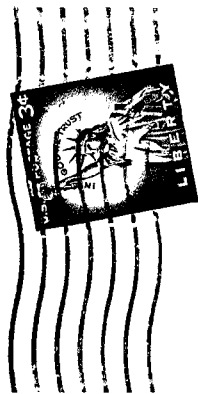

Mrs. Marjiam Zarefian  
18 Elm Street  
Providence, RI.



# City Plan Commission

EDWARD WINSOR, *Chairman*  
JERRY LORENZO      RALPH MATERA

WALTER H. REYNOLDS, *Mayor*  
LUCIO E. CARLONE, *Secretary*

PAUL A. SAN SOUZI, *Vice Chairman*  
RAYMOND J. NOTTAGE      HARRY PINKERSON

FRANK H. MALLEY, *Director*  
MILLARD HUMSTONE, *Senior Planner*

*Suite 103, City Hall,  
Providence 3, Rhode Island*

December 14, 1955

Committee on Ordinances  
City Hall  
Providence, Rhode Island

SUBJECT: Referral No. 759 - ZONING CHANGE AT 36 AND 38 DUKE STREET

Gentlemen:

The subject referral received consideration by the City Plan Commission at a meeting held on Tuesday, December 13, 1955.

This referral is a request for a change in zoning from an R-3 Zone to a C-1 Zone of Lot 37 on Assessor's Plat 67 located on 36 and 38 Duke Street. The lot in question contains 20,858 square feet.

On the field trip it was found that the area is occupied by an insurance company and a newspaper distributor. A major portion of the lot is used for parking.

In order to avoid undesirable spot zoning,

The Commission

VOTED: To recommend that this petition be denied.

Very truly yours,

  
FRANK H. MALLEY  
DIRECTOR  
CITY PLAN COMMISSION

FHM:MMH

c.c. Councilman William A. Gray  
Councilman Russell J. Boyle

Zoning Change No.

Shaded area to be changed from an  
R-3 General Residence Zone to a  
C-1 Limited Commercial Zone

November 28, 1955

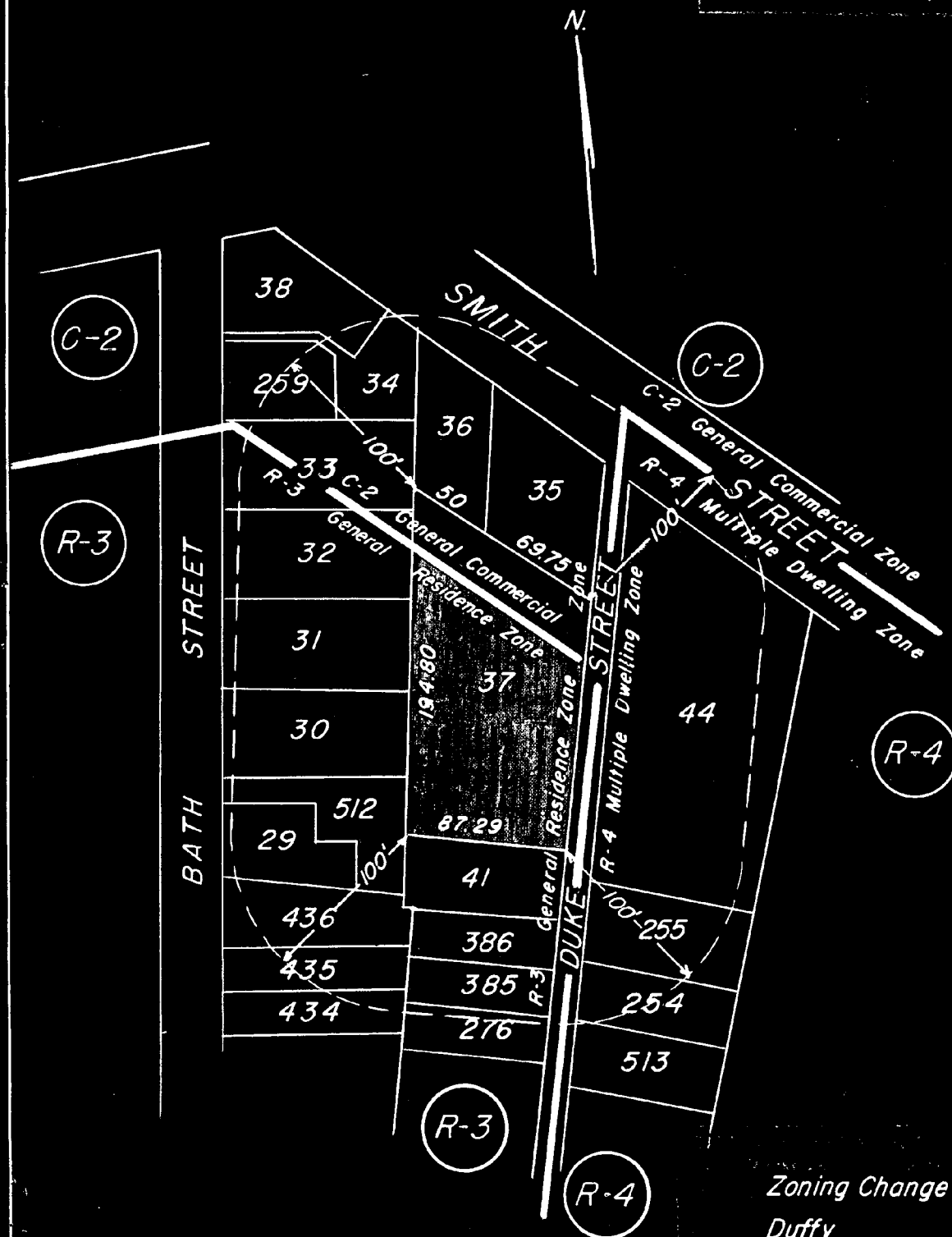

Assessor's Plat 67

Zoning Change No.

Duffy

11-80

William of Bay

Robert W. Hall

W.L.B.

11-28-55

# The City of Providence

STATE OF RHODE ISLAND AND PROVIDENCE PLANTATIONS

## CHAPTER 1007

*moving change #86*

No. 75 **AN ORDINANCE** IN AMENDMENT OF CHAPTER 544 OF THE ORDINANCES OF THE CITY OF PROVIDENCE, APPROVED SEPTEMBER 21, 1951 AS HERETOFORE AMENDED IS HEREBY FURTHER AMENDED BY CHANGING FROM AN R-4 MULTIPLE DWELLING ZONE TO AN M-1 GENERAL INDUSTRIAL ZONE - LOTS 16, 17, 18, 40 and 46; AND PORTIONS OF LOTS 39 AND 45 AS SET OUT AND DELINEATED ON CITY ASSESSOR'S PLAT 29; SAID LOTS BEING BOUNDED BY WHITTAKER STREET, HOOD STREET AND FOUNTAIN STREET.

Approved February 3, 1956

*Be it ordained by the City of Providence:*

SECTION 1. The Zoning Map accompanying and made a part of Chapter 544 of the Ordinances of the City of Providence, approved September 21, 1951 as heretofore amended and entitled, "An Ordinance Zoning the City of Providence and Establishing Use, Height and Area Regulations" is hereby further amended by changing from an R-4 Multiple Dwelling Zone to an M-1 General Industrial Zone Lots 16, 17, 18, 40 and 46, and portions of Lots 39 and 45 as set out and delineated on City Assessor's Plat 29; said lots being bounded by Whittaker Street, Hood Street and Fountain Street - bounded and described as follows:

Beginning at the southwesterly corner of Fountain and Whittaker Streets; thence southerly along the westerly line of Whittaker Street, crossing Washington Street to the northerly boundary of the present General Commercial Zone C-2; thence westerly along the said northerly boundary of the present General Commercial Zone C-2, to the center line of Hood Street; thence northerly along the said center line of Hood Street and extension thereof, crossing Washington Street, to the northerly line of Lot 39 on Assessor's Plat 29; thence easterly along the said northerly line of Lot 39 to the southeasterly corner of Lot 19; thence northerly along the easterly line of said Lot 19 to the southerly line of Fountain Street and the northwesterly corner of Lot 18; thence easterly along the said southerly line of Fountain Street to the point and place of beginning.

SECTION 2: This Ordinance shall take effect upon its passage.

IN CITY  
COUNCIL

JAN 19 1956

FIRST READING

READ AND PASSED

*Deverett Whelan*  
CLERK

IN CITY  
COUNCIL

FEB 2 - 1956

FINAL READING  
READ AND PASSED

*Charles Wells*  
PRESIDENT  
*Deverett Whelan*  
CLERK

APPROVED

FEB 3 1956

*Walter H. Reynolds*  
MAYOR

CITY OF PROVIDENCE  
STATE OF RHODE ISLAND AND PROVIDENCE PLANTATIONS

PETITION TO THE CITY COUNCIL

TO THE HONORABLE CITY COUNCIL OF THE CITY OF PROVIDENCE:

The undersigned respectfully petition your honorable body

To amend the Zoning map which is part of the Zoning Ordinance of the City of Providence by changing Lots 16, 17, 18, <sup>19</sup>40, 46 and part of Lots ~~49~~, 39 and 45 on Assessor's Plat 29 presently zoned Multiple Dwelling R4 to a General Industrial M1 Zone said change in effect extending the M1 Zone westerly from Whittaker Street to the center of Hood Street and then extended northerly to Fountain Street.

*Evelyn Agnoff*

031-755 032

0.00

0.00

032

IN CITY  
COUNCIL

OCT 6 - 1855

RECEIVED  
REferred TO COMMITTEE ON  
ORDINANCES  
.....  
The undersigned Clerk

RECEIVED  
OCT 6 4 05 PM '55  
CITY CLERK'S OFFICE  
PROVIDENCE, R.I.

Handwritten notes in the top left corner, including a signature and the date "Oct 6 - 1855".

CITY COUNCIL

1050

DATE October 6 19 55

RECEIVED OF Evelyn Azroff

TEN AND 00/100

90X-2

DOLLARS

Fee for Petition to the City Council for a change in the Zoning of

16, 17, 18, 40 & 46 & part of  
Lot 19, 39 and 45

City of

29

\$10.00

PAID - James M. Gordon, City Collector

061-7-55



**Providence — Legislative Department**

**OFFICE—OFFICIAL MEMORANDUM**

October 7, 1955  
Providence, R. I., .....

- vicinity of Whittaker, Hood, and Fountain Streets  
on Ordinances  
refer attached petition for study, report, and  
commendation.

City Clerk

1 EVELYN AZROFF, vicinity of Whittaker, Hood, & Fountain Streets  
Plat 29, Lots 16, 17, 18, 19, 39, 40, 45, & 46

(25)

Plat 29 Evelyn Azroff  
Lot 16 40 Warrington St

17 Albert & Benjarelli & Joseph Pisaturo  
449 Fountain St

18

19 Frank V Lombardi & wife Jennie A. & Giovanni  
V Lombardi & wife Jennie A.  
470 Fountain St

39 Annie Solomon  
483 Warrington

40 Same as #17

45 dropped

46 James & Gentile & wife Lena, & Lorenzo L Barbare  
& wife Maria 1021 Westminster St

7 Domenico M. Tortolani & wife Anna D.  
202 Carpenter St

4

11

3 Joseph Piaturo + w/ Christina  
27 March St

15 John D Croediman + w/ Mary J D  
1214 Cranston St, Cranston

42

"

41 Vincenzo Tasso + w/ Grace  
122 Norwood Ave, Cranston

481

"

43 M<sup>c</sup> Kendall Land Co, Inc.  
735 Elmwood Ave

44

"

60

"

61

"

59 William J, M<sup>c</sup> Isaac + w/ Luise W  
11 Norwell Place, Riverside

58 Same as #46

373 Same as #43

62 Antlers Building Ass. Inc.  
1029 Westminster St.

#7 Antonio Gallucci  
797 Charles St

#8 Kerkor Eneclian & w/ Agavice  
120 Oak St

285 Same as #15

#68 Vincenzina Esposito  
487 Washington St

#67 Vincenzo Simeone & w/ Concetta  
506 Washington St

38

20 Mary C. Connello  
315 Atwell Ave

21 Filomena Cotoia

478 Fountain #

22 Arcangelo Di Battista Est. & wid. Rosina

482 Fountain #

12 Giuseppe Mansolillo & wif Clara A.

475 Fountain #

10 Aristide Lombardi

212 Carpenter #

~~420 Enrico Gelbetti & wif Delta~~

~~469 Fountain #~~

8 Mary E. Chalford wid Arnold A.

465 Fountain #

420 Alfred J. Labonte & Ellis

M. Labonte

19 Lorenzo & wif

Ward 13

Councilman Lorenzo & wif

Joe:

P.B. 1041/368 <sup>9-23-55</sup>/<sub>9-23-55</sub> 6.05 Warranty deed from  
Enrico Giberti + w/ Delia & Alfred J.  
Sabonte and Ellis M. Sabonte - Jt. Ten.  
- Plat 29 Lot. 420

↗ This is the only transfer & date  
HGR.

19 Leroy George.



## City Plan Commission

EDWARD WINSOR, *Chairman*  
JERRY LORENZO      RALPH MATERA

WALTER H. REYNOLDS, *Mayor*  
LUCIO E. CARLONE, *Secretary*

PAUL A. SAN SOUZI, *Vice Chairman*  
RAYMOND J. NOTTAGE      HARRY PINKERSON

FRANK H. MALLEY, *Director*  
MILLARD HUMSTONE, *Senior Planner*

*Suite 103, City Hall,  
Providence 3, Rhode Island*

October 26, 1955

Committee on Ordinances  
City Hall  
Providence, Rhode Island

SUBJECT: REFERRAL NO. 749 - ZONING CHANGE IN THE VICINITY OF WHITTAKER,  
HOOD, WASHINGTON AND FOUNTAIN STREETS

Gentlemen:

The subject referral received consideration by the City Plan Commission on Tuesday, October 25, 1955.

This referral is a request for a change in zoning from an R-4 Zone to an M-1 Zone Lots 16, 17, 18, 40, 46, and part of Lots 19, 39 and 45 on Assessor's Plat 29.

On the field trip it was found that the area in question lies between Whittaker and Hood Streets and is an extension of an existing M-1 Zone. As several industrial properties are located in the area involved,

The Commission

VOTED: To offer no objection to the granting of this petition.

Very truly yours,

  
FRANK H. MALLEY  
DIRECTOR  
CITY PLAN COMMISSION

FHM:MMH

c.c. Councilman Jerry Lorenzo  
Councilman Thomas S. Luongo

THE CITY OF PROVIDENCE

PUBLIC HEARING

Relative to Amendments to the Zoning Ordinance, concerning Lot Coverage, and to the Zoning Ordinance and Zoning Map.

City Clerk's Office,  
October 8, 1955.

NOTICE is hereby given that a PUBLIC HEARING will be held in the City Council Chamber, City Hall, on MONDAY, OCTOBER 31, 1955, at 2:00 o'clock p.m., at which time the following Ordinance in amendment of Chapter 544 of the Ordinances of the City of Providence, approved September 21, 1951, as heretofore amended, and the following Petition in amendment of the Zoning Ordinance and Zoning Map, will be considered.

AN ORDINANCE amending Section 41, C, Paragraph 5, of Chapter 544 of the Ordinances of the City of Providence, approved September 21, 1951, as amended, entitled "An Ordinance Zoning the City of Providence and Establishing Use, Height, and Area Regulations" relative to Lot Coverage.

PETITION OF EVELYN AZROFF to change from an R-4 Multiple Dwelling Zone to an M-1 General Industrial Zone, Lots 16, 17, 18, 19, 39, 40, 45, and 46 as set out and delineated on City Assessor's Plat 29; said lots being located in the vicinity of Whittaker, Hood, and Fountain Streets.

All persons interested in the above Ordinance and Petition are hereby invited to be present at that time and place to be heard thereon.

The Ordinance and Petition may be seen and information obtained relative to the above in the Office of the City Clerk, City Hall.

By Order of the Committee on Ordinances.

JOHN F. BROCK, Chairman,  
D. EVFRET WHELAN, City Clerk.



CITY OF PROVIDENCE  
THE CITY CLERK  
CITY HALL, PROVIDENCE 3, R. I.



Annie Solomon  
483 Warrington Street  
Providence, R.I.

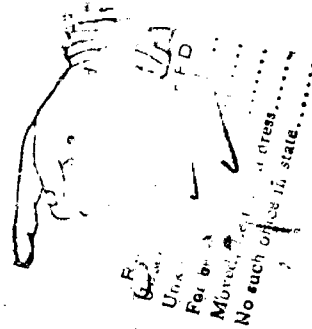

Try 245  
10

For a  
United  
States  
Postage  
No such office in state.

