

# RESOLUTION OF THE CITY COUNCIL

No. 412

Approved October 7, 2025

WHEREAS, The Providence City Council shares the Providence School Committee's desire to provide all of the City's students with 21st century learning facilities; and

WHEREAS, In support of this endeavor, it is necessary to offer students with progressive educational environments that will incorporate different types of collaboration and learning spaces to enhance students' daily experiences; and



WHEREAS, The Providence School Committee has completed a comprehensive application for Stage II approval by the Rhode Island Department of Education ("RIDE") consistent with the Rhode Island School Construction Regulations ("Regulations") that addresses the mutual goals of both the City Council and the School Building Committee; and

WHEREAS, 200-RICR-20-05-4.9.3(A)(6)(a) of the Regulations requires the submission of documentation demonstrating the City Council's support of the Stage II submission to RIDE.

NOW, THEREFORE, BE IT RESOLVED, That we, the members of the Providence City Council hereby support and approve the Providence Public School District's Necessity of School Construction Application to RIDE for Stage II approval; and

BE IT FURTHER RESOLVED, That this resolution shall become effective immediately upon passage by the Providence City Council.

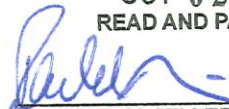
IN CITY COUNCIL  
OCT 02 2025  
READ AND PASSED

  
RACHEL M. MILLER, PRESIDENT  
  
CLERK

I HEREBY APPROVE.

  
\_\_\_\_\_  
Mayor  
Date: 10/7/25

## 2025 RIDE Stage II

### Objective of the 2025 RIDE Stage II

- Stage II application is for housing aid reimbursement for future construction projects, with a primary focus on the Capital Revolving Fund
- Once approved, it will result in a Memorandum of Agreement (MOA) with RIDE that the City will use to seek reimbursement
  - Please note that the MOA amounts and actual funding levels are distinct – funding will be determined on an annual basis by the City and PPSD
  - The SBC may make adjustments to the MOA in the coming years as project needs adjust
  - Key components of this Stage II request include
    - Capital Revolving Fund
    - Program additions at Kizirian Pk-8 (existing Gym Renovation, Connector & Site Work
    - Times2 Academy funded projects (no CRF, City or PPSD funding)

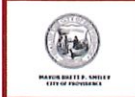

Providence  
Schools



STUDIO  
JAED

## 2025 RIDE Stage II

The Providence School Department, in partnership with the City of Providence, respectfully submits this Stage II Necessity of School Construction application requesting **\$79,493,307, which is eligible for \$67,330,831** in state reimbursement funding to address urgent facility needs across multiple schools. The proposed program encompasses targeted renovations at eighteen schools spanning elementary, middle, and high school levels. Projects will be funded by the City's Revolving Fund, which the City Council created in 2022.



Providence  
Schools



STUDIO  
JAED

## RIDE Stage II

### **Projects**

Kizirian Prk-8 Gymnasium Renovation & Site Work

Districtwide 5 Year Capital Improvement Plan

Times2 Academy

## RIDE Stage II

### Funding

The 2025 Stage II is not seeking funding (i.e. bond) for the 5-year capital improvement projects and will utilize the City Council's revolving fund for reimbursement (up to 91%) through 2030.

### Order of Magnitude Costs

Kizirian ES Gymnasium Renovation & Site Work	\$20M
Districtwide 5 Year Capital Improvement Plan	\$50M
Times2 Academy (funding T2A budget)	\$10M
	Total \$80M

## RIDE Stage II

# Kizirian ES Gymnasium Renovation & Site Work

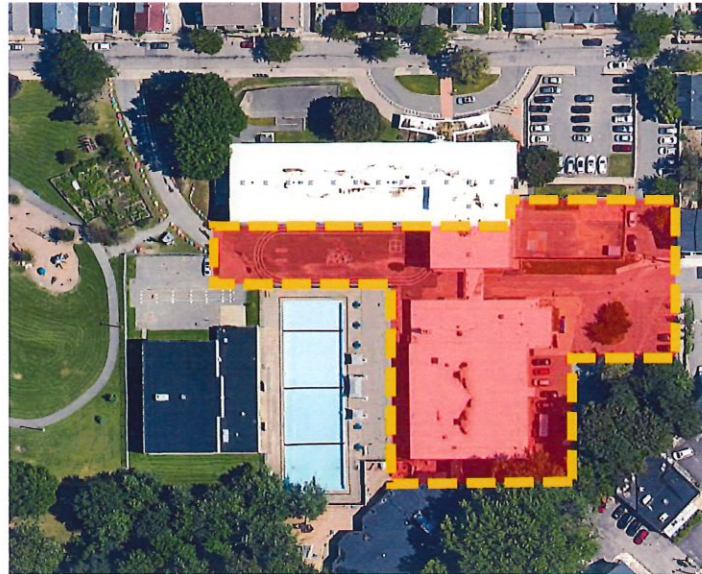

Existing to be Renovated

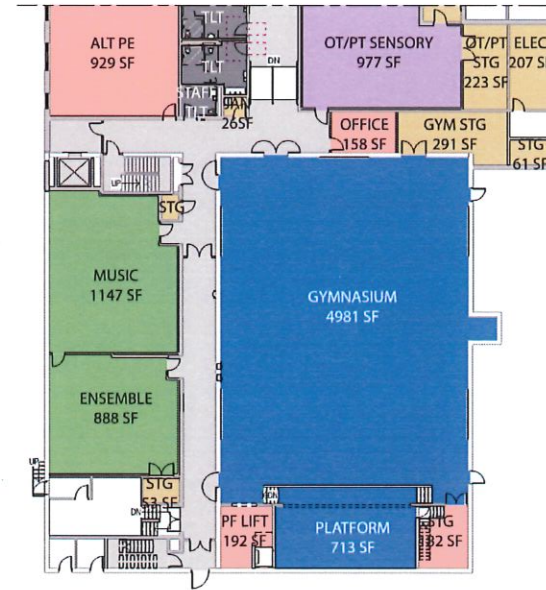

First Floor

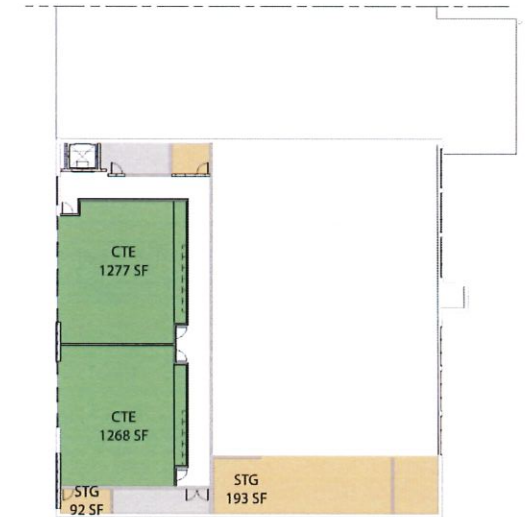

Second Floor

## RIDE Stage II

### **Districtwide 5 Year Capital Improvement Plan**

Total District Need is approx. \$350M

Elementary Schools \$175M

Middle Schools \$80M

High Schools \$95M

## RIDE Stage II

### **Districtwide 5 Year Capital Improvement Plan**

Proposed Scope of Work is Approx. \$10M / year (Five Years)

Elementary Schools      \$25M

Middle Schools          \$5M

High Schools             \$20M

RIDE Stage II

## **Districtwide 5 Year Capital Improvement Plan**

Protect Types

Teaching & Learning Excellence

Student & Staff Well-Being

Resource Management

Family & Community Engagement

## RIDE Stage II

# Districtwide 5 Year Capital Improvement Plan

The proposed projects focus on:

- **Critical infrastructure improvements** – mechanical, electrical, plumbing, structural systems, and building envelope repairs.
- **Life safety compliance** – addressing fire code deficiencies and security upgrades, including cameras and access control.
- **Learning environment enhancements** – classroom and specialty space renovations to support STEAM, SEL, and CTE programming, along with improvements to art, music, and physical education spaces.
- **Site and environmental upgrades** – pedestrian, vehicular, and athletic improvements that promote safety and accessibility.

## RIDE Stage II

### Districtwide 5 Year Capital Improvement Plan

The funding is allocated across the following schools:

	Amount
Feinstein Elementary at Sackett Street	\$2,441,406
George West Elementary	\$6,535,638
Leviton Dual Language School	\$1,826,381
Reservoir Avenue Elementary	\$2,113,477
Robert L. Bailey Elementary	\$4,514,878
Veazie Street Elementary	\$4,742,897
Young & Woods Elementary	\$2,572,392
Webster Avenue Elementary	\$3,402,897
Esek Hopkins Middle	\$1,728,701
Nathan Bishop Middle	\$1,617,018
Central High	\$2,742,169
Classical High	\$3,408,691
Dr. Jorge Alvarez High	\$2,484,027
E-Cubed Academy	\$3,120,333
Hope High	\$3,309,889
Juanita Sanchez Complex	\$2,339,116
Providence Career & Technical Academy	\$1,100,092

The SBC may make adjustments on annual basis based on specific needs or funding determined by the city & PPSD.

## RIDE Stage II

### **Harry Kizirian Prk-8**

Harry Kizirian Prk-8 – \$19,978,500- supplementary funding for additional scope in the Phase III project.

## RIDE Stage II

### **5 Year Capital Improvement Plan – Times 2 Academy**

Times2 Academy – \$9,514,805- Times2 will allocate this funding for improvements to their school building. Including their scope of work in this Stage 2 will allow them to seek reimbursement from RIDE.

Times 2 will be self funded – no CRF, city or PPSD funding.