



HARRY F. CURVIN
SPEAKER

State of Rhode Island and Providence Plantations

House of Representatives

May 12, 1961

Mr. D. Everett Whelan
City Clerk
City Hall
Providence, Rhode Island

Dear Sir:

Thank you for forwarding to me a copy of Resolution No 305 urging the General Assembly to enact legislation abolishing price control on milk.

I shall call your resolution to the attention of the House and have it referred to the Agriculture Committee which is considering such legislation.

Very truly yours,

Harry F. Curvin
Harry F. Curvin
Speaker

HFC:g

IN CITY COUNCIL
MAY 18 1961

READ:

WHEREUPON IT IS ORDERED THAT
THE SAME BE RECEIVED.

Vincent Vespa
ACTING CLERK



CITY OF PROVIDENCE - RHODE ISLAND - Walter H. Reynolds, Mayor

TRAFFIC ENGINEERING DEPARTMENT

ROGER T. CHANDLER
Traffic Engineer
JOHN I. LOGAN
Assistant Traffic Engineer

147 Fountain Street
Providence 3, R. I.

May 16, 1961

Honorable City Council
City Hall
Providence, Rhode Island

Gentlemen:

We have completed our investigation which you requested concerning the need for "YIELD" control at the intersection of Ada Avenue and Hunnewell Avenue.

Our study showed very low volumes on both of these streets. Also, there have been no reported accidents at this intersection for the past 10 years. Therefore we do not recommend the installation of "YIELD" signs at this location.

Very truly yours,

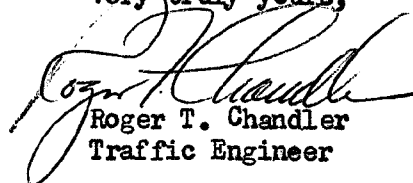
Roger T. Chandler
Traffic Engineer

RTC:cb

IN CITY COUNCIL

MAY 18 1961

READ:

WHEREUPON IT IS ORDERED THAT
THE SAME BE RECEIVED.

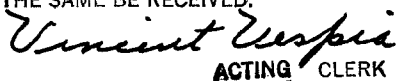
ACTING CLERK

1

FILED

MAY 18 9 27 AM '61

CITY CLERK'S OFFICE
PROVIDENCE, R. I.

1

5-2-61

333
REPORT OF THE CITY MESSENGER

For the month of M A R C H
1961

To the Honorable the City Council of the City of Providence:

Complying with the provisions of the City Ordinances the undersigned reports to your honorable body the following statement of "the expenditures and liabilities incurred in the care and superintendence of the City Hall and adjacent sidewalks," for the months of

For lighting City Hall,.....	\$ 928.65
" power,.....	243.93
" fuel,.....	1,384.71
" pay-roll of clerks, engineer, fireman, janitors, elevator men, watchman, etc.,.....	7,372.75
" supplies,	410.85
" salary of City Sergeant and Deputy,	1,096.20
" new furniture,.....	
" furnishings and repairs,.....	
" telephone service, excess calls.....	2,732.19
Rental - 112 Union Street	<u>1,000.00</u>
	\$15,169.28

IN CITY COUNCIL

MAY 18 1961

READ:

WHEREUPON IT IS ORDERED THAT
THE SAME BE RECEIVED.

Vincent Vespia
ACTING CLERK

Respectfully submitted,

J. H. Crowley

City Sergeant
Acting as City Messenger.

FILED

MAY 8 3 58 PM '61

CITY CLERK'S OFFICE
PROVIDENCE, R.I.

City of Providence
DEPARTMENT OF MILK INSPECTION
C. V. Chapin Hospital
153 Eaton Street, Providence, R.I.

May 18, 1961

To the Honorable The City Council of the City of Providence, Gentlemen:

The following list of individuals, firms, companies, corporations, etc., with the approval of the Inspector of Milk, respectfully request licenses to sell milk, cream and skimmed milk in the City of Providence.

IN CITY COUNCIL

MAY 18 1961

READ AND GRANTED

Vincent Vespia
ACTING CLERK

Respectfully submitted,

Joseph Smith
Joseph Smith, M. D.
Inspector of Milk

941 SUNNYBROOK FARM
d/b/a CLOVERLY FARM
301 Taunton Avenue
Seekonk, Mass.

942 BETTY'S DIET
PETER A. CALISE
471 Allens Avenue
Providence, R.I.

943 ZUCHOWSKI-NEWS STORE
912 Branch Avenue
Providence, R.I.

944 SUNNYBROOK FARM
1032 Branch Avenue
Providence, R.I.

945 LEO'S MARKET
LEO APOSHIAN
1421 Broad Street
Providence, R.I.

946 DRISCOLL & LANE, INC.
1485 Broad Street
Providence, R.I.

947 F. RAYMOND LANE
1485 Broad St.
Providence, R.I.

948 JIMMY'S PIZZERIA
286 Brook Street
Providence, R.I.

949 RICHARD HANOLAN
130 Calverley Street
Providence, R.I.

950 BLUE RIBBON BEEF, INC.
71 Camp Street
Providence, R.I.

- 951 SUNNYBROOK FARM
185 Camp Street
Providence, R.I.
- 952 PETER PONTARELLI
PIZZA WORLD
578 Chalkstone Avenue
Providence, R.I.
- 953 CALISE'S FRUIT & VARIETY
1280 Chalkstone Avenue
Providence, R.I.
- 954 THE NEW TRIANGLE DINER, INC.
10 Charles Street
Providence, R.I.
- 955 KALIAN'S SUPER MARKET
124 Charles Street
Providence, R.I.
- 956 GEORGE MARRINOS
Alpha Lunch
142 Charles St.
Providence, R.I.
- 957 CHARLES ST. PHARMACY
VINCENT DI NICOLA
592 Charles Street
Providence, R.I.
- 958 SUNNYBROOK FARM
632 Charles Street
Providence, R.I.
- 959 LEPORE'S MARKET
824 Charles Street
Providence, R.I.
- 960 COLE AVENUE PHARMACY
195 Cole Avenue
Providence, R.I.
- 961 Mary Cusick
26 Common St.
Prov., R.I.
- 962 COURTNEY'S INC.
88 Dorrance Street
Providence R.I.
- 963 ANTHONY MERLINO
901 Douglas Ave.
Providence, R.I.
- 964 OSCAR'S LOUNGE
950-954 Eddy Street
Providence, R.I.
- 965 Federal Products Corp. #1
1144 Eddy St.
Prov., R.I.
- 966 GAETANO MARCOGLIESE
178 Elmwood Avenue
Providence, R.I.
- 967 LIL'S DINETTE
751 Elmwood Avenue
Providence, R.I.
- 968 AL NIO'S CAFE
50 - 56 Hartford Avenue
Providence, R.I.
- 969 ANTONIO SPAZIANO
103 Hawkins Street
Providence, R.I.
- 970 MILTON H. BLOOM
99 Hope Street
Providence, R.I.
- 971 Mee-Fong Restaurant
772 Hope Street
Providence, R.I.
- 972 LES PETITS FOURS, INC.
BENJAMIN WEISS, PRES.
959 Hope Street
Providence, R.I.
- 973 NARRAGANSETT FOOD SERVICE, INC.
73 Ives Street
Providence, R.I.
- 974 LONG ISLAND LUNCH
MILDRED REBELLO
99 Ives Street
Providence, R.I.
- 975 ALFRED DI FIORE
67 Knight Street
Providence, R.I.
- 976 ANGELA DE FUSCO
167 Ledge Street
Providence, R.I.
- 977 DE CESARE'S MARKET
EDWARD DE CESARE
188 Ledge Street
Providence, R.I.
- 978 FEDERAL PRODUCTS CORP.
35 Oxford Street
Providence, R.I.
- 979 SUNNYBROOK FARM
241 Union Avenue
Providence, R.I.
- ~~NARRAGANSETT FOOD SERVICE, Inc.~~
~~73 Ives Street~~
~~Providence, R.I.~~

RECEIVED
MAY 19 2 57 PM '61
CITY CLERK'S OFFICE
PROVIDENCE, R.I.

SEMI-ANNUAL REPORT

OF THE

CITY TREASURER

OF THE

**CITY OF PROVIDENCE
RHODE ISLAND**

March 31, 1961



INDEX

Exhibit A—General Fund—Statement of Cash Receipts and Disbursements for six months ending March 31, 1961.

Exhibit B—School Fund—Statement of Cash Receipts and Disbursements for six months ending March 31, 1961.

Exhibit C—Statement of Trust and Special Funds, March 31, 1961.

Exhibit D—Capital Fund, Statement of Cash Receipts and Disbursements for six months ending March 31, 1961.

Exhibit E—Statement of Net Debt, March 31, 1961.

THE CITY OF PROVIDENCE

CITY TREASURER'S REPORT
March 31, 1961

TO THE HONORABLE THE CITY COUNCIL:

The undersigned, herewith presents a report of the cash transactions and/or balances of all funds together with a report of net debt, March 31, 1961.

Respectfully submitted,

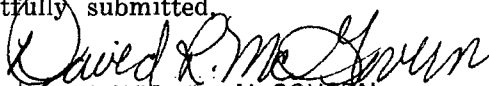
DAVID R. MCGOVERN

~~_____
City Treasurer~~

IN CITY COUNCIL
MAY 18 1961

READ:

WHEREUPON IT IS ORDERED THAT
THE SAME BE RECEIVED.

ACTING CLERK

EXHIBIT A**CITY OF PROVIDENCE****GENERAL FUND****Statement of Cash Receipts and Disbursements for
Six Months Ending March 31, 1961**

Cash Balance, October 1, 1960.....		<u>\$ 1,501,342.88</u>
Cash Receipts:		
Revenue Receipts	\$22,407,637.07	
Non-Revenue Receipts	22,440.92	
Investments Sold	<u>4,994,928.89</u>	<u>27,425,006.88</u>
		<u>\$28,926,349.76</u>
Cash Disbursements:		
Revenue Payments	\$17,531,527.41	
Liquidation of Prior Year Encum- brances	684,177.09	
Reserve for Revenue for Extraordi- nary Expenditures of year 1960- 1961	121,845.00	
Non-Revenue Payments:		
Transferred to Water Works, De- preciation and Extension Fund..	15,000.00	
Transferred to Commissioners of Sinking Funds	317,677.19	
Investments Purchased	7,994,928.89	
Others	<u>111,509.45</u>	<u>26,776,665.03</u>
CASH BALANCE, March 31, 1961.....		<u><u>\$ 2,149,684.73</u></u>
Note—General Fund Investments on Cer- tificate of Deposit due April 27, 1961		\$ 3,000,000.00

EXHIBIT B**CITY OF PROVIDENCE****SCHOOL FUND****Statement of Cash Receipts and Disbursements for
Six Months Ending March 31, 1961**

Cash Balance, October 1, 1960.....		\$ 971,474.56
Cash Receipts:		
Revenue Receipts	\$ 4,500,000.00	
Appropriation Receipts	1,463,807.36	
Non-Revenue Receipts		5,963,807.36
		<hr/>
		\$ 6,935,281.92
Cash Disbursements:		
Revenue Payments	\$ 5,992,208.28	
Non-Revenue Payments		
Liquidation of Prior Year Encum-		
brances	834,221.56	6,826,429.84
		<hr/>
CASH BALANCE, March 31, 1961.....		\$ 108,852.08
		<hr/>

CITY OF PROVIDENCE

Statement of Trust and Special Funds, March 31, 3961

EXHIBIT C

	Cash	Investments	Real Estate	Total Fund
American Federation State County & Municipal Employees A.F.L. Local #278	\$ 3.00			\$ 3.00
Anthony, Senator Henry B.—Prize Fund	0.00	\$ 3,000.00		3,000.00
Anthony, Henry B.—Public Fountain Fund	5,218.94			5,218.94
Automobile Accident Insurance	2,231.92	20,000.00		22,231.92
Barnes, Ellen R.—Trust Fund	1,908.43			1,908.43
Bragunn, Mary Swift—Fund	379.47	3,000.00		3,379.47
Central Purchasing Revolving Fund	20,943.96			20,943.96
City Licenses Due State	104.10			104.10
Danforth Street Recreation Rentals	851.17			851.17
Danforth Street School Rentals	2,021.74			2,021.74
Davis Park Playground	33,795.30			33,795.30
Deposit and Refund	26,765.25			26,765.25
Dexter Donation Trust Fund	448.98	393,000.00	158,590.00	552,038.98
Dexter Donation Trust Fund Income	3,139.59	46,940.80		50,080.39
Dexter, Ebenezer Knight Trust Fund, City of Providence, Trustee—	500.86	1,011,271.36		1,011,772.22
Dexter, Ebenezer Knight Trust Fund, City of Providence, Trustee—	8,247.97	87,000.00		95,247.97
Income Acct.	1,178.70			1,178.70
Dog Licenses	31,958.75			31,958.75
Employees' Defense Savings Account	717,018.98	(B)23,053,561.42		23,770,580.40
Employees' Retirement System	1,464.18			1,464.18
Employees Retirement System of State of Rhode Island	866.00			866.00
Employees Suggestion Awards	291,110.61			291,110.61
Employees' Withholding Tax	514.40	19,000.00		19,514.40
Fire Insurance Fund	168.75	100,000.00		100,168.75
Gould, Elizabeth Angell	3,107.31			3,107.31
Gould, Elizabeth Angell—Fund Income	0.00	5,000.00		5,000.00
Gould, Marshall H.—Fund	1,875.56			1,875.56
Gould, Marshall H.—Fund Income	24,660.24			24,660.24
Hospital Service Corporation of Rhode Island	7,052.35			7,052.35
King, Abby A.—Trust Fund	5,345.35	11,210.28		18,262.63
King, Abby A. Trust Fund Income				5,345.35

Local #799 International Association Fire Fighters.....	3.00		3.00
Local #1339 School Clerks Union.....	144.00		144.00
Lippitt, Louisa G. Fund.....	24,825.16		24,825.16
Lower South Providence Recreation.....	171.18		171.18
Lower South Providence School Rents.....	630.00		630.00
Man, Anna H.—Trust Fund.....	9,064.02	247,600.00	297,924.02
Man, Anna H.—Trust Fund Income.....	6,033.26		6,033.26
Municipal Docks Promotion.....	1,270.34		1,270.34
Municipal Garage Revolving.....	19,202.69		19,202.69
New Water Main Account.....	0.00		0.00
North Burial Ground.....	3,403.75		3,403.75
North Burial Ground—Perpetual Care Fund.....	1,882.35	600,786.61	602,668.96
North Burial Ground—Perpetual Care Fund Income.....	5,172.57		5,172.57
Police Pistol Range.....	6,704.26		6,704.26
Potter, Gladys—Trust Fund.....	0.00	11,000.00	11,000.00
Potter, Gladys—Trust Fund Income.....	137.50		137.50
*Premium on Bonds Issued.....	26,536.18	20,000.00	46,536.18
Prospect Terrace Plant Fund.....	482.00		482.00
Providence Civilian Defense Council.....	19,509.65		19,509.65
Providence Junior Fire Dept. Program.....	1,997.87		1,997.87
Providence Junior Police Camp.....	7.72		7.72
Providence Lodge #3, Fraternal Order Police.....	1.00		1.00
Public School Estates—Revolving Fund.....	12,559.94		12,559.94
Public Works—Highways—Curbs.....	46,012.58		46,012.58
Public Works—Highway Grading.....	6,242.69		6,242.69
Public Works Construction and Maintenance Equipment Shop and Stores Revolving Fund.....	129,993.84		129,993.84
Public Works Sanitation Equipment Shop and Store Revolving Fund.....	84,949.14		84,949.14
Public Works Sewer Construction and Maintenance Equipment Shop and Stores Revolving Fund.....	24,276.28		24,276.28
Real Estate Sales Proceeds.....	39,938.40		39,938.40
Real Estate Sales Proceeds—Water.....	0.00		0.00
Redevelopment Transfer Fund.....	0.00		0.00
Reserve for Social Security Taxes.....	83,809.69		83,809.69
Roberts Expressway—Property Owners' Escrow Funds.....	170.91		170.91
School Committee Special Memorial.....	7,346.19		7,346.19
Sewer Fees—Lubec Street.....	913.16		913.16
Sharpe, Mary Elizabeth Plant Fund.....	100.00		100.00
Sinking Fund.....	125,106.80	12,068,474.86	12,193,581.66

CITY OF PROVIDENCE
Statement of Trust and Special Funds, March 31, 3961

	Cash	Investments	Real Estate	Total Fund
	\$	\$ (A) 5,146.58	\$(C) 942,490.00	\$
Smith, Charles H.—City of Providence Trustee u/w.....	98,978.89			1,046,615.47
Smith, Charles H.—Revolving Fund.....	5,025.00			5,025.00
Smith, Charles H.—Trust Fund.....	0.00	1,000.00		1,000.00
Smith, Charles H.—Trust Fund—Roger Williams Park.....	3,558.09			3,558.09
Smith, Charles H.—Trust Fund—Roger Williams Park Unalloted Income.....	0.00			0.00
Smith, Charles H.—Trust Fund Income.....	75.00			75.00
Special Assessments Highway—Curbing—Grading.....	17,748.45			17,748.45
State Sales Tax, Water.....	14,039.32			14,039.32
Tillinghast Donation.....	26.00	174.00		200.00
Tillinghast Donation Income.....	1.25			1.25
Tingley, Samuel H.—Trust Fund.....	400.00	99,600.00		100,000.00
Tingley, Samuel H.—Trust Fund Income.....	13,710.48			13,710.48
Unclaimed Estates.....	31,640.60	124,000.00		155,640.60
Unclaimed Estates Fund Income.....	1,737.20			1,737.20
United Fund Inc.	149.27			149.27
Valley View Housing Reserve.....	11,261.57	137,000.00		148,261.57
Vinton, Emmeline Owen Fund.....	520.80			520.80
Vinton, Emmeline Owen Fund Income.....	140.59			140.59
Vinton, Frederick Arnold, M.D. Fund.....	520.80			520.80
Vinton, Frederick Arnold, M.D., Fund Income.....	140.61			140.61
Water Stores Revolving Fund.....	17,722.25			17,722.25
Water Works Depreciation and Extension.....	1,325.56	354,000.00		355,325.56
TOTALS	\$2,100,101.71	\$38,421,765.91	\$1,142,340.00	\$41,664,207.62

- (A) Trust Deposit with Rhode Island Hospital Trust Co.
 (B) Includes Loans to Employees in the amount of \$289,547.97.
 (C) Includes Unsettled condemnation claims on property \$25,610.00

*For Retirement of Bonded Debt.

EXHIBIT D

CITY OF PROVIDENCE
CAPITAL FUND

March 31, 1961

	Cash Balance Sept. 30, 1960	Receipts	Totals	Disbursements	Cash Balance Sept. 31, 1961
Alterations Neutaconkanut Pumping Station.....	\$14,491.00	\$ 0.00	\$ 14,491.00	\$ 14,491.00	0.00
Capital Debt Fund.....	0.00	683.12	683.12	0.00	683.12
City Council Chamber.....	18,000.00	0.00	18,000.00	0.00	18,000.00
Classical High School Fire Damage Fund I.....	33.09	0.00	33.09	33.09	0.00
Classical High School Fire Damage Fund II.....	400.34	0.00	400.34	400.34	0.00
Danforth Street School.....	48,283.73	185,000.00	223,283.73	230,770.39	2,513.34
Debt Service Willard Center II.....	43,778.42	0.00	43,778.42	43,778.42	0.00
Downtown Area Project D-2.....	597.84	2,132.48	2,730.32	364.01	2,366.31
Dutch Elm Disease Control.....	14,459.16	6,543.68	21,002.84	0.00	21,002.84
East Side Renewal.....	0.00	10,500.00	10,500.00	10,091.25	408.75
Erco Real Estate Purchase.....	2,500.00	0.00	2,500.00	2,500.00	0.00
Extension To Municipal Dock at Fields Point.....	19,529.42	188,500.00	208,029.42	206,909.27	1,120.15
Garage Incinerator Turbines Repair.....	280.80	0.00	280.80	0.00	280.80
1956 Highway.....	11,905.94	0.00	11,905.94	8,102.66	3,803.28
1956 Highway West River Highway.....	93,203.30	0.00	93,203.30	2,500.00	90,703.30
1958 Highway.....	10,508.43	65,000.00	75,508.43	65,102.25	10,406.18
Highway Special IV.....	0.00	39,797.38	39,797.38	0.00	39,797.38
Hurricane Barrier.....	430.26	387,000.00	387,430.26	384,146.99	3,283.27
Inserting New Valves.....	4,911.07	0.00	4,911.07	0.00	4,911.07
Joslin Street School.....	2,765.01	0.00	2,765.01	1,000.00	1,765.01
Land Purchase at Barden Reservoir.....	0.00	17,000.00	17,000.00	0.00	17,000.00
Mashapaug Pond.....	751.65	3,284,077.78	3,284,829.43	3,277,660.01	7,169.42
Miscellaneous Water Works Depreciation and Extension.....	22,041.71	0.00	22,041.71	10,190.82	11,850.89
Modernizing School Buildings I.....	480.78	0.00	480.78	480.78	0.00
Modernizing School Buildings II.....	16,625.31	0.00	16,625.31	0.00	16,625.31
Modernizing School Buildings III.....	16,889.86	1,000,520.83	1,017,410.69	1,012,402.92	5,007.77
Modernizing School Buildings IV.....	22,159.23	185,000.00	207,159.23	184,872.68	22,286.55
Municipal Garage Warehouse.....	907.01	0.00	907.01	26.90	880.11
Off Street Parking Facilities in Providence.....	13,777.09	3,859.71	17,636.80	4,085.21	13,551.59

CITY OF PROVIDENCE
CAPITAL FUND

March 31, 1961

	Cash Balance Sept. 30, 1960	Receipts	Totals	Disbursements	Cash Balance Sept. 31, 1961
Pitometer Survey	0.00	15,000.00	15,000.00	0.00	15,000.00
Premium on Bonds and Accrued Interest	0.00	29,203.10	29,203.10	29,203.10	0.00
Public Works Garage	23,925.07	0.00	23,925.07	0.00	23,925.07
Public Works Highway Office Building and Garage	5,320.71	1,115,377.60	1,120,698.31	923,398.09	197,300.22
Recreation II	40,402.89	0.00	40,402.89	10,088.05	30,314.84
Recreation III	33,785.44	20,000.00	53,785.44	40,807.94	12,977.50
Reconstruction Oaklawn Ave.	552.27	0.00	552.27	552.27	0.00
Redevelopment Act of 1956 for Lead Tract and Appurtenances— West River	40,950.00	0.00	40,950.00	15,926.64	25,023.36
Redevelopment Act of 1956, No. II	428.04	3,145,802.09	3,146,230.13	3,134,195.46	12,034.67
Roberts Expressway	93,365.28	0.00	93,365.28	0.00	93,365.28
School Athletic Fields	666.17	1,500.00	2,166.17	1,035.71	1,130.46
School Building Administration Fire Damage	282.78	0.00	282.78	282.78	0.00
Sewage Treatment Plant Loan I	79,374.87	0.00	79,374.87	0.00	79,374.87
Sewage Treatment Plant Loan II	31,585.80	0.00	31,585.80	1,495.64	30,090.16
Sewage Treatment Account	201,351.87	0.00	201,351.87	47,027.06	154,324.81
1956 Sewer	22,055.37	49,000.00	71,055.37	69,469.29	1,586.08
Slum Clearance and Redevelopment No. III	0.00	5,153,802.08	5,153,802.08	5,152,500.00	1,302.08
Slum Clearance and Redevelopment No. IV	0.00	10,500.00	10,500.00	10,500.00	0.00
South Providence School No. I	160.00	0.00	160.00	0.00	160.00
South Providence School No. II	68,187.48	201,000.00	269,187.48	261,221.76	7,965.72
Traffic Signal Installation	7,003.13	0.00	7,003.13	0.00	7,003.13
Water Distribution Reservoir	8,616.66	597,000.00	605,616.66	603,074.20	2,542.46
Water Purification Works Improvement I	29,858.80	355,000.00	384,858.80	378,036.73	6,822.07
Water Purification Works Improvement II	2,081.66	500.00	2,581.66	2,230.44	351.22
Water Purification Works Improvement III	313,899.28	66,000.00	379,899.28	372,927.86	6,971.42
TOTALS	\$1,383,564.02	\$16,135,299.85	\$17,518,863.87	\$16,513,882.01	\$1,004,981.86

EXHIBIT E**CITY OF PROVIDENCE****Statement of Net Debt
March 31, 1961**

	Notes	Bonds	Total
Gross Debt, Oct. 1, 1960.....	\$ 7,135,638.86	\$52,319,500.00	\$59,455,138.86
Additions	5,753,500.00	6,900,000.00	12,653,500.00
	<hr/>	<hr/>	<hr/>
	\$12,889,138.86	\$59,219,500.00	\$72,108,638.86
Reductions	6,998,332.00	1,384,000.00	8,382,332.00
	<hr/>	<hr/>	<hr/>
Gross Debt, Mar. 31, 1961	\$ 5,890,806.86	\$57,835,500.00	\$63,726,306.86
Sinking Fund, Premium, Valley View Housing and Capital Debt Fund...	12,389,062.53	12,389,062.53
	<hr/>	<hr/>	<hr/>
Net Debt, Mar. 31, 1961.....	\$ 5,890,806.86	\$45,446,437.47	\$51,337,244.33
	<hr/>	<hr/>	<hr/>

Composition of Net Debt

General City Debt	\$ 5,890,806.86	\$45,446,437.47	\$51,337,244.33
*Water Debt	1,806,418.34	1,806,418.34
	<hr/>	<hr/>	<hr/>
Totals	\$ 5,890,806.86	\$43,640,019.13	\$49,530,825.99

*To be retired by Water Department Earnings and Investments.

REPORT

OFF-STREET PARKING FACILITY
(Fountain, Eddy, Worcester)

* * *

May 15, 1961



CITY OF PROVIDENCE - RHODE ISLAND - Walter H. Reynolds, Mayor

EXECUTIVE DEPARTMENT

CITY HALL

May 15, 1961

The Honorable City Council
City Hall
Providence, Rhode Island

Gentlemen:

We are pleased to submit to your Honorable Body, with a recommendation for action, a report on the proposed purchase for off-street parking purposes of the land and buildings located on Assessors Plat 25, lot 145, bordering on Fountain, Eddy, and Worcester Streets, in accordance with the provisions of Chapter 121 of the Public Laws of 1960, Article III, Section 8.

Very truly yours,

Walter H. Reynolds
Mayor of Providence

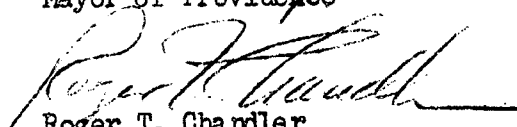
Roger T. Chandler
Traffic Engineer

RTC:gd

IN CITY COUNCIL

MAY 18 1961

READ:

WHEREUPON IT IS ORDERED THAT
THE SAME BE RECEIVED.

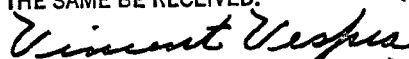
ACTING CLERK

FILED

MAY 16 11:00 AM '61

CITY CLERK'S OFFICE
PROVIDENCE, R. I.

REPORT ON PROPOSED PARKING FACILITY

(Blocks Bounded by Fountain, Eddy, and Worcester Streets)

The parking problem in Providence was studied through a comprehensive parking survey conducted in 1945 through the cooperative efforts of the Rhode Island Department of Public Works, Highway Planning Section and the Bureau of Public Roads of the United States Department of Commerce. A report on the results of this survey was published by the Rhode Island Department of Public Works in 1946, copies of which are on file in the office of the City Plan Commission and the Traffic Engineering Department.

In 1950, the City Plan Commission, in collaboration with the Redevelopment Agency and the Traffic Engineer, published a report entitled "Parking in Downtown Providence." This report comprised a general plan for automobile parking facilities in the Providence Central Business District. The report was published in September 1950, and copies were filed with the City Clerk and distributed at that time.

During 1959 and 1960 the City Plan Commission, in collaboration with the Traffic Engineer and others, formulated a Downtown Master Plan which was presented to the public on May 3, 1960. This Master Plan included a general plan of automobile parking facilities. The accompanying letter signed by Mr. Edward Winsor, Chairman of the City Plan Commission, indicates that the parking facility proposed in this report is in conformance with the general plan as required by Sections 3 and 8 of Article III of Chapter 121 of the Public Laws of 1960, "An Act Providing for Off-Street Parking Facilities in the City of Providence."



City Plan Commission

EDWARD WINSOR, *Chairman*
JERRY LORENZO RALPH MATERA

WALTER H. REYNOLDS, *Mayor*
LUCIO E. CARLONE, *Secretary*

PAUL A. SAN SOUZI, *Vice Chairman*
RAYMOND J. NOTTAGE HARRY PINKERSON

FRANK H. MALLEY, *Director*
DIETER HAMMERSCHLAG, *Chief Planner*

*Suite 103, City Hall,
Providence 3, Rhode Island*

May 9, 1961

The Honorable Walter H. Reynolds, Mayor
The Honorable City Council of the
City of Providence
City Hall
Providence, Rhode Island

SUBJECT: Purchase of land on Fountain, Eddy and Worcester Streets
for parking purposes

Gentlemen:

In connection with the Off-Street Parking Plan, submitted by the Traffic Engineer, this is to report that this Off-Street Parking Plan is in conformity with the General Plan and also with the Downtown Master Plan, developed by the City Plan Commission in collaboration with the Traffic Engineer, in accordance with provisions of Article 3 Section 3 of the Providence public parking act; and that the City Plan Commission at a meeting today Voted: to recommend approval and execution of this Plan as being necessary in the public interest.

Very truly yours,

EDWARD WINSOR
CHAIRMAN
CITY PLAN COMMISSION

EW:MMC

The inventory of off-street and on-street parking in the downtown area has been maintained on a current basis to reflect all changes that have been made, including all new facilities, as well as the loss of any spaces to other land uses. During the past fifteen years there have been a significant number of such changes in land use by private developments of one form or another, in addition to the loss of approximately 2,800 spaces for construction of the North-South Freeway.

While the total number of spaces in public off-street parking lots has changed from 5,091 in 1945 to 7,233 as of January 1961 for an increase of 2,142 spaces, 1,929 of these spaces were created by the City of Providence or by the combined effort of the City working with other interests. These 1,929 spaces are accounted for in three facilities---Pershing Square Parking Plaza (334 metered spaces), Park N' Lock (1,500 spaces), and the Francis Street Parking Deck (95 spaces)--all three being located on the northwesterly edge of the Central Business District.

This means that while commercial parking lot operators and private investors have made substantial contributions to the downtown area in the creation of several improved parking structures during the past fifteen years, the effect in terms of the total number of parking spaces provided has been primarily one of changing land uses and improvement of the type of facility provided, without any significant increase in the total number of parking spaces. Therefore, in the public interest and for the economic welfare of the citizens of Providence it becomes necessary that the supply of off-street parking spaces continues to be increased at every opportunity. These increases should also be made to assure the continued high valuation of the Central Business District, and to assure the creation and continuation of conveniently located off-street parking facilities.

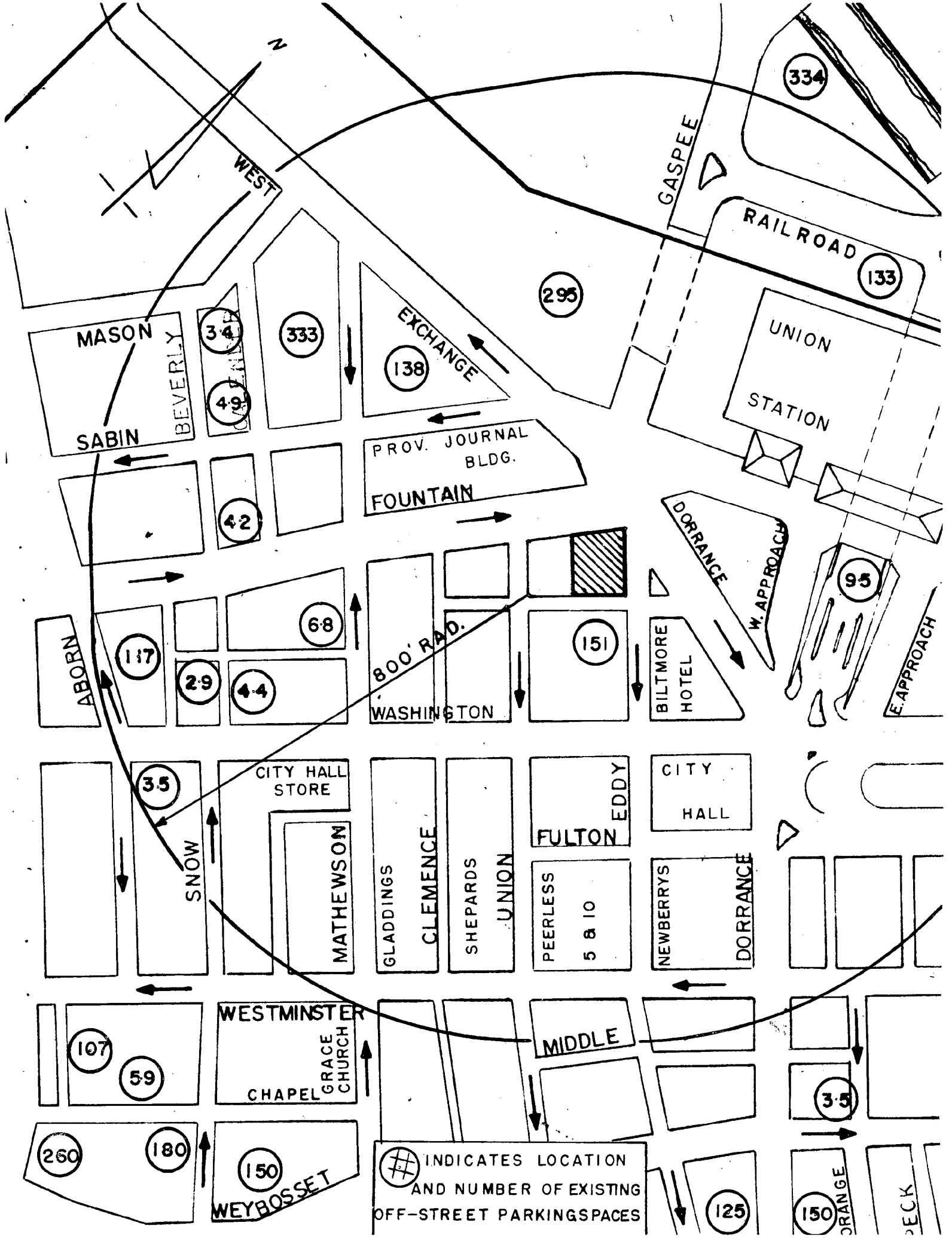

⊞ INDICATES LOCATION
AND NUMBER OF EXISTING
OFF-STREET PARKING SPACES

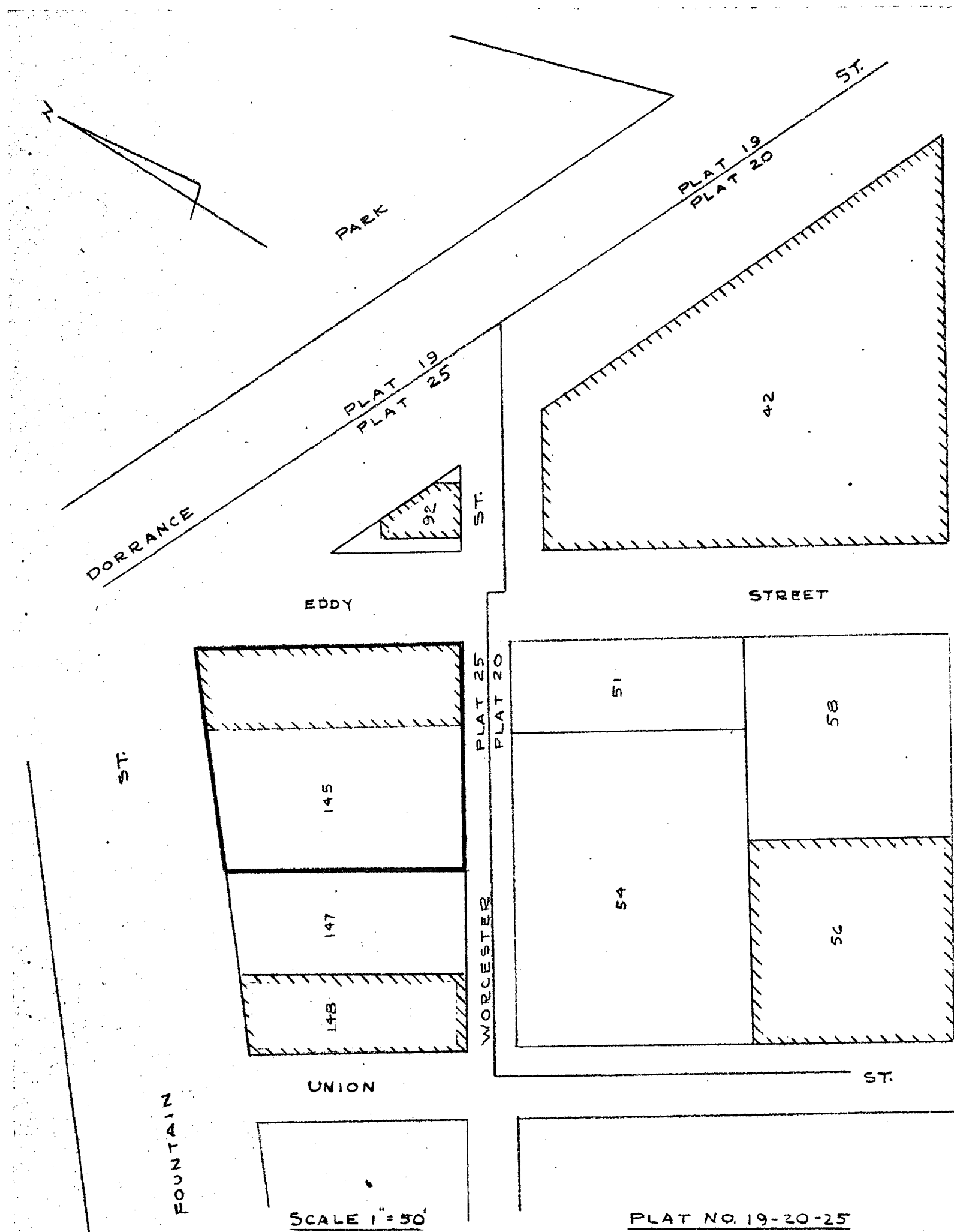

The locations of the several major parking facilities included as part of the general parking plan in the Downtown Master Plan were selected as being those locations which best serve the Central Business District in its present form and in the future. One of the locations shown on the Master Plan is the area bounded by Fountain, Eddy, Washington, and Union Streets. The land comprising Assessors Plat 25, lot 145 is a part of this larger tract, and is now used as the New England Bus Terminal Building and a part of the bus terminal yard area.

As another part of the Downtown Master Plan it is proposed to relocate and build a new bus terminal facility. The bus company operators and IMPACT R. I., Inc., are actively arranging for the early construction of such a new bus terminal. The present lease between the bus company operators and the terminal building owners is due to ~~expire~~ this year. Since this building was constructed for use as a bus terminal, its adaptability to other uses without major modifications is very limited. The present building owners, being aware of the general parking plan and the fact that the major parking facility proposed for this area includes their land and building, are willing to sell this property to the City of Providence at this time.

It is, therefore, proposed that the City of Providence acquire the land and buildings on Assessors Plat 25, lot 145 bordering on Fountain, Eddy, and Worcester Streets for off-street parking purposes.

An option to purchase the land and buildings contained on plat 25, lot 145 has been obtained, and the stipulated purchase price is \$305,000.00. The land is presently assessed for \$208,500.00 and the building for \$52,808.00 for a total assessment of \$261,308.00. The lot includes an area of 11,915 square feet.

The present leasees pay an annual rental of \$36,000.00. The leases expire on September 30, 1961, and will be subject to renewal negotiation at that time. As soon as the new terminal is completed and this building becomes vacant, it is proposed that the present building be razed, and the resulting lot used for off-street parking purposes, pending acquisition of the remainder of the land needed for the construction of the proposed parking garage.

If the entire lot area were to be used for off-street parking with an attendant operating the lot, a total of 50 vehicles could be parked. If the lot were to be metered, a total of 37 spaces could be made available.

73-2-11

MAY 16 11 00 AM '61

CITY CLERK'S OFFICE
PROVIDENCE, R.I.