

THE CITY OF PROVIDENCE  
STATE OF RHODE ISLAND AND PROVIDENCE PLANTATIONS

RESOLUTION OF THE CITY COUNCIL

No. 48

Approved January 28, 1977

BE IT RESOLVED, That

1. The Board of Contract and Supply is hereby authorized on behalf of the City of Providence to purchase from the Providence Redevelopment Agency for the sum of One Dollar (\$1.00) that parcel of land situated in the City of Providence and described in that Deed which is attached hereto and marked "Exhibit A".

2. This Resolution shall take effect upon its passage.

A true copy,  
Attest:

Vincent Vespia,  
City Clerk.

IN CITY COUNCIL

JAN 20 1977  
READ AND PASSED

*Robert J. Fenton*  
PRES.  
*Vincent Vespia*  
CLERK

APPROVED

*Vincent A. Vespia*  
JAN 28 1977

IN CITY COUNCIL  
DEC 2 1976

FIRST READING URBAN REDEVELOPMENT  
REFERRED TO COMMITTEE ON RENEWAL & PLANNING

Vincent Lopez  
CLERK

THE COMMITTEE ON  
URBAN REDEVELOPMENT  
RENEWAL & PLANNING

Approves Passage of  
The Within Resolution

Vincent Lopez  
Jan. 12, 1977 Clerk

Councilman Reedman  
and  
Committee Breckner,  
by Request

DEC 2 1976

CLERK

DEC 2 1976

D E E D

The PROVIDENCE REDEVELOPMENT AGENCY, a public body, corporate and politic, of the City and County of Providence, State of Rhode Island, for and in consideration of the sum of One Dollar (\$1.00) does hereby grant, bargain, sell and convey unto the CITY OF PROVIDENCE, a municipal corporation located in said State of Rhode Island, the following tract of land located in the City of Providence, State of Rhode Island:

That certain tract or parcel of land with all buildings and improvements thereon situated on the northerly side of Chester Avenue and the easterly line of Prairie Avenue; said point being the southwesterly corner of the herein described parcel;

thence running N-17° 37' 50"-W bounded southwesterly by said Prairie Avenue a distance of three hundred forty-three and 39/100 (343.39) feet to a corner and land now or lately owned by the First Federal Savings and Loan Association of Providence;

thence turning an interior angle of 72° 42' 00" and running N-89° 40' 10"-E bounded northwesterly by said First Federal Savings and Loan Association of Providence land a distance of two hundred seventy-eight and 146/1000 (278.146) feet to a corner and land now or lately owned by the City of Providence;

thence turning an interior angle of 90°-00'-00" and running S-00° 19' 50" -E bounded northeasterly by said City land a distance of one hundred eighty-six and 538/1000 (196.538) feet to a corner;

thence turning an interior angle of 283°-37'-00" and running N-76° 03' 10"-E bounded northwesterly by said City land a distance of one hundred ten and 85/100 (110.85) feet to a corner;

thence turning an interior angle of 93° 40' 40" and running S-17° 37' 30"-E bounded northeasterly by said City land a distance of eighty-eight and 289/1000 (88.289) feet to a corner and the aforesaid northerly line of Chester Avenue;

thence turning an interior angle of 87° 42' 50" and running S-74° 39' 40"-W bounded southeasterly by said Chester Avenue a distance of three hundred twenty and 96/100 (320.96) feet to the point of beginning where it forms an interior angle of 92° 17' 30" with the first above described course.

The herein described parcel contains 81,487 square feet of land.

The aforementioned conveyance is made subject to the provisions of and the restrictions and limitations contained in Chapter 1972-42 of the Ordinances of the City of Providence, approved September 11, 1972, and entitled "An Ordinance of the City Council of the City of Providence Approving the Redevelopment Plan and Feasibility of Relocation for the Comstock Redevelopment Plan" as the same has been amended and supplemented by Chapter 1974-29 of the Ordinances of the City of Providence, approved September 28, 1974, and entitled, "An Ordinance of the City Council of the City of Providence Approving the Redevelopment Plan and the Feasibility of Relocation for the Comstock Redevelopment Plan."

TO HAVE AND TO HOLD the aforegranted premises with their appurtenances unto and to the use of the said CITY OF PROVIDENCE, its successors and assigns, forever.

IN WITNESS WHEREOF, PROVIDENCE REDEVELOPMENT AGENCY has caused these presents to be executed and its corporate seal to be affixed hereunto by its Chairman thereunto duly authorized this            day of 197 .

PROVIDENCE REDEVELOPMENT AGENCY

By \_\_\_\_\_  
Chairman

STATE OF RHODE ISLAND ) SS  
COUNTY OF PROVIDENCE )

In the City of Providence, in said County and State, on the day of            , 197 , before me appeared the above-named Stanley P. Blacher, to me known and known by me to be the Chairman of said Providence Redevelopment Agency, and he acknowledged the foregoing instrument by him so executed to be his free act and deed in said capacity and the free act and deed of said Providence Redevelopment Agency.

\_\_\_\_\_  
Notary Public



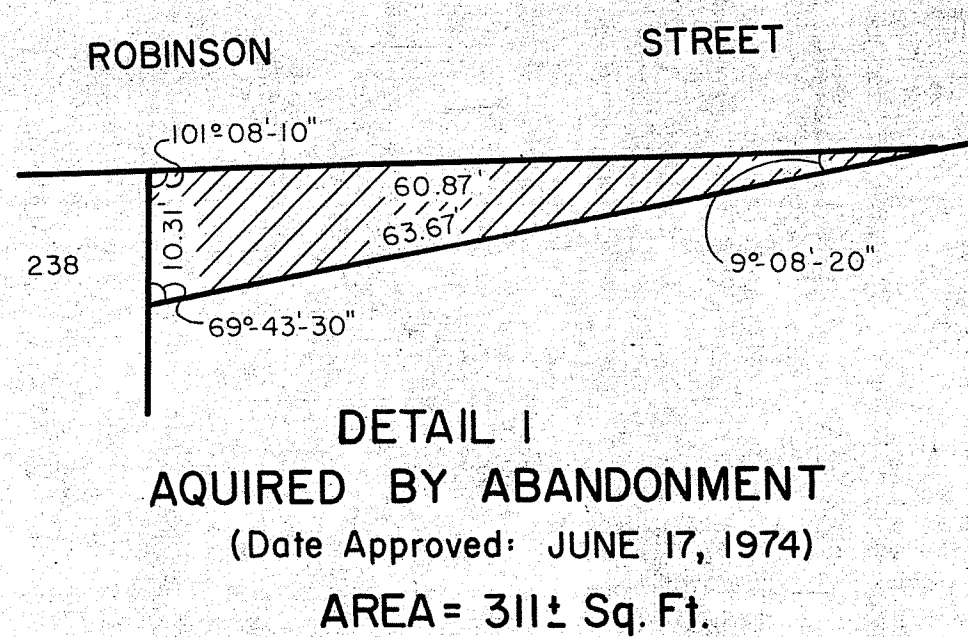

#### TOTAL AREA FOR BLOCKS

- ① = 23,152.6 SQ. FT.
- ② = 79,871.8 SQ. FT.
- ③ = 86,549.1 SQ. FT.
- ④ = 13,283.7 SQ. FT.
- ⑤ = 39,953.7 SQ. FT.
- ⑥A = 120,653 SQ. FT.
- ⑥B = 81,487 SQ. FT.
- 444,950.9 SQ. FT. = 10.2 ACRES

#### LEGEND

- ① CONDEMNATION BLOCK NUMBER
- DISPOSITION PARCEL NUMBER
- ASSESSOR'S LOT NUMBER
- CONDEMNATION LINE
- EXISTING LOT LINES
- GRANITE BOUND
- S.F. SQUARE FEET
- (0.0) DIMENSION FOR LEGAL DESCRIPTION

#### ASSESSOR'S PLAT 45

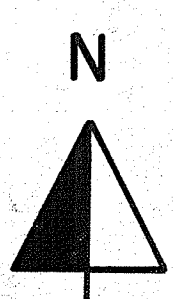

#### DETAIL 2 SUBDIVISION OF ABANDONED AREA Scale 1"=20'

REVISIONS		PROPERTY MAP	
NO.	DATE	COMSTOCK RENEWAL PROJECT	
1	OCT. 5, 1976	PROVIDENCE	REDEVELOPMENT AGENCY
		CITY OF	PROVIDENCE, RHODE ISLAND
		STATE OF	
		DATE	PROJECT NO.
		1975	