

THE CITY OF PROVIDENCE
STATE OF RHODE ISLAND AND PROVIDENCE PLANTATIONS

RESOLUTION OF THE CITY COUNCIL

No. 325

Approved April 19, 1957

Resolved,

That the Director of the Department of Recreation be and he is hereby requested to study the feasibility of the reconstruction of tennis courts on Metcalf Field.

IN CITY COUNCIL

APR 18 1957

READ and PASSED

Frederick P. Phillips
President
W. Everett T. McKean
Clerk

APPROVED

APR 19 1957

Walter H. Reynolds
MAYOR

RESOLUTION OF THE CITY COUNCIL

No. 326

Approved April 19, 1957

Resolved,

That the City Council of the City of Providence hereby judges that public necessity requires the establishment of a school in the vicinity of Kossuth, Florence, Joslin and Hyat Streets, in the City of Providence, which will involve the taking of land and improvements, and pursuant to the provisions of Chapter 1402 of the Public Laws, approved February 28, A. D. 1895, entitled "An Act to Provide for the Taking of Land for School Purposes in the City of Providence," and the acts in amendment thereof and in addition thereto, and in the exercise of the power and authority conferred by said Chapter 1402, as amended, the City Council of the City of Providence hereby deems it necessary to take, and the City of Providence, a municipal corporation created by the General Assembly of the State of Rhode Island, hereby elects to take and does take, in fee simple, for school purposes, the following described tracts or parcels of land, with all the buildings and improvements thereon, said areas being located in the City of Providence, and comprising those two certain tracts of land with all the buildings and improvements thereon, situated on Kossuth, Hyat, Joslin and Florence Streets in the said City of Providence, shown shaded and designated as Area A and Area B on the accompanying plan entitled "Providence, R. I., P.W. Dept.-- Engineering Office, City Property Section, Plan No. 061581, Date April 10, 1957", bounded and described as follows:

AREA A

Beginning at the southeasterly corner of Kossuth and Hyat Streets; thence easterly and bounding northerly on Kossuth Street, one hundred eighty-nine and eighty-two one hundredths (189.82) feet to the southwesterly corner of Kossuth and Joslin Streets; thence southerly, making an interior angle of 90° with Kossuth Street and bounding easterly on Joslin Street, sixty-nine and ninety-eight one hundredths (69.98) feet to an angle in the westerly line of said Joslin Street; thence continuing southerly, making an interior angle of 185°-09'-17" and bounding easterly on said Joslin Street, ninety-six and sixty one hundredths (96.60) feet to a second angle in the said westerly line of Joslin Street; thence southwesterly, making an interior angle of 135°-41'-40" and bounding southeasterly on said Joslin

RESOLUTION
OF THE
CITY COUNCIL

THE CITY OF PROVIDENCE
STATE OF RHODE ISLAND AND PROVIDENCE PLANTATIONS

RESOLUTION OF THE CITY COUNCIL

No.

Approved

~~Resolved~~,

~~That~~

Street, seventeen and twenty-three one hundredths (17.23) feet to other land of City of Providence; thence northwesterly, making an interior angle of $89^{\circ}-24'-11''$ and bounding southwesterly on said other land of City of Providence, eighty-seven and eighty-seven one hundredths (87.87) feet; thence northeasterly, making an interior angle of $89^{\circ}-38'-33''$ and bounding northwesterly on said other land of City of Providence, thirty-three and fifty-five one hundredths (33.55) feet; thence northwesterly, making an interior angle of $280^{\circ}-37'-53''$ and bounding southwesterly on said other land of City of Providence, one hundred sixty-two and seventy-one one hundredths (162.71) feet to the easterly line of Hyat Street; thence northerly, making an interior angle of $119^{\circ}-30'-35''$ and bounding westerly on said Hyat Street, seventeen and sixty-five one hundredths (17.65) feet to the southeasterly corner of Hyat and Kossuth Streets and the point and place of beginning and containing 16,872 square feet, this last described line making an interior angle of $89^{\circ}-57'-51''$ with the line first described herein.

AREA B

Beginning at the southeasterly corner of Kossuth and Joslin Streets; thence easterly and bounding northerly on Kossuth Street, one hundred eighty-nine and eighty-six one hundredths (189.86) feet to the southwesterly corner of Kossuth and Florence Streets; thence southerly, making an interior angle of 90° with Kossuth Street, and bounding easterly on said Florence Street, two hundred sixty-one and fifty-three one hundredths (261.53) feet to other land of City of Providence; thence northwesterly, making an interior angle of $60^{\circ}-22'-26''$ and bounding southwesterly on said other land of City of Providence, two hundred eighteen and forty-one one hundredths (218.41) feet to the easterly line of Joslin Street; thence northerly, making an interior angle of $119^{\circ}-37'-34''$ and bounding westerly on said Joslin Street, one hundred fifty-three and fifty-six one hundredths (153.56) feet to the southeasterly corner of Joslin and Kossuth Streets and the point and place of beginning and containing 39,404 square feet, this last described line making an interior angle of 90° with the line first described herein.

Together with all the right, title and interest of the abutting owners in and to said Kossuth Street, Florence Street, Joslin Street and Hyat Street, as may be appurtenant to Areas A and B.

The City of Providence expressly exempts from this taking the poles, wires, pipes, fixtures and other removable facilities of any public

RESOLUTION
OF THE
CITY COUNCIL

RESOLUTION OF THE CITY COUNCIL

No.

Approved

~~Resolved,~~

~~That~~

utility company located in, on or above the highways or streets located within the area taken, but does not waive or relinquish any existing right to order the same relocated or removed.

That although the measurements herein given and the measurements and areas given are shown on said plat, and believed to be approximately correct, yet, all the land described and delineated as included in the taking herein or hereunder are taken whether said areas are greater or less than shown herein.

That there be filed in the Office of the Recorder of Deeds in said City of Providence a description of said lands to be acquired, and also a plat thereof, and a statement that the same are taken pursuant to the provisions of said acts, which description, plat and statement shall be signed by the Mayor of said City.

After the filing of said description, plat and statement, the Director of Public Works shall enter upon and take possession of said lands in behalf of the City of Providence, and the Board of Contract and Supply is hereby authorized and empowered to confer with the owner or owners of any part or parts of the land taken hereunder, and to agree in behalf of the City of Providence upon the price of the land and improvements so taken. The Board of Contract and Supply is hereby further authorized as a part of any such agreement made by it to sell to the owner or owners thereof any and all improvements upon the premises of said owner or owners, and is also authorized as a part of said agreement to convey to the owner or owners thereof any excess land, which said City may acquire by reason of said condemnation from such owner or owners.

The Board of Contract and Supply is hereby authorized to determine the rents and charges for the use and occupancy of any and all lands or premises condemned pursuant to the provisions of this resolution, and may designate some person to collect the rents for the City Collector of the City of Providence. Said Board may sell at public auction or private sale any and all buildings and improvements within the con-

THE CITY OF PROVIDENCE
STATE OF RHODE ISLAND AND PROVIDENCE PLANTATIONS

RESOLUTION OF THE CITY COUNCIL

No.

Approved

~~Resolved,~~
Resolved,

~~That~~
That

demnation area, which have not been sold to the former owner or owners thereof as part of the settlement agreement hereinbefore provided, and may provide for the tearing down and removal thereof where necessary.

The cost of taking said land and property, and all costs incidental thereto incurred in carrying out the terms of this resolution shall be charged to the Loan Account authorized by Chapter 3639 of the Public Laws, 1956, entitled "An Act Authorizing the City of Providence to Issue Bonds in the Sum of One Million Two Hundred Fifty Thousand (\$1,250,000) Dollars for School Purposes."

IN CITY COUNCIL

APR 18 1957

READ and PASSED

Deverett Whelan
Clerk

APPROVED

APR 19 1957

Walter H. Reynolds

RESOLUTION

OF THE

CITY COUNCIL

CONDEMNING TWO TRACTS
OF LAND ON KOSSUTH,
FLORENCE, JOSLIN AND
HYAT STREETS, FOR SCHOOL
PURPOSES.

STATEMENT PLAT OF LAND CONDEMNED

PURSUANT TO THE PROVISIONS OF CHAPTER 1402 OF THE PUBLIC LAWS ENTITLED,
"AN ACT TO PROVIDE FOR THE TAKING OF LAND FOR SCHOOL PURPOSES IN THE CITY
OF PROVIDENCE," PASSED BY THE GENERAL ASSEMBLY AT ITS JANUARY SESSION
A.D. 1895 AND THE ACTS IN AMENDMENT THEREOF AND IN ADDITION THERETO AND
IN ACCORDANCE WITH THE RESOLUTION OF THE CITY COUNCIL OF THE CITY OF
PROVIDENCE NUMBERED APPROVED CONDEMNING
CERTAIN LAND FOR SCHOOL PURPOSES.

MAYOR OF THE CITY OF PROVIDENCE.

PROVIDENCE, R.I.
CITY ENGINEERING OFFICE
CITY PROPERTY SECTION
File No. 061581
Date April 10, 1957

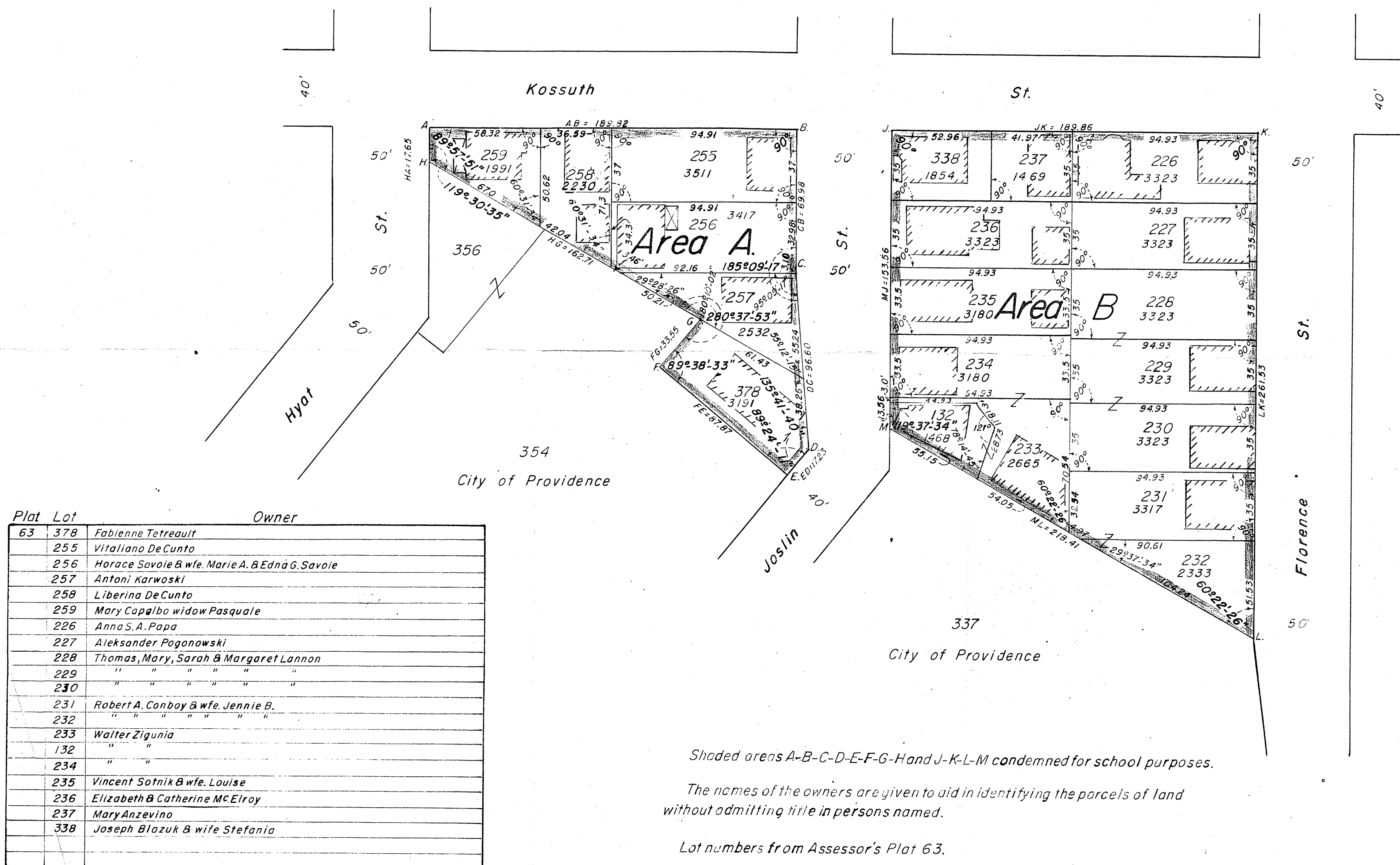

CITY OF PROVIDENCE, R.I.
Public Works Dept. - Engineering Office
Following Condemnation for
School Purposes
Drawn by E.A.K. Checked by L.P.R.
Scale 1" = 40' Date 4-10-57
Contract Z-10-1-57
Approved [Signature] City Engineer

Q & file

RAF

STATEMENT CONTAINING A DESCRIPTION OF LAND AND IMPROVEMENTS TAKEN PURSUANT TO THE PROVISIONS OF CHAPTER 1402 OF THE PUBLIC LAWS, APPROVED FEBRUARY 28, A. D. 1895, ENTITLED "AN ACT TO PROVIDE FOR THE TAKING OF LAND FOR SCHOOL PURPOSES IN THE CITY OF PROVIDENCE," AND THE ACTS IN AMENDMENT THEREOF AND IN ADDITION THERETO, AND BY AND IN ACCORDANCE WITH THE RESOLUTION OF THE CITY COUNCIL No. 326 APPROVED APRIL 19 A.D. 1957, IN THE VICINITY OF KOSSUTH, HYAT, JOSLIN AND FLORENCE STREETS, IN THE CITY OF PROVIDENCE.

WHEREAS, the City of Providence, a municipal corporation in the State of Rhode Island, pursuant to the provisions of Chapter 1402 of the Public Laws, passed at the January Session, A. D. 1895, and approved February 28, A. D. 1895, entitled "An Act to Provide for the Taking of Land for School Purposes in the City of Providence," and in the exercise of the power and authority conferred by said Act, as amended, authorizing the City of Providence to take lands, improved and unimproved, for school purposes, the City Council of the City of Providence passed its certain Resolution No. 326 approved April 19 1957, wherein and whereby the City of Providence elected to take and did take certain tracts or parcels of land, and wherein was specified the purpose or purposes for which the same were taken, and which said Chapter 1402 of the Public Laws of 1895, as amended, provided that there be filed in the office of the Recorder of Deeds in said City a description of said lands, and also a plat thereof, and a statement that the same are taken pursuant to the provisions of said Chapter 1402 for school purposes, which said description, plat and statement shall be signed by His Honor the Mayor of said City.

NOW THEREFORE, pursuant to the provisions of said Acts and said Resolution, and in conformity therewith, the City of Providence makes the following statement:

THAT it has elected to take and takes, and the same is taken, pursuant to the provisions of said Acts, as amended, for school purposes, the following described tracts or parcels of land, with all the buildings and improvements thereon, said areas being located in the City of Providence, and comprising those two certain tracts of land with all the buildings and improvements thereon, situated on Kossuth, Hyat, Joslin and Florence Streets in the said City of Providence, shown shaded and designated as Area A and Area B on the accompanying plan entitled "Providence, R. I., P.W. Dept.--Engineering Office, City Property Section, Plan No. 061581, Date April 10, 1957", bounded and described as follows:

AREA A

Beginning at the southeasterly corner of Kossuth and Hyat Streets; thence easterly and bounding northerly on Kossuth Street, one hundred eighty-nine and eighty-two one hundredths (189.82) feet to the southwesterly corner of Kossuth and Joslin Streets; thence southerly, making an interior angle of 90° with Kossuth Street and bounding easterly on Joslin Street, sixty-nine and ninety-eight one hundredths (69.98) feet to an angle in the westerly line of said Joslin Street; thence continuing southerly, making an interior angle of 185°-09'-17" and bounding easterly on said Joslin Street, ninety-six and sixty one hundredths (96.60) feet to a second angle in the said westerly line of Joslin Street; thence southwesterly, making an interior angle of 135°-41'-40" and bounding southeasterly on said Joslin Street, seventeen and twenty-three one hundredths (17.23) feet to other land of City of Providence; thence northwesterly, making an interior angle of 89°-24'-11" and bounding southwesterly on said other land of City of Providence, eighty-seven and eighty-seven one hundredths (87.87) feet; thence northeasterly, making an interior angle of 89°-38'-33" and bounding northwesterly on said other land of City of Providence, thirty-three and fifty-five one hundredths (33.55) feet; thence northwesterly, making an interior angle of 280°-37'-53" and bounding southwesterly on said other land of City of Providence, one hundred sixty-two and seventy-one one hundredths (162.71) feet to the easterly line of Hyat Street; thence northerly, making an interior angle of 119°-30'-35" and bounding westerly on said Hyat Street, seventeen and sixty-five one hundredths (17.65) feet to the southeasterly corner of Hyat and Kossuth Streets and the point and place of beginning and containing 16,872 square feet, this last described line making an interior angle of 89°-57'-51" with the line first described herein.

AREA B

Beginning at the southeasterly corner of Kossuth and Joslin Streets; thence easterly and bounding northerly on Kossuth Street, one hundred eighty-nine and eighty-six one hundredths (189.86) feet to the southwesterly corner of Kossuth and Florence Streets; thence southerly, making an interior angle of 90° with Kossuth Street, and bounding easterly on said Florence Street, two hundred sixty-one and fifty-three one hundredths (261.53) feet to other land of City of Providence; thence northwesterly, making an interior angle of 60°-22'-26" and bounding southwesterly on said other land of City of Providence, two hundred eighteen and forty-one one hundredths (218.41) feet to the easterly line of Joslin Street; thence northerly, making an interior angle of 119°-37'-34" and bounding westerly on said Joslin Street, one hundred fifty-three and fifty-six one hundredths (153.56) feet to the southeasterly corner of Joslin and Kossuth Streets and the point and place of beginning and containing 39,404 square feet, this last described line making an interior angle of 90° with the line first described herein.

Together with all the right, title and interest of the abutting owners in and to said Kossuth Street, Florence Street, Joslin Street and Hyat Street, as may be appurtenant to Areas A and B.

The City of Providence expressly exempts from this taking the poles, wires, pipes, fixtures and other removable facilities of any public utility company located in, on or above the highways or streets located within the area taken, but does not waive or relinquish any existing right to order the same relocated or removed.

That although the measurements herein given and the measurements and areas given are shown on said plat, and believed to be approximately correct, yet, all the land described and delineated as included in the taking, herein or hereunder are taken whether said areas are greater or less than shown herein.

CITY OF PROVIDENCE

By _____ MAYOR

The foregoing description and statement, together with a plat, were filed in the office of the Recorder of Deeds, City of Providence, April 19, A. D. 1957.

A true copy Attest:

Thomas D. McManus
ASSISTANT CITY SOLICITOR
A true copy, Attest:

CITY CLERK

3-

CITY SERGEANT

THE CITY OF PROVIDENCE
STATE OF RHODE ISLAND AND PROVIDENCE PLANTATIONS

RESOLUTION OF THE CITY COUNCIL

No. 327

Approved April 19, 1957

Resolved,

That the following taxpayers be refunded

the amounts specified because of overpayment of their 1955 taxes
to the City Collector.

Code #08-045-980
Francis W. Hamilton and wf. Irene B.
40 College Rd.
Providence, R. I.

Amount of original 1955 tax	\$292.38
Amt. abated, Cert 18P-5 approved 3/7/57	21.78
Amt. paid 10/26/55 P Teller	292.38
Amount overpaid, Cert. 0-5067	21.78

Refund \$21.78 to Francis W. Hamilton and wf. Irene B.
40 College Rd., City ✓

Code #11-144-590
Jennie C. Kilner
55 Algonquin St.
Providence, R. I.

Amount of original 1955 tax	\$6.60
Amt. abated, Cert 18P-6 approved 3/7/57	6.60
Amt. paid 9/27/56 A Teller	6.60 ✓
Amount overpaid, Cert. 0-5068	6.60

Refund \$6.60 to Jennie C. Kilner, 55 Algonquin St., City

Code #01-235-110
Artcraft Jewelers Inc.
143 Summer St.
Providence, R. I.

Amount of original 1955 tax	\$66.00 ✓
Amt. abated, Cert. 23P-28 approved 3/7/57	26.40
Amt. paid 12/11/56 A Teller	66.00
Amount overpaid, Cert. 0-5109	26.40

Refund \$26.40 to Artcraft Jewelers Inc, 143, Summer St., City

Code #03-712-490
Joseph Crudelli
80 Veazie St.
Providence, R. I.

Amount of original 1955 tax	\$46.20
Amt. abated, Cert 23P-38 approved 3/7/57	26.40 ✓
Amt. paid 3/6/57 A Teller	46.20
Amount overpaid, Cert. 0-5111	26.40

Refund \$26.40 to Joseph Crudelli, 80 Veazie St., City

RESOLUTION
OF THE
CITY COUNCIL

The City of Providence

STATE OF RHODE ISLAND AND PROVIDENCE PLANTATIONS

PAGE 2

Code #19-376-740
Edward E. Smith
251 Pocasset Ave.
Providence, R. I.

Amount of original 1955 tax	\$9.24
Amt. abated, Cert 25P-7 approved 3/7/57	4.62
Amt. paid 1/14/57 A Teller	9.24
Amount overpaid, Cert. 0-5112	4.62

Refund \$4.62 to Edward E. Smith, 251 Pocasset Ave., City

Code #20-016-900
Stella E. Tamke
70 Peace St.
Providence, R. I.

Amount of original 1955 tax	\$13.20
Amt. abated, Cert 27P-4 approved 3/7/57	13.20
Amt. paid 10/2/56 D Teller	13.20
Amount overpaid, Cert. 0-5113	13.20

Refund \$13.20 to Stella E. Tamke, 70 Peace St., City

Code #13-487-710
John M. McManus and wf. Alice M.
7 East St.
Providence, R. I.

Amount of original 1955 tax	\$103.62
Amt. abated, Cert 28P-3 approved 3/7/57	25.08
Amt. paid 10/18/55 D Teller	25.91
Amt. paid 1/12/56 D Teller	25.90
Amt. paid 4/24/56 F Teller	25.91
Amt. paid 7/18/56 B Teller	25.90
Amount overpaid, Cert. 0-5114	25.08

Refund \$25.08 to John M. McManus and wf. Alice M. 7 East St., City

Code #03-467-120
Charles W. Cole and wf. Helen M.
65 Homer St.
Providence, R. I.

Amount of original 1955 tax	\$347.49
Amt. abated, Cert 28P-5 approved 3/7/57	21.78
Amt. paid 10/17/55 P Teller	347.49
Amount overpaid, Cert 0-5115	21.78

Refund \$21.78 to Charles W. Cole and wf. Helen M., 65 Homer St., City

IN CITY COUNCIL

APR 18 1957

READ and PASSED

Charles W. Cole
President
Edward E. Smith
Clerk

APPROVED

APR 19 1957

Walter H. Reynolds
MAYOR

No.

CHAPTER AN ORDINANCE

•
•
•
•

✱
✱
✱
✱

1
2
3
4
5
6
7

•

THE CITY OF PROVIDENCE
STATE OF RHODE ISLAND AND PROVIDENCE PLANTATIONS

RESOLUTION OF THE CITY COUNCIL

No. 328

Approved April 19, 1957

Resolved,

That the following taxpayers be refunded the amounts specified because of overpayment of their 1956 taxes to the City Collector.

Code #02-338-173
Robert S. Bogosian
91 Alvin Street
Providence, R. I.

Amount of original 1956 tax
Amt. abated, Cert 13P-9 approved 3/7/57
Amt. paid 10/19/56 F Teller
Amount overpaid, Cert. 0-5049

\$4.62
4.62
1.15
1.15 ✓

Refund \$1.15 to Robert S. Bogosian, 91 Alvin St., City

Code #02-386-555
George L. Boudreau
P. O. Box 80
Providence College
Providence, R. I.

Amount of original 1956 tax
Amt. abated, Cert. 13P-9 approved 3/7/57
Amt. paid 11/9/56 A Teller
Amount overpaid, Cert. 0-5050

\$4.62
4.62
1.15
1.15 ✓

Refund \$1.15 to George L. Boudreau, P. O. Box 80, Providence College, City

Code #02-530-805
John W. Browning
219 Hanover St.
Providence, R. I.

Amount of original 1956 tax
Amt. abated, Cert 13P-11 approved 3/7/57
Amt. paid 10/2/56 J Teller
Amount overpaid, Cert. 0-5051

\$4.62
4.62
1.15
1.15 ✓

Refund \$1.15 to John W. Browning, 219 Hanover St., City

Code #03-149-210
Vincent T. Carlone
27 Diamond St.
Providence, R. I.

Amount of original 1956 tax
Amt. abated, Cert. 13P-15 approved 3/7/57
Amt. paid 10/8/56 L Teller
Amount overpaid, Cert. 0-5052

\$6.60 ✓
6.60
6.60
6.60

Refund \$6.60 to Vincent T. Carlone, 27 Diamond St., City

RESOLUTION
OF THE
CITY COUNCIL

The City of Providence

STATE OF RHODE ISLAND AND PROVIDENCE PLANTATIONS

PAGE 2

Code #03-235-690
Ernest H. Caswell
19 Hammond St.
Providence, R. I.

Amount of original 1956 tax	\$4.62
Amt. abated, Cert 13P-17 approved 3/7/57	4.62
Amt. paid 10/10/56 A Teller	4.62
Amount overpaid, Cert. 0-5053	4.62 ✓

Refund \$4.62 to Ernest H. Caswell, 19 Hammond St., City

Code #03-622-092
Alfred Costa
662 Prairie Ave.
Providence, R. I.

Amount of original 1956 tax	\$8.58
Amt. abated, Cert 13P-22 approved 3/7/57	8.58
Amt. paid 10/15/56 D Teller	2.14
Amount overpaid, Cert. 0-5054	2.14

Refund \$2.14 to Alfred Costa, 662 Prairie Ave., City

Code #04-227-616
Joseph A. DePasquale
894 Chalkstone Ave.
Providence, R. I.

Amount of original 1956 tax	\$11.22
Amt. abated, Cert 13P-27 approved 3/7/57	11.22
Amt. paid 10/2/56 J Teller	2.80 ✓
Amount overpaid, Cert. 0-5055	2.80

Refund \$2.80 to Joseph A. DePasquale, 894 Chalkstone Ave., City

Code #06-010-445
Albert Faiola
45 Terrace Ave.
Providence, R. I.

Amount of original 1956 tax	\$26.40
Amt. abated, Cert. 13P-33 approved 3/7/57	26.40 ✓
Amt. paid 10/23/56 H Teller	6.60
Amount overpaid, Cert. 0-5056	6.60

Refund \$6.60 to Albert Faiola, 45 Terrace Ave., City

Code #04-172-120
Joseph Del Greco
1 Hunnewell Ave.
Providence, R. I.

Amount of original 1956 tax	\$9.24 ✓
Amt. abated, Cert. 13P-27 approved 3/7/57	9.24
Amt. paid 10/17/56 A Teller	9.24
Amount overpaid, Cert. 0-5057	9.24

Refund \$9.24 to Joseph Del Greco, 1 Hunnewell Ave., City

The City of Providence

STATE OF RHODE ISLAND AND PROVIDENCE PLANTATIONS

PAGE 3

Code #07-003-100
Luigi Gabriele
20 Gridley St.
Providence, R. I.

Amount of original 1956 tax
Amt. abated, Cert 13P-40 approved 3/7/57
Amt. paid 10/22/56 J Teller
Amount overpaid, Cert. 0-5058

\$21.78
21.78
21.78
21.78 ✓

Refund \$21.78 to Luigi Gabriele, 20 Gridley St., City

Code #07-280-215
Charles Goodman
240 Gallatin St.
Providence, R. I.

Amount of original 1956 tax
Amt. abated, Cert 13P-44 approved 3/7/57
Amt. paid 10/30/56 A Teller
Amt. paid 1/18/57 D Teller
Amount overpaid, Cert. 0-5059

\$5.94
5.94
1.48
1.49
2.97 ✓

Refund \$2.97 to Charles Goodman, 240 Gallatin St., City

Code #08-126-610
Charles Hathaway
672 Prairie Ave.
Providence, R. I.

Amount of original 1956 tax
Amt. abated, Cert 13P-48 approved 3/7/57
Amt. paid 10/23/56 L Teller
Amount overpaid, Cert. 0-5060

\$19.80
19.80
4.95 ✓
4.95

Refund \$4.95 to Charles Hathaway, 672 Prairie Ave., City

Code #08-233-670
Frank J. Hindle
10 Wyndham Ave.
Providence, R. I.

Amount of original 1956 tax
Amt. abated, Cert. 13P-49 approved 3/7/57
Amt. paid 10/15/56 D Teller
Amount overpaid, Cert. 0-5061

\$10.56
10.56
10.56 ✓
10.56

Refund \$10.56 to Frank J. Hindle, 10 Wyndham Ave., City

Code #09-021-960
Pasquale Iascone
18 Piedmont St.
Providence, R. I.

Amount of original 1956 tax
Amt. abated, Cert 13P-51 approved 3/7/57
Amt. paid 10/3/56 J Teller
Amount overpaid, Cert. 0-5062

\$11.22
11.22 ✓
2.80
2.80

Refund \$2.80 to Pasquale Iascone, 18 Piedmont St., City

The City of Providence

STATE OF RHODE ISLAND AND PROVIDENCE PLANTATIONS

PAGE 4

Code #11-150-705
Chester T. King
10 Rushmore Ave.
Providence, R. I.

Amount of original 1956 tax
Amt. abated, Cert. 13P-57 approved 3/7/57
Amt. paid 10/18/56 A Teller
Amount overpaid, Cert. O-5063

\$33.00
33.00
8.25
8.25 ✓

Refund \$8.25 to Chester T. King, 10 Rushmore Ave., City

Code #12-352-800
Gino Lupoli
21 Denison St.
Providence, R. I.

Amount of original 1956 tax
Amt. abated, Cert 13P-63 approved 3/7/57
Amt. paid 10/23/56 F Teller
Amount overpaid, Cert. O-5064

\$11.88
11.88
2.97
2.97 ✓

Refund \$2.97 to Gino Lupoli, 21 Denison St., City

Code #13-123-920
Richard M. Manley
658 Prairie Ave.
Providence, R. I.

Amount of original 1956 tax
Amt. abated, Cert 13P-65 approved 3/7/57
Amt. paid 10/15/56 L Teller
Amount overpaid, Cert. O-5065

\$4.62
4.62
4.62
4.62 ✓

Refund \$4.62 to Richard M. Manley, 658 Prairie Ave., City

Code #01-276-095
Earl E. Ayers
547 Mt. Pleasant Ave.
Providence, R. I.

Amount of original 1956 tax
Amt. abated, Cert 13P-4 approved 3/7/57
Amt. paid 1/15/57 D Teller
Amount overpaid, Cert. O-5066

\$11.88
11.88
11.88 ✓
11.88

Refund \$11.88 to Earl E. Ayers, 547 Mt. Pleasant Ave., City

Code #16-232-567
Alfred L. Pettine
263 New York Ave.
Providence, R. I.

Amount of original 1956 tax
Amt. abated, Cert 19P-7 approved 3/7/57
Amt. paid 10/23/56 J Teller
Amount overpaid, Cert. O-5069

\$7.92
7.92
7.92 ✓
7.92

Refund \$7.92 to Alfred L. Pettine, 263 New York Ave. City

No.

**CHAPTER
AN ORDINANCE**

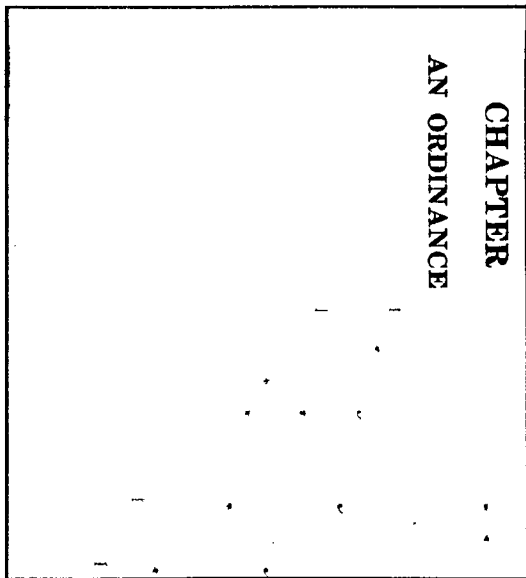

The City of Providence

STATE OF RHODE ISLAND AND PROVIDENCE PLANTATIONS

PAGE 5

Code #16-370-610
Millie E. Powers
47 Pitman St.
Providence, R. I.

Amount of original 1956 tax	\$31.68
Amt. abated, Cert 19P-9 approved 3/7/57	31.68
Amt. paid 10/29/56 F Teller	31.68
Amount overpaid, Cert. 0-5070	31.68 ✓

Refund \$31.68 to Millie E. Powers, 47 Pitman St., City

Code #18-258-937
Cornelius G. Ridgewell
809 Admiral St.
Providence, R. I.

Amount of original 1956 tax	\$4.62
Amt. abated, Cert 19P-12 approved 3/7/57	4.62
Amt. paid 11/13/56 P Teller	4.62
Amount overpaid, Cert. 0-5071	4.62

Refund \$4.62 to Cornelius G. Ridgewell, 809 Admiral St., City

Code #18-360-830
Wilfred L. Rousseau
351 Lockwood St.
Providence, R. I.

Amount of original 1956 tax	\$11.88
Amt. abated, Cert 19P-15 approved 3/7/57	11.88
Amt. paid 11/29/56 A Teller	4.62
Amount overpaid, Cert. 0-5072	4.62

Refund \$4.62 to Wilfred L. Rousseau, 351 Lockwood St., City

Code #19-557-720
Richard W. Strachan
217 Eighth St.
Providence, R. I.

Amount of original 1956 tax	\$15.18
Amt. abated, Cert 19P-23 approved 3/7/57	15.18
Amt. paid 11/26/56 D Teller	3.79
Amt. paid 1/16/57 D Teller	3.80
Amount overpaid, Cert. 0-5073	7.59

Refund \$7.59 to Richard W. Strachan, 217 Eighth St., City

Code #20-087-260
Omer R. Thibodeau
59 Bogman St.
Providence, R. I.

Amount of original 1956 tax	\$26.40
Amt. abated, Cert 19P-25 approved 3/7/57	26.40
Amt. paid 10/17/56 F Teller	6.60
Amount overpaid, Cert. 0-5074	6.60 ✓

Refund \$6.60 to Omer R. Thibodeau, 59 Bogman St., City

CHAPTER
AN ORDINANCE

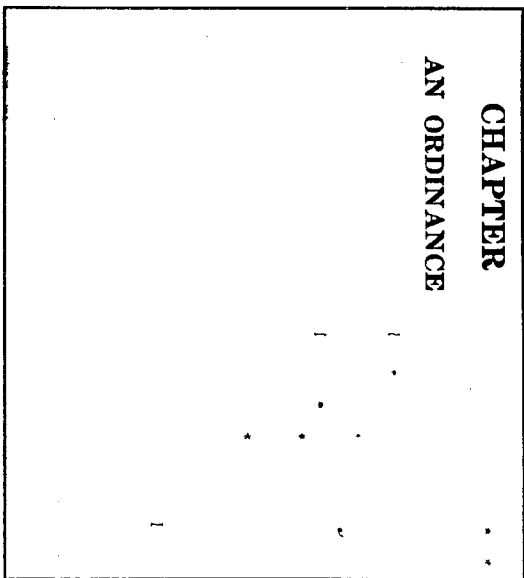

The City of Providence

STATE OF RHODE ISLAND AND PROVIDENCE PLANTATIONS

PAGE 6

Code #20-150-620
Herman R. Torman
148 Pearl St.
Providence, R. I.

Amount of original 1956 tax	\$26.40
Amt. abated, Cert 19P-26 approved 3/7/57	26.40
Amt. paid 10/16/56 L Teller	6.60
Amount overpaid, Cert. 0-5075	6.60

Refund \$6.60 to Herman R. Torman, 148 Pearl St., City

Code #18-253-730
Justin L. Richman
1152 Beacon St.
Brookline 46, Mass.

Amount of original 1956 tax	\$13.20
Amt. abated, Cert 20P-3 approved 3/7/57	13.20
Amt. paid 10/29/56 F Teller	3.30
Amount overpaid, Cert. 0-5076	3.30

Refund \$3.30 to Justin L. Richman, 1152 Beacon St., Brookline 46, Mass.

Code #13-180-190
Edna Marocco
220 Pocasset Ave.
Providence, R. I.

Amount of original 1956 tax	\$33.66
Amt. abated, Cert 20P-4 approved 3/7/57	33.66
Amt. paid 10/5/56 L Teller	8.41
Amount overpaid, Cert 0-5077	8.41

Refund \$8.41 to Edna Marocco 220 Pocasset Ave. City

Code #14-014-327
Giovannino Nappi
184 Waverly St.
Providence, R. I.

Amount of original 1956 tax	\$13.86
Amt. abated, Cert 20P-5 approved 3/7/57	13.86
Amt. paid 10/9/56 L Teller	3.46
Amount overpaid, Cert. 0-5078	3.46

Refund \$3.46 to Giovannino Nappi, 184 Waverly St., City

Code #05-044-780
Adelbert R. Ellinwood
126 Niantic Ave.
Providence, R. I.

Amount of original 1956 tax	\$50.82
Amt. abated, Cert 20P-6 approved 3/7/57	46.20
Amt. paid 10/23/56 J Teller	12.70
Amt. paid 1/21/57 D Teller	12.71
Amount overpaid, Cert. 0-5079	20.79

Refund \$20.79 to Adelbert R. Ellinwood, 126 Niantic Ave., City

No.

**CHAPTER
AN ORDINANCE**

The City of Providence

STATE OF RHODE ISLAND AND PROVIDENCE PLANTATIONS

PAGE 7

Code #19-307-000
Anible Silvia
34 Home Ave.
Providence, R. I.

Amount of original 1956 tax	\$234.01
Amt. abated, Cert 20P-7 approved 3/7/57	83.20
Amt. paid 10/30/56 D Teller by Peoples Savings Bank	234.01
Amount overpaid, Cert. 0-5080	83.20

Refund \$83.20 to Peoples Savings Bank Agent for Anible Silvia,
145 Westminster St., City

Code #04-075-210
Minnie Datz
139 Radcliffe Ave,
Providence, R. I.

Amount of original 1956 tax	\$26.40
Amt. abated, Cert. 20P-11 approved 3/7/57	26.40
Amt. paid 10/22/56 J Teller	6.60
Amount overpaid, Cert. 0-5081	6.60

Refund \$6.60 to Minnie Datz, 139 Radcliffe Ave., City

Code #07-001-900
Catherine R. Gabriel
43 Ackerman St.
Providence, R. I.

Amount of original 1956 tax	\$23.76
Amt. abated, Cert 20P-33 approved 3/7/57	4.62
Amt. paid 1/17/57 D Teller	23.76
Amount overpaid, Cert 0-5082	4.62

Refund \$4.62 to Catherine R. Gabriel, 43 Ackerman St., City

Code #12-175-477
Ermanno J. Leonelli and wf. Yolanda A.
145 Hillcrest Ave.
Providence, R. I.

Amount of original 1956 tax	\$405.24
Amt. abated, Cert 20P-38 approved 3/7/57	369.60
Amt. pd. 10/29/56 F Teller by First Fed. Savings	405.24
Amount overpaid, Cert. 0-5083	369.60

Refund \$369.60 to First Federal Savings and Loan Association
Agent for Ermanno J. Leonelli and wf. Yolanda A.
110 Westminster St., City

Code #01-021-190
Andrew Accioli Jr.
563 Charles St.
Providence, R. I.

Amount of original 1956 tax	\$6.60
Amt. abated, Cert 21P-1 approved 3/7/57	6.60
Amt. paid 10/17/56 D Teller	1.65
Amount overpaid, Cert. 0-5084	1.65

Refund \$1.65 to Andrew Accioli Jr., 563 Charles St., City

No.

CHAPTER
AN ORDINANCE

The City of Providence

STATE OF RHODE ISLAND AND PROVIDENCE PLANTATIONS

PAGE 8

Code #01-107-730
William Altham
16 Harmony Drive
Providence, R. I.

Amount of original 1956 tax	\$15.18
Amt. abated, Cert 21P-1 approved 3/7/57	15.18
Amt. paid 11/26/56 D Teller	3.79
Amount overpaid, Cert. 0-5085	3.79 ✓

Refund \$3.79 to William Altham, 16 Harmony Drive, City

Code #06-010-801
Joseph Faioli Jr.
17 Sweetbriar St.
Providence, R. I.

Amt. of 1956 tax as corrected by cert 7P-9	\$11.22
Amt. abated, Cert 21P-8 approved 3/7/57	11.22
Amt. paid 12/3/56 F Teller	2.81
Amount overpaid, Cert. 0-5086	2.81 ✓

Refund \$2.81 to Joseph Faioli Jr., 17 Sweetbriar St., City

Code #06-266-375
Warren W. Francis
82 Taber Ave.
Providence, R. I.

Amount of original 1956 tax	\$23.10
Amt. abated, Cert. 21P-10 approved 3/7/57	23.10
Amt. paid 10/20/56 J Teller	5.77
Amt. paid 1/17/57 D Teller	6.00
Amount overpaid, Cert. 0-5087	11.77 ✓

Refund \$11.77 to Warren W. Francis, 82 Taber Ave., City

Code #07-254-495
Albert Goldman
94 Taylor St.
Providence, R. I.

Amount of original 1956 tax	\$13.86
Amt. abated, Cert 21P-11 approved 3/7/57	13.86
Amt. paid 11/1/56 P Teller	3.46
Amount overpaid, Cert 0-5088	3.46 ✓

Refund \$3.46 to Albert Goldman, 94 Taylor St., City

Code #08-269-995
Charles P. Holmes Jr.
146 Taber Ave.
Providence, R. I.

Amount of original 1956 tax	\$33.00
Amt. abated, Cert 21P-13 approved 3/7/57	33.00
Amt. paid 10/29/56 D Teller	8.25
Amount overpaid, Cert. 0-5089	8.25 ✓

Refund \$8.25 to Charles P. Holmes Jr., 146 Taber Ave., City

No.

**CHAPTER
AN ORDINANCE**

C

• • • • •

• • • • •

• • • • •

• • • • •

• • • • •

The City of Providence

STATE OF RHODE ISLAND AND PROVIDENCE PLANTATIONS

PAGE 9

Code #08-321-245
W. Hersey Howard
203 Calla St.
Providence, R. I.

Amount of original 1956 tax	\$11.22
Amt. abated, Cert 21P-13 approved 3/7/57	11.22
Amt. paid 10/10/56 L Teller	11.22
Amount overpaid, Cert. 0-5090	11.22 ✓

Refund \$11.22 to W. Hersey Howard, 203 Calla St., City

Code #10-088-605
Andrew Johnston
46 Stanwood St.
Providence, R. I.

Amount of original 1956 tax	\$33.00
Amt. abated, Cert 21P-14 approved 3/7/57	33.00
Amt. paid 10/28/56 A Teller	33.00
Amount overpaid, Cert. 0-5091	33.00 ✓

Refund \$33.00 to Andrew Johnston, 46 Stanwood St., City

Code #11-025-390
Carl L. Karp
141 Lancaster St.
Providence, R. I.

Amount of original 1956 tax	\$46.20
Amt. abated, Cert 21P-14 approved 3/7/57	33.00
Amt. paid 10/24/56 L Teller	46.20 ✓
Amount overpaid, Cert. 0-5092	33.00

Refund \$33.00 to Carl L. Karp, 141 Lancaster St., City

Code #11-053-430
Kenneth E. Keefe
158 West Clifford St.
Providence, R. I.

Amount of original 1956 tax	\$49.50
Amt. abated, Cert 21P-14 approved 3/7/57	33.00
Amt. paid 11/1/56 P Teller	49.50 ✓
Amount overpaid, Cert. 0-5094	33.00

Refund \$33.00 to Kenneth E. Keefe, 158 West Clifford St. City

Code #11-099-360
Richard Z. Kenler
71 Woodbine St.
Providence, R. I.

Amount of original 1956 tax	\$25.08
Amt. abated, Cert 21P-14 approved 3/7/57	25.08 ✓
Amt. paid 10/25/56 D Teller	6.27
Amount overpaid, Cert. 0-5095	6.27

Refund \$6.27 to Richard Z. Kenler, 71 Woodbine St., City

No.

CHAPTER
AN ORDINANCE

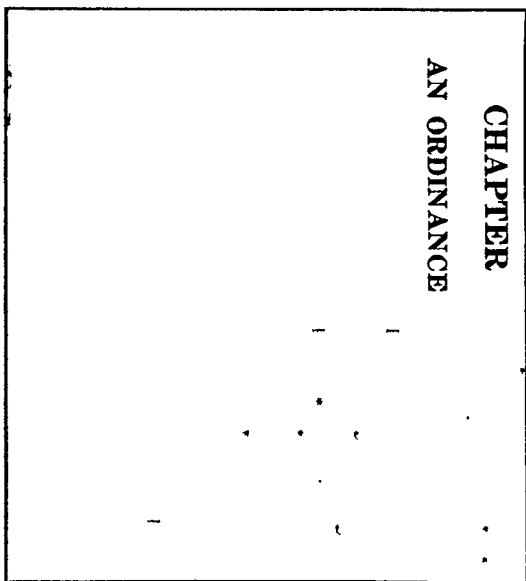

•
•
•
•

•
•
•
•

•
•
•
•

•
•
•
•

•
•
•
•

The City of Providence

STATE OF RHODE ISLAND AND PROVIDENCE PLANTATIONS

PAGE 10

Code #11-106-805
Harold Kenner and wf. Roselyn
271 Taber Ave.
Providence, R. I.

Amount of original 1956 tax	\$1186.35
Amt. abated, Cert 21P-15 approved 3/7/57	21.12
Amt. paid 10/30/56 D Teller	1186.35
Amount overpaid, Cert. 0-5096	21.12

Refund \$21.12 to Harold Kenner and wf. Roselyn, 271 Taber Ave., City ✓

Code #13-469-211
Charles F. McLaughlin Jr. and wf. Joan B.
29 Gray St.
Providence, R. I.

Amount of original 1956 tax	\$219.12
Amt. abated, Cert 21P-19 approved 3/7/57	33.00
Amt. paid 12/20/56 J Teller	219.12
Amount overpaid, Cert. 0-5097	33.00 ✓

Refund \$33.00 to Charles F. McLaughlin Jr. and wf. Joan B.
29 Gray St., City

Code #13-701-145
David Montefusco
32 Osborn St.
Providence, R. I.

Amount of original 1956 tax	\$11.22
Amt. abated, Cert 21P-20 approved 3/7/57	11.22
Amt. paid 10/29/56 D Teller	2.80
Amount overpaid, Cert. 0-5098	2.80

Refund \$2.80 to David Montefusco, 32 Osborn St., City

Code #13-722-805
Samuel H. Moore
272 Niantic Ave.
Providence, R. I.

Amount of original 1956 tax	\$4.62
Amt. abated, Cert 21P-20 approved 3/7/57	4.62
Amt. paid 10/8/56 G Teller	1.15
Amount overpaid, Cert 0-5099	1.15 ✓

Refund \$1.15 to Samuel H. Moore, 272 Niantic Ave, City

Code #14-097-687
Edward C. Noon
521 Admiral St.
Providence, R. I.

Amount of original 1956 tax	\$31.68
Amt. abated, Cert 21P-20 approved 3/7/57	31.68 ✓
Amt. paid 10/26/56 L Teller	7.92
Amount overpaid, Cert. 0-5100	7.92

Refund \$7.92 to Edward C. Noon, 521 Admiral St., City

No.

CHAPTER
AN ORDINANCE

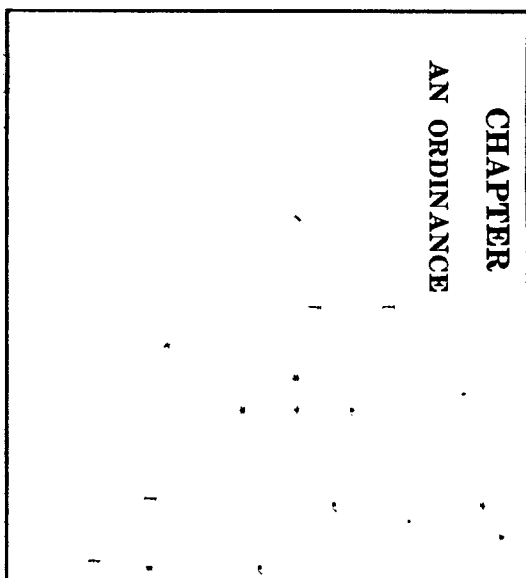

•
•
•
•

•
•
•
•

•
•
•
•

•
•
•
•

•
•
•
•

The City of Providence

STATE OF RHODE ISLAND AND PROVIDENCE PLANTATIONS

PAGE 11

Code #16-235-320
Thomas L. Pezza
22 Lawn St.
Providence, R. I.

Amount of original 1956 tax	\$4.62
Amt. abated, Cert 21P-22 approved 3/7/57	4.62
Amt. paid 1/2/57 A Teller	4.62
Amount overpaid, Cert 0-5101	4.62 ✓

Refund \$4.62 to Thomas L. Pezza, 22 Lawn St., City

Code #18-471-045
John A. Ryan and wf. Mary V.
155 Donelson St.
Providence, R. I.

Amount of original 1956 tax	\$138.60
Amt. abated, Cert 21P-25 approved 3/7/57	21.78
Amt. paid 10/30/56 F Teller	138.60
Amount overpaid, Cert 0-5102	21.78 ✓

Refund \$21.78 to John A. Ryan and wf. Mary V., 155 Donelson St., City

Code #21-023-790
Alfredo Uva
58 Sisson St.
Providence, R. I.

Amount of original 1956 tax	\$4.62
Amt. abated, Cert 21P-29 approved 3/7/57	4.62
Amt. paid 10/8/56 J Teller	4.62
Amount overpaid, Cert. 0-5103	4.62 ✓

Refund \$4.62 to Alfredo Uva, 58 Sisson St., City

Code #23-132-025
Isabelle M. Whalen
11 Tanner St.
Providence, R. I.

Amount of original 1956 tax	\$26.40
Amt. abated, Cert 21P-29 approved 3/7/57	26.40
Amt. paid 10/16/56 L Teller	6.60
Amount overpaid, Cert 0-5104	6.60 ✓

Refund \$6.60 to Isabelle M. Whalen, 11 Tanner St., City

Code #23-161-195
Richard E. Whiteley
135 Cleveland St.
Providence, R. I.

Amount of original 1956 tax	\$9.24
Amt. abated Cert 21P-29 approved 3/7/57	9.24
Amt. paid 10/29/56 L Teller	9.24
Amount overpaid, Cert 0-5105	9.24 ✓

Refund \$9.24 to Richard E. Whiteley, 135 Cleveland St City

CHAPTER
AN ORDINANCE

•
•
•
•
•

•
•
•
•
•

•
•
•
•
•

•
•
•
•
•

•
•
•
•
•

The City of Providence

STATE OF RHODE ISLAND AND PROVIDENCE PLANTATIONS

12
PAGE _____

Code #23-230-320
Milton J. Wintman
201 Freeman Pkwy
Providence, R. I.

Amount of original 1956 tax	\$36.30
Amt. abated, Cert 21P-30 approved 3/7/57	33.00
Amt. paid 10/18/56 F Teller	36.30
Amount overpaid, Cert 0-5106	33.00

Refund \$33.00 to Milton J. Wintman, 201 Freeman Pkwy, City

Code #16-075-240
Henry Paris
55 Marshall St.
Providence, R. I.

Amount of original 1956 tax	\$57.42
Amt. abated, Cert 23P-10 approved 3/7/57	46.20
Amt. paid 10/25/56 F Teller	14.35
Amount overpaid, Cert 0-5107	3.13

Refund \$3.13 to Henry Paris, 55 Marshall St., City

Code #20-142-200
Patrick James Toner
361 Plainfield St.
Providence, R. I.

Amount of original 1956 tax	\$18.48
Amt. abated, Cert 23P-20 approved 3/7/57	4.62
Amt. paid 10/24/56 D Teller	18.48
Amount overpaid, Cert. 0-5108	4.62

Refund \$4.62 to Patrick James Toner, 361 Plainfield St., City

Code #01-235-110
Artcraft Jewelers Inc.
143 Summer St.
Providence, R. I.

Amount of original 1956 tax	\$91.74
Amt. abated, Cert 23P-28 approved 3/7/57	33.00
Amt. paid 12/11/56 A Teller	91.74
Amount overpaid, Cert. 0-5110	33.00

Refund \$33.00 to Artcraft Jewelers Inc., 143 Summer St., City

IN CITY COUNCIL

APR 18 1957

READ and PASSED

Augusta Della
President
Robert W. Brown
Clerk

APPROVED

APR 19 1957

Walter H. Rappaport

CHAPTER
AN ORDINANCE

